



Local  
CMS#

CMS#

17014858 OOS

CenturyLink Constant Job Order/Maintenance Work Authorization

Company T866 Exchange 579 Osseo Service Order# \_\_\_\_\_  
 Work Activity Drop-Buried Copper Capital x Maintenance \_\_\_\_\_  
 Customer Name Mike and Robin Phone# 763-425-6845  
 Address 10890 NATHAN LN N One Call Ticket# \_\_\_\_\_  
 Location/Directions Maple Grove, MN

Description of Work or Special Instructions plow 225' from ONU to new MST. Place MST then plow 135' drop from new ped to NID. 2 bores one at 25' and the road at 45'. This is fiber. Customer is waiting for service.

DOR/TOG Yes \_\_\_ No x Permit: Yes \_\_\_ No x Bore: Yes x No \_\_\_ CBR# 612-210-0854  
 Employee Name Kris Townsend Employee Contact# 612-715-9060

Sketch (Include Line & Pedestal)	Material/Labor Units		Est Qty.	Actual Qty.	Placed by (Foreman/Crew Name)
	Description	Notes			
Line					
Ped#					
Parish/County					
Hennipen					
Township:					
Section					
Range					
GPS Reading					

Nearest cross st. \_\_\_\_\_ Plat Page \_\_\_\_\_ Map# \_\_\_\_\_  
 Damaged facility # \_\_\_\_\_ Tax Code \_\_\_\_\_  
**SKETCH**

\*\*\*by the NID go deep because customer will be putting in a concrete pad\*\*\*

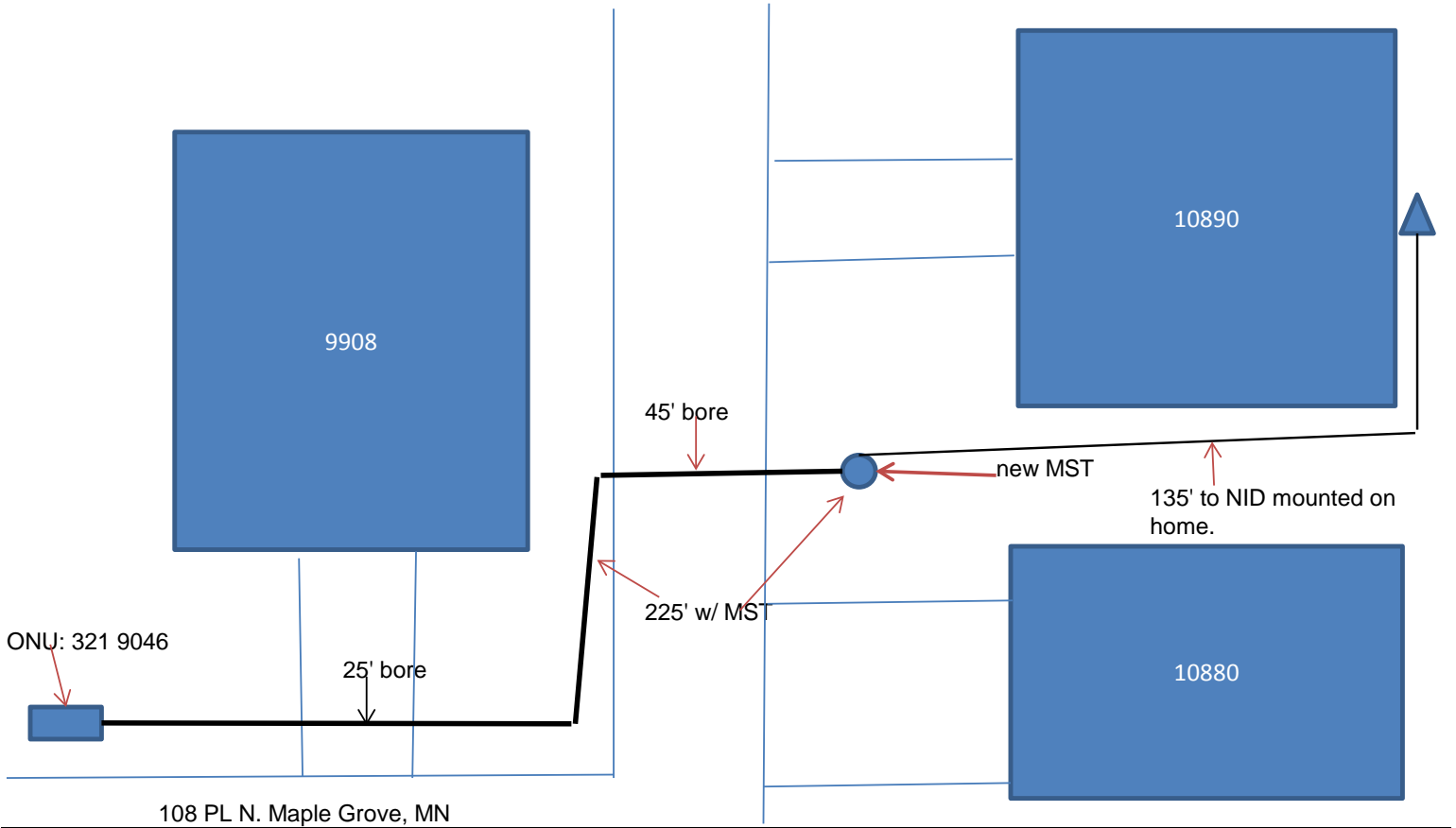

108 PL N. Maple Grove, MN

Originated By: Townsend Date: 1/17/17 Completed By: \_\_\_\_\_ Date: \_\_\_\_\_  
 Authorized By: (APS) \_\_\_\_\_ Date: \_\_\_\_\_ Inspected By: \_\_\_\_\_ Date: \_\_\_\_\_  
 Authorized By: (AOM) \_\_\_\_\_ Date: \_\_\_\_\_  
 Inspection notes: \_\_\_\_\_