

		Local Exch#			CMS#		
CenturyLink BSW Order/Maintenance Work Authorization							
Company	T600	Exchange				Service Order#	1416208497
Work Activity				Capital	Y	Maintenance	N
Customer Name	MELISSA PETTERSON				Phone#	763-416-1198	
Address	8261 ARROWWOOD LN N				One Call Ticket#		
City & Zip	maple grove						
Location/Directions	GPS						
Description of Work or Special Instructions							
place 175' drop and pick up temp fiber drop							
Held Order ?	NO	Permit:	NO	Bore:	NO	CBR#	763-228-2979
Employee Name	MER064519			Employee Contact#	7632288645		
Material/Labor Units				Est	Actual	Placed by	
(Include Cntr Line & Pedestal)	Description	Notes		Qty.	Qty	(Foreman/Crew Name)	
Cntr Line foot	33	SEB3-22	Place 3 pair BSW				
Ped#		SEPCUTOVER	CUTOVER BSW				
Parish/County	Hennepi	BM83	BSW guard at house				
		XXSEB-GL	Remove temp drop				
Township:	na	BM61(1.5)D	BSW Bore required				
Section	na	SEB3-22T	Hand Dig				
Range	na	SEBOP2	Fiber Drop				
Nearest cross st.	GPS			Plat Page	GPS	Map#	GPS
Damaged facility #							
SKETCH							

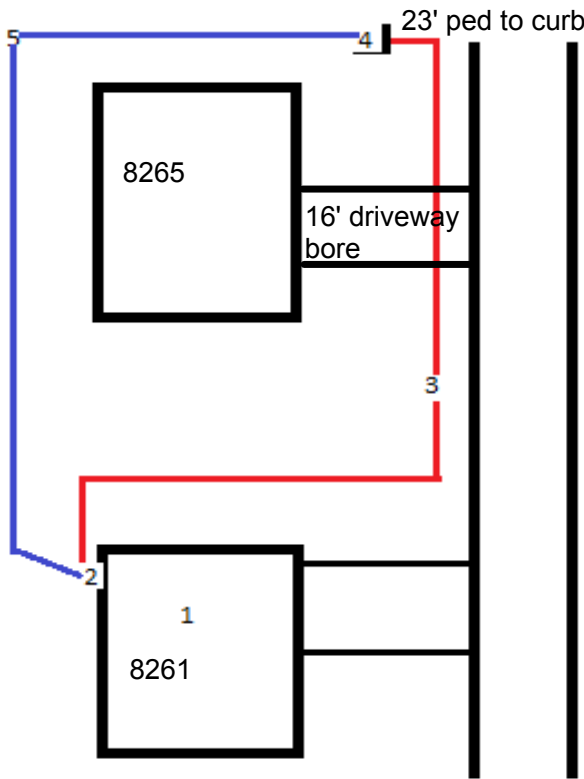

- 1-house
- 2-nid
- 3-175' drop bury fiber
- 4-MST
- 5-temp drop remove temp

64' in ROW

Originated By:	MER064519	Date:	12/28/16	Completed By:		Date:	
Authorized By: (APS)		Date:		Inspected By:		Date:	
Authorized By: (AOM)		Date:					
Inspection Notes:		MetroBSW @centurylink.com					
1. Distance of the bury in Right-of-Way		3. Distance to the nearest intersection					
2. Distance from the terminal to the centerline:		4. Nearest State Hwy mile marker					