









PROPRIETARY AND CONFIDENTIAL

**WO# 115436381**

CITY INFO **25-77976**

**MAPLE GROVE M52900-SVCS**

**LEGEND:**

-  IN SERVICE
-  PROPOSED
-  PROPOSED ABANDONED
-  ABANDONED
-  Interruptible
-  Existing
-  Normal
-  Future
-  Proposed

**CUSTOMER APPROVAL OF DESIGN**

SIGNATURE: \_\_\_\_\_

PRINTED NAME: \_\_\_\_\_ DATE: \_\_\_\_\_

Please review Center Point Energy design for installing Natural Gas to your facility. Verify the route of the Service Line and Meter Location on the building. If there is a conflict please contact the Designer or Sales Rep as shown in the Title Block. Before natural gas service lines can be installed, you must clearly mark all privately-owned underground facilities including: septic tanks, drain fields, sewer lines, water wells, sprinkler systems, invisible fences, electric lines and pipelines. CenterPoint Energy and its representatives are not responsible for damage to these items if they are not clearly marked at time of installation.

**CUSTOMER APPROVAL SITE MEETING**

SIGNATURE: \_\_\_\_\_

PRINTED NAME: \_\_\_\_\_

PHONE NUMBER: \_\_\_\_\_ DATE: \_\_\_\_\_

The site is ready for gas install and is within 6" of final grade. Any and all private crossings have been clearly marked on site. I acknowledge that any alterations after the gas line is installed will be at **Builder's/Owner's expense**.

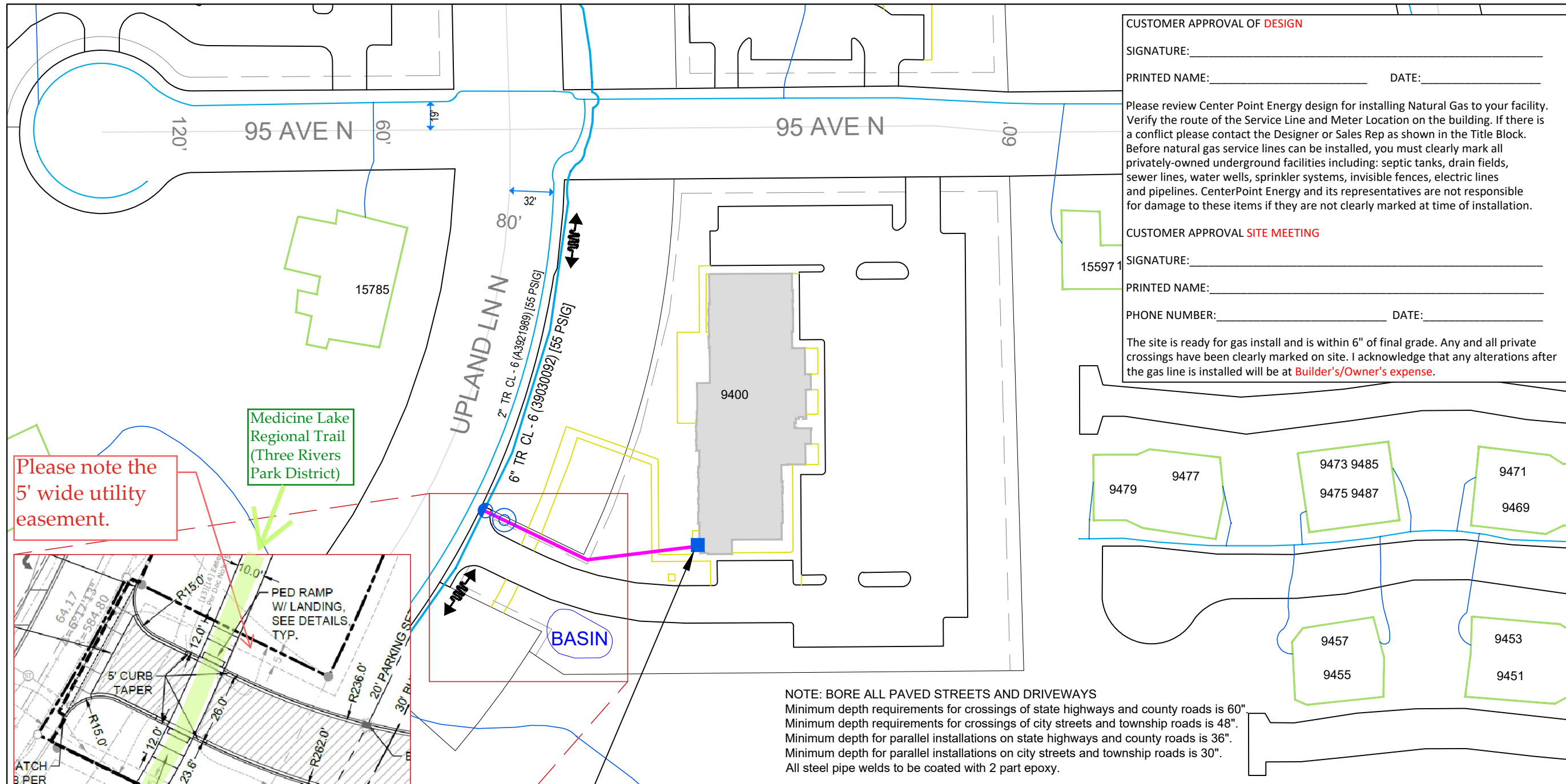

Please note the 5' wide utility easement.

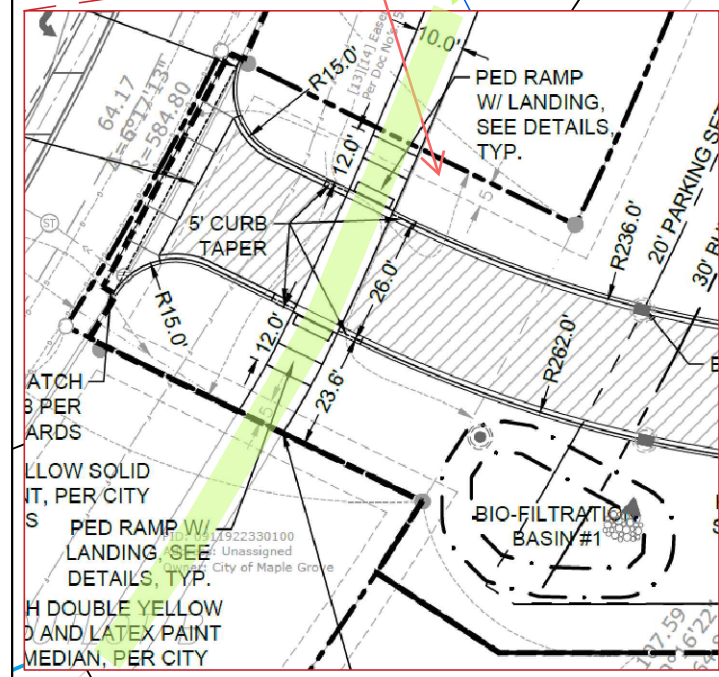

**M/I METER WO# 115436252**  
 INSTALL a D1000 OUTSIDE METERSET with a 1-1/4" 1813C REGULATOR at CL-6 to 2 PSI with a 3/16" ORIFICE (LOAD: 1070cfh), with a BYPASS. METERSET EQUIP# 16171225

**SERVICE WO# 115436381**  
 INSTALL a 6" x 1-1/4" IPS PE SVC TEE with a .80" TAP  
 INSTALL a 2" IPS EFV - 5500 SERIES 1-1/4" ASSEMBLY in the BLVD.  
 INSTALL 170' of 1-1/4" IPS PE CL-6 SVC LINE with a 1-1/4" MPT x 1-1/4" IPS PE ANODELESS RISER, with SLEEVE.  
 SERVICE EQUIP# 77597964

Address: 9400 UPLAND LN N  
 Customer: MAPLE GROVE RE, LLC  
 Contact Person: Brandon Abrahamson  
 Contact Phone: 612-461-9029  
 Sales Rep: Jason Kocke  
 Sales Rep Phone: 612-258-4327  
 Construction Hotline: 612-321-5310  
 Restoration Hotline: 612-321-5042  
 Copies To Pipeline Integrity: No  
 Curb Valve: No  
 Copies to Corrosion: No  
 Corrosion Approval: N/A  
 Follow Internal Pipe Sampling Requirements? No  
 Job Briefing Required? No  
 GFIP#: N/A  
 Permits: Yes - City Of Maple Grove & Three Rivers Park District  
 Requested Install Date: 03/02/2025

Approval: *tracia killion*

PROJECT DESCRIPTION:  
 DENTAL ASSOCIATES

DESIGNER: Philip Woutat  
 PHONE#: (612) 321 - 4437  
 DRAWN BY: Philip Woutat  
 DESIGN DATE: 1/16/2025

Revised Print  
 Destroy All Others  
 Revision History  
 Date:  
 Description:  
 Design Approval:

SCALE: 1" = 80'  
 SHEET 1 OF 1

