

VICINITY MAP

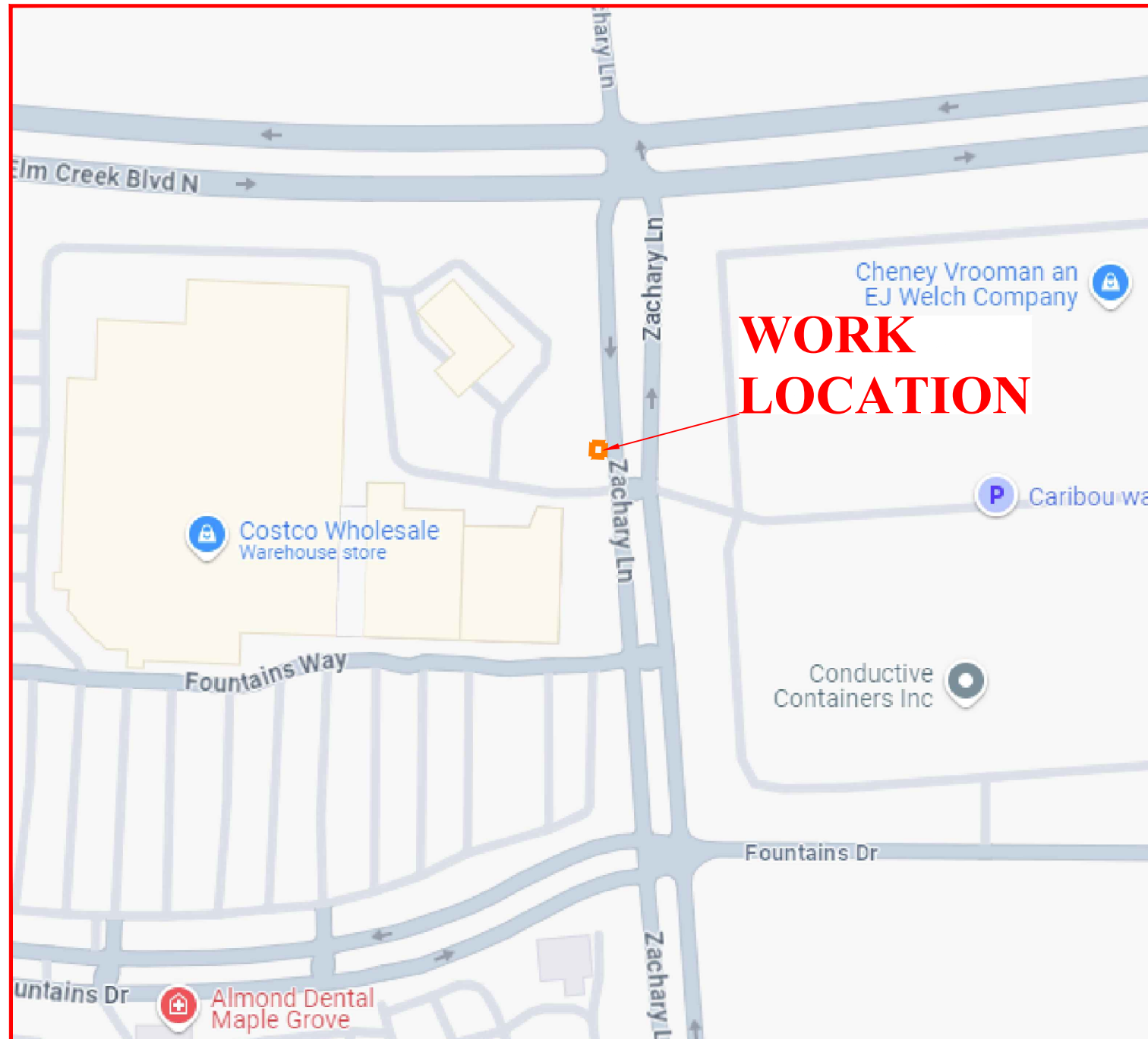

EX.HH UNK-1/AOMP6
ACCESS NEEDED FOR SPLICING



DISCLAIMER:

UTILITY LOCATIONS SHOWN ON THIS DRAWING ARE APPROXIMATE AND SHOULD NOT BE SOLELY RELIED UPON TO LOCATE UNDERGROUND FACILITIES. THE CONTRACTOR SHALL BE FULLY RESPONSIBLE FOR COMPLIANCE WITH STATEWIDE AND/OR LOCAL AREA "ONE CALL" PROGRAMS AND REQUIREMENTS.

CALL 811 BEFORE DIGGING TO LOCATE ANY ADDITIONAL UTILITIES

GENERAL NOTES

FOR ALL PUBLIC RIGHT OF WAY AND PUBLIC PROPERTIES:
 - FOR CROSSING AT 90 DEGREES, ALL CONDUITS AND FIBER OPTIC CABLE SHALL BE PLACED AT A MINIMUM DEPTH OF THIRTY (30")INCHES BELOW THE IMAGINARY LINE FROM TOP OF CURB TO TOP OF CURB ON OPPOSITE SIDE OF STREET (FOR STREETS WITH CURBS) AND THIRTY(30")INCHES BELOW PUBLIC ROADWAYS (FOR STREETS WITHOUT CURBS),UNLESS OTHERWISE SPECIFIED IN A NOTE/ CALLOUT ON THE SUBSEQUENT PLAN SHEETS.
 -FOR CROSSING AT 90 DEGREES, ALL CONDUITS AND FIBER OPTIC CABLE SHALL BE PLACED A MINIMUM OF THIRTY (30")INCHES BELOW PUBLIC SEWERS,PUBLIC CULVERTS,AND/OR PUBLIC WATERWAYS.
 -ALL CONDUITS AND FIBER OPTIC CABLE SHALL BE PLACED AT A MINIMUM DISTANCE OF 2' FROM OTHER UTILITIES,UNLESS OTHERWISE SPECIFIED IN A NOTE/CALLOUT ON THE SUBSEQUENT PLAN SHEETS.

ADDRESS:11121 FOUNTAINS DRIVE,
MAPLE GROVE, MN 55369

TOWNSHIP: S26-T119N-R22W

CITY PERMIT REQUIRED



LUMEN ENGINEER:KERRI WALDERA-DEROSA
PHONE: 612-431-3492
DRAWN BY PEARCE SERVICES / VIPIN
SHEET: 01 OF 03

PROJECT: P.260540

WIRE CENTER: OSSEMNXO

SCALE: NTS

DATE: 09/11/2024 *today's date*



LEGEND SHEET

SYMBOLOLOGY

BACK OF CURB		BOC
EDGE OF PAVEMENT		EOP
CENTERLINES		C/L
MONUMENT LINE		M/L
DRIVEWAY		DW
SIDEWALK		SW
PROPERTY LINE		P/L
RIGHT OF WAY		R/W
PUE		PUE
NON-VEHICLE-ACCESS EASEMENT		NVAE
MATCHLINE		
RAILROAD		
CATV LINE		CATV
ELECTRIC		E
OVERHEAD ELECTRIC		OHE
OVERHEAD T & E		OHT&E
GAS		G
PETROLEUM		PETROLEUM
IRRIGATION		IRR
RWCD IRRIGATION PIPE		IRR
SEWER		S
SITE TRIANGLE		
STORM DRAIN		SD
EX. CONDUIT		T
JOINT TRENCH TELCO/ELEC		T&E
AERIAL UTILITY (FIBER OPTIC)		AFO
BURIED UTILITY (FIBER OPTIC)		BFO
ABN TELCO		T
WATER		W
CITY LIMITS		
PLOW 1.25 INCH		PLOW
BORE		BORE
TRENCH		TRENCH

	MAILBOX		STORM DRAIN INTAKE
	BRASS CAP		STORM DRAIN GRATE
	CENTERLINE TICK		STORM DRAIN MANHOLE
	STREET SIGN		SEWER MANHOLE
	TREE		CULVERT
	BUSH		IRRIGATION MANHOLE
	Pinnacle Peak		IRRIGATION VALVE
	POWER POLE		CATV CABINET
	TELEPHONE POLE		CATV HANDHOLE
	JOINT POLE		CATV VAULT
	CATV ANCHOR		CATV PEDESTAL
	POWER / TELEPHONE ANCHOR		GAS VALVE
	TRAFFIC LIGHT POLE		GAS VAULT
	TRAFFIC SIGNAL POST		FLOWER POT
	TRAFFIC SIGNAL J-BOX		TEL PEDESTAL EXISTING
	STREET LIGHT		TEL PEDESTAL NEW
	ELECTRIC SWITCHGEAR		TEL MANHOLE EXISTING
	JUNCTION BOX		TEL MANHOLE NEW
	ELECTRIC VAULT		TELCO HANDHOLE EXISTING
	GROUND TRANSFORMER		TELCO HANDHOLE NEW
	AERIAL TRANSFORMER		4'x4' BOREPIT
	ELECTRIC HANDHOLE		SAI EXISTING
	ELECTRIC MANHOLE		SAI NEW
	POWER PED EXISTING		RT EXISTING
	POWER PED NEW		RT NEW
	WATER METER		TELCO REPEATER NEW
	WATER VALVE (FLUSH)		TELCO REPEATER EXISTING
	WATER VALVE (ABOVE GND)		COOLPED NEW
	FIRE HYDRANT		COOLPED EXISTING
	TRENCH FTG		BORE FTG
	ASPHALT CUT FTG		SLACK LOOP FTG
<u>ALL PROPOSED EQUIPMENT WILL BE BOLD</u>			

ADDRESS: 11121 FOUNTAINS DRIVE,
MAPLE GROVE, MN 55369

TOWNSHIP: S26-T119N-R22W

CITY PERMIT REQUIRED



LUMEN ENGINEER: KERRI WALDERA-DEROSA

PHONE: 612-431-3492

DRAWN BY: PEARCE SERVICES / VIPIN

SHEET: 02 OF 03

PROJECT: P.260540

WIRE CENTER: OSSEMNXO

SCALE: NTS

DATE: 09/11/2024



HENNEPIN COUNTY ELM CREEK BLVD N

CITY PERMIT

REVERSE ALL THE LAYERS OF BOC, R/W, EOP, S/W, C/L

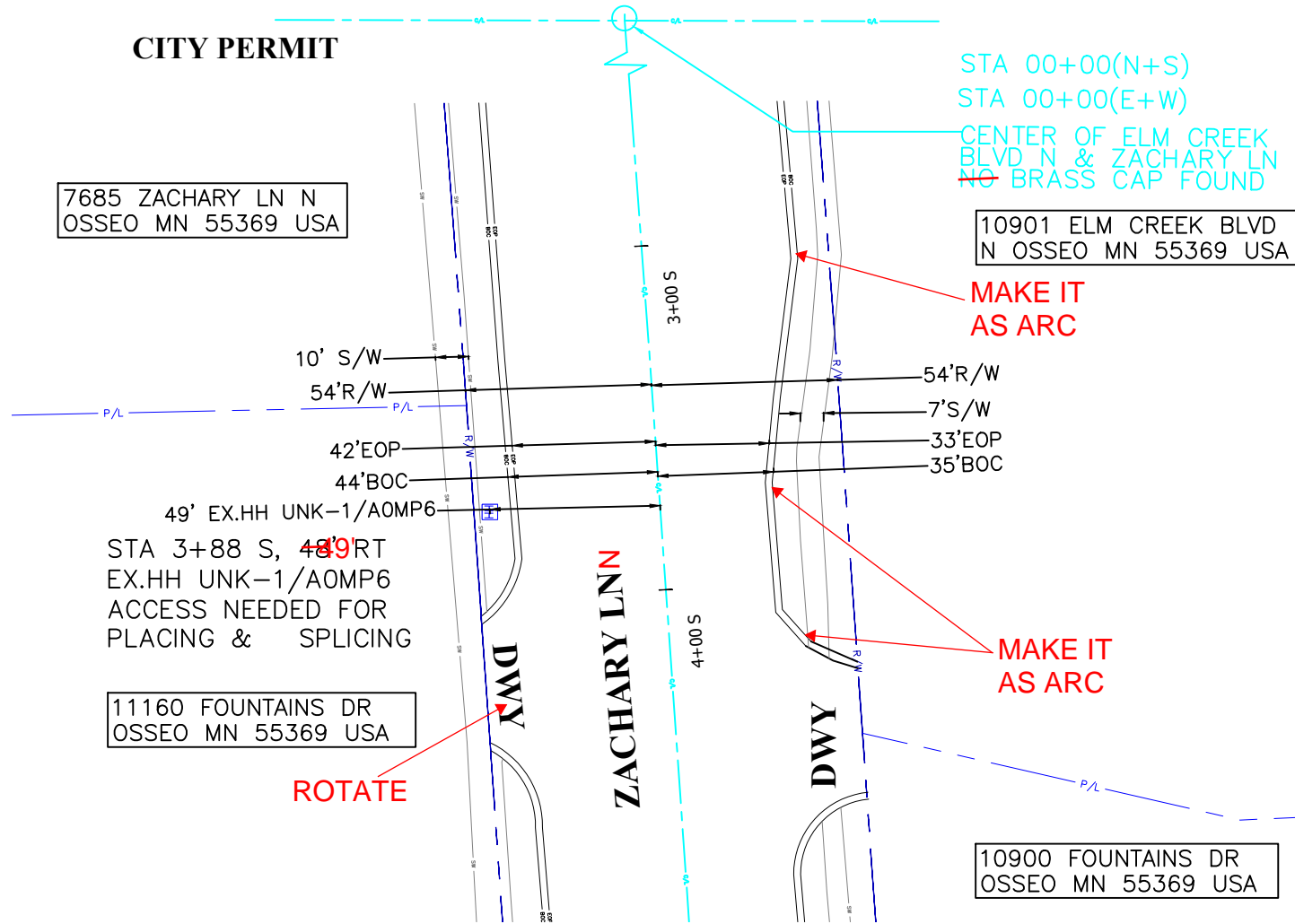

NOTE: "CALL 811 BEFORE DIGGING TO LOCATE ANY ADDITIONAL UTILITIES"

ALL UTILITIES NEED LOCATED BEFORE CONSTRUCTION PERMIT REQUIRED



ADDRESS: 11121 FOUNTAINS DRIVE,
MAPLE GROVE, MN 55369

TOWNSHIP: S26-T119N-R22W

CITY PERMIT REQUIRED

LUMEN

LUMEN ENGINEER: KERRI WALDERA-DEROSA

PHONE: 612-431-3492

DRAWN BY: PEARCE SERVICES /VIPIN

SHEET: 03 OF 03

PROJECT: P.260540

WIRE CENTER: OSSEMNXO

SCALE: 1:50

DATE: 09/11/2024

PEARCE
SERVICES