

DESCRIPTION	QUANTITY	UNIT
EX. CONDUIT	1802'	FT
TOTAL PROJECT FOOTAGE	1802'	FT

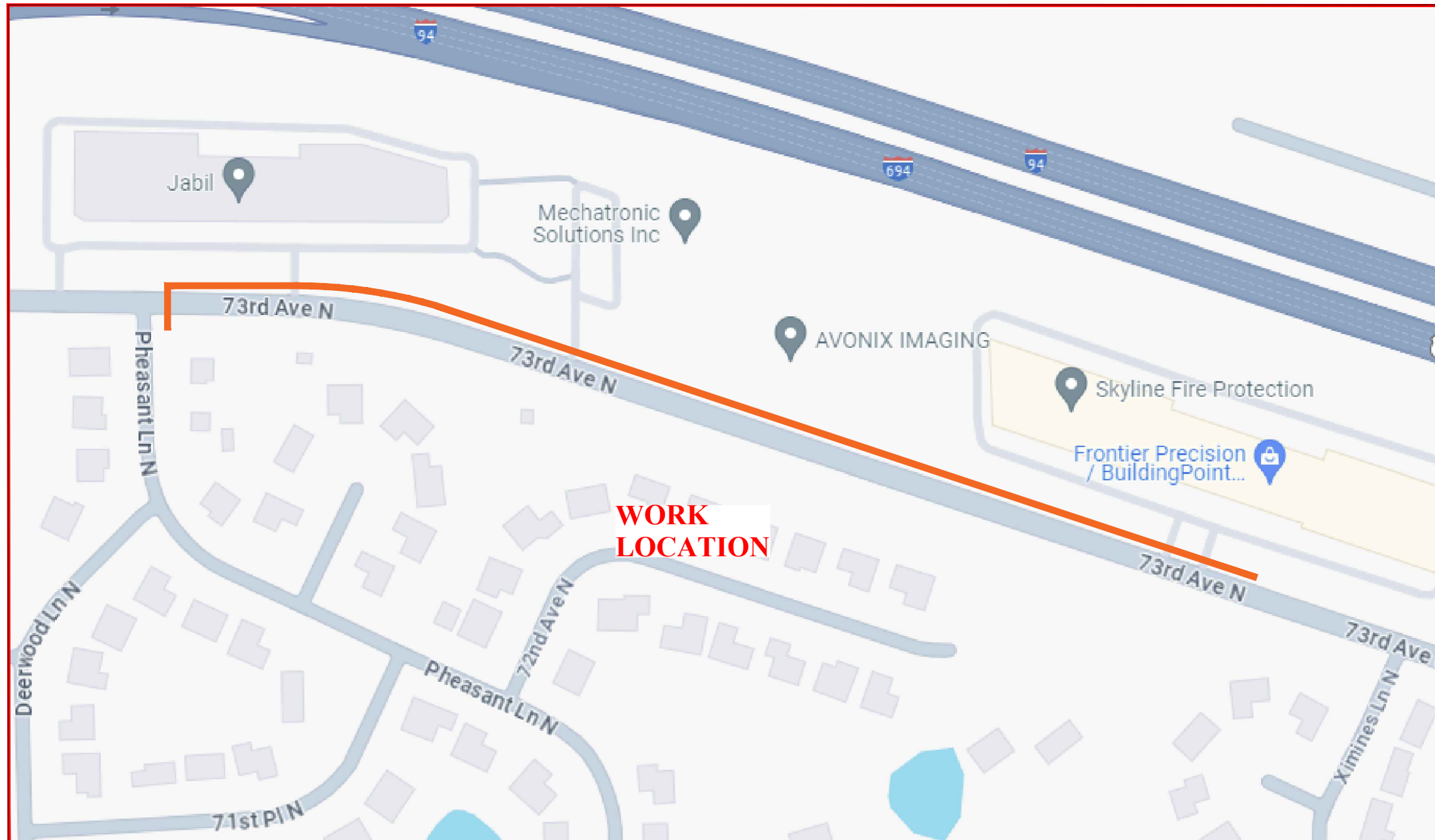

VICINITY MAP



GENERAL NOTES
FOR ALL PUBLIC RIGHT OF WAY AND PUBLIC PROPERTIES: - FOR CROSSING AT 90 DEGREES, ALL CONDUITS AND FIBER OPTIC CABLE SHALL BE PLACED AT A MINIMUM DEPTH OF THIRTY (30") INCHES BELOW THE IMAGINARY LINE FROM TOP OF CURB TO TOP OF CURB ON OPPOSITE SIDE OF STREET (FOR STREETS WITH CURBS) AND THIRTY(30") INCHES BELOW PUBLIC ROADWAYS (FOR STREETS WITHOUT CURBS), UNLESS OTHERWISE SPECIFIED IN A NOTE/ CALLOUT ON THE SUBSEQUENT PLAN SHEETS. -FOR CROSSING AT 90 DEGREES, ALL CONDUITS AND FIBER OPTIC CABLE SHALL BE PLACED A MINIMUM OF THIRTY (30") INCHES BELOW PUBLIC SEWERS, PUBLIC CULVERTS, AND/OR PUBLIC WATERWAYS. -ALL CONDUITS AND FIBER OPTIC CABLE SHALL BE PLACED AT A MINIMUM DISTANCE OF 2' FROM OTHER UTILITIES, UNLESS OTHERWISE SPECIFIED IN A NOTE/CALLOUT ON THE SUBSEQUENT PLAN SHEETS.

ADDRESS: 10900 73RD AVE N
 MAPLE GROVE, MN 55369

TOWNSHIP: S25 T119N R22W

CITY PERMIT REQUIRED

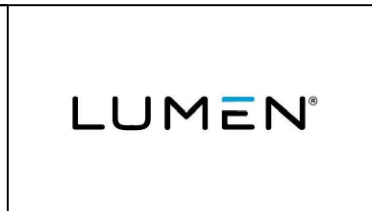

LUMEN ENGINEER: KERRI WALDERA-DEROSA

PHONE: 612-431-3492

SHEET: 01 OF 05

PROJECT: P.252400

WIRE CENTER: OSSEMNXO

SCALE: NTS

DATE: 08/09/2024



LEGEND SHEET

SYMBOLOLOGY

BACK OF CURB		B/C
EDGE OF PAVEMENT		EOP
CENTERLINES		C/L
MONUMENT LINE		M/L
DRIVEWAY		DW
SIDEWALK		SW
PROPERTY LINE		P/L
RIGHT OF WAY		R/W
PUE		PUE
NON-VEHICLE-ACCESS EASEMENT		NVAE
MATCHLINE		
RAILROAD		
CATV LINE		CATV
ELECTRIC		E
OVERHEAD ELECTRIC		OHE
OVERHEAD T & E		OHT&E
GAS		G
PETROLEUM		PETROLEUM
IRRIGATION		IRR
RWCD IRRIGATION PIPE		
SEWER		S
EX.COPPER CABLE		
STORM DRAIN		SD
EX. CONDUIT		T
JOINT TRENCH TELCO/ELEC		T&E
AERIAL UTILITY (FIBER OPTIC)		AFD
BURIED UTILITY (FIBER OPTIC)		BFD
ABN TELCO		T
WATER		W
CITY LIMITS		
PLOW 1.25 INCH		PLOW
BORE		BORE
TRENCH		TRENCH

	MAILBOX		STORM DRAIN INTAKE
	BRASS CAP		STORM DRAIN GRATE
	CENTERLINE TICK		STORM DRAIN MANHOLE
	STREET SIGN		SEWER MANHOLE
	TREE		CULVERT
	BUSH		IRRIGATION MANHOLE
	Pinnacle Peak		IRRIGATION VALVE
	POWER POLE		CATV CABINET
	TELEPHONE POLE		CATV HANDHOLE
	JOINT POLE		CATV VAULT
	CATV ANCHOR		CATV PEDESTAL
	POWER / TELEPHONE ANCHOR		GAS VALVE
	TRAFFIC LIGHT POLE		GAS VAULT
	TRAFFIC SIGNAL POST		FLOWER PDT
	TRAFFIC SIGNAL J-BOX		TEL PEDESTAL EXISTING
	STREET LIGHT		TEL PEDESTAL NEW
	ELECTRIC SWITCHGEAR		TEL MANHOLE EXISTING
	JUNCTION BOX		TEL MANHOLE NEW
	ELECTRIC VAULT		TELCO HANDHOLE EXISTING
	GROUND TRANSFORMER		TELCO HANDHOLE NEW
	AERIAL TRANSFORMER		4'x4' BOREPIT
	ELECTRIC HANDHOLE		SAI EXISTING
	ELECTRIC MANHOLE		SAI NEW
	POWER PED EXISTING		RT EXISTING
	POWER PED NEW		RT NEW
	WATER METER		TELCO REPEATER NEW
	WATER VALVE (FLUSH)		TELCO REPEATER EXISTING
	WATER VALVE (ABOVE GND)		COOLPED NEW
	FIRE HYDRANT		COOLPED EXISTING
	TRENCH FTG		BORE FTG
	ASPHALT CUT FTG		SLACK LOOP FTG

ALL PROPOSED EQUIPMENT WILL BE BOLD

ADDRESS: 10900 73RD AVE N
MAPLE GROVE, MN 55369

TOWNSHIP: S25 T119N R22W

CITY PERMIT REQUIRED



LUMEN ENGINEER: KERRI WALDERA-DEROSA

PHONE: 612-431-3492

SHEET: 02 OF 05

PROJECT: P.252400

WIRE CENTER: OSSEMNXO

SCALE: NTS

DATE: 08/09/2024



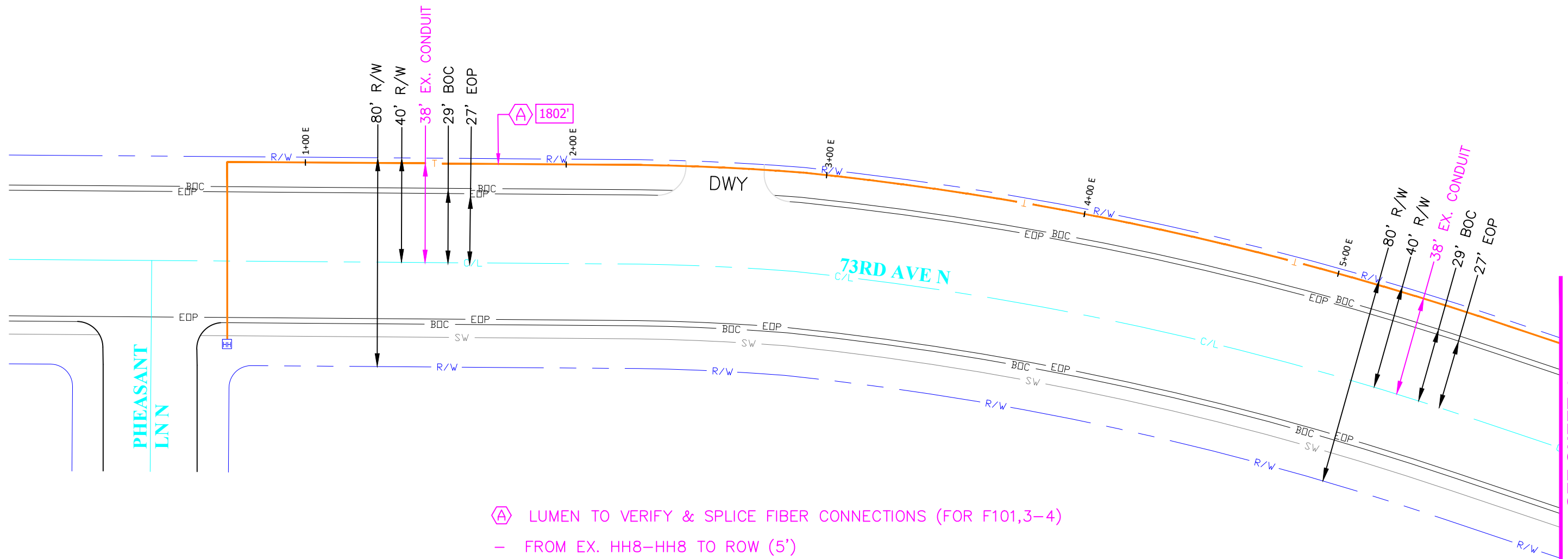

ADDRESS: 10900 73RD AVE N
 MAPLE GROVE, MN 55369

TOWNSHIP: S25 T119N R22W

CITY PERMIT REQUIRED



LUMEN ENGINEER: KERRI WALDERA-DEROSA

PHONE: 612-431-3492

SHEET: 03 OF 05

PROJECT: P.252400

WIRE CENTER: OSSEMNXO

SCALE: 1:40

DATE: 08/09/2024



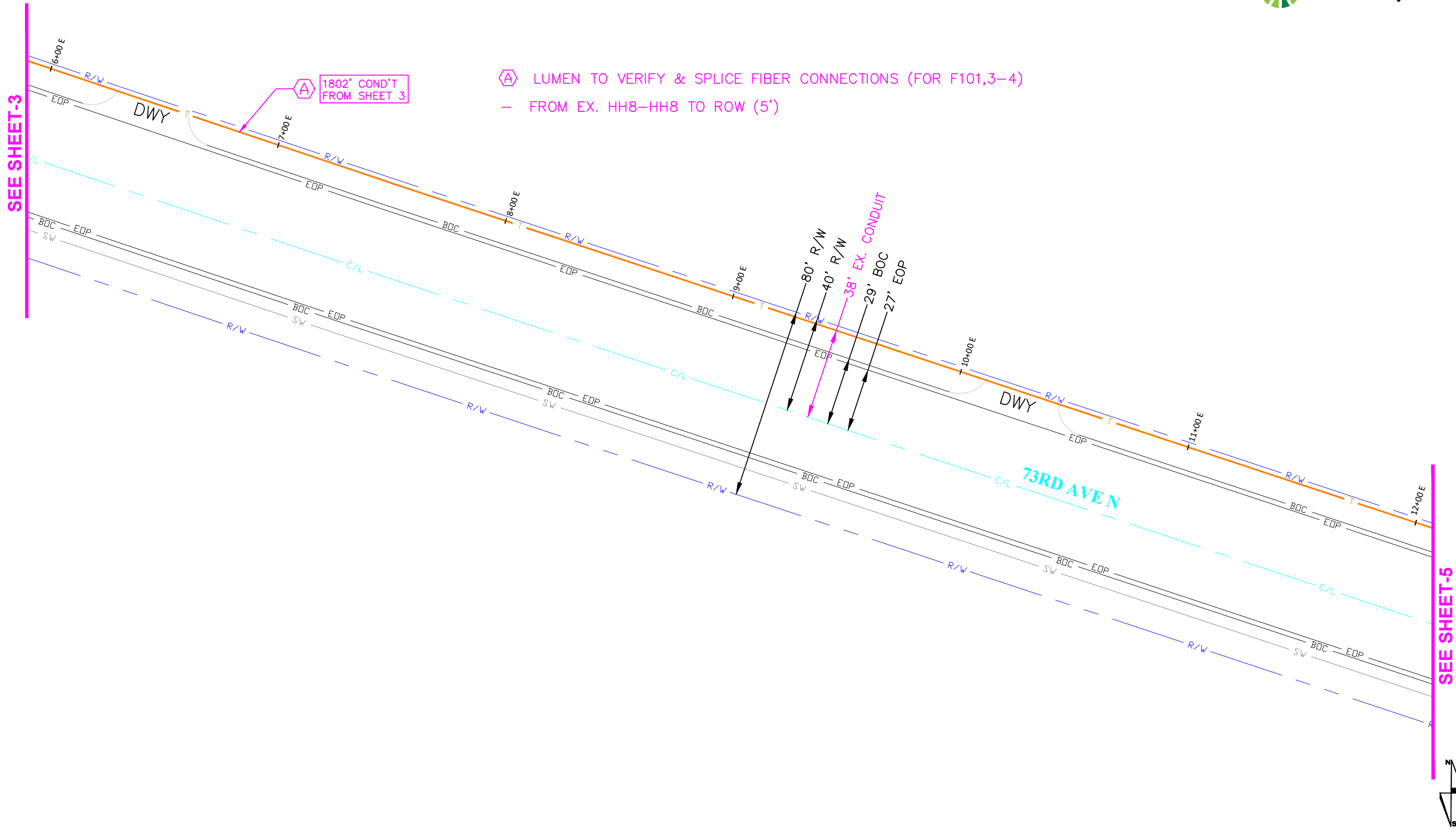

Ⓐ LUMEN TO VERIFY & SPLICE FIBER CONNECTIONS (FOR F101,3-4)
 - FROM EX. HH8-HH8 TO ROW (5')

Ⓐ 1802' COND'T FROM SHEET 3

SEE SHEET-3

SEE SHEET-5



ADDRESS: 10900 73RD AVE N
 MAPLE GROVE, MN 55369

TOWNSHIP: S25 T119N R22W

CITY PERMIT REQUIRED



LUMEN ENGINEER: KERRI WALDERA-DEROSA

PHONE: 612-431-3492

SHEET: 04 OF 05

PROJECT: P.252400

WIRE CENTER: OSSEMNXO

SCALE: 1:40

DATE: 08/09/2024



SEE SHEET-4

Ⓐ 1802' COND'T FROM SHEET 4

Ⓐ LUMEN TO VERIFY & SPLICE FIBER CONNECTIONS (FOR F101,3-4)
 - FROM EX. HH8-HH8 TO ROW (5')

WORK CONTINUE BEYOND R/W
 LUMEN TO VERIFY & SPLICE FIBER CONNECTIONS (FOR F101,3-4)
 FROM R/W TO MPOP

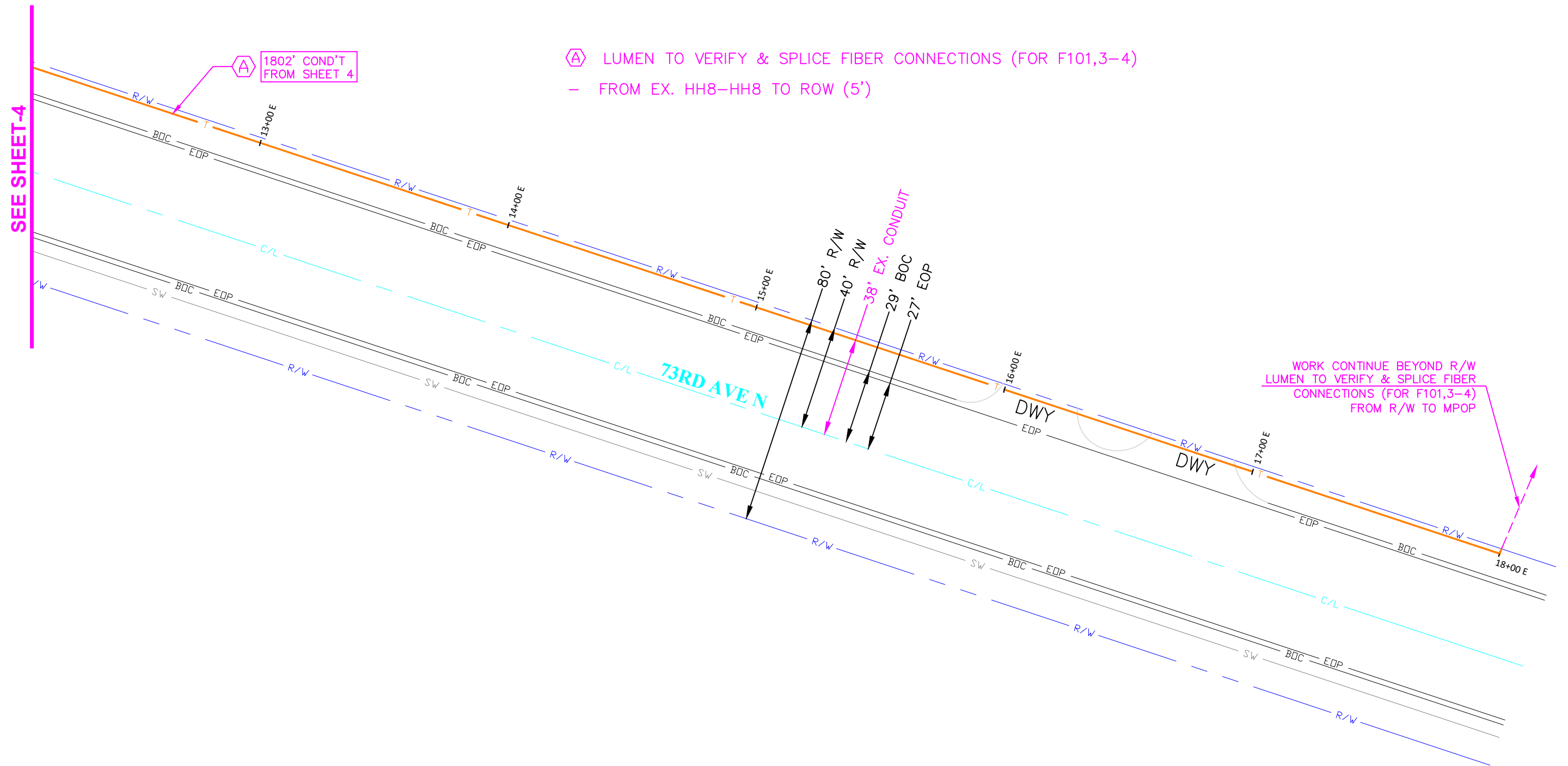

ADDRESS: 10900 73RD AVE N
 MAPLE GROVE, MN 55369

TOWNSHIP: S25 T119N R22W

CITY PERMIT REQUIRED



LUMEN ENGINEER: KERRI WALDERA-DEROSA
PHONE: 612-431-3492
SHEET: 05 OF 05

PROJECT: P.252400
WIRE CENTER: OSSEMNXO
SCALE: 1:40
DATE: 08/09/2024

