

**RUSH CREEK HOLLOW**  
**MAPLE GROVE**  
**ELECTRIC & ODL LAYOUT**  
**ELEC WO - 112652953**  
**ODL WO - 112652955**

**DESIGNER: CASSIE KELLGREN**  
**EMAIL: CASSANDRE.A.KELLGREN@XCELENERGY.COM**  
**CELL: 612-456-9257**

**SERVICE DESIGNER: EVAN FULLER**  
**EMAIL: EVAN.J.FULLER@XCELENERGY.COM**  
**PHONE: 612-216-8010**

**DEVELOPER:**  
**EMAIL:**  
**PHONE:**

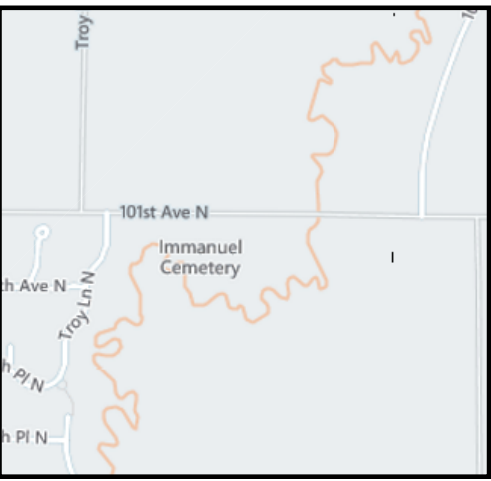

**LOCAL DESIGNER IS SENDING WORK ORDERS FOR JOINT TRENCH TO REMOVE EXISTING OH TRANSFORMER AND SECONDARY OH SERVICE.**

**PROJECT NOTES:**  
 INSTALL #2 AL PRIMARY IN JOINT TRENCH WITH, PHONE AND CATV. RUN TRENCH IN UTILITY EASEMENT (SEE PLAT). INSTALL 350 AL TO PEDESTALS. LOCAL DESIGNER IS SENDING WORK ORDERS FOR JT TO REMOVE EXISTING OH XFRMR AND SECONDARY OH SERVICE TO EXISTING HOME THAT IS CONVERTING TO UG. INSTALL OH STEP DOWN XFRMR AFTER EXISTING OH XFRMR AND OH SECONDARY SERVICE IS REMOVED. DIRECTIONAL BORE 350' OF #2 AL PRIMARY TO NEW DEVELOPMENT, TRENCH THE REMAINING FOOTAGE, AND LEAVE T15 RADIAL.

**MAP BOUNDARIES:**  
 K51091 - STEP DOWN XFRMR  
 K52001 - NEW DEVELOPMENT

**FEEDER: ECK322**  
**FEEDER VOLTAGE: 35KV (19.9KV)**  
**PHASE: B**  
**LONGEST SVC RUN: <250'**

**SIDEWALK TRAIL:** ———

**OH MATERIALS**  
**STEPDOWN XFRMR - 100KVA (19.9KV - 7.9KV) = 1**

**UG MATERIALS**  
 50KV XFRMR= 2  
 PEDS= 3  
 #2 AL PRIMARY= 1,040'  
 350 AL= 430'  
 #6 AL SEC= 165'

**STREETLIGHT MATERIALS**  
**INSTALL TWO (2) 18' FGDB POLES W/ 100W LED TRADITIONAL COLONIAL STREETLIGHTS AT STAKED LOCATIONS.**

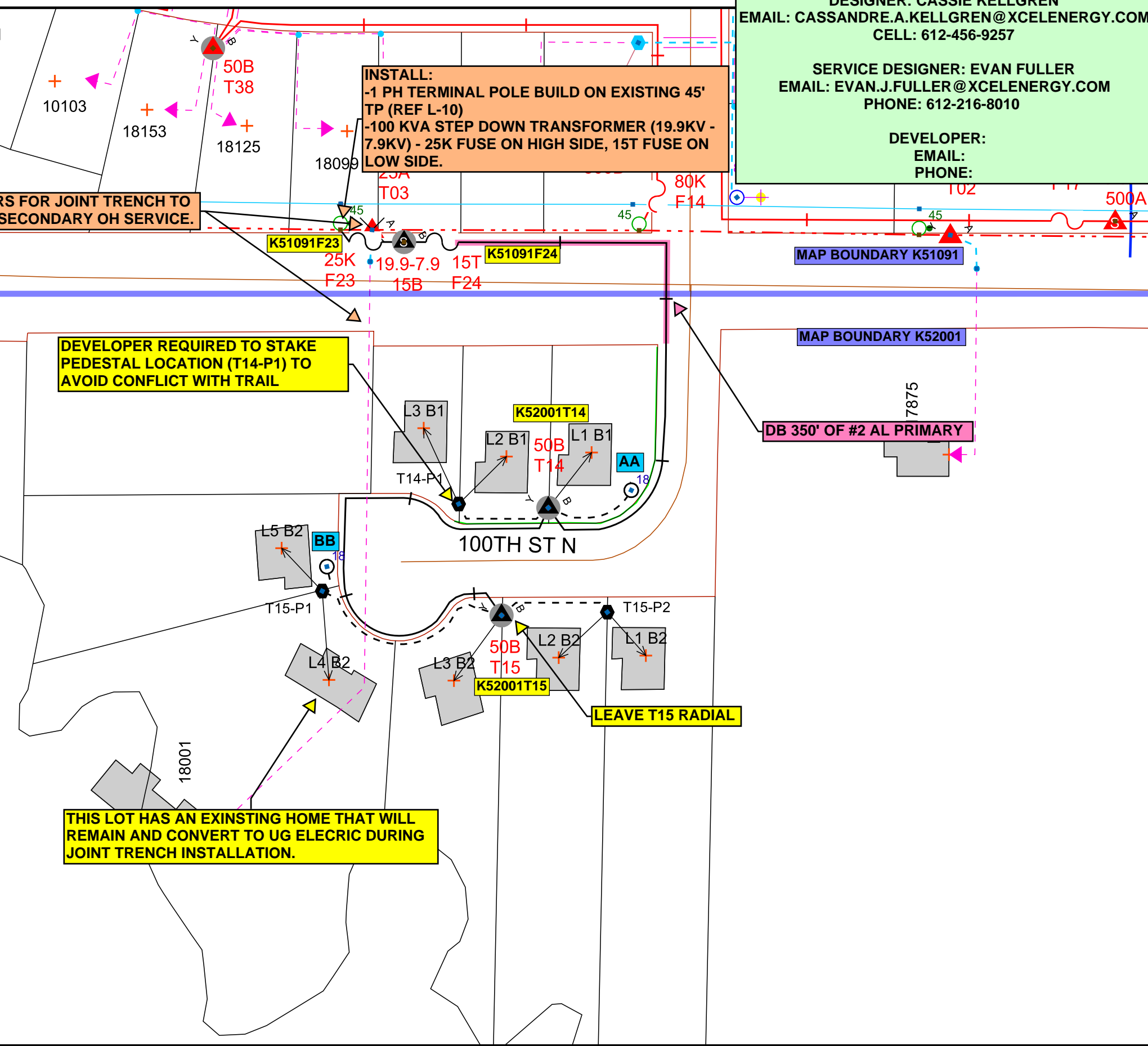

**DEVELOPER REQUIRED TO STAKE PEDESTAL LOCATION (T14-P1) TO AVOID CONFLICT WITH TRAIL**

**DB 350' OF #2 AL PRIMARY**

**LEAVE T15 RADIAL**

**THIS LOT HAS AN EXISTING HOME THAT WILL REMAIN AND CONVERT TO UG ELECTRIC DURING JOINT TRENCH INSTALLATION.**

Work Order Information	
Service Request #	: 000014795226
Design Number	: 000001186219
Designer/Planner ID	: 302153
Designer/Planner Name	:
Designer/Planner Ph #	: (000) 000-0000
Manager Approval	:

Joint Utility	
E:	G:
T:	C:

Design Location	
Division	: Maple Grove
County	: Hennepin
City	: Maple Grove
Address	:
T: 119N	R: 22W S: 7
Map #	: K52001 Permit :

Electric	
Feeder: ECK322	Voltage: 35KV (19.9KV)
Phase: B	Bkup Dev ID:

Gas	
System	: Pressure :
Size	: Material :
Dead End	:

Work Order # :  
 Date: 08/29/2024  
 Sketch: # Of # Sketch Data  
 Scale: 1" equals 83'

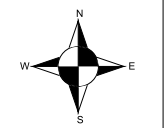

**CONSTRUCTION USE ONLY**

- NO CHANGES (BUILT AS DESIGNED)
- CHANGES MADE AS INDICATED (ALL URD MUST HAVE ACTUAL MEASUREMENTS FROM THE FIELD SITE)

RFO \_\_\_\_\_  
 FOREMAN \_\_\_\_\_ DATE \_\_\_\_\_  
 TEAM LEADER \_\_\_\_\_

DISCLAIMER: THERE ARE NO REPRESENTATIONS OR WARRANTIES (EXPRESS OR IMPLIED) ABOUT THE ACCURACY OF THIS PRINT. THIS PRINT IS PROVIDED WITH NO CLAIM AS TO PRINT COMPLETENESS, TIMELINESS, ACCURACY OF CONTENT OR USEFULNESS. STATE LAW REQUIRES ANYONE DIGGING, GRADING OR EXCAVATING TO OBTAIN A PRIOR FIELD LOCATE OF ALL UTILITIES; THIS PRINT DOES NOT DISCHARGE THIS REQUIREMENT OR ANY OTHER REQUIREMENT. THE COMPANY AND ITS AFFILIATES ASSUME NO LEGAL RESPONSIBILITY OR LIABILITY FOR THE RECIPIENT'S USE (OR ANY OTHER PARTIES' USE) OF THE PRINT, INCLUDING THE RECIPIENT'S INTENDED PURPOSE IN USING THE PRINT. NO COMPANY EMPLOYEE OR OTHER PARTY HAS BEEN AUTHORIZED TO PROVIDE THIS PRINT FOR PLANNING OR ESTIMATING PURPOSES; RELY ON THIS PRINT AT YOUR OWN RISK. BY ACCEPTING THIS PRINT, THE RECIPIENT & ANY OTHER PARTY RECEIVING A COPY OF THE PRINT ACKNOWLEDGES AND AGREES TO THIS DISCLAIMER. For All Field Locates Call 811