

ESCALATED CABLE FAULT
9555 JUNEAU LN N
MAPLE GROVE

SP823758

PERMIT REQUIRED

SERVICE CENTER: MPALE
GROVE

FEEDER ECK061

PHASE C

VOLTAGE 15 KV

P1 -N6- TERM NEW CABLE (LOOPED)

P2 -P6- TERM NEW CABLE (LOOPED)

S1 -ABANDON EXISTING CABLE, DIR BORE
APPROX. 410' OF NEW #2 AL CABLE.

RESTORATION REQUIRED.

80 9482

9466 9468
9460 9462

9446 9448
9440 9442

DB 5
9428 9426
9420 9422

14729 14727
14723 14721

DISCLAIMER: THERE ARE NO REPRESENTATIONS OR WARRANTIES (EXPRESS OR IMPLIED) ABOUT THE ACCURACY OF THIS PRINT. THIS PRINT IS PROVIDED WITH NO CLAIM AS TO PRINT COMPLETENESS, TIMELINESS, ACCURACY OF CONTENT OR USEFULNESS. STATE LAW REQUIRES ANYONE DIGGING, GRADING OR EXCAVATING TO OBTAIN A PRIOR FIELD LOCATE OF ALL UTILITIES; THIS PRINT DOES NOT DISCHARGE THIS REQUIREMENT OR ANY OTHER REQUIREMENT. THE COMPANY AND ITS AFFILIATES ASSUME NO LEGAL RESPONSIBILITY OR LIABILITY FOR THE RECIPIENT'S USE (OR ANY OTHER PARTIES' USE) OF THE PRINT, INCLUDING THE RECIPIENTS INTENDED PURPOSE IN USING THE PRINT. NO COMPANY EMPLOYEE OR OTHER PARTY HAS BEEN AUTHORIZED TO PROVIDE THIS PRINT FOR PLANNING OR ESTIMATING PURPOSES; RELY ON THIS PRINT AT YOUR OWN RISK. BY ACCEPTING THIS PRINT, THE RECIPIENT & ANY OTHER PARTY RECEIVING A COPY OF THE PRINT ACKNOWLEDGES AND AGREES TO THIS DISCLAIMER. For All Field Locates Call 811

THIS DOCUMENT IS XCEL ENERGY CONFIDENTIALS AND PROPRIETARY INFORMATION AND MAY NOT BE REPRODUCED IN WHOLE, OR IN PART, NOR MAY ANY OF THE INFORMATION CONTAINED HEREIN BE DISCLOSED WITHOUT THE CONSENT OF XCEL ENERGY. CONFIDENTIALS AND PROPRIETARY INFORMATION © 2019 XCEL ENERGY INC. | XCEL ENERGY IS REGISTERED TRADEMARK OF XCEL ENERGY INC

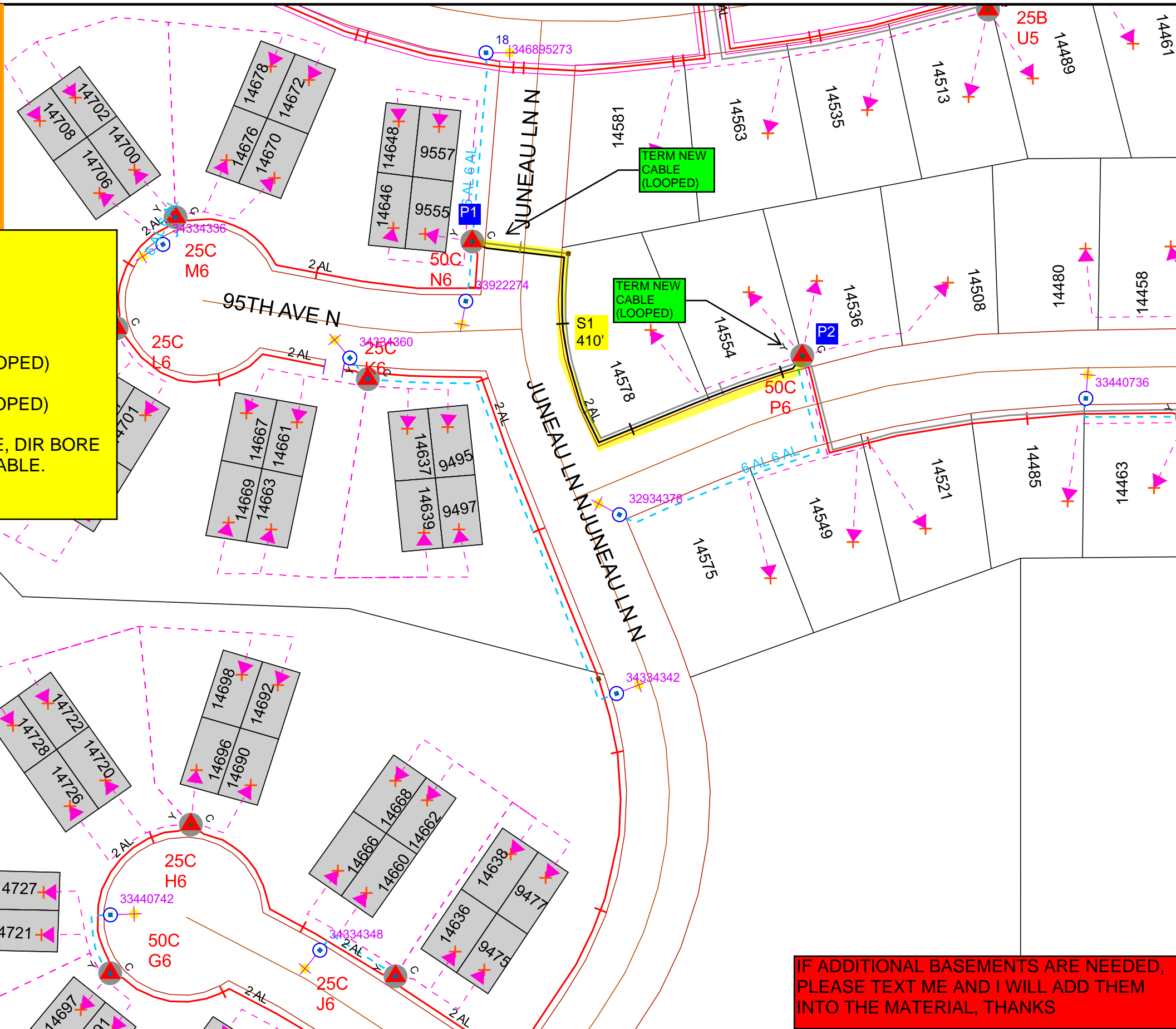

DESIGNER:
JAYMIE HOLTE
EMAIL: JAYMIE.L.HOLTE@XCELENERGY.COM
PHONE: 608-799-3001

Work Order Information	
Service Request #	: 000014751801
Design Number	: 000001184189
Designer/Planner ID	: W37797
Designer/Planner Name	: J. HOLTE
Designer/Planner Ph #	: 608-799-3001
Manager Approval	:

Joint Utility	
E:	G:
T:	C:

Design Location	
Division	: Maple Grove
County	: Hennepin
City	: Maple Grove
Address	:
T: 119N	R: 22W S: 9
Map #	: K52025 Permit :

Electric	
Feeder: ECK061	Voltage: 15 KV
Phase: C PHASE	Bkup Dev ID:

Gas	
System	: Pressure :
Size	: Material :
Dead End	:

Work Order # :
Date: 08/19/2024
Sketch: 1 OF 1
Scale: 1" equals 83'



CONSTRUCTION USE ONLY
 NO CHANGES (BUILT AS DESIGNED)
 CHANGES MADE AS INDICATED
(ALL URD MUST HAVE ACTUAL MEASUREMENTS FROM THE FIELD SITE)

RFO _____
FOREMAN _____ DATE _____
TEAM LEADER _____