

**ESCALATED CABLE FAULT**  
 10570 SUMTER LN  
 BLOOMINGTON

SP822648

PERMIT REQUIRED

SERVICE CENTER: EDINA

**FEEDER ECK082**

**PHASE A**

**VOLTAGE 15 KV**

**P1 -L- TERM NEW CABLE (LOOPED)**

**P2 -M-REPLACE TRANSFORMER & BASEMENT, TERM NEW CABLE (LOOPED)**

**S1 -ABANDON EXISTING CABLE, DIR BORE APPROX. 550' OF NEW #2 AL CABLE.**

**RESTORATION REQUIRED.**



**DESIGNER:**  
 JAYMIE HOLTE  
 EMAIL: JAYMIE.L.HOLTE@XCELENERGY.COM  
 PHONE: 608-799-3001

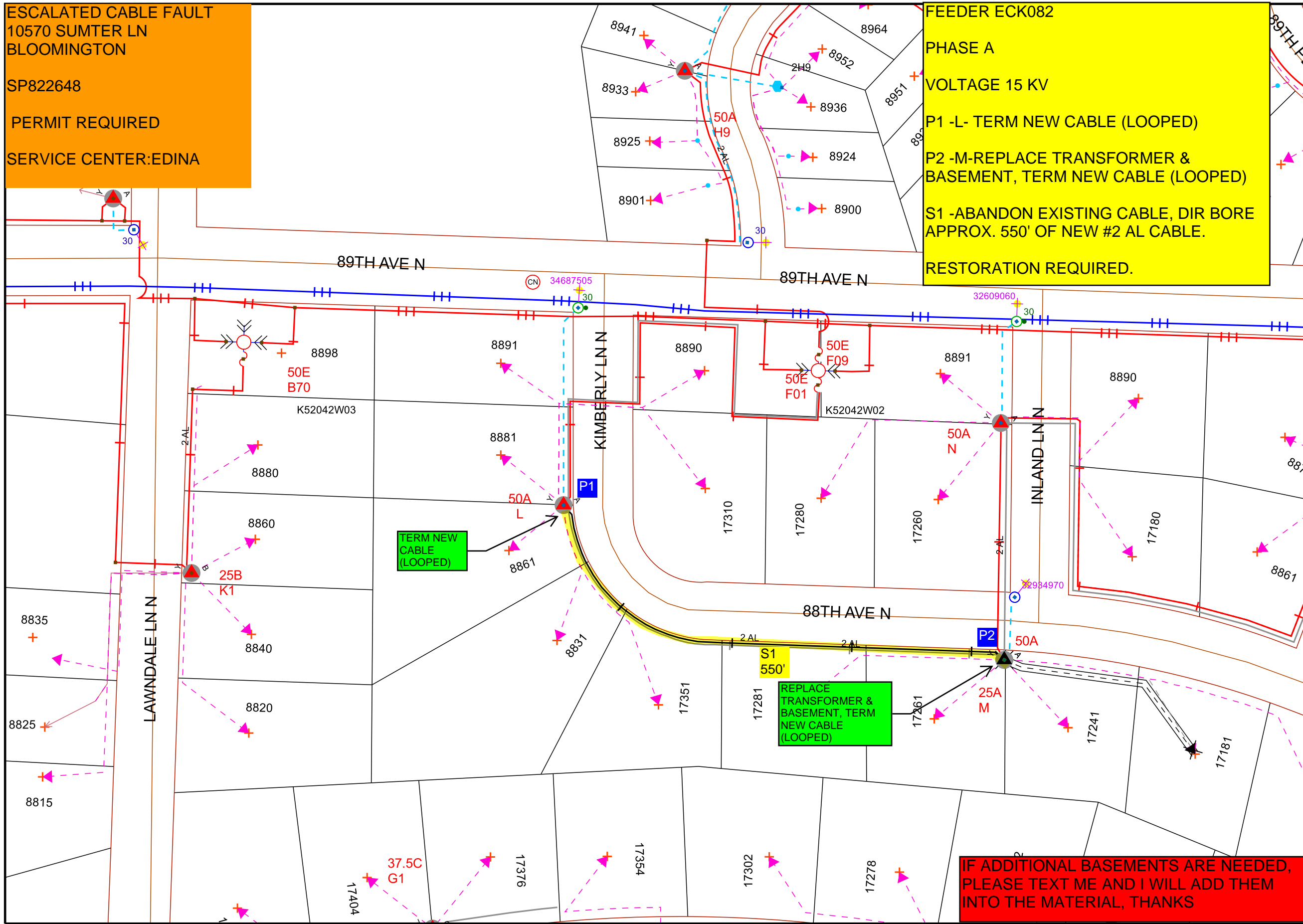

Work Order Information	
Service Request #	: 000014691945
Design Number	: 000001181583
Designer/Planner ID	: W37797
Designer/Planner Name	: J. HOLTE
Designer/Planner Ph #	: 608-799-3001
Manager Approval	: _____

Joint Utility	
E:	G:
T:	C:

Design Location	
Division	: Maple Grove
County	: Hennepin
City	: Maple Grove
Address	:
T: 119N	R: 22W S: 17
Map #	: K52042 Permit :

Electric	
Feeder: ECK082	Voltage: 15 KV
Phase: A PHASE	Bkup Dev ID:

Gas	
System	: Pressure :
Size	: Material :
Dead End	:

Work Order # : \_\_\_\_\_

Date: 07/24/2024

Sketch: 1 OF 1

Scale: 1" equals 100'

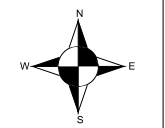

**IF ADDITIONAL BASEMENTS ARE NEEDED, PLEASE TEXT ME AND I WILL ADD THEM INTO THE MATERIAL, THANKS**

**CONSTRUCTION USE ONLY**

NO CHANGES (BUILT AS DESIGNED)

CHANGES MADE AS INDICATED (ALL URD MUST HAVE ACTUAL MEASUREMENTS FROM THE FIELD SITE)

RFO \_\_\_\_\_

FOREMAN \_\_\_\_\_ DATE \_\_\_\_\_

TEAM LEADER \_\_\_\_\_

DISCLAIMER: THERE ARE NO REPRESENTATIONS OR WARRANTIES (EXPRESS OR IMPLIED) ABOUT THE ACCURACY OF THIS PRINT. THIS PRINT IS PROVIDED WITH NO CLAIM AS TO PRINT COMPLETENESS, TIMELINESS, ACCURACY OF CONTENT OR USEFULNESS. STATE LAW REQUIRES ANYONE DIGGING, GRADING OR EXCAVATING TO OBTAIN A PRIOR FIELD LOCATE OF ALL UTILITIES; THIS PRINT DOES NOT DISCHARGE THIS REQUIREMENT OR ANY OTHER REQUIREMENT. THE COMPANY AND ITS AFFILIATES ASSUME NO LEGAL RESPONSIBILITY OR LIABILITY FOR THE RECIPIENT'S USE (OR ANY OTHER PARTIES' USE) OF THE PRINT, INCLUDING THE RECIPIENTS INTENDED PURPOSE IN USING THE PRINT. NO COMPANY EMPLOYEE OR OTHER PARTY HAS BEEN AUTHORIZED TO PROVIDE THIS PRINT FOR PLANNING OR ESTIMATING PURPOSES; RELY ON THIS PRINT AT YOUR OWN RISK. BY ACCEPTING THIS PRINT, THE RECIPIENT & ANY OTHER PARTY RECEIVING A COPY OF THE PRINT ACKNOWLEDGES AND AGREES TO THIS DISCLAIMER. For All Field Locates Call 811