

10507 WELLINGTON LN N MAPLE GROVE, MN
 WO: 112295529
 UG CONSTRUCTION

UG FAULT. BORE IN NEW SECONDARY CABLE AND CONDUIT.

INSTALL:
 279' #6 DUPLEX SECONDARY CABLE
 279' 1 1/2" CONDUIT

ABANDON:
 279' SECONDARY CABLE

RESTORATION

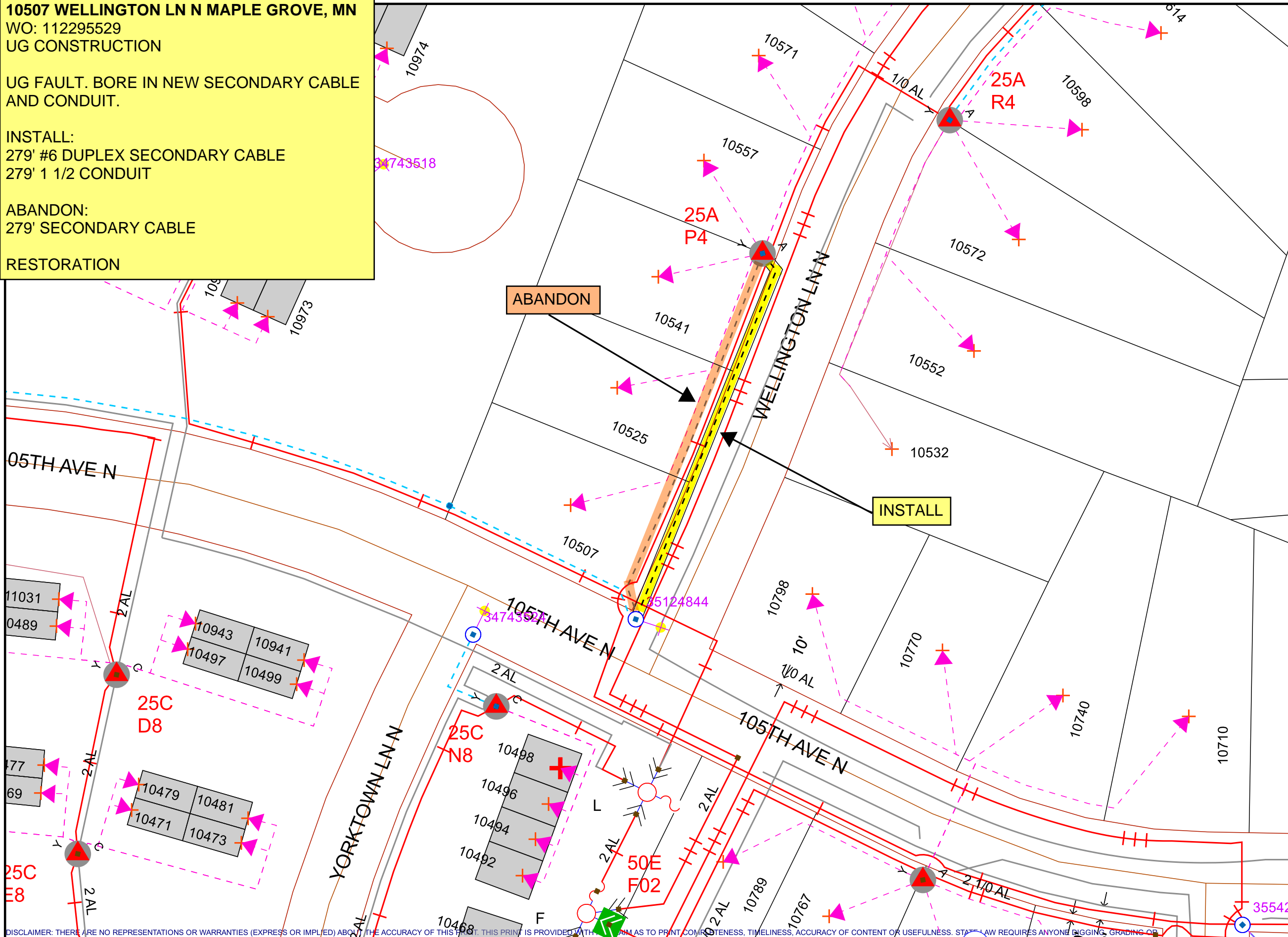

Work Order Information

Service Request #	: 000014680855
Design Number	: 000001180918
Designer/Planner ID	: 243934
Designer/Planner Name	:
Designer/Planner Ph #	: 612-346-2952
Manager Approval	:

Joint Utility

E:	G:
T:	C:

Design Location

Division	: Maple Grove		
County	: Hennepin		
City	: Maple Grove		
Address	: 10507 WELLINGTON LN N		
T: 119N	R: 22W	S: 1	
Map #	: K51090	Permit	:

Electric

Feeder:	Voltage:
Phase:	Bkup Dev ID:

Gas

System	: Pressure	:
Size	: Material	:
Dead End	:	

Work Order # :

Date: 07/17/2024

Sketch: #1 Of #1 Sketch Data

Scale: 1" equals 67'



CONSTRUCTION USE ONLY

- NO CHANGES (BUILT AS DESIGNED)
- CHANGES MADE AS INDICATED (ALL URD MUST HAVE ACTUAL MEASUREMENTS FROM THE FIELD SITE)

RFO _____
 FOREMAN _____ DATE _____
 TEAM LEADER _____

DISCLAIMER: THERE ARE NO REPRESENTATIONS OR WARRANTIES (EXPRESS OR IMPLIED) ABOUT THE ACCURACY OF THIS PRINT. THIS PRINT IS PROVIDED WITHIN THE SCOPE OF THE CONTRACT AND IS NOT TO BE USED FOR ANY OTHER PURPOSE. THE COMPANY AND ITS AFFILIATES ASSUME NO LEGAL RESPONSIBILITY OR LIABILITY FOR THE RECIPIENT'S USE (OR ANY OTHER PARTIES' USE) OF THE PRINT, INCLUDING THE RECIPIENT'S INTENDED PURPOSE IN USING THE PRINT. NO COMPANY EMPLOYEE OR OTHER PARTY HAS BEEN AUTHORIZED TO PROVIDE THIS PRINT FOR PLANNING OR ESTIMATING PURPOSES; RELY ON THIS PRINT AT YOUR OWN RISK. BY ACCEPTING THIS PRINT, THE RECIPIENT & ANY OTHER PARTY RECEIVING A COPY OF THE PRINT ACKNOWLEDGES AND AGREES TO THIS DISCLAIMER. For All Field Locates Call 811