

EUC STRUCTURAL:
 SEE ATTACHED DOC
 INSTALL TWO NEW 10'X20' MANHOLES OUTSIDE SUBSTATION. MH 2136 & 2137.
 CONNECT WITH 12-WAY DUCT.
 INSTALL 12-WAY DUCT FROM MH 2137 TO MH 2488.
 INSTALL 12-WAY DUCT FROM MH 2137 TO MH 6007.
 REBUILD MH 6007 TP 10'20';
 INSTALL 16-WAY DUCT FROM MH 6007 TO MH 2489.
 INSTALL NEW 11'X12' MH 2138.
 INSTALL 16-WAY DUCT FROM MH 6007 TO MH 2138.
 INSTALL FOUR 6" CONDUITS FROM MH 6007 TO L02 AND FOUR 6" CONDUITS TO L01.
 INSTALL TWO 6" CONDUITS FROM MH 2138 TO L03.

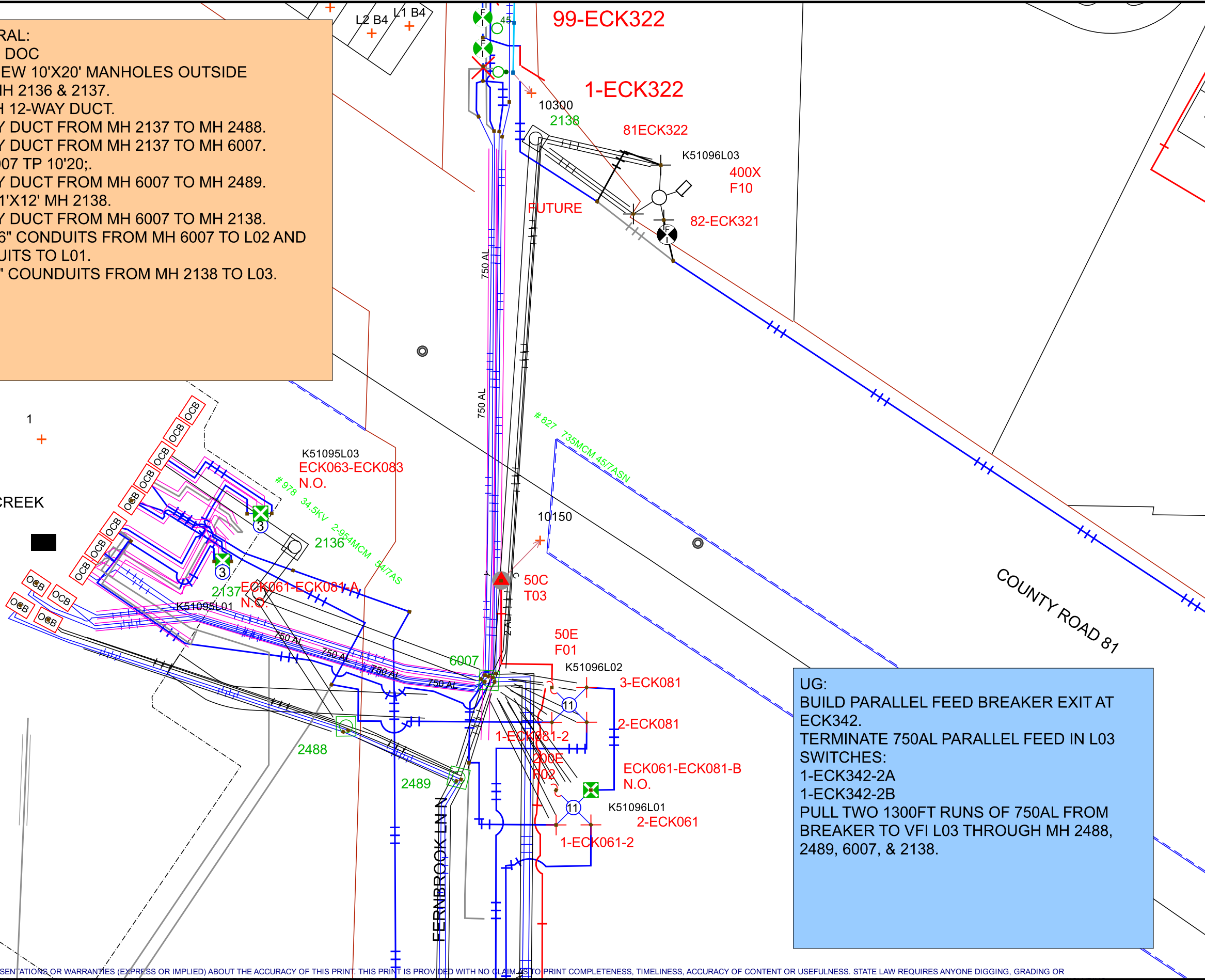

UG:
 BUILD PARALLEL FEED BREAKER EXIT AT ECK342.
 TERMINATE 750AL PARALLEL FEED IN L03 SWITCHES:
 1-ECK342-2A
 1-ECK342-2B
 PULL TWO 1300FT RUNS OF 750AL FROM BREAKER TO VFI L03 THROUGH MH 2488, 2489, 6007, & 2138.



DESIGNER:
 JOSH WUBBENA
 C: 763.350.6346

Work Order Information	
Service Request #	: 000012918068
Design Number	: 000001062672
Designer/Planner ID	: WBBJ96
Designer/Planner Name	: JOSH WUBBENA
Designer/Planner Ph #	: 763.493.1649
Manager Approval	: _____

Joint Utility	
E:	G:
T:	C:

Design Location	
Division	: Maple Grove
County	: Hennepin
City	: Maple Grove
Address	: ELM CREEK SUBSTATION
T: 119N	R: 22W S: 3
Map #	: K51096 Permit :

Electric	
Feeder: ECK342	Voltage: 34500
Phase: ABC	Bkup Dev ID:

Gas	
System :	Pressure :
Size :	Material :
Dead End :	

Work Order # : _____

Date: 06/29/2023
 Sketch: 1 Of 1 Sketch Data
 Scale: 1" equals 100'

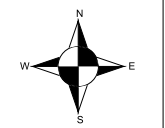

CONSTRUCTION USE ONLY
 NO CHANGES (BUILT AS DESIGNED)
 CHANGES MADE AS INDICATED (ALL URD MUST HAVE ACTUAL MEASUREMENTS FROM THE FIELD SITE)

RFO _____
 FOREMAN _____ DATE _____
 TEAM LEADER _____

DISCLAIMER: THERE ARE NO REPRESENTATIONS OR WARRANTIES (EXPRESS OR IMPLIED) ABOUT THE ACCURACY OF THIS PRINT. THIS PRINT IS PROVIDED WITH NO CLAIM AS TO PRINT COMPLETENESS, TIMELINESS, ACCURACY OF CONTENT OR USEFULNESS. STATE LAW REQUIRES ANYONE DIGGING, GRADING OR EXCAVATING TO OBTAIN A PRIOR FIELD LOCATE OF ALL UTILITIES. THIS PRINT DOES NOT DISCHARGE THIS REQUIREMENT OR ANY OTHER REQUIREMENT. THE COMPANY AND ITS AFFILIATES ASSUME NO LEGAL RESPONSIBILITY OR LIABILITY FOR THE RECIPIENT'S USE (OR ANY OTHER PARTIES' USE) OF THE PRINT, INCLUDING THE RECIPIENT'S INTENDED PURPOSE IN USING THE PRINT. NO COMPANY EMPLOYEE OR OTHER PARTY HAS BEEN AUTHORIZED TO PROVIDE THIS PRINT FOR PLANNING OR ESTIMATING PURPOSES; RELY ON THIS PRINT AT YOUR OWN RISK. BY ACCEPTING THIS PRINT, THE RECIPIENT & ANY OTHER PARTY RECEIVING A COPY OF THE PRINT ACKNOWLEDGES AND AGREES TO THIS DISCLAIMER. For All Field Locates Call 811