

SILVER CREEK TOWNHOUSES

MAPLE GROVE

ELECTRIC LAYOUT

WO 111527894

PROJECT NOTES:
 INSTALL 1/0 AL PRIMARY IN JOINT TRENCH WITH, PHONE AND CATV IN UTILITY EASEMENT(SEE PLAT) SPLICE ON TO EXSTING 3 PHASE PRIMARY WITH B PHASE PRIMARY WITH 1/0AL TO 1/0AL SPLICE (SEE LAYOUT) RUN B PHASE PRIMARY TO LBC CABINET(SEE LAYOUT). RUN B PHASE PRIMARY FROM LBC CABINET BACK TO 1/0AL TO 1/0 AL SPLICE (SEE LAYOUT). SPLICE BACK ONTO EXISTING 3PHASE PRIMARY WITH B PHASE (SEE LAYOUT). TAP OUT OF LBC CABINET WITH 65E FUSE AND LOOP PRIMARY THROUGH DEVELOPMENT (SEE LAYOUT). LEAVE A PRIMARY COIL FOR FUTURE USE. (SEE LAYOUT)

DEVELOPER TO STAKE ALL BUILDING CORNERS, TRANSFORMER & PEDISTAL LOCATIONS. MARK ALL SIDEWALKS.

MAP BOUNDARIES:
 K52078
 K52068

FEEDER:
 ECK321

FEEDER VOLTAGE:
 35kV (19.9kV)

PHASE:
 B

LONGEST SVC RUN:
 <250'

SIDEWALKS: _____

UG MATERIALS:
 50KV XFRMR= 3
 PEDS=4
 1/0 AL PRIMARY=1,240' FT
 350 AL SECONDARY=550' FT

DESIGNER:
 RYAN K. PETERSON
EMAIL:
 RYAN.K.PETERSON@XCELENERGY.COM
CELL: 651-677-1932
SERVICE DESIGNER:
 ALEX SHIMCO
 ALEX.A.SHIMCO@XCELENERGY.COM
PHONE:
 715-418-3007
DEVELOPER:
 BRENNAN CONSTRUCTION
EMAIL:
 RKRIESEL@BCOFMN.COM
PHONE:
 507-250-4846

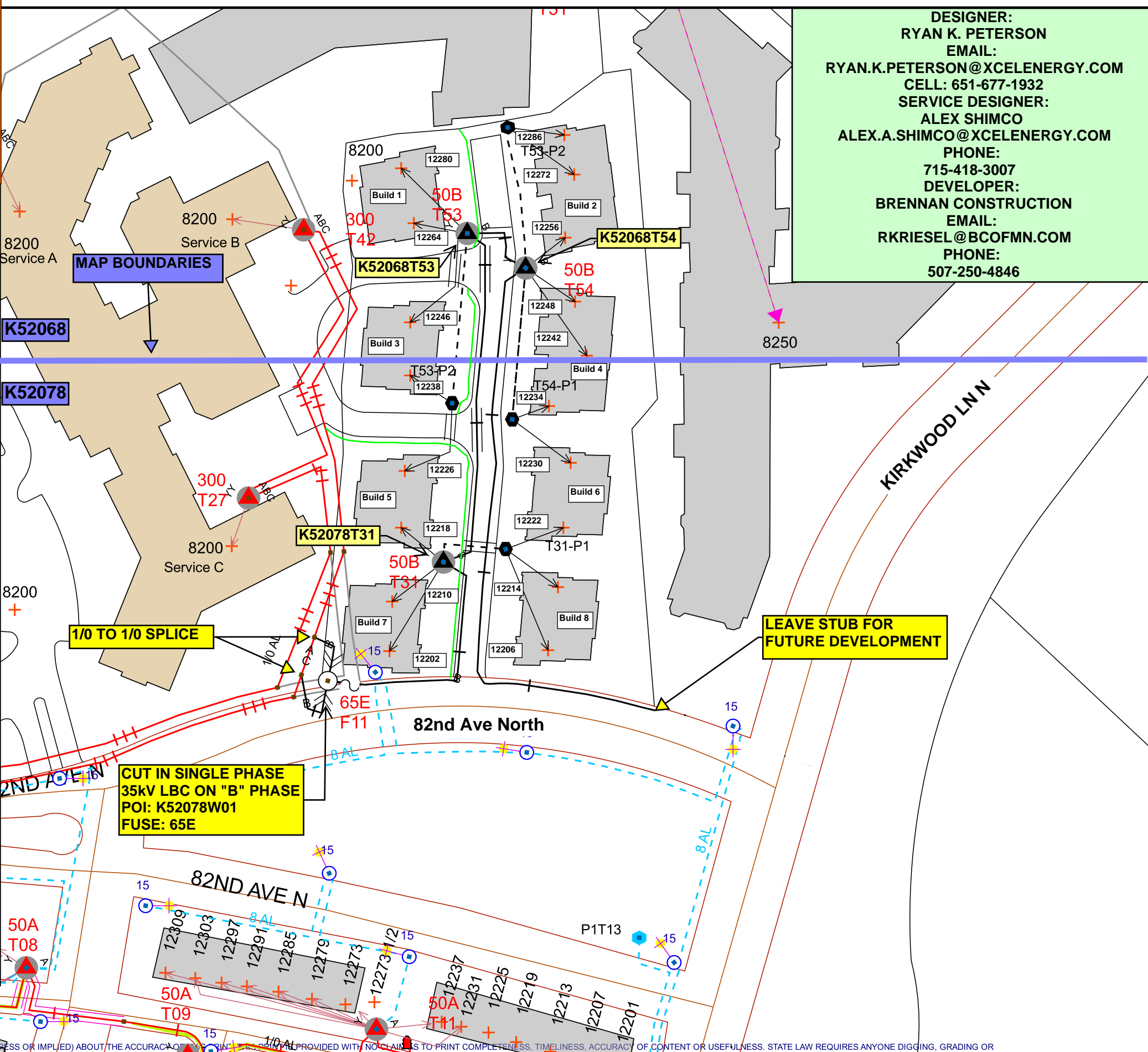
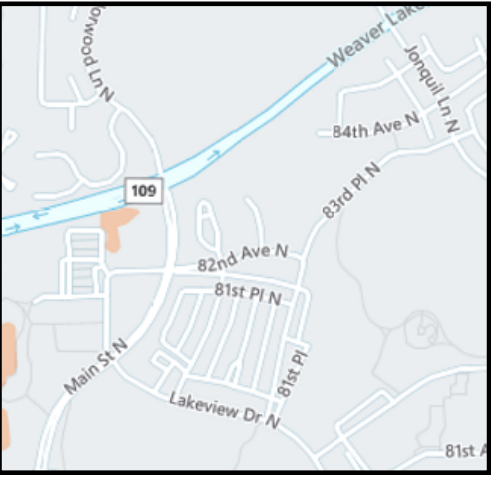

Work Order Information	
Service Request #	: 000014142133
Design Number	: 000001159519
Designer/Planner ID	: 313243
Designer/Planner Name	: RYAN K. PETERSON
Designer/Planner Ph #	: 651-677-1932
Manager Approval	: _____

Joint Utility	
E:	G:
T:	C:

Design Location	
Division	: Maple Grove
County	: Hennepin
City	: Maple Grove
Address	:
T: 119N	R: 22W S: 23
Map #	: K52078 Permit :

Electric	
Feeder: ECK321	Voltage: 35kV (19.9kV)
Phase: B PHASE	Bkup Dev ID:

Gas	
System	: Pressure :
Size	: Material :
Dead End	:

Work Order # :
 Date: 03/12/2024
 Sketch: # Of # Sketch Data
 Scale: 1" equals 84'

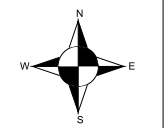

- CONSTRUCTION USE ONLY**
- NO CHANGES (BUILT AS DESIGNED)
 - CHANGES MADE AS INDICATED (ALL URD MUST HAVE ACTUAL MEASUREMENTS FROM THE FIELD SITE)

RFO _____
 FOREMAN _____ DATE _____
 TEAM LEADER _____

DISCLAIMER: THERE ARE NO WARRANTIES (EXPRESS OR IMPLIED) ABOUT THE ACCURACY OF THE INFORMATION PROVIDED WITH THIS PRINT. THE COMPANY AND ITS AFFILIATES ASSUME NO LEGAL RESPONSIBILITY OR LIABILITY FOR THE RECIPIENT'S USE (OR ANY OTHER PARTIES' USE) OF THE PRINT, INCLUDING THE RECIPIENT'S INTENDED PURPOSE IN USING THE PRINT. NO COMPANY EMPLOYEE OR OTHER PARTY HAS BEEN AUTHORIZED TO PROVIDE THIS PRINT FOR PLANNING OR ESTIMATING PURPOSES; RELY ON THIS PRINT AT YOUR OWN RISK. BY ACCEPTING THIS PRINT, THE RECIPIENT & ANY OTHER PARTY RECEIVING A COPY OF THE PRINT ACKNOWLEDGES AND AGREES TO THIS DISCLAIMER. For All Field Locates Call 811

THIS DOCUMENT IS XCEL ENERGY CONFIDENTIALS AND PROPRIETARY INFORMATION AND MAY NOT BE REPRODUCED IN WHOLE, OR IN PART, NOR MAY ANY OF THE INFORMATION CONTAINED HEREIN BE DISCLOSED WITHOUT THE CONSENT OF XCEL ENERGY. CONFIDENTIALS AND PROPRIETARY INFORMATION © 2019 XCEL ENERGY INC. | XCEL ENERGY IS REGISTERED TRADEMARK OF XCEL ENERGY INC