

USI CONTACT INFO:

Richard Miske
651-764-1411
rmiske@usi-universal.com

COMCAST CONTACT INFO:

Peter Drangeid
651-724-7815
peter_drangeid@cable.comcast.com

Comcast to Perform Fiber Splicing -
USI to Perform Const. & Coax Splicing

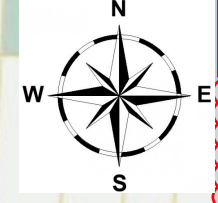

Green Lin = New Underground Placement	
Yellow Line = Existing Conduit	
Blue Line = Aerial Placement	
New Fiber Vault	
Existing Fiber Vault	
New Pedestal	
Existing Pedestal	

Change to Doghouse Ped

Change to Doghouse Ped

Change to Doghouse Ped

Change to Doghouse Ped

Change to Doghouse Ped

E11, P2 - Permit Walkout >
300' Non-complex
(ROW - 300' =)

Change to Doghouse Ped

Change to Doghouse Ped

Change to Doghouse Ped

Change to Doghouse Ped

Change to Doghouse Ped

Change to Doghouse Ped

Change to Doghouse Ped

Change to Doghouse Ped

Proactive - T2A - NONE - MNMGD07Q00 1x2
 (DA141 2x2) Housing Swap w/amp Upgrade
 18310 82nd PI N Maple Grove, MN

USI CONTACT INFO:
 Richard Miske
 651-764-1411
 rmiske@usi-universal.com

COMCAST CONTACT INFO:
 Peter Drangid
 651-724-7815
 peter_drangid@cable.comcast.com

Comcast to Perform Fiber Splicing -
 USI to Perform Const. & Coax Splicing

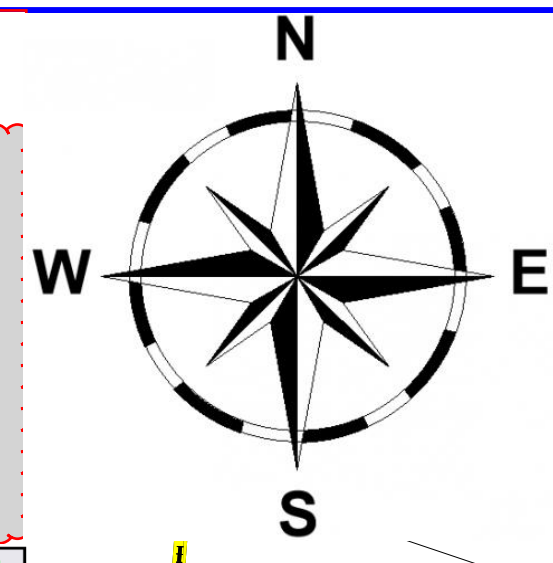

Green Lin = New Underground Placement
 Yellow Line = Existing Conduit
 Blue Line = Aerial Placement
 New Fiber Vault
 Existing Fiber Vault
 New Pedestal
 Existing Pedestal

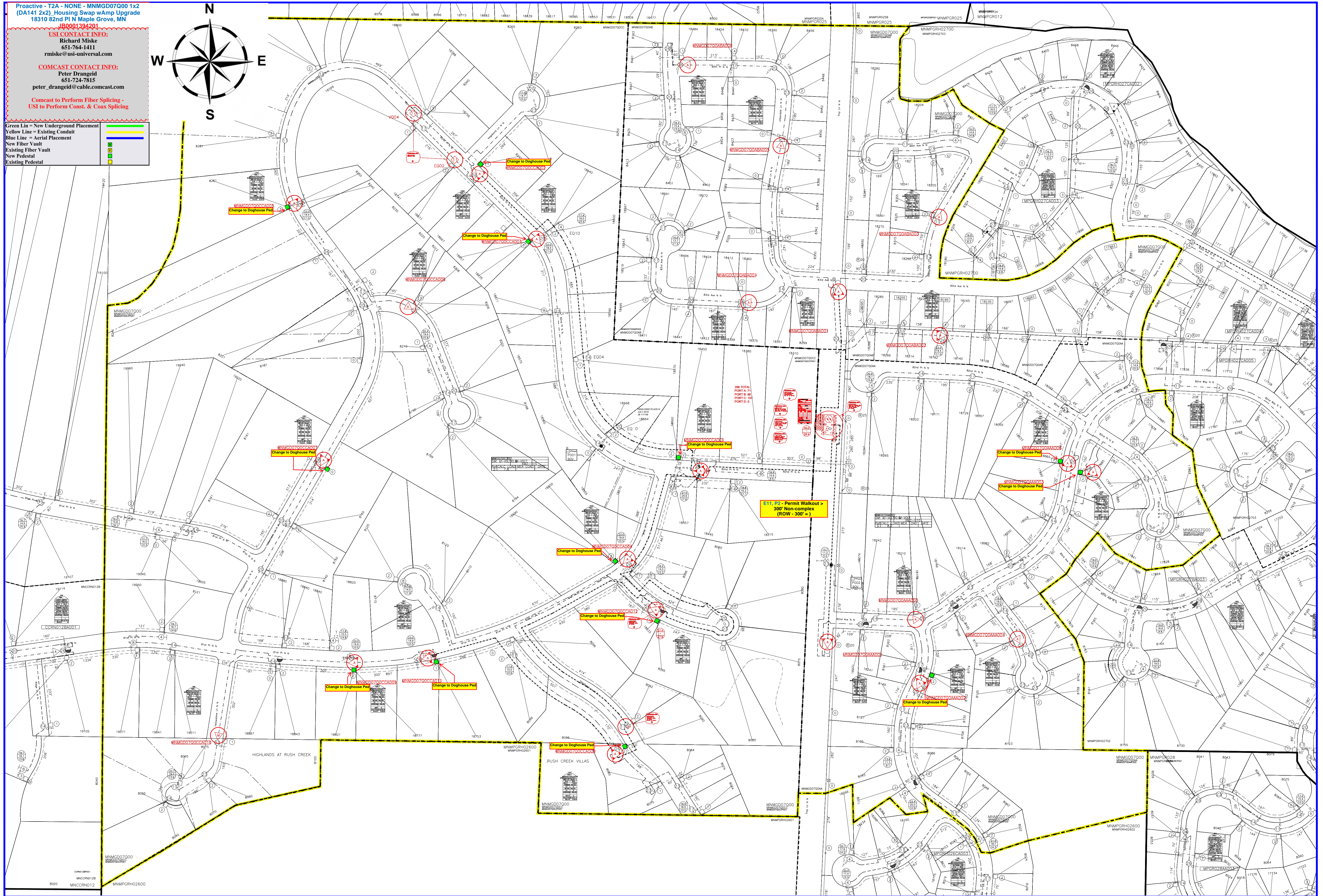

MNMGD07Q00
 MNMG
 MAPLE GROVE, MN

Rev	Date	Description	Rev	Date	Description	Rev	Date	Description	Rev	Date	Description
01	05/18/2023	DSN JB0001394201 MNMGD07Q00 (MNMGD07Q00) NODE UPGRADE (QUASAR)									

