



PROPRIETARY AND CONFIDENTIAL

PROJECT #: **WO #111812345**

CITY: MAPLE GROVE

COUNTY: HENNEPIN

**LEGEND:**

- IN SERVICE
- PROPOSED
- PROPOSED ABANDONED
- ABANDONED
- NOT A PART OF PROJECT  
SEE NOTES

**PIPE SUMMARY**

857' 2" PE CL-6

857' TOTAL PIPE

COPIES:  
PIPELINE INTEGRITY PACKET: N  
STATION MANAGER: N  
DD NUMBER: NA  
CORROSION: NA  
EMP: N

SITE CONTACT: MIKE ZABACK  
PROJECT MANAGER  
507-995-9177

SURVEYOR REQUIRED? N

RETURN PACKET TO ENG? N

JOB BRIEFING REQUIRED? N

GFIP #: NA

PERMITS: CITY OF MAPLE GROVE

PROJECT DESCRIPTION: NBRE  
SILVER CREEK TOWNHOMES

DESIGNER: CAMERON VICTOR  
PHONE #: 612-321-5347  
DRAWN BY: CAMERON VICTOR  
DESIGN DATE: 04/22/2024

**REVISION INFO:**

MAIN SS#: SCALE: 1"=50'  
SHEET 1 OF 1

# DUAL MAIN IN UTILITY EASEMENT

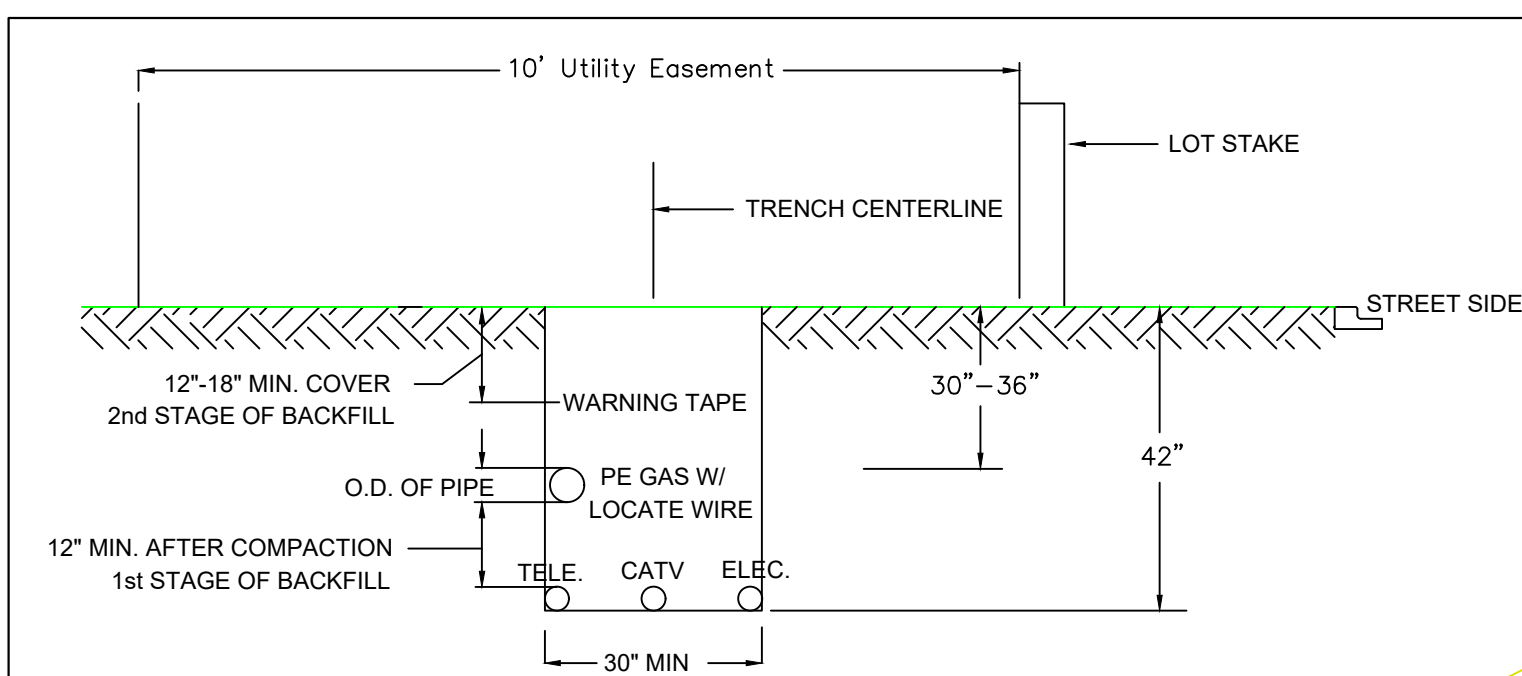

**CUSTOMER APPROVAL INSTALL:**

SIGNATURE: \_\_\_\_\_ TITLE: \_\_\_\_\_  
PRINTED NAME: \_\_\_\_\_ DATE: \_\_\_\_\_

The running line for natural gas main is approved, the site is within 6" of final grade, and ready for installation. Any and all private crossings have been clearly marked on site. I acknowledge that any alterations to the natural gas main that are needed after installation will be at the **Builder's/Developer's expense.**

**NOTE: BORE ALL PAVED STREETS AND DRIVEWAYS**  
Minimum depth requirements for crossings of state highways and county roads is 60". Minimum depth requirements for crossings of city streets and township roads is 48". Minimum depth for parallel installations on state highways and county roads is 36". Minimum depth for parallel installations on city streets and township roads is 30". All steel pipe welds to be coated with 2 part epoxy.

INSTALL LOCATING POINTS AT A MAXIMUM SPACING OF 1,000 FT.

INSTALL 2" PE CL-6 ~ JOINT TRENCH - WITHIN TOWNHOME DEVELOPMENT

C = INSTALL 2" PE CAP TO COVER SERVICE

Install: Clean and Test, and Put in Service; Proposed new main per CenterPoint Energy Construction and Service Manual.

Purge new main until essentially 100% gas reading is obtained on Combustible Gas Indicator. See CenterPoint Energy Construction and Service Manual Section CS-B-1.230 for purging mains into service.

Install a marker ball at a new end of main, at a valve, at each ell of a horizontal offset, at road crossings and at any fitting or pressure control identified as needing to be located in the future. Refer to CenterPoint Energy Construction and Service Manual section CS-B-1.310 for installation procedures.

Procedure for tapping or making tie-ins to existing gas mains: Verify existing gas main size, type, and location prior to tapping or making tie-in. Monitor and verify, using a pressure gauge, existing gas main Pressure Class within the bell hole of tap location or tie-in location prior to tapping or making tie-in.

I hereby certify that this plan, specification, or report was prepared by me or under my direct supervision and that I am a duly Licensed Professional Engineer under the laws of the state of Minnesota.

Signature: Eric Yang  
Typed or Printed Name: Eric Yang  
Date: 4/25/2024 License Number: 56613

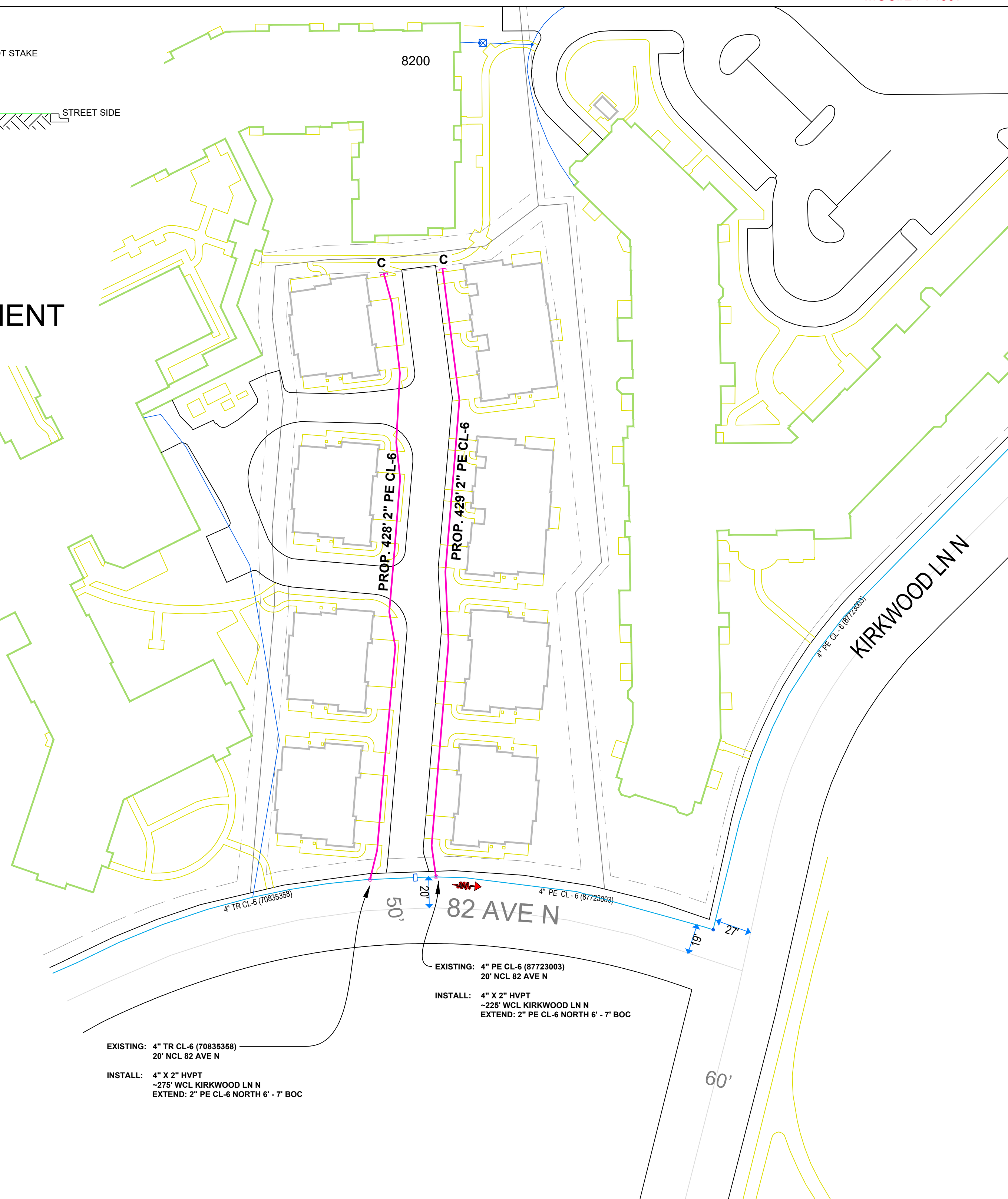

4/24/2024 2:26:08 PM