

ADA CONTROL POINTS			
POINT NO.	X COORD. (EAST)	Y COORD. (NORTH)	ELEV. OR RADIUS
P5000	466294.442	218500.548	EX.
P5001	466302.317	218498.736	953.75
P5002	466317.055	218499.630	953.97
P5003	466324.360	218502.242	EX.
P5004	466312.465	218507.662	953.97
P5005	466320.726	218514.926	954.79
P5020	466390.435	218427.622	EX.
P5021	466385.371	218438.098	954.80
P5022	466383.602	218452.451	954.65
P5023	466385.317	218461.900	EX.
P5024	466388.264	218452.175	954.83
P5025	466389.826	218439.497	954.98
P5026	466400.241	218448.739	955.05
P5027	466402.144	218443.367	955.12

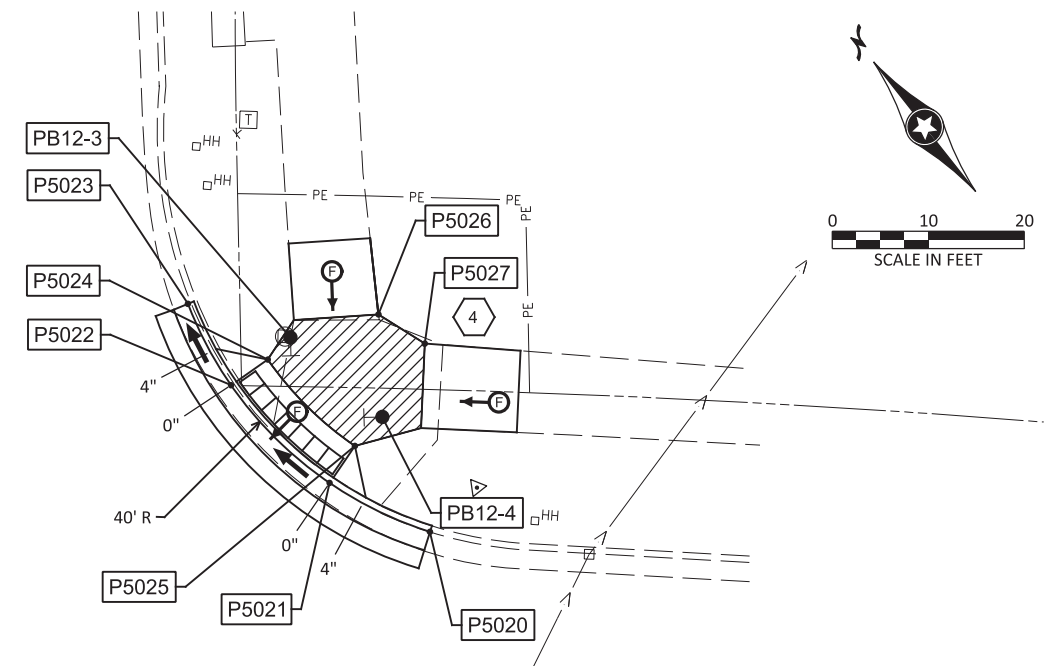

ADA CONTROL POINTS			
POINT NO.	X COORD. (EAST)	Y COORD. (NORTH)	ELEV. OR RADIUS
P5040	466297.345	218358.837	EX.
P5041	466317.860	218369.635	953.12
P5042	466331.435	218370.178	953.28
P5043	466339.287	218368.325	EX.
P5044	466318.836	218365.068	953.40
P5045	466330.826	218365.548	953.56
P5046	466309.837	218355.541	954.19
P5047	466319.347	218358.634	953.48
P5048	466329.361	218357.025	953.67
P5060	466251.032	218437.749	EX.
P5061	466257.474	218429.274	952.58
P5062	466262.415	218414.210	952.85
P5063	466262.557	218406.242	EX.

LEGEND

- PXXXX CONTROL POINTS AT GUTTER FLOW LINE
- TRUNCATED DOMES (SEE STANDARD PLATE 7038)
- CONSTRUCT CONCRETE CURB & GUTTER
- REMOVE AND REPLACE BITUMINOUS PAVEMENT
- X" CURB HEIGHT
- LANDING AREA - 4' X 4' MIN. DIMENSIONS AND MAX. 2.0% SLOPE IN ALL DIRECTIONS
- BITUMINOUS TRAIL
- INDICATES PEDESTRIAN RAMP - SLOPE SHALL NOT EXCEED 8.3% IN THE DIRECTION SHOWN AND CROSS SLOPE SHALL NOT EXCEED 2.0%
- INDICATES PEDESTRIAN RAMP - SLOPE SHALL BE GREATER THAN 2.0% AND LESS THAN 5.0% IN THE DIRECTION SHOWN AND CROSS SLOPE SHALL NOT EXCEED 2.0%
- CROSS SLOPE TRANSITION PANELS
- DRAINAGE FLOW DIRECTION
- RW REFERENCE LINE (NOT SURVEYED)
- TEMPORARY EASEMENT LINE (NOT SURVEYED)
- PERMANENT EASEMENT LINE (NOT SURVEYED)
- PEDESTRIAN PUSH BUTTON STATION

CSAH 101 (TROY LN N)

GENERAL NOTES

ALL CURB AND GUTTER TO BE B624 UNLESS NOTED OTHERWISE.

SAWCUT AT REMOVAL LIMITS OR NEAREST JOINT. ALL SAWCUTS SHALL BE INCIDENTAL.

SEE SHEET 13 FOR CONCRETE WALK TYPICAL SECTION.

CONTRACTOR SHALL VERIFY RADIUS AND ARC LENGTHS NEEDED AT RADIAL DOME CORNERS PRIOR TO ORDERING AND INSTALLING DOMES.

RIGHT OF WAY LINES ARE NOT FROM A SURVEY AND ARE FOR REFERENCE INFORMATION ONLY.

PERMISSION FOR WORK SHOWN OUTSIDE OF THE RIGHT OF WAY IS TO BE OBTAINED VIA RIGHT OF ENTRY BY THE ENGINEER.

PROTECT ALL EXISTING SIGNAL POLES, LIGHTS POLES, POWER POLES, HYDRANTS, RETAINING WALLS, AND OTHER MAJOR INFRASTRUCTURE NOT IDENTIFIED FOR REMOVAL.

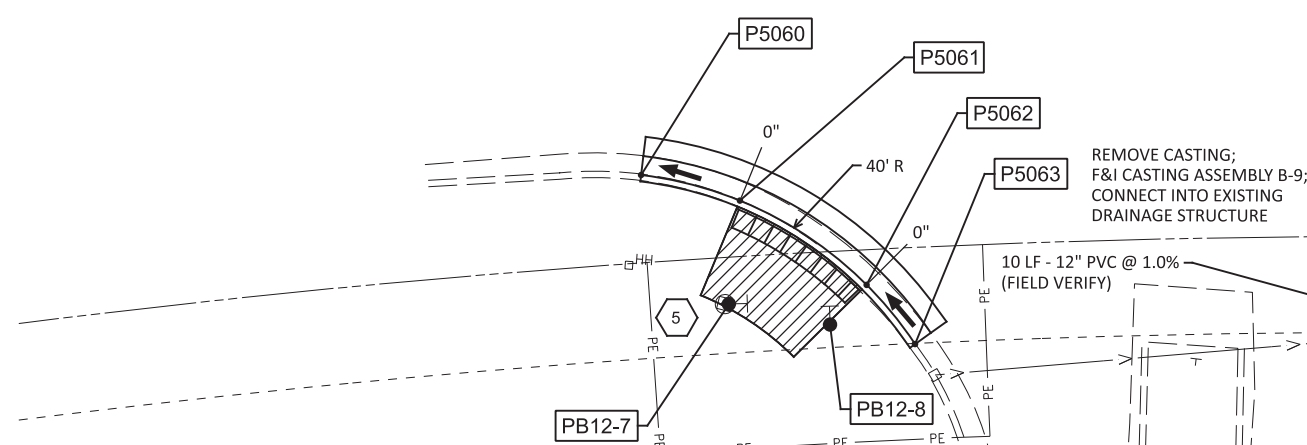

APS CONTROL POINTS				
POINT NO.	X COORD. (EAST)	Y COORD. (NORTH)	DISTANCE TO FRONT OF LANDING (FT.)	DISTANCE TO BACK OF LANDING (FT.)
PB12-1	ON POLE	ON POLE	5.12	7.79
PB12-2	466316.444	218503.405	3.14	0.38
PB12-3	ON POLE	ON POLE	3.30	1.83
PB12-4	466393.913	218440.058	4.13	4.07
PB12-5	466321.854	218359.485	6.04	0.80
PB12-6	466332.422	218361.992	3.90	0.37
PB12-7	ON POLE	ON POLE	9.60	0.40
PB12-8	466256.861	218413.319	4.96	5.06

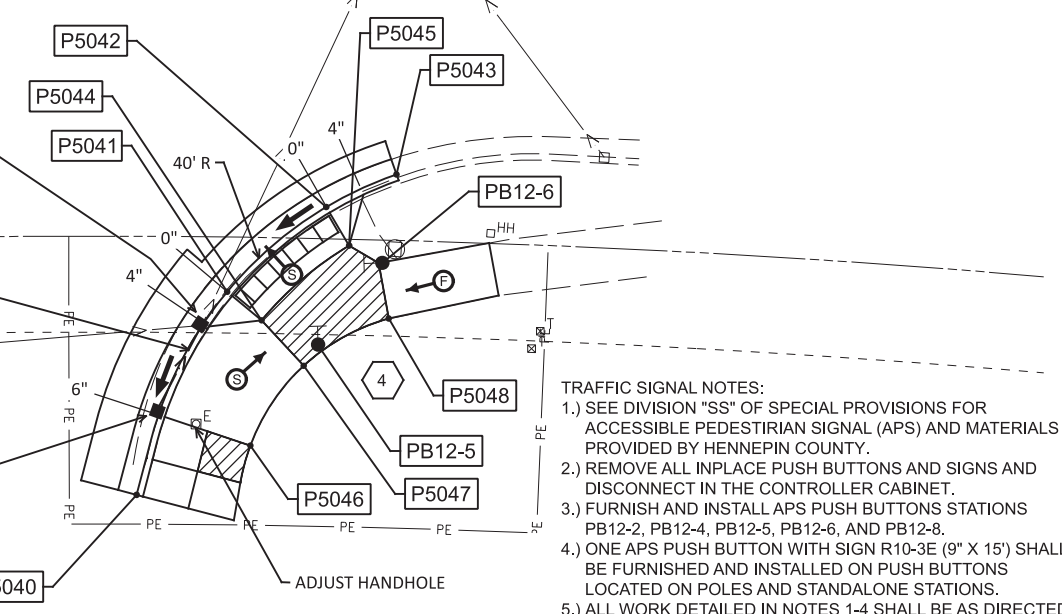

TRAFFIC SIGNAL NOTES:

- SEE DIVISION "SS" OF SPECIAL PROVISIONS FOR ACCESSIBLE PEDESTRIAN SIGNAL (APS) AND MATERIALS PROVIDED BY HENNEPIN COUNTY.
- REMOVE ALL INPLACE PUSH BUTTONS AND SIGNS AND DISCONNECT IN THE CONTROLLER CABINET.
- FURNISH AND INSTALL APS PUSH BUTTON STATIONS PB12-2, PB12-4, PB12-5, PB12-6, AND PB12-8.
- ONE APS PUSH BUTTON WITH SIGN R10-3E (9" X 15") SHALL BE FURNISHED AND INSTALLED ON PUSH BUTTONS LOCATED ON POLES AND STANDALONE STATIONS.
- ALL WORK DETAILED IN NOTES 1-4 SHALL BE AS DIRECTED BY AND TO THE SATISFACTION OF THE FIELD ENGINEER AND ALL COSTS SHALL BE INCLUDED IN THE UNIT PRICE BID FOR REVISE SIGNAL SYSTEM E (SIG SYS).

CONSTRUCT PEDESTRIAN CURB RAMPS PER STANDARD PLANS SEE SHEET 16 TO 21

1 PERPENDICULAR	5 DEPRESSED CORNER
2 TIERED PERPENDICULAR	6 DIAGONAL
3 PARALLEL	7 COMBINED DIRECTIONAL
4 FAN	8 ONE-WAY DIRECTIONAL

	I HEREBY CERTIFY THAT THIS PLAN WAS PREPARED BY ME OR UNDER MY DIRECT SUPERVISION AND THAT I AM A DULY LICENSED PROFESSIONAL ENGINEER UNDER THE LAWS OF THE STATE OF MINNESOTA. BRADY RUTMAN, PROFESSIONAL ENGINEER	DESIGN BY: B. RUTMAN CAD BY: W. GRAY CHECKED BY: N. WILL LAST REVISION:	56607 06/26/2023 LICENSE NO. DATE	INTERSECTION DETAILS PEDESTRIAN RAMP RETROFITS HENNEPIN COUNTY PROJECT 2183344 SAP 027-030-065	SHEET 50 77
	<p style="font-size: small;">6/26/2023 12:50:49 PM H:\Projects\15000\15702\Design\PlanSheets\FinalPlan\15702.in\9L_Phase 4-Csah 101 & 89th Ave.dgn</p>				