

Job Location: Evanswood Phase 3

Narrative/Special Remarks

This project will provide fiber optic services to the Evanswood development phase 3. Work Will consist of placing 1 1/4" duct via joint trench, placing 5 pedestals and pulling fiber optic cables.



DEVELOPER CONTACT

Held Order Information

Service Order # _____ Customer Terminal: _____
 Customer Name: _____ Cable Assignment: _____
 Customer Address: _____ F1: _____
 F2: _____
 Cross Connect: _____

Misc. Information

List all associated projects _____ Right of Way Required YES/NO
 State Permit Required YES/NO
 County Permit Required YES/NO
 City Permit Required YES/NO
 Additional Permit Information _____
 Site Location ID # (BVAPP) _____
 Trench Open Date: DATE: _____
 Cut Sheets: YES/NO _____
 FW Contracts: _____ RZ _____
 CZ _____
 NOTIFY CONVERSATION NUMBER _____

REVISIONS

DATE	REVISION DESCRIPTION

ERFS / ECD Date



REVISION: 01

WC CLLI: MPGVMNXA

EXCEPT AS MAY BE OTHERWISE PROVIDED BY CONTRACT, THESE DRAWINGS AND SPECIFICATIONS SHALL REMAIN THE PROPERTY OF CENTURYLINK BEING ISSUED IN STRICT CONFIDENCE AND SHALL NOT BE REPRODUCED, COPIED, OR USED FOR ANY PURPOSE WITHOUT SPECIFIC WRITTEN PERMISSION.

SECTION: 6

TOWNSHIP: 119

RANGE: 22W

DESC: Evanswood Development Ph 3

PROJECT#: P.229992 WFMT PROJECT:

SCALE: NTS DATE: 4/16/2024 SHEET: 01 OF 02

EXCHANGE KEY:	REMOTE SWITCH EXCHANGE KEY	COMMUNITY NAME NAME: Maple Grove CITY: Maple Grove	ENGINEERING CONTACT NAME: PHONE NUMBER:	CONTRACT ENGINEER NAME: Justin Foth COMPANY: 612-431-3523	CONSTRUCTION COORDINATOR NAME: Chris Thompson PHONE NUMBER:
---------------	----------------------------	--	---	---	---

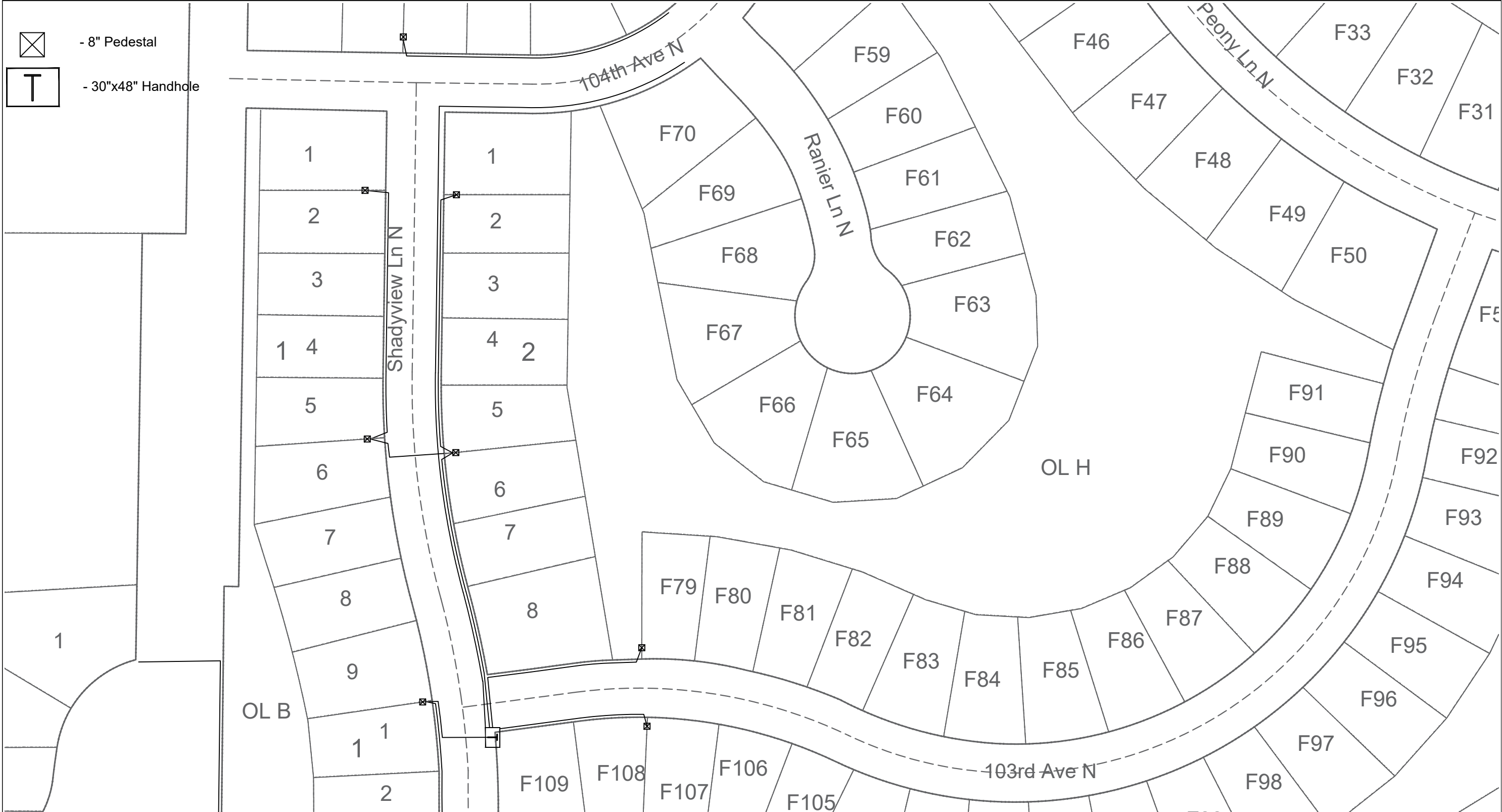

EXCHANGE KEY:		REMOTE SWITCH EXCHANGE KEY	COMMUNITY NAME	ENGINEERING CONTACT	CONTRACT ENGINEER	CONSTRUCTION COORDINATOR	SECTION:	REVISION:	CENTURYLINK EXCEPT AS MAY BE OTHERWISE PROVIDED BY CONTRACT, THESE DRAWINGS AND SPECIFICATIONS SHALL REMAIN THE PROPERTY OF CENTURYLINK BEING ISSUED IN STRICT CONFIDENCE AND SHALL NOT BE REPRODUCED, COPIED, OR USED FOR ANY PURPOSE WITHOUT SPECIFIC WRITTEN PERMISSION.
			NAME: Maple Grove CITY: Maple Grove	NAME: PHONE NUMBER:	NAME: Justin Foth COMPANY: 612-431-3523	NAME: Chris Thompson PHONE NUMBER:	06	01	
							TOWNSHIP:	DATE:	SHEET:
							119	4/16/24	06 OF 08
							RANGE:		
							22W		

REVISIONS	
DATE	DESCRIPTION

