

County Road 30 & new Rush Creek Blvd, Maple Grove
 Project Overview:
 Relocate ECK341 feeder cable and 1/0AL 3 phase tap cable.

WO# 111546582
 Sketch 1/4
 Access: Truck
 Feeder: ECK341



Adam Barthel
 C: 612-368-6427

Work Order Information	
Service Request #	: 000014360528
Design Number	: 000001162775
Designer/Planner ID	: 248845
Designer/Planner Name	:
Designer/Planner Ph #	: (000) 000-0000
Manager Approval	:

Joint Utility	
E:	G:
T:	C:

Design Location	
Division	: Maple Grove
County	: Hennepin
City	: Maple Grove
Address	:
T: 119N	R: 22W S: 7
Map # : K52011	Permit :

Electric	
Feeder:	Voltage:
Phase:	Bkup Dev ID:

Gas	
System	: Pressure :
Size	: Material :
Dead End	:

Work Order # :
 Date: 03/20/2024
 Sketch: # Of # Sketch Data
 Scale: 1" equals 124'

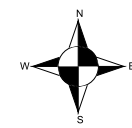

CONSTRUCTION USE ONLY
 NO CHANGES (BUILT AS DESIGNED)
 CHANGES MADE AS INDICATED
 (ALL URD MUST HAVE ACTUAL MEASUREMENTS FROM THE FIELD SITE)

RFO _____
 FOREMAN _____ DATE _____
 TEAM LEADER _____

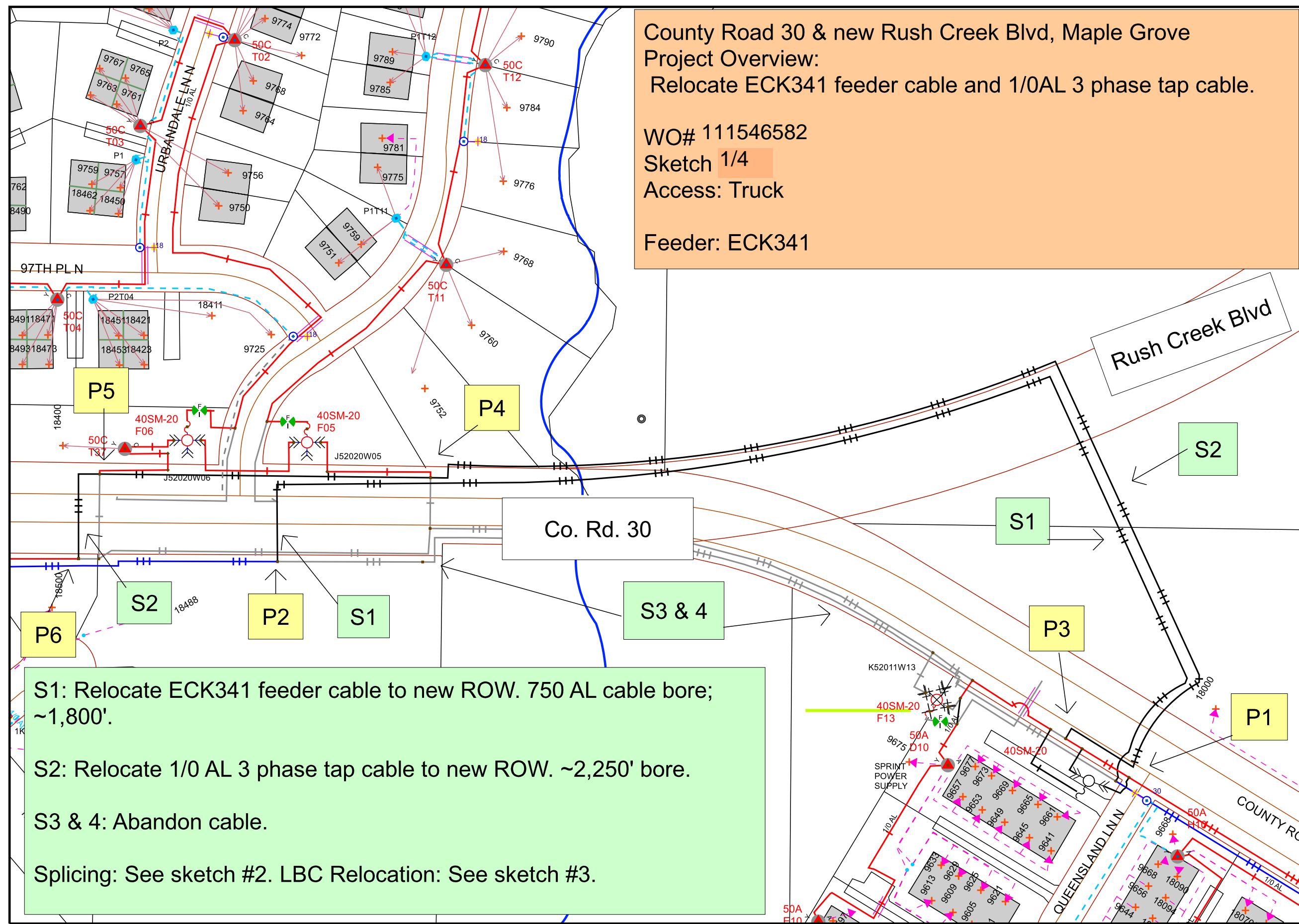

S1: Relocate ECK341 feeder cable to new ROW. 750 AL cable bore; ~1,800'.
 S2: Relocate 1/0 AL 3 phase tap cable to new ROW. ~2,250' bore.
 S3 & 4: Abandon cable.
 Splicing: See sketch #2. LBC Relocation: See sketch #3.

DISCLAIMER: THERE ARE NO REPRESENTATIONS OR WARRANTIES (EXPRESS OR IMPLIED) ABOUT THE ACCURACY OF THIS PRINT. THIS PRINT IS PROVIDED WITH NO CLAIM AS TO PRINT COMPLETENESS, TIMELINESS, ACCURACY OF CONTENT OR USEFULNESS. STATE LAW REQUIRES ANYONE DIGGING, GRADING OR EXCAVATING TO OBTAIN A PRIOR FIELD LOCATE OF ALL UTILITIES; THIS PRINT DOES NOT DISCHARGE THIS REQUIREMENT OR ANY OTHER REQUIREMENT. THE COMPANY AND ITS AFFILIATES ASSUME NO LEGAL RESPONSIBILITY OR LIABILITY FOR THE RECIPIENT'S USE (OR ANY OTHER PARTIES' USE) OF THE PRINT, INCLUDING THE RECIPIENT'S INTENDED PURPOSE IN USING THE PRINT. NO COMPANY EMPLOYEE OR OTHER PARTY HAS BEEN AUTHORIZED TO PROVIDE THIS PRINT FOR PLANNING OR ESTIMATING PURPOSES; RELY ON THIS PRINT AT YOUR OWN RISK. BY ACCEPTING THIS PRINT, THE RECIPIENT & ANY OTHER PARTY RECEIVING A COPY OF THE PRINT ACKNOWLEDGES AND AGREES TO THIS DISCLAIMER. For All Field Locates Call 811

P3: Splice into existing 3ph. 1/0 AL cable outside of new location for LBC "W13". Cable is under paved trail.

P4: Splice out "C" phase to feed LBC "W05".

P5: Splice out "C" phase to feed LBC "W06".

P6: Splice back into 3ph. 1/0 AL cable west of Troy Ln. Cable is under paved trail.

County Road 30 & new Rush Creek Blvd, Maple Grove
 Project Overview:
 Relocate ECK341 feeder cable and 1/0AL 3 phase tap cable.

WO# 111546582

Sketch 2/4

Access: Truck

Feeder: ECK341



Adam Barthel
 C: 612-368-6427

Work Order Information

Service Request # : 000014360528
 Design Number : 000001162775
 Designer/Planner ID : 248845
 Designer/Planner Name :
 Designer/Planner Ph # : (000) 000-0000
 Manager Approval :

Joint Utility

E: G:
 T: C:

Design Location

Division : Maple Grove
 County : Hennepin
 City : Maple Grove
 Address :
 T: 119N R: 22W S: 7
 Map # : K52011 Permit :

Electric

Feeder: Voltage:
 Phase: Bkup Dev ID:

Gas

System : Pressure :
 Size : Material :

Dead End :

Work Order # :

Date: 03/20/2024

Sketch: # Of # Sketch Data

Scale: 1" equals 124'

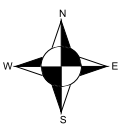

CONSTRUCTION USE ONLY

- NO CHANGES (BUILT AS DESIGNED)
- CHANGES MADE AS INDICATED (ALL URD MUST HAVE ACTUAL MEASUREMENTS FROM THE FIELD SITE)

RFO _____
 FOREMAN _____ DATE _____
 TEAM LEADER _____

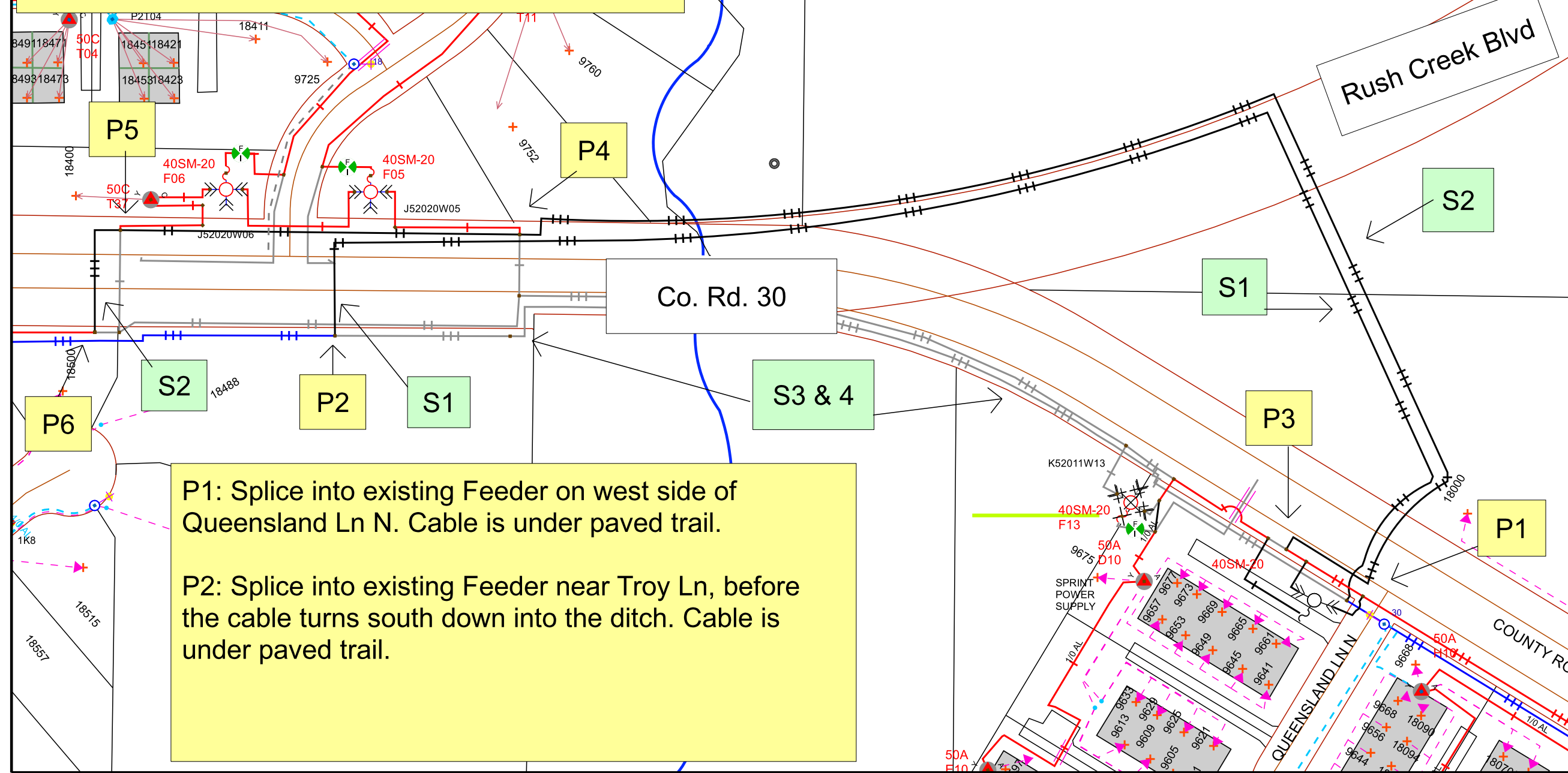

P1: Splice into existing Feeder on west side of Queensland Ln N. Cable is under paved trail.
 P2: Splice into existing Feeder near Troy Ln, before the cable turns south down into the ditch. Cable is under paved trail.

DISCLAIMER: THERE ARE NO REPRESENTATIONS OR WARRANTIES (EXPRESS OR IMPLIED) ABOUT THE ACCURACY OF THIS PRINT. THIS PRINT IS PROVIDED WITH NO CLAIM AS TO PRINT COMPLETENESS, TIMELINESS, ACCURACY OF CONTENT OR USEFULNESS. STATE LAW REQUIRES ANYONE DIGGING, GRADING OR EXCAVATING TO OBTAIN A PRIOR FIELD LOCATE OF ALL UTILITIES; THIS PRINT DOES NOT DISCHARGE THIS REQUIREMENT OR ANY OTHER REQUIREMENT. THE COMPANY AND ITS AFFILIATES ASSUME NO LEGAL RESPONSIBILITY OR LIABILITY FOR THE RECIPIENT'S USE (OR ANY OTHER PARTIES' USE) OF THE PRINT, INCLUDING THE RECIPIENT'S INTENDED PURPOSE IN USING THE PRINT. NO COMPANY EMPLOYEE OR OTHER PARTY HAS BEEN AUTHORIZED TO PROVIDE THIS PRINT FOR PLANNING OR ESTIMATING PURPOSES; RELY ON THIS PRINT AT YOUR OWN RISK. BY ACCEPTING THIS PRINT, THE RECIPIENT & ANY OTHER PARTY RECEIVING A COPY OF THE PRINT ACKNOWLEDGES AND AGREES TO THIS DISCLAIMER. For All Field Locates Call 811

THIS DOCUMENT IS XCEL ENERGY CONFIDENTIALS AND PROPRIETARY INFORMATION AND MAY NOT BE REPRODUCED IN WHOLE, OR IN PART, NOR MAY ANY OF THE INFORMATION CONTAINED HEREIN BE DISCLOSED WITHOUT THE CONSENT OF XCEL ENERGY. CONFIDENTIALS AND PROPRIETARY INFORMATION © 2019 XCEL ENERGY INC. | XCEL ENERGY IS REGISTERED TRADEMARK OF XCEL ENERGY INC

County Rd. 30 & new Rush Creek Blvd, Maple Grove.
 Project Overview: Relocate ECK341 feeder & 1/0 tap cable.

WO # 111546582
 Sketch 3/4
 Access: Truck
 Feeder: ECK341

P7: Relocate LBC "W13" closer to Queensland Ln N to maintain better truck acces. POI/stencil will remain the same. Can relocate existing cabinet if possible.

Splice into & out of existing 3 ph. cable to feed thru LBC.

Fuse position: splice out additional span of A phase to tie into existing 3ph cable running back to old LBC location. Deenergize B & C phase. Install fault indicator.

Splice through A phase cable at old LBC location.

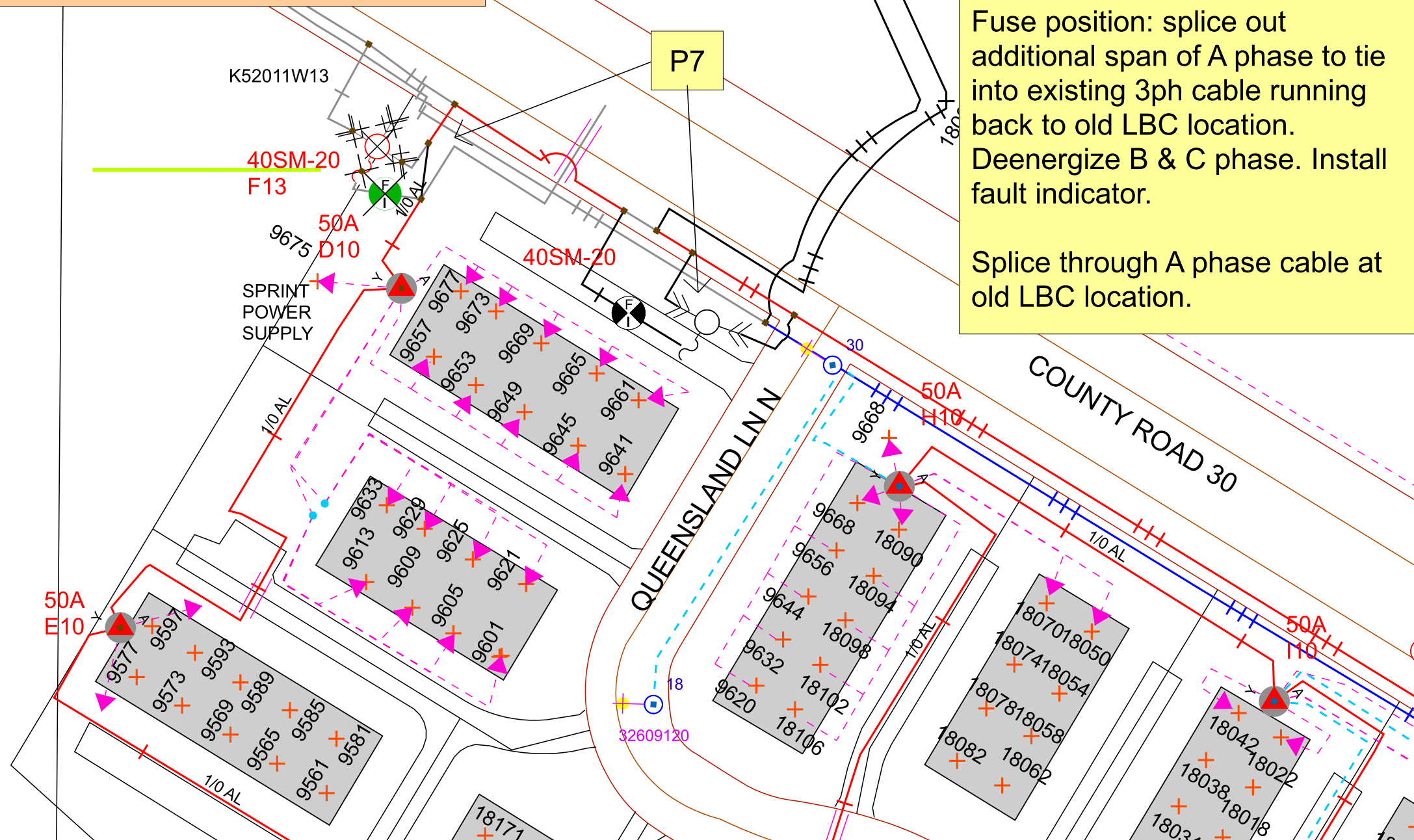

Adam Barthel
 C: 612-368-6427

Work Order Information	
Service Request #	: 000014360528
Design Number	: 000001162775
Designer/Planner ID	: 248845
Designer/Planner Name	:
Designer/Planner Ph #	: (000) 000-0000
Manager Approval	:

Joint Utility	
E:	G:
T:	C:

Design Location	
Division	: Maple Grove
County	: Hennepin
City	: Maple Grove
Address	:
T: 119N	R: 22W S: 7
Map # : K52011	Permit :

Electric	
Feeder:	Voltage:
Phase:	Bkup Dev ID:

Gas	
System :	Pressure :
Size :	Material :
Dead End :	

Work Order # :
 Date: 03/20/2024
 Sketch: # Of # Sketch Data
 Scale: 1" equals 75'



CONSTRUCTION USE ONLY
 NO CHANGES (BUILT AS DESIGNED)
 CHANGES MADE AS INDICATED
 (ALL URD MUST HAVE ACTUAL MEASUREMENTS FROM THE FIELD SITE)

RFO _____
 FOREMAN _____ DATE _____
 TEAM LEADER _____

DISCLAIMER: THERE ARE NO REPRESENTATIONS OR WARRANTIES (EXPRESS OR IMPLIED) ABOUT THE ACCURACY OF THIS PRINT. THIS PRINT IS PROVIDED WITH NO CLAIM AS TO PRINT COMPLETENESS, TIMELINESS, ACCURACY OF CONTENT OR USEFULNESS. STATE LAW REQUIRES ANYONE DIGGING, GRADING OR EXCAVATING TO OBTAIN A PRIOR FIELD LOCATE OF ALL UTILITIES; THIS PRINT DOES NOT DISCHARGE THIS REQUIREMENT OR ANY OTHER REQUIREMENT. THE COMPANY AND ITS AFFILIATES ASSUME NO LEGAL RESPONSIBILITY OR LIABILITY FOR THE RECIPIENT'S USE (OR ANY OTHER PARTIES' USE) OF THE PRINT, INCLUDING THE RECIPIENTS INTENDED PURPOSE IN USING THE PRINT. NO COMPANY EMPLOYEE OR OTHER PARTY HAS BEEN AUTHORIZED TO PROVIDE THIS PRINT FOR PLANNING OR ESTIMATING PURPOSES; RELY ON THIS PRINT AT YOUR OWN RISK. BY ACCEPTING THIS PRINT, THE RECIPIENT & ANY OTHER PARTY RECEIVING A COPY OF THE PRINT ACKNOWLEDGES AND AGREES TO THIS DISCLAIMER. For All Field Locates Call 811

County Rd. 30 & new Rush Creek Blvd, Maple Grove.
 Project Overview: Relocate ECK341 feeder & 1/0 tap cable.

WO # 111546582
 Sketch 4/4
 Access: Truck
 Feeder: ECK341

"After" sketch when LBC relocation is completed.



Adam Barthel
 C: 612-368-6427

Work Order Information	
Service Request #	: 000014360528
Design Number	: 000001162775
Designer/Planner ID	: 248845
Designer/Planner Name	:
Designer/Planner Ph #	: (000) 000-0000
Manager Approval	:

Joint Utility	
E:	G:
T:	C:

Design Location	
Division	: Maple Grove
County	: Hennepin
City	: Maple Grove
Address	:
T: 119N	R: 22W S: 7
Map # : K52011	Permit :

Electric	
Feeder:	Voltage:
Phase:	Bkup Dev ID:

Gas	
System :	Pressure :
Size :	Material :
Dead End :	

Work Order # :
 Date: 03/20/2024
 Sketch: # Of # Sketch Data
 Scale: 1" equals 75'



CONSTRUCTION USE ONLY

NO CHANGES (BUILT AS DESIGNED)
 CHANGES MADE AS INDICATED
 (ALL URD MUST HAVE ACTUAL MEASUREMENTS FROM THE FIELD SITE)

RFO _____
 FOREMAN _____ DATE _____
 TEAM LEADER _____

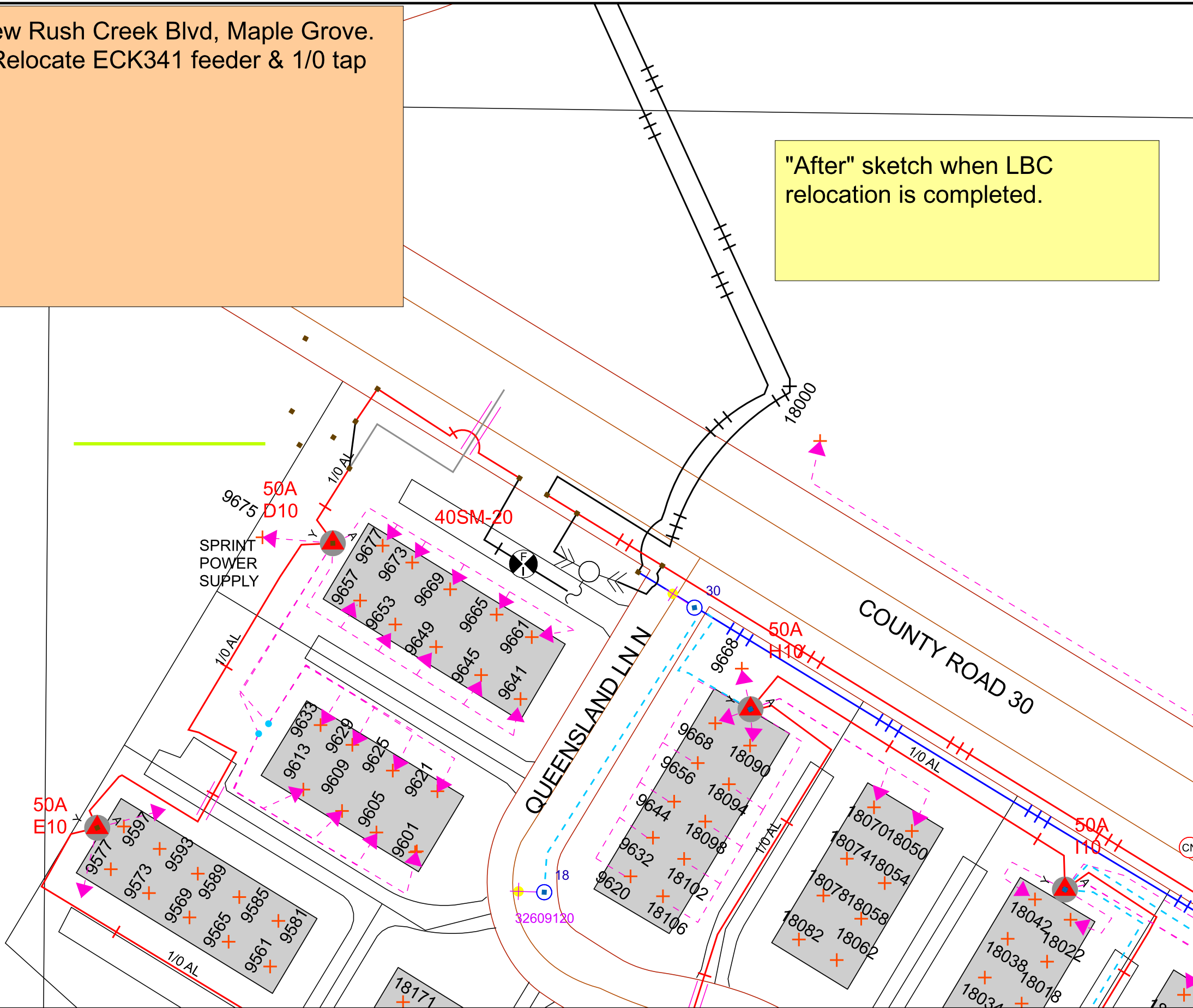

DISCLAIMER: THERE ARE NO REPRESENTATIONS OR WARRANTIES (EXPRESS OR IMPLIED) ABOUT THE ACCURACY OF THIS PRINT. THIS PRINT IS PROVIDED WITH NO CLAIM AS TO PRINT COMPLETENESS, TIMELINESS, ACCURACY OF CONTENT OR USEFULNESS. STATE LAW REQUIRES ANYONE DIGGING, GRADING OR EXCAVATING TO OBTAIN A PRIOR FIELD LOCATE OF ALL UTILITIES; THIS PRINT DOES NOT DISCHARGE THIS REQUIREMENT OR ANY OTHER REQUIREMENT. THE COMPANY AND ITS AFFILIATES ASSUME NO LEGAL RESPONSIBILITY OR LIABILITY FOR THE RECIPIENT'S USE (OR ANY OTHER PARTIES' USE) OF THE PRINT, INCLUDING THE RECIPIENTS INTENDED PURPOSE IN USING THE PRINT. NO COMPANY EMPLOYEE OR OTHER PARTY HAS BEEN AUTHORIZED TO PROVIDE THIS PRINT FOR PLANNING OR ESTIMATING PURPOSES; RELY ON THIS PRINT AT YOUR OWN RISK. BY ACCEPTING THIS PRINT, THE RECIPIENT & ANY OTHER PARTY RECEIVING A COPY OF THE PRINT ACKNOWLEDGES AND AGREES TO THIS DISCLAIMER. For All Field Locates Call 811

THIS DOCUMENT IS XCEL ENERGY CONFIDENTIALS AND PROPRIETARY INFORMATION AND MAY NOT BE REPRODUCED IN WHOLE, OR IN PART, NOR MAY ANY OF THE INFORMATION CONTAINED HEREIN BE DISCLOSED WITHOUT THE CONSENT OF XCEL ENERGY. CONFIDENTIALS AND PROPRIETARY INFORMATION © 2019 XCEL ENERGY INC. | XCEL ENERGY IS REGISTERED TRADEMARK OF XCEL ENERGY INC