

Revised 05-27-2021	State	MN	Contractor	MN Metro	CMS#	23167679
-----------------------	-------	----	------------	----------	------	----------

**CenturyLink BSW Order/Maintenance Work Authorization**

Company	Lumen	Exchange Name	PLMOMNFE	Service Order#	
Work Activity	Fiber-Buried	Capital	Y	Maintenance	N
Customer Name	Bryan Ophaug			Phone#	(612) 703-8746
Address	16250 62nd PL N			One Call Ticket#	
City & Zip	Maple Grove, MN 55311				
Location/Directions	See Group Maps				
Description of Work or Special Instructions	BSW				

Held Order	N	Permit:	N	Bore:	N	CBR#	612-703-8746
Tech Name and Tech #	Elton Dahn			Employee Contact#	612-462-0063		

Sketch (Include Cntr Line & Pedestal)	Material/Labor Units		Footage/Quantity	Comments
	Description	Notes		
Cntr Line foot	SEB3-22	BSW-3 & plow plcmt		
	SEB3-22T	BSW-3 & hand dig plcmt		
Ped#	299 Weston Ln	SEPCUTOVER		
Parish/County	BM83	BSW guard at house	1	
	XXSEB-GL	Remove temp drop	300	Footage when temp can't be re-used
Township:	BM61(1.25)SEB	BSW Bore footage	40	
Section	SEBO PER FT LBR	Fiber & plow plcmt	180	
Range	SEBO PER FT LBR T	Fiber & hand dig plcmt		
	SEB6-22	BSW-6 & plow plcmt		
	BM2(5/8)(8)	Ground Rod		
	SEBO-COIL	Fiber Coil		Coil excess on Fiber drop add 1 unit
	Permit	Permit		Any placement within the ROW requires a permit
Nearest cross st.	Xena Ln N		Plat Page	Map#

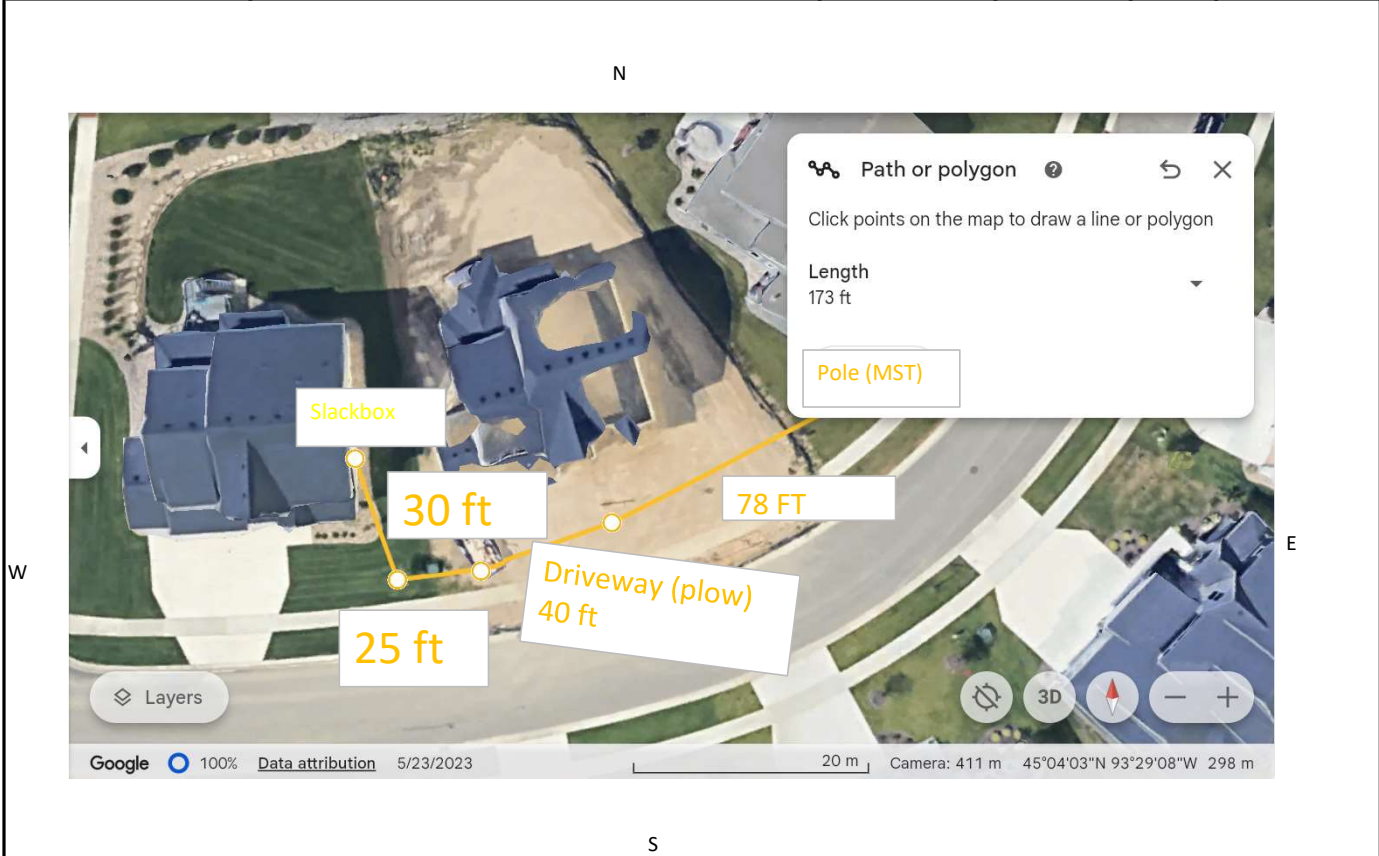

Originated By:	Elton Dahn	Date:	1/5/24	Completed By:		Date:	
Authorized By: (SRO)	Ryan Behnning	Date:		Inspected By:		Date:	
Authorized By: (MRO)		Date:					

1. Distance of the bury in Right-of-Way	200 ft.	3. Distance to the nearest intersection	
2. Distance from the terminal to the centerline		4. Nearest State Hwy mile marker	