

ESCALATED CABLE FAULT  
 9333 RANCHVIEW LN N  
 MAPLE GROVE  
 SP806446  
 PERMIT REQUIRED  
 SERVICE CENTER: MAPLE GROVE

FEEDER ECK061  
 PHASE A  
 VOLTAGE 15 KV  
 P1 -SPLICE PT  
 #2-#2 SPLICE, A PHASE  
 P2 -G7-TERM NEW CABLE (LOOPED)  
 P3 -F7-TERM NEW CABLE (LOOPED)  
 P4 -E7-TERM NEW CABLE (LOOPED)  
 S1 -ABANDON EXISTING CABLE, DIR BORE APPROX. 495" OF NEW #2 AL CABLE.  
 S2 -ABANDON EXISTING CABLE, DIR BORE APPROX. 260" OF NEW #2 AL CABLE.  
 RESTORATION REQUIRED.

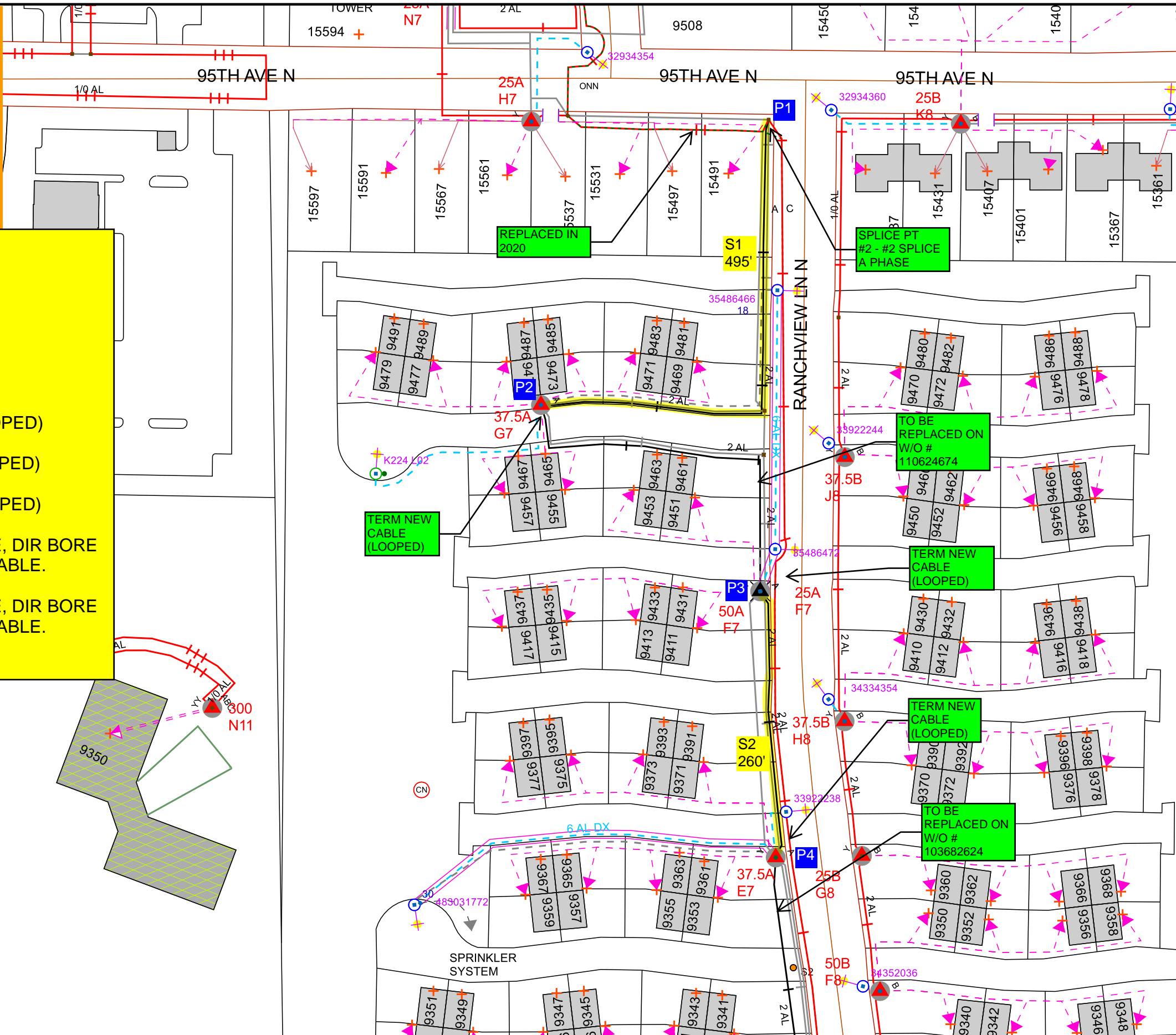

DESIGNER:  
 JAYMIE HOLTE  
 EMAIL: JAYMIE.L.HOLTE@XCELENERGY.COM  
 PHONE: 608-799-3001

| Work Order Information |                |
|------------------------|----------------|
| Service Request #      | : 000014252169 |
| Design Number          | : 000001155690 |
| Designer/Planner ID    | : W37797       |
| Designer/Planner Name  | : J. H. HOLTE  |
| Designer/Planner Ph #  | : 608-799-3001 |
| Manager Approval       | :              |

| Joint Utility |    |
|---------------|----|
| E:            | G: |
| T:            | C: |

| Design Location |                   |
|-----------------|-------------------|
| Division        | : Maple Grove     |
| County          | : Hennepin        |
| City            | : Maple Grove     |
| Address         | :                 |
| T: 119N         | R: 22W S: 9       |
| Map #           | : K52024 Permit : |

| Electric       |                |
|----------------|----------------|
| Feeder: ECK061 | Voltage: 15 KV |
| Phase: A PHASE | Bkup Dev ID:   |

| Gas      |              |
|----------|--------------|
| System   | : Pressure : |
| Size     | : Material : |
| Dead End | :            |

Work Order # :  
 Date: 01/03/2024  
 Sketch: 1 of 1  
 Scale: 1" equals 100'



**CONSTRUCTION USE ONLY**  
 NO CHANGES (BUILT AS DESIGNED)  
 CHANGES MADE AS INDICATED  
 (ALL URD MUST HAVE ACTUAL MEASUREMENTS FROM THE FIELD SITE)

RFO \_\_\_\_\_  
 FOREMAN \_\_\_\_\_ DATE \_\_\_\_\_  
 TEAM LEADER \_\_\_\_\_

DISCLAIMER: THERE ARE NO REPRESENTATIONS OR WARRANTIES (EXPRESS OR IMPLIED) ABOUT THE ACCURACY OF THIS PRINT. THIS PRINT IS PROVIDED WITH NO CLAIM AS TO PRINT COMPLETENESS, TIMELINESS, ACCURACY OF CONTENT OR USEFULNESS. STATE LAW REQUIRES ANYONE DIGGING, GRADING OR EXCAVATING TO OBTAIN A PRIOR FIELD LOCATE OF ALL UTILITIES; THIS PRINT DOES NOT DISCHARGE THIS REQUIREMENT OR ANY OTHER REQUIREMENT. THE COMPANY AND ITS AFFILIATES ASSUME NO LEGAL RESPONSIBILITY OR LIABILITY FOR THE RECIPIENT'S USE (OR ANY OTHER PARTIES' USE) OF THE PRINT, INCLUDING THE RECIPIENTS INTENDED PURPOSE IN USING THE PRINT. NO COMPANY EMPLOYEE OR OTHER PARTY HAS BEEN AUTHORIZED TO PROVIDE THIS PRINT FOR PLANNING OR ESTIMATING PURPOSES; RELY ON THIS PRINT AT YOUR OWN RISK. BY ACCEPTING THIS PRINT, THE RECIPIENT & ANY OTHER PARTY RECEIVING A COPY OF THE PRINT ACKNOWLEDGES AND AGREES TO THIS DISCLAIMER. For All Field Locates Call 811  
 THIS DOCUMENT IS XCEL ENERGY CONFIDENTIALS AND PROPRIETARY INFORMATION AND MAY NOT BE REPRODUCED IN WHOLE, OR IN PART, NOR MAY ANY OF THE INFORMATION CONTAINED HEREIN BE DISCLOSED WITHOUT THE CONSENT OF XCEL ENERGY. CONFIDENTIALS AND PROPRIETARY INFORMATION © 2019 XCEL ENERGY INC. | XCEL ENERGY IS REGISTERED TRADEMARK OF XCEL ENERGY INC