

ESCALATED CABLE FAULT
 14536 95th Ave N,
 Maple Grove, MN 55369

SP809390

PERMIT REQUIRED

SERVICE CENTER: Maple Grove

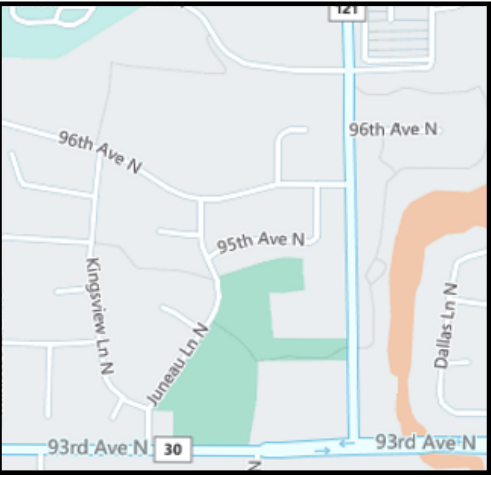
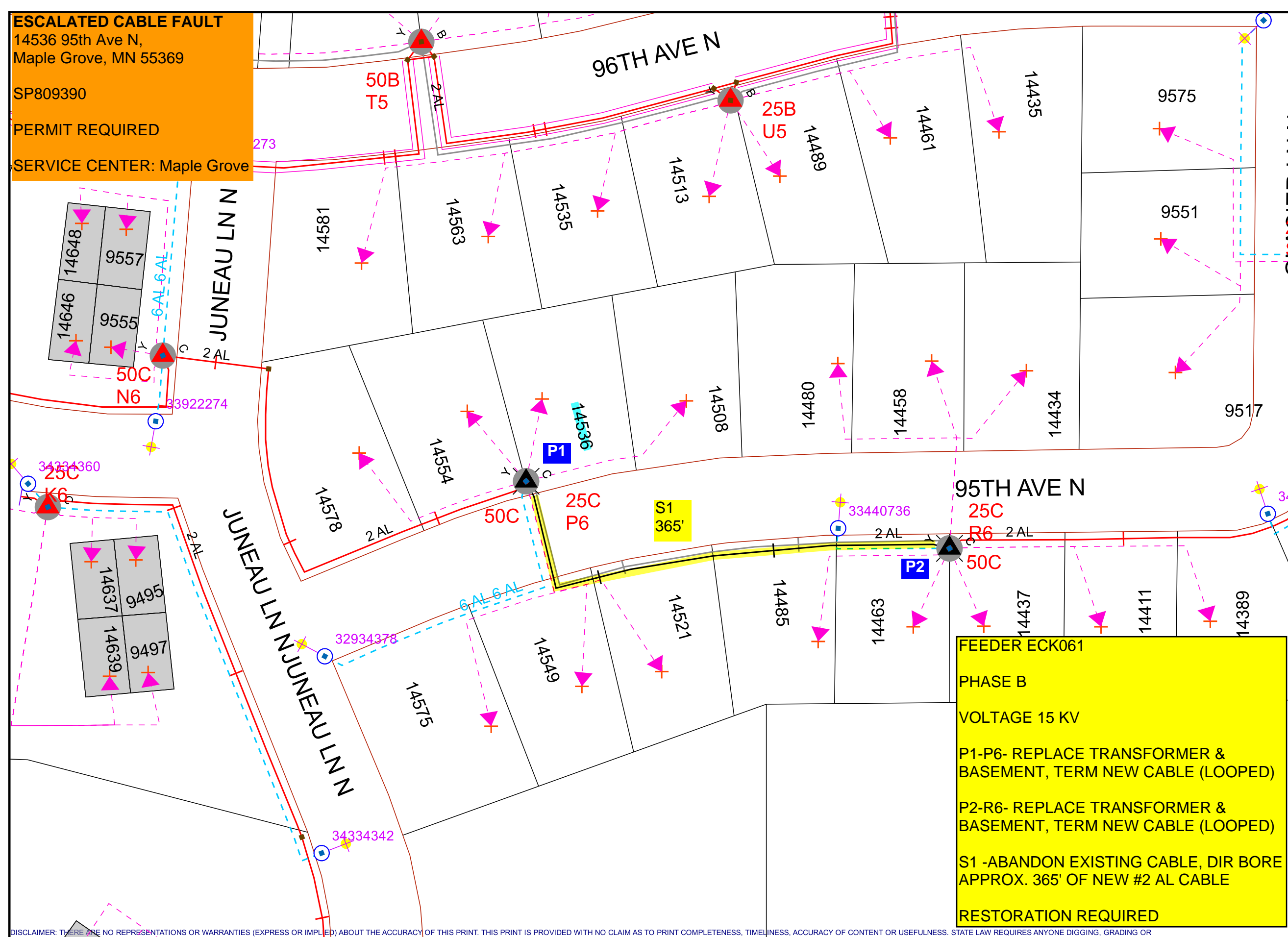

Designer:
Danielle Parker
 Danielle.E.Parker@xcelenergy.com

Work Order Information	
Service Request #	: 000014174429
Design Number	: 000001150327
Designer/Planner ID	: 237800
Designer/Planner Name	: D.Parker
Designer/Planner Ph #	: 303-532-9794
Manager Approval	:

Joint Utility	
E:	G:
T:	C:

Design Location	
Division	: Maple Grove
County	: Hennepin
City	: Maple Grove
Address	: 14536 95TH AVE N
T: 119N	R: 22W S: 9
Map #	: K52025 Permit :

Electric	
Feeder: ECK061	Voltage: 7.97 kV
Phase: C	Bkup Dev ID:

Gas	
System	: Pressure :
Size	: Material :
Dead End	:

Work Order # :

Date: 11/15/2023

Sketch: #1 Of #1 Sketch Data

Scale: 1" equals 67'

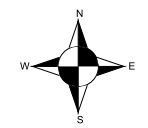

FEEDER ECK061

PHASE B

VOLTAGE 15 KV

P1-P6- REPLACE TRANSFORMER & BASEMENT, TERM NEW CABLE (LOOPED)

P2-R6- REPLACE TRANSFORMER & BASEMENT, TERM NEW CABLE (LOOPED)

S1 -ABANDON EXISTING CABLE, DIR BORE APPROX. 365' OF NEW #2 AL CABLE

RESTORATION REQUIRED

CONSTRUCTION USE ONLY

NO CHANGES (BUILT AS DESIGNED)

CHANGES MADE AS INDICATED (ALL URD MUST HAVE ACTUAL MEASUREMENTS FROM THE FIELD SITE)

RFO _____

FOREMAN _____ DATE _____

TEAM LEADER _____

DISCLAIMER: THERE ARE NO REPRESENTATIONS OR WARRANTIES (EXPRESS OR IMPLIED) ABOUT THE ACCURACY OF THIS PRINT. THIS PRINT IS PROVIDED WITH NO CLAIM AS TO PRINT COMPLETENESS, TIMELINESS, ACCURACY OF CONTENT OR USEFULNESS. STATE LAW REQUIRES ANYONE DIGGING, GRADING OR EXCAVATING TO OBTAIN A PRIOR FIELD LOCATE OF ALL UTILITIES. THIS PRINT DOES NOT DISCHARGE THIS REQUIREMENT OR ANY OTHER REQUIREMENT. THE COMPANY AND ITS AFFILIATES ASSUME NO LEGAL RESPONSIBILITY OR LIABILITY FOR THE RECIPIENT'S USE (OR ANY OTHER PARTIES' USE) OF THE PRINT, INCLUDING THE RECIPIENT'S INTENDED PURPOSE IN USING THE PRINT. NO COMPANY EMPLOYEE OR OTHER PARTY HAS BEEN AUTHORIZED TO PROVIDE THIS PRINT FOR PLANNING OR ESTIMATING PURPOSES; RELY ON THIS PRINT AT YOUR OWN RISK. BY ACCEPTING THIS PRINT, THE RECIPIENT & ANY OTHER PARTY RECEIVING A COPY OF THE PRINT ACKNOWLEDGES AND AGREES TO THIS DISCLAIMER. For All Field Locates Call 811

THIS DOCUMENT IS XCEL ENERGY CONFIDENTIALS AND PROPRIETARY INFORMATION AND MAY NOT BE REPRODUCED IN WHOLE, OR IN PART, NOR MAY ANY OF THE INFORMATION CONTAINED HEREIN BE DISCLOSED WITHOUT THE CONSENT OF XCEL ENERGY. CONFIDENTIALS AND PROPRIETARY INFORMATION © 2019 XCEL ENERGY INC. | XCEL ENERGY IS REGISTERED TRADEMARK OF XCEL ENERGY INC