

**Forced RELO - Rush Hollow -**  
**14301 Territorial Road**  
14301 Territorial Road  
Maple Grove, MN 55369  
JB0000940020  
(Reference JB0001637897)  
Node: MNMGD05100  
Legacy: DD82A  
Partial GIS Image East of County Road 121

Green Line = New Underground Placement  
Brown Line = Existing Conduit  
Blue Line = Aerial Placement  
Red Line = Aerial Placement  
Yellow Line = New Placement  
Orange Line = New Placement  
Light Blue Line = New Placement

CSL CONTACT INFO:  
Eric Witt  
612.704.1640  
EWitt@cs.com  
COMCAST CONTACT INFO:  
Michele Lyford  
612.425.4712  
mlyford@comcast.com  
Contact for Permit Time Scheduling  
USA to Perform Gas Splicing &  
Work Area

**\*\* Permit Note: Currently No Accurate GIS Map West of County Road 121 for New Subdivision - See Comcast Plant Map \*\***



1 inch = 800 feet

**Forced RELO - Rush Hollow -**  
**14301 Territorial Road**  
 Maple Grove, MN 55369  
 JB000940020  
 (Reference JB0001637897)  
 Node: MNMGD05J00  
 Legacy: DD82A

Green Line = New Underground Placement  
 Yellow Line = Existing Conduit  
 Blue Line = Aerial Placement  
 New Fiber Vault  
 Existing Fiber Vault  
 New Pedestal  
 Existing Pedestal

**Permit Note:** Accurate City GIS Map of Area West of County Road 121 Currently Unavailable - Permit Application Drawn on Comcast Plant Map & GIS Map East of County Road 121 Only - All Vaults & Conduit West of County Road 121 to be Placed by Michael's (USI to Pull Fiber when Complete) - All Pedestals & Conduit East of County Road 121 to be Placed by USI - Total Permit Footage: 5625'

**USI CONTACT INFO:**  
 Eric Witt  
 651-764-1640  
 Ewitt@USI-Universal.com

**COMCAST CONTACT INFO:**  
 McClay Lyford  
 651-925-6372  
 mcclay\_lyford@comcast.com  
 Comcast to Perform Fiber Splicing & USI to Perform Coax Splicing & Wreck-Out

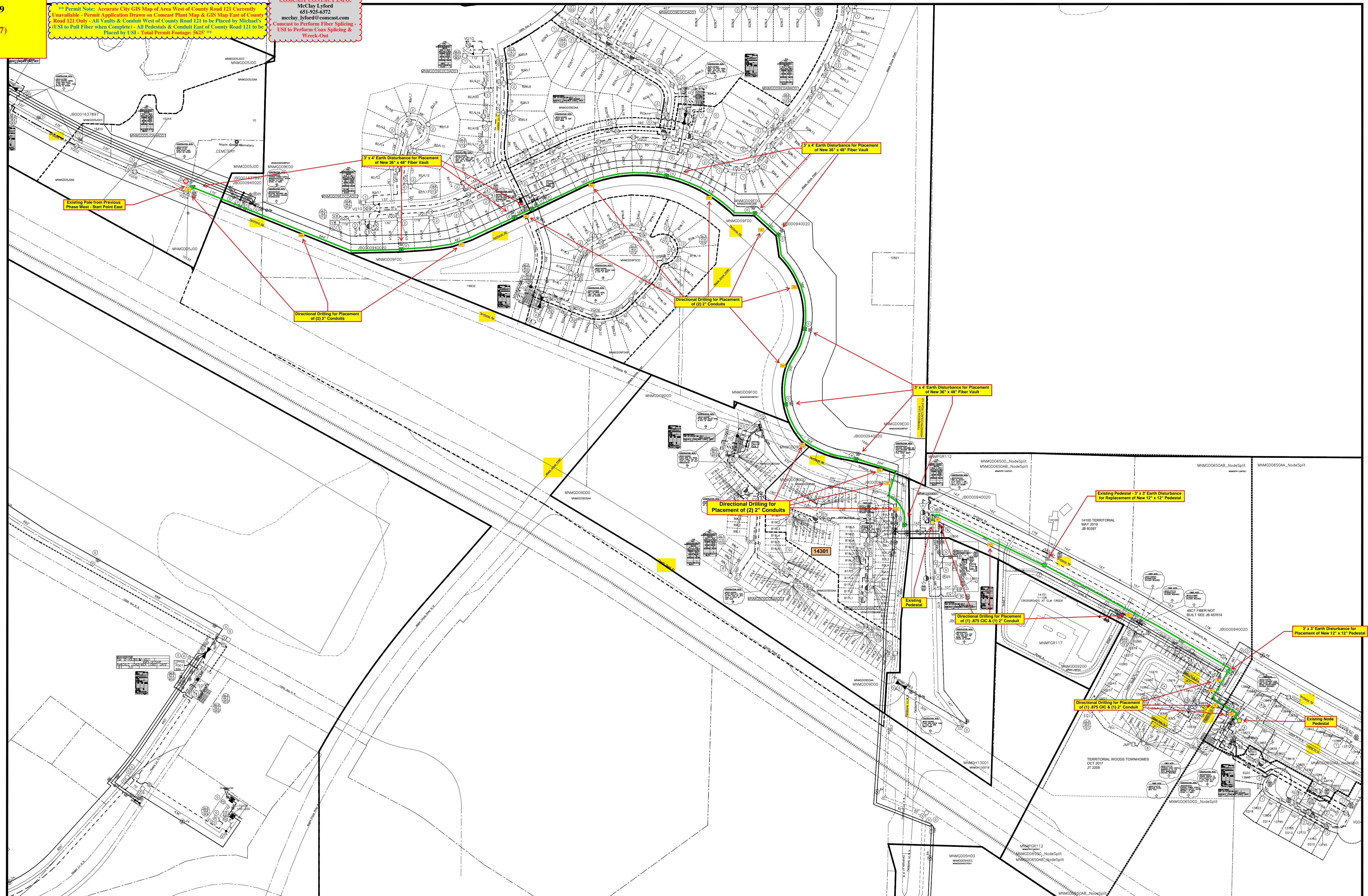

Rev	Date	Description	Rev	Date	Description	Rev	Date	Description	Rev	Date	Description
01	10/27/2023	FORCED RELOCATE / JB000940020 / BB (CCI)									

MNMPGR112  
 MNMG  
 MAPLE GROVE, MN



**Forced RELO - Rush Hollow -**  
**14301 Territorial Road**  
14301 Territorial Road  
Maple Grove, MN 55369  
JB0000940020  
(Reference JB0001637897)  
Node: MNMGD05J00  
Legacy: DD82A  
Wreck-Out GIS Image West of County Road 121

Green Line = New Underground Placement  
Yellow Line = Existing Structure  
Blue Line = New Pole Placement  
Red Line = New Pole Placement  
Orange Line = New Pole Placement  
Purple Line = New Pole Placement

US CONTACT INFO:  
Eric Witt  
651.764.6688  
eric@us.comcast.com

COMCAST CONTACT INFO:  
McClay, J. Edward  
651.854.2772  
mcclay\_jed@comcast.com  
Contact to Perform Pole Relocation  
US to Perform Core Splicing &  
Wreck-Out

**\*\* Permit Note: Currently No Accurate GIS Map West of County Road 121 for New Subdivision - See Comcast Plant Map \*\***

Aerial Wreck-Out of All Stand & Cables -  
Poles 7-12 - 1007' Total

Wreck-Out All UG  
Cables - 967' Total

3' x 3' Earth Disturbance for Removal  
of Existing Pedestal & Restoration

Aerial Wreck-Out of All Stand & Cables -  
Poles 14-20 - 1343' Total

Wreck-Out All UG  
Cables - 379' Total

3' x 3' Earth Disturbance for Removal  
of Existing Pedestal & Restoration



Maple Grove Pkwy N

County Road 81

1 inch = 800 feet

# Forced RELO - Rush Hollow - 14301 Territorial Road

14301 Territorial Road  
Maple Grove, MN 55369

JB0000940020

(Reference JB0001637897)

Node: MNMGD05J00

Legacy: DD82A

Wreck-Out Map West of County Road 121

Green Line = New Underground Placement	
Yellow Line = Existing Conduit	
Blue Line = Aerial Placement	
New Fiber Vault	
Existing Fiber Vault	
New Pedestal	
Existing Pedestal	

**USI CONTACT INFO:**  
Eric Witt  
651-764-1640  
Ewitt@USI-Universal.com

**COMCAST CONTACT INFO:**  
McClay Lyford  
651-925-6372  
mcclay\_lyford@comcast.com  
Comcast to Perform Fiber Splicing -  
USI to Perform Coax Splicing &  
Wreck-Out

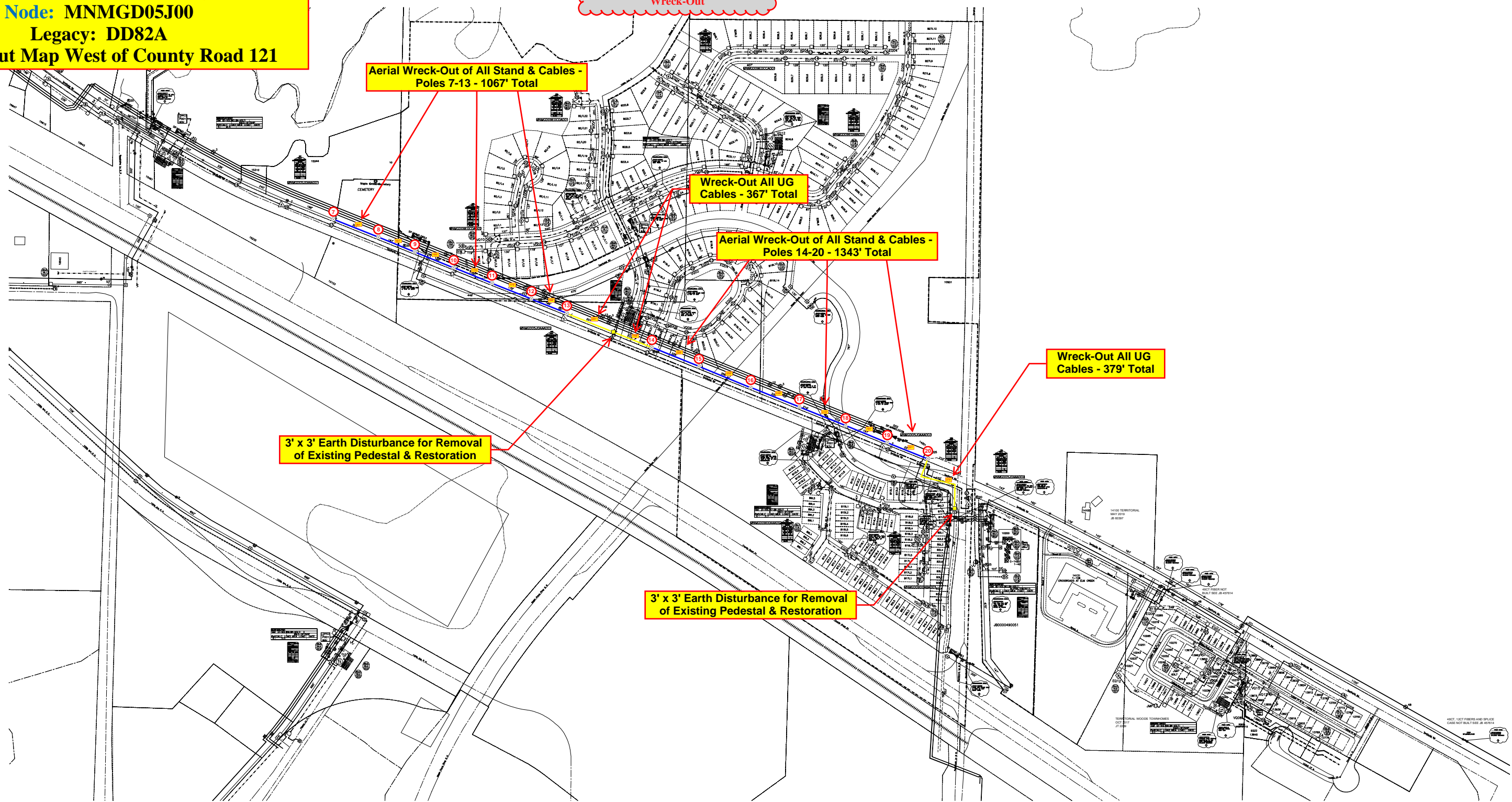

Aerial Wreck-Out of All Stand & Cables -  
Poles 7-13 - 1067' Total

Wreck-Out All UG  
Cables - 367' Total

Aerial Wreck-Out of All Stand & Cables -  
Poles 14-20 - 1343' Total

Wreck-Out All UG  
Cables - 379' Total

3' x 3' Earth Disturbance for Removal  
of Existing Pedestal & Restoration

3' x 3' Earth Disturbance for Removal  
of Existing Pedestal & Restoration

14301 TERRITORIAL  
MAY 2019  
JB 000094

14301 TERRITORIAL  
MAY 2019  
JB 000094

14301 TERRITORIAL  
MAY 2019  
JB 000094

14301 TERRITORIAL  
MAY 2019  
JB 000094