

Escalated Cable Replacement
 14710 79th Pl N, Maple Grove

Feeder. ECK062/C/7.97Kva

Directional Bore. Bore in 450' of #2 AL 1 Phase cable
 from K1 to U1

Terminations. 2 terminations at K1 and U1

Restorations

Plant ID # D214 Maple Grove
 SP# 744594



Brad Lylum
 O (651)-229-5571

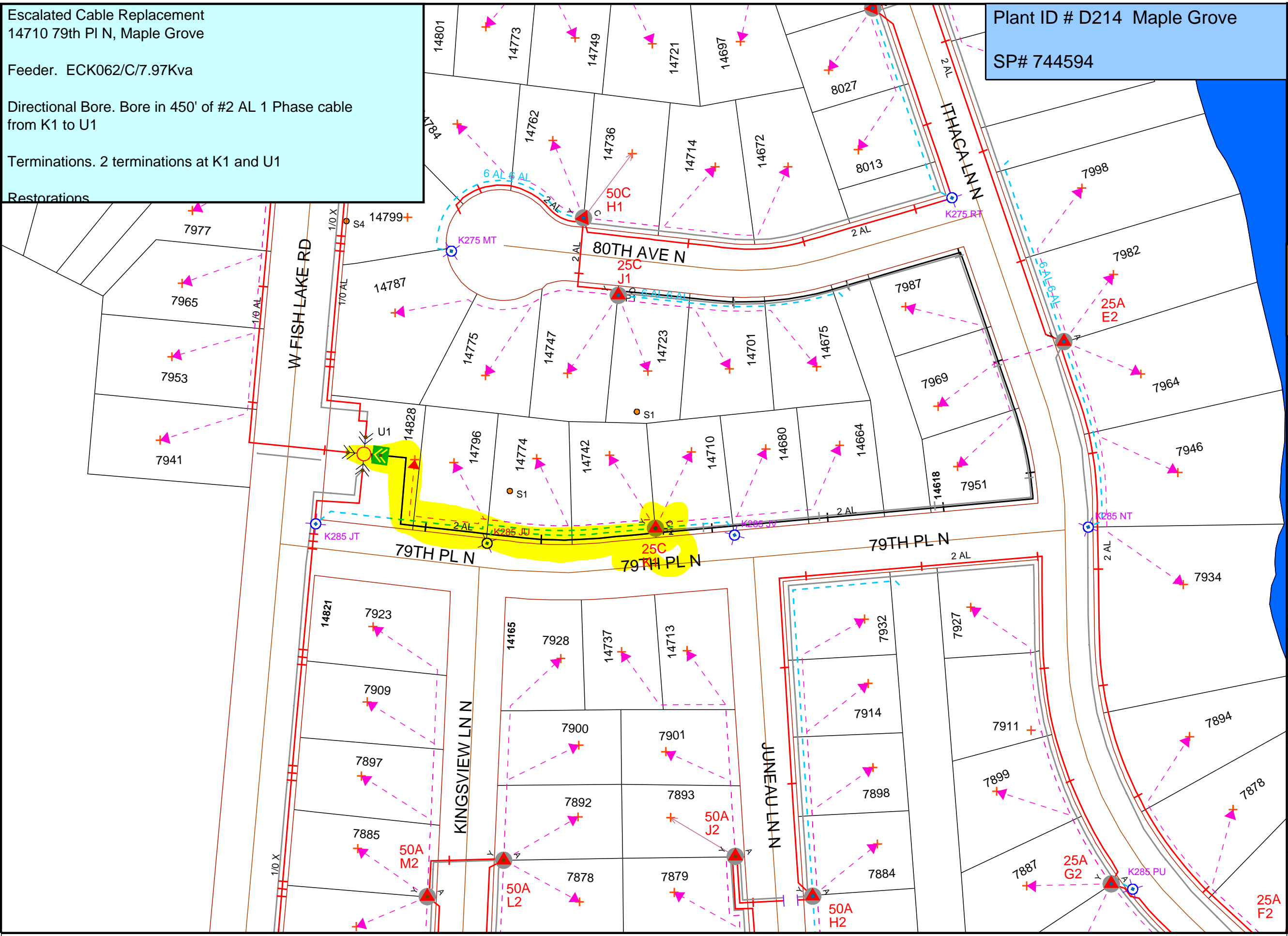

| Work Order Information | |
|------------------------|------------------|
| Service Request # | : |
| Design Number | : 00000828070 |
| Designer/Planner ID | : 233210 |
| Designer/Planner Name | : Lylum,Bradley |
| Designer/Planner Ph # | : (651) 229-5571 |
| Manager Approval | : |

| Joint Utility | |
|---------------|----|
| E: | G: |
| T: | C: |

| Design Location | |
|-----------------|-------------------|
| Division | : Maple Grove |
| County | : Hennepin |
| City | : Maple Grove |
| Address | : 14710 79th Pl N |
| T: 119N | R: 22W S: 21 |
| Map # | : K52085 |
| Permit | : |

| Electric | |
|-------------|-------------|
| Feeder | : See Notes |
| Voltage | : See Notes |
| Phase | : See Notes |
| Bkup Dev ID | : |

| Gas | |
|----------|--------------|
| System | : Pressure : |
| Size | : Material : |
| Dead End | : |

Work Order # :
 Date: 11/14/2018
 Sketch: # Of# Sketch Data
 Scale: 1" equals 100'

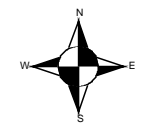

CONSTRUCTION USE ONLY

NO CHANGES (BUILT AS DESIGNED)
 CHANGES MADE AS INDICATED
 (ALL URD MUST HAVE ACTUAL MEASUREMENTS FROM THE FIELD SITE)

RFO _____
 FOREMAN _____ DATE _____
 TEAM LEADER _____

DISCLAIMER: THERE ARE NO REPRESENTATIONS OR WARRANTIES (EXPRESS OR IMPLIED) ABOUT THE ACCURACY OF THIS PRINT. THIS PRINT IS PROVIDED WITH NO CLAIM AS TO PRINT COMPLETENESS, TIMELINESS, ACCURACY OF CONTENT OR USEFULNESS. STATE LAW REQUIRES ANYONE DIGGING, GRADING OR EXCAVATING TO OBTAIN A PRIOR FIELD LOCATE OF ALL UTILITIES; THIS PRINT DOES NOT DISCHARGE THIS REQUIREMENT OR ANY OTHER REQUIREMENT. THE COMPANY AND ITS AFFILIATES ASSUME NO LEGAL RESPONSIBILITY OR LIABILITY FOR THE RECIPIENT'S USE (OR ANY OTHER PARTIES' USE) OF THE PRINT, INCLUDING THE RECIPIENT'S INTENDED PURPOSE IN USING THE PRINT. NO COMPANY EMPLOYEE OR OTHER PARTY HAS BEEN AUTHORIZED TO PROVIDE THIS PRINT FOR PLANNING OR ESTIMATING PURPOSES; RELY ON THIS PRINT AT YOUR OWN RISK. BY ACCEPTING THIS PRINT, THE RECIPIENT & ANY OTHER PARTY RECEIVING A COPY OF THE PRINT ACKNOWLEDGES AND AGREES TO THIS DISCLAIMER. For All Field Locates Call 811