

NATHAN
LANCER LN

9565 LANCASTER LN
 ID: 753917567
 POI: L52011 T06
 OSS073/C/7.9KV

TASK 1: DIRECTIONAL BORE
 BORE IN 80" OF 4/0 AL UG TRIPLEX CABLE P1 TO P2

TASK 2: TERMINATION
 TERMINATE AT P1 AND P2

TASK 3: REMOVE ADD-A-PHASE

TASK 4: RESTORATION

NOTE: ABANDON EXISTING SVC CABLE IN PLACE
 REPLACE PADLOCK ON TRANSFORMER
 REMOVE LANDSCAPE AT METER

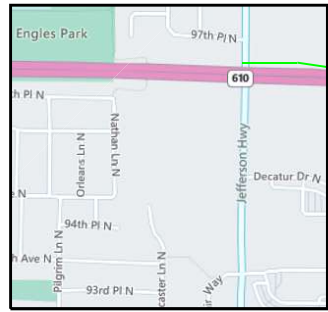
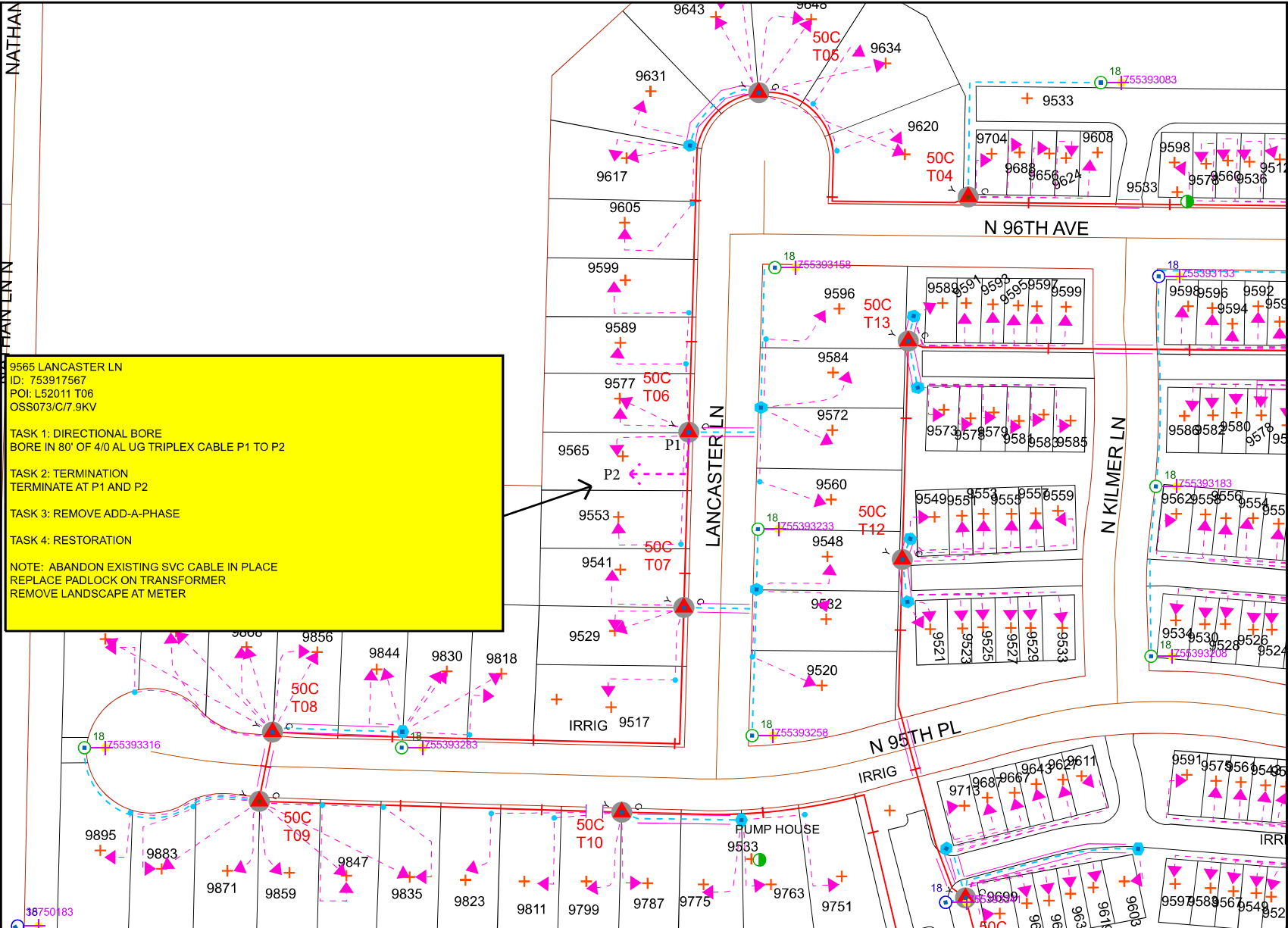

Work Order Information	
Service Request #	: 000014061346
Design Number	: 000001142747
Designer/Planner ID	: 243922
Designer/Planner Name	: DEBORAH GROSKO
Designer/Planner Ph #	: (816) 414-1113
Manager Approval	:
Joint Utility	
E:	G:
T:	C:
Design Location	
Division	: Maple Grove
County	: Hennepin
City	: Maple Grove
Address	: 9565 Lancaster LN
T: 119N	R: 22W S: 12
Map #	: L52021 Permit : Maple Grove
Electric	
Feeder: OSS073	Voltage: 7.9KV
Phase: C	Bkup Dev ID:
Gas	
System	: Pressure :
Size	: Material :
Dead End	:
Work Order #	: 00000110403009
Date:	09/19/2023
Sketch:	1 Of 1 Sketch Data
Scale:	1" equals 83'

CONSTRUCTION USE ONLY

NO CHANGES (BUILT AS DESIGNED)
 CHANGES MADE AS INDICATED
 (ALL URD MUST HAVE ACTUAL MEASUREMENTS FROM THE FIELD SITE)

RFO: _____
 FOREMAN: _____ DATE: _____
 TEAM LEADER: _____

DISCLAIMER: THERE ARE NO REPRESENTATIONS OR WARRANTIES (EXPRESS OR IMPLIED) ABOUT THE ACCURACY OF THIS PRINT. THIS PRINT IS PROVIDED WITH NO CLAIM AS TO PRINT COMPLETENESS, TIMELINESS, ACCURACY OF CONTENT OR USEFULNESS. STATE LAW REQUIRES ANYONE DIGGING, GRADING OR EXCAVATING TO OBTAIN A PRIOR FIELD LOCATE OF ALL UTILITIES; THIS PRINT DOES NOT DISCHARGE THIS REQUIREMENT OR ANY OTHER REQUIREMENT. THE COMPANY AND ITS AFFILIATES ASSUME NO LEGAL RESPONSIBILITY OR LIABILITY FOR THE RECIPIENTS USE (OR ANY OTHER PARTIES' USE) OF THE PRINT, INCLUDING THE RECIPIENTS INTENDED PURPOSE IN USING THE PRINT. NO COMPANY EMPLOYEE OR OTHER PARTY HAS BEEN AUTHORIZED TO PROVIDE THIS PRINT FOR PLANNING OR ESTIMATING PURPOSES; RELY ON THIS PRINT AT YOUR OWN RISK. BY ACCEPTING THIS PRINT, THE RECIPIENT & ANY OTHER PARTY RECEIVING A COPY OF THE PRINT ACKNOWLEDGES AND AGREES TO THIS DISCLAIMER. For All Field Locates Call 811

THIS DOCUMENT IS XCEL ENERGY CONFIDENTIALS AND PROPRIETARY INFORMATION AND MAY NOT BE REPRODUCED IN WHOLE, OR IN PART, NOR MAY ANY OF THE INFORMATION CONTAINED HEREIN BE DISCLOSED WITHOUT THE CONSENT OF XCEL ENERGY. CONFIDENTIALS AND PROPRIETARY INFORMATION © 2019 XCEL ENERGY INC. | XCEL ENERGY IS REGISTERED TRADEMARK OF XCEL ENERGY INC