

**14840 TERRITORIAL RD, MG  
RELOCATE POLE FOR ROAD  
CONSTRUCTION.**

**ECK322- 34.5KV (1/7)**

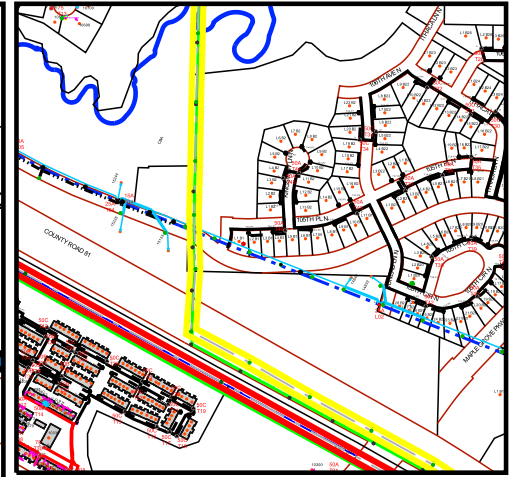

Designer-  
John Pfothenauer  
612-963-3804

Work Order Information

Service Request #	: 000014132286
Design Number	: 000001147451
Designer/Planner ID	: PFTJ01
Designer/Planner Name	:
Designer/Planner Ph #	:
Manager Approval	:

Joint Utility

E:	G:
T:	C:

Design Location

Division	: Maple Grove		
County	: Hennepin		
City	: Maple Grove		
Address	:		
T: 119N	R: 22W	S: 4	
Map #	: K51085	Permit	:

Electric

Feeder:	Voltage:
Phase:	Bkup Dev ID:

Gas

System	: Pressure	:
Size	: Material	:
Dead End	:	:

Work Order # :

Date: 10/23/2023

Sketch:

Scale: 1" equals 100'

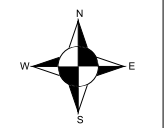

**CONSTRUCTION USE ONLY**

NO CHANGES (BUILT AS DESIGNED)

CHANGES MADE AS INDICATED  
(ALL URD MUST HAVE ACTUAL MEASUREMENTS FROM THE FIELD SITE)

RFO \_\_\_\_\_  
FOREMAN \_\_\_\_\_ DATE \_\_\_\_\_  
TEAM LEADER \_\_\_\_\_

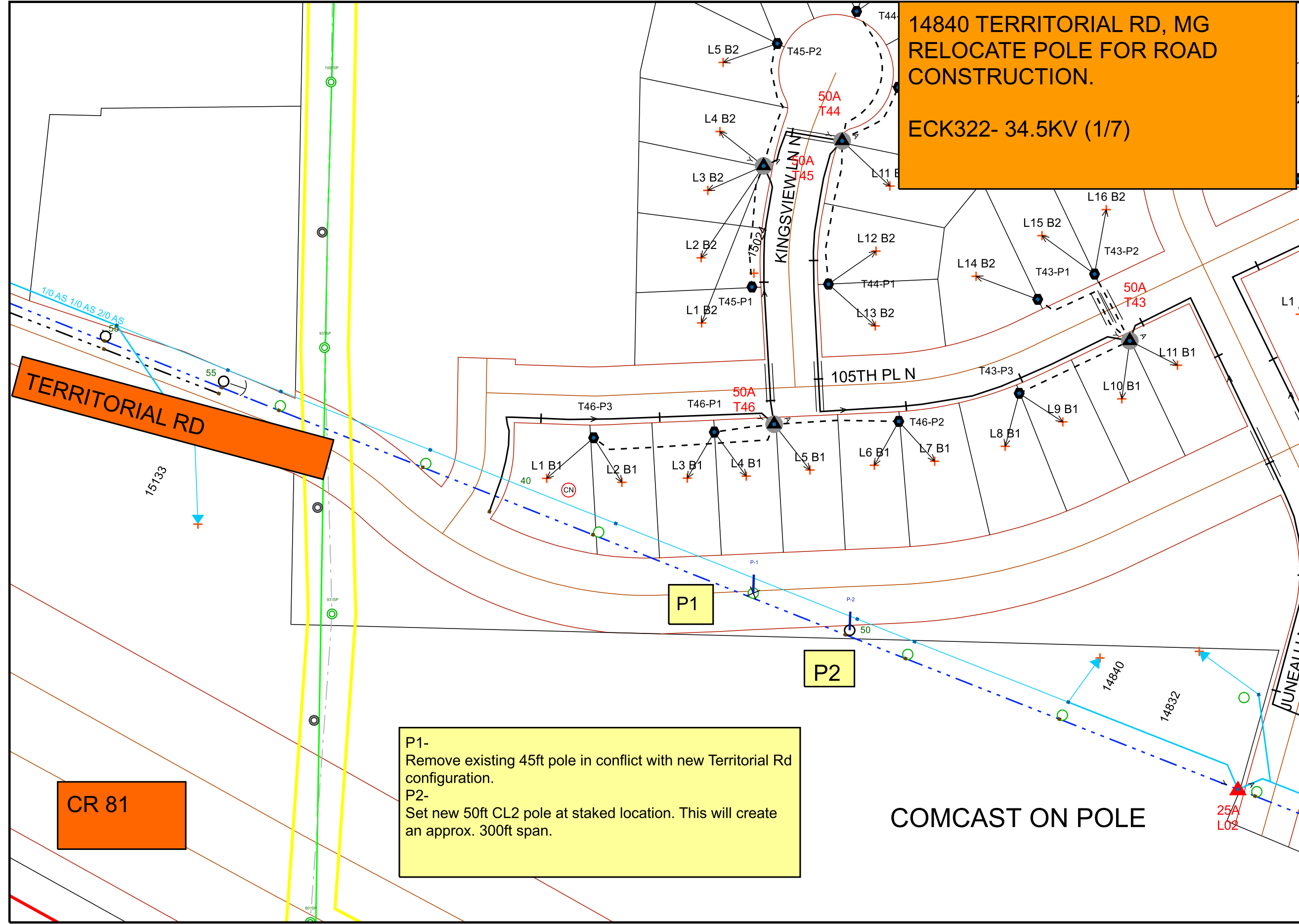

**P1-**  
Remove existing 45ft pole in conflict with new Territorial Rd configuration.

**P2-**  
Set new 50ft CL2 pole at staked location. This will create an approx. 300ft span.

**CR 81**

DISCLAIMER: THERE ARE NO REPRESENTATIONS OR WARRANTIES (EXPRESS OR IMPLIED) ABOUT THE ACCURACY OF THIS PRINT. THIS PRINT IS PROVIDED WITH NO CLAIM AS TO PRINT COMPLETENESS, TIMELINESS, ACCURACY OF CONTENT OR USEFULNESS. STATE LAW REQUIRES ANYONE DIGGING, GRADING OR EXCAVATING TO OBTAIN A PRIOR FIELD LOCATE OF ALL UTILITIES; THIS PRINT DOES NOT DISCHARGE THIS REQUIREMENT OR ANY OTHER REQUIREMENT. THE COMPANY AND ITS AFFILIATES ASSUME NO LEGAL RESPONSIBILITY OR LIABILITY FOR THE RECIPIENT'S USE (OR ANY OTHER PARTIES' USE) OF THE PRINT, INCLUDING THE RECIPIENTS INTENDED PURPOSE IN USING THE PRINT. NO COMPANY EMPLOYEE OR OTHER PARTY HAS BEEN AUTHORIZED TO PROVIDE THIS PRINT FOR PLANNING OR ESTIMATING PURPOSES; RELY ON THIS PRINT AT YOUR OWN RISK. BY ACCEPTING THIS PRINT, THE RECIPIENT & ANY OTHER PARTY RECEIVING A COPY OF THE PRINT ACKNOWLEDGES AND AGREES TO THIS DISCLAIMER. For All Field Locates Call 811