

**ECK322 13.8KV
EXTENSION-CREATING DOUBLE
CIRCUIT 34.5KV & 13.8KV FEEDER
LINE.
15406 TERRITORIAL RD, MG
ECK322- (1/7)**

**PART OF NEW RUSH HOLLOW
RESIDENTIAL DEVELOPMENT**

P1- Set new 55'CL2 pole. Dead-end both 336AL 35.5KV & 13.8KV feeder lines. Buck 13.8KV feeder line heading south.
P2- Set new 55'CL2 tangent double circuit pole. Transfer existing 336AL 34.5KV feeder and extend new 336AL 13.8KV feeder.
P3- Set new 55'CL2 tangent double circuit pole. Remove existing 10KVA OH tub K184 T10 from 34.5KV line and replace with 25KVA tub K51084T44 on 13.8KV feeder line on A phase to feed 15406 Territorial Rd. Splice onto existing 1/0 triplex service and run up new pole.
P4- Set new 55'CL2 double circuit light angle pole for 13.8KV feeder extension. Run span guy to existing pole on south side of road.
P5- Set new 55'CL2 double circuit tangent pole for new 13.8KV feeder.
P6- Set new 55'CL2 double circuit tangent pole. Remove existing 15KVA tu K184 T04 on 34.5KV feeder and hang new 25KVA tub K184 T04 on 13.8KV feeder line on A phase to feed 15244, 15235 & 15133 Territorial.
P7- Set new 55'CL2 double circuit tangent pole for new 13.8KV feeder.
P8- Set new 55'CL2 double circuit tangent pole. Joint-trench to use this pole to build TP for 13.8KV feed into new Rush Hollow Residential development.
P9- Set new 55'CL2 double circuit tangent pole. Dead-end the 13.8KV lower deck. 13.8KV feeder line will dip into conduit and run to new MH and ductline.
P10- Set new 45'CL2 dead-end pole. This will be a parallel cable TP to feed new MH and ductline.

All new poles set in-line of existing 34.5KV feeder line. Old poles to be removed. Comcast currently on poles. Not sure what their plan for area is.

S1- String in approx. 155ft span of 336AL conductor for new 13.8KV feeder extension. Transfer existing 34.5KV feeder to new poles.
S2- String in approx. 135ft span of 336AL conductor.
S3- String in approx. 220ft span of 336AL conductor.
S4- String in approx. 235ft span of 336AL conductor.
S5- String in approx. 235ft span of 336AL conductor.
S6- String in approx 200ft span of 336AL conductor.
S7- String in approx, 172ft span of 336AL conductor.
S8- String in approx. 25ft span of 336AL conductor.
S9- From pole at P9 OH will be wrecked out going east along Territorial.

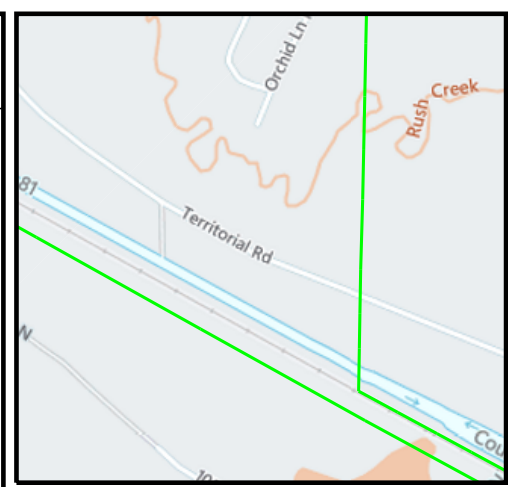
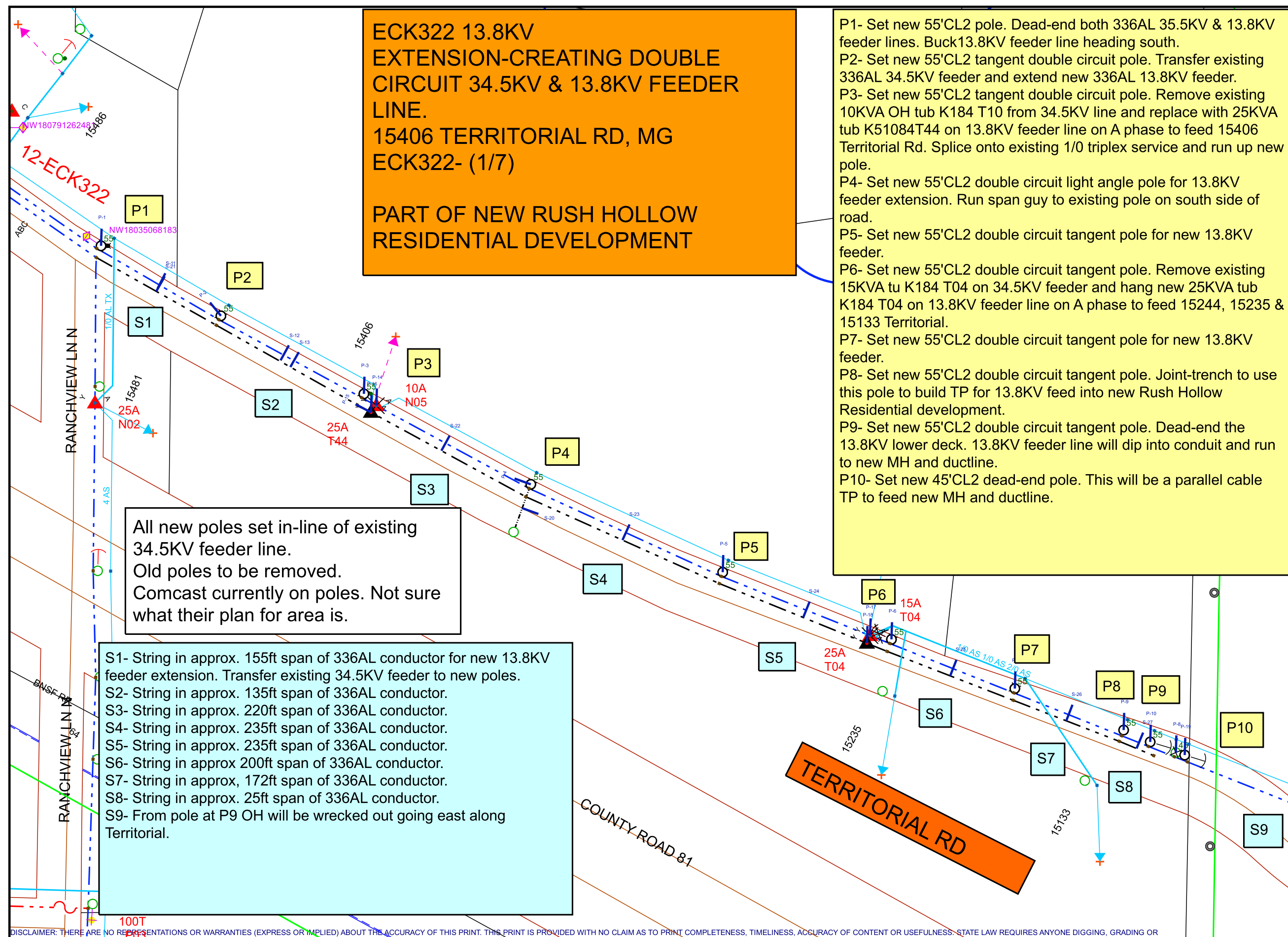

Designer-
John Pfothenauer
763-493-1876
612-963-3804 cell

Work Order Information	
Service Request #	: 000013965010
Design Number	: 000001136599
Designer/Planner ID	: PFTJ01
Designer/Planner Name	:
Designer/Planner Ph #	: (612) 963-3804
Manager Approval	:

Joint Utility	
E:	G:
T:	C:

Design Location	
Division	: Maple Grove
County	: HENNEPIN
City	: MAPLE GROVE
Address	: TERRITORIAL RD
T: 119N	R: 22W S: 4
Map #	: K51084 Permit :

Electric	
Feeder: ECK322	Voltage: 34.5KV
Phase: ABC	Bkup Dev ID:

Gas	
System	: Pressure :
Size	: Material :
Dead End	:

Work Order # :
Date: 08/14/2023
Sketch: 1 Of 1 Sketch Data
Scale: 1" equals 108'



CONSTRUCTION USE ONLY

NO CHANGES (BUILT AS DESIGNED)
 CHANGES MADE AS INDICATED
(ALL URD MUST HAVE ACTUAL MEASUREMENTS FROM THE FIELD SITE)

RFO _____
FOREMAN _____ DATE _____
TEAM LEADER _____

DISCLAIMER: THERE ARE NO REPRESENTATIONS OR WARRANTIES (EXPRESS OR IMPLIED) ABOUT THE ACCURACY OF THIS PRINT. THIS PRINT IS PROVIDED WITH NO CLAIM AS TO PRINT COMPLETENESS, TIMELINESS, ACCURACY OF CONTENT OR USEFULNESS. STATE LAW REQUIRES ANYONE DIGGING, GRADING OR EXCAVATING TO OBTAIN A PRIOR FIELD LOCATE OF ALL UTILITIES. THIS PRINT DOES NOT DISCHARGE THIS REQUIREMENT OR ANY OTHER REQUIREMENT. THE COMPANY AND ITS AFFILIATES ASSUME NO LEGAL RESPONSIBILITY OR LIABILITY FOR THE RECIPIENT'S USE (OR ANY OTHER PARTIES' USE) OF THE PRINT, INCLUDING THE RECIPIENT'S INTENDED PURPOSE IN USING THE PRINT. NO COMPANY EMPLOYEE OR OTHER PARTY HAS BEEN AUTHORIZED TO PROVIDE THIS PRINT FOR PLANNING OR ESTIMATING PURPOSES; RELY ON THIS PRINT AT YOUR OWN RISK. BY ACCEPTING THIS PRINT, THE RECIPIENT & ANY OTHER PARTY RECEIVING A COPY OF THE PRINT ACKNOWLEDGES AND AGREES TO THIS DISCLAIMER. For All Field Locates Call 811