

**CenturyLink BSW Order/Maintenance Work Authorization**

Company	Exchange Name	MPGVMNXA	Service Order#	2333031	
Work Activity	Fiber-Buried	Capital	N	Maintenance	Y
Customer Name	MATTEW HAGEL		Phone#		
Address	18443 70TH AVE N		One Call Ticket#		
City & Zip	MAPLE GROVE, MN 55311				
Location/Directions					
Description of Work or Special Instructions					

Held Order	N	Permit:	Y	Bore:	Y	CBR#	
Tech Name and Tech #	Mamadee Keita - AD22553			Employee Contact#	404-317-5848		

Sketch (Include Cntr Line & Pedestal)	Material/Labor Units		Footage/Quantity	Comments
	Description	Notes		
Cntr Line foot	SEB3-22	BSW-3 & plow plcmt		
	SEB3-22T	BSW-3 & hand dig plcmt		
Ped#	SEPCUTOVER	CUTOVER BSW	1	
Parish/County	BM83	BSW guard at house	1	
	XXSEB-GL	Remove temp drop	200	Footage when temp can't be re-used
Township:	BM61(1.25)SEB	BSW Bore footage	71	
Section	SEBO PER FT LBR	Fiber & plow plcmt	64	
Range	SEBO PER FT LBR T	Fiber & hand dig plcmt		
	SEB6-22	BSW-6 & plow plcmt		
	BM2(5/8)(8)	Ground Rod		
	SEBO-COIL	Fiber Coil	1	Coil excess on Fiber drop add 1 unit
	Permit	Permit	1	Any placement within the ROW requires a permit

Nearest cross st.		Plat Page		Map#	
-------------------	--	-----------	--	------	--

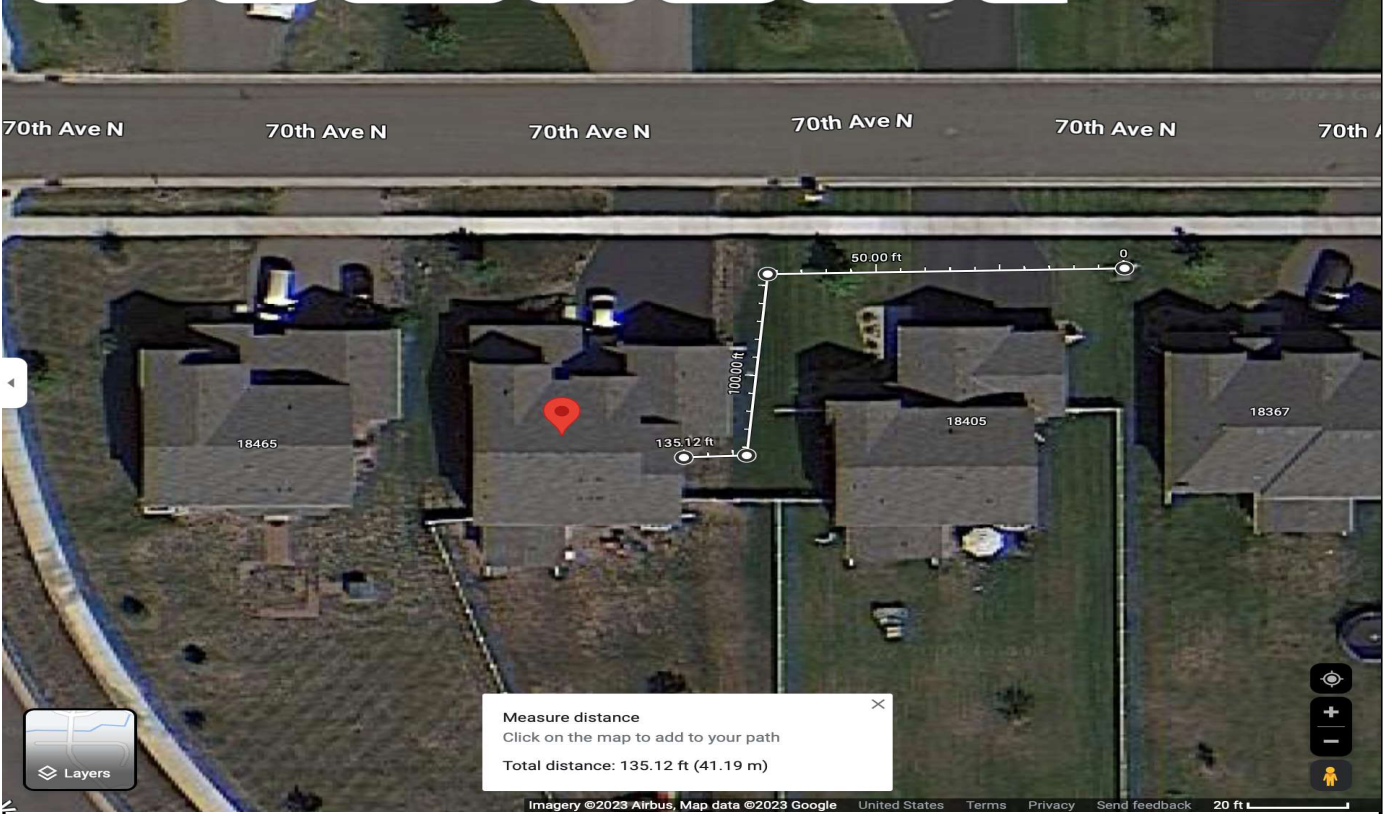

Originated By:	MAMADEE KEITA	Date:	7/31/23	Completed By:		Date:	
Authorized By: (SRO)		Date:		Inspected By:		Date:	
Authorized By: (MRO)		Date:					

1. Distance of the bury in Right-of-Way		3. Distance to the nearest intersection	
2. Distance from the terminal to the centerline		4. Nearest State Hwy mile marker	