

**S-1: Relocate underground service going to 8206 Walnut Grove Ln. 2" directional bore 150' 4/0 Triplex along new service path. 6 potholes needed. Approx every 25'.**

**S-2: Abandon previous service.**

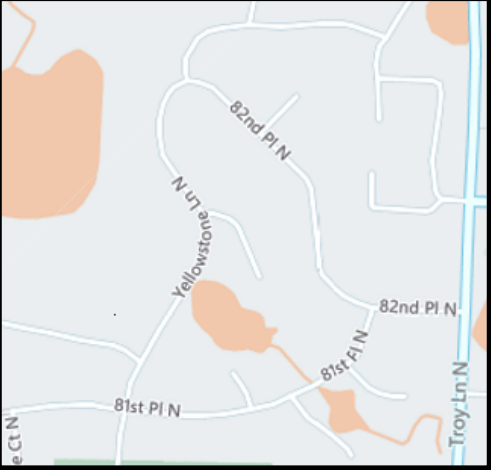
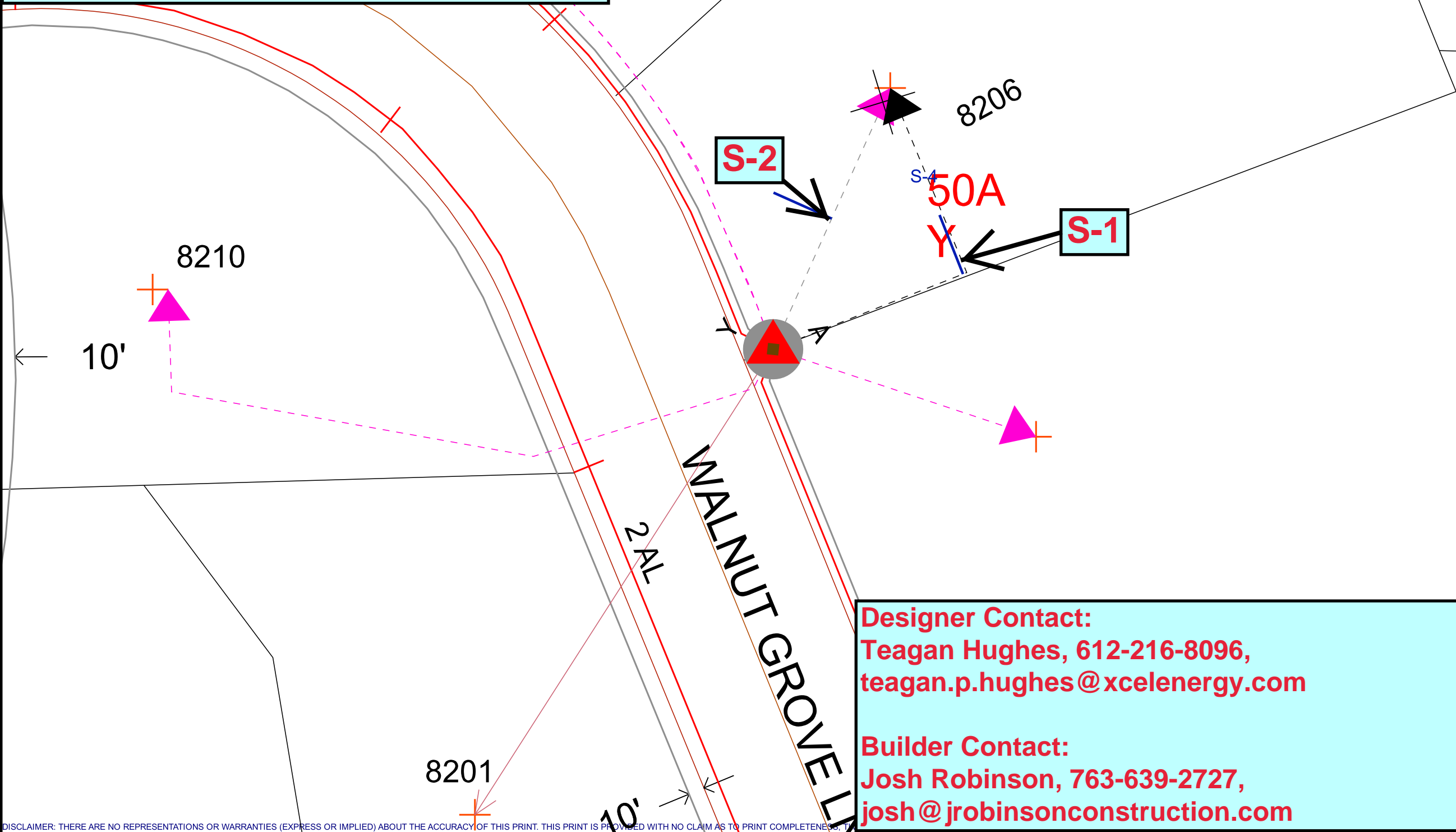

**Feeder Map:  
ECK322 - 13.8KV 4/7**

Work Order Information	
Service Request #	: 000013839525
Design Number	: 000001130353
Designer/Planner ID	: 310648
Designer/Planner Name	: Teagan Hughes
Designer/Planner Ph #	: (612) 216-8096
Manager Approval	: _____

Joint Utility	
E:	G:
T:	C:

Design Location	
Division	: Maple Grove
County	: Hennepin
City	: Maple Grove
Address	: 8206 Walnut Grove Ln
T: 119N	R: 22W S: 19
Map #	: J52070 Permit : _____

Electric	
Feeder: ECK322	Voltage: 7970
Phase:	Bkup Dev ID:

Gas	
System	: Pressure :
Size	: Material :
Dead End	:

Work Order # : \_\_\_\_\_  
 Date: 06/23/2023  
 Sketch: 1 Of 1 Sketch Data  
 Scale: 1" equals 33'



**Designer Contact:**  
 Teagan Hughes, 612-216-8096,  
 teagan.p.hughes@xcelenergy.com

**Builder Contact:**  
 Josh Robinson, 763-639-2727,  
 josh@jrobinsonconstruction.com

**CONSTRUCTION USE ONLY**

NO CHANGES (BUILT AS DESIGNED)  
 CHANGES MADE AS INDICATED  
 (ALL URD MUST HAVE ACTUAL MEASUREMENTS FROM THE FIELD SITE)

RFO \_\_\_\_\_  
 FOREMAN \_\_\_\_\_ DATE \_\_\_\_\_  
 TEAM LEADER \_\_\_\_\_

DISCLAIMER: THERE ARE NO REPRESENTATIONS OR WARRANTIES (EXPRESS OR IMPLIED) ABOUT THE ACCURACY OF THIS PRINT. THIS PRINT IS PROVIDED WITH NO CLAIM AS TO PRINT COMPLETENESS, THE EXCAVATING TO OBTAIN A PRIOR FIELD LOCATE OF ALL UTILITIES. THIS PRINT DOES NOT DISCHARGE THIS REQUIREMENT OR ANY OTHER REQUIREMENT. THE COMPANY AND ITS AFFILIATES ASSUME NO LEGAL RESPONSIBILITY OR LIABILITY FOR THE RECIPIENT'S USE (OR ANY OTHER PARTIES' USE) OF THE PRINT, INCLUDING THE RECIPIENTS INTENDED PURPOSE IN USING THE PRINT. NO COMPANY EMPLOYEE OR OTHER PARTY HAS BEEN AUTHORIZED TO PROVIDE THIS PRINT FOR PLANNING OR ESTIMATING PURPOSES; RELY ON THIS PRINT AT YOUR OWN RISK. BY ACCEPTING THIS PRINT, THE RECIPIENT & ANY OTHER PARTY RECEIVING A COPY OF THE PRINT ACKNOWLEDGES AND AGREES TO THIS DISCLAIMER. For All Field Locates Call 811

THIS DOCUMENT IS XCEL ENERGY CONFIDENTIALS AND PROPRIETARY INFORMATION AND MAY NOT BE REPRODUCED IN WHOLE, OR IN PART, NOR MAY ANY OF THE INFORMATION CONTAINED HEREIN BE DISCLOSED WITHOUT THE CONSENT OF XCEL ENERGY. CONFIDENTIALS AND PROPRIETARY INFORMATION © 2019 XCEL ENERGY INC. | XCEL ENERGY IS REGISTERED TRADEMARK OF XCEL ENERGY INC