

ESCALATED CABLE FAULT
 13604 80TH CIR
 MAPLE GROVE

SP804147

PERMIT REQUIRED

SERVICE CENTER: MAPLE GROVE

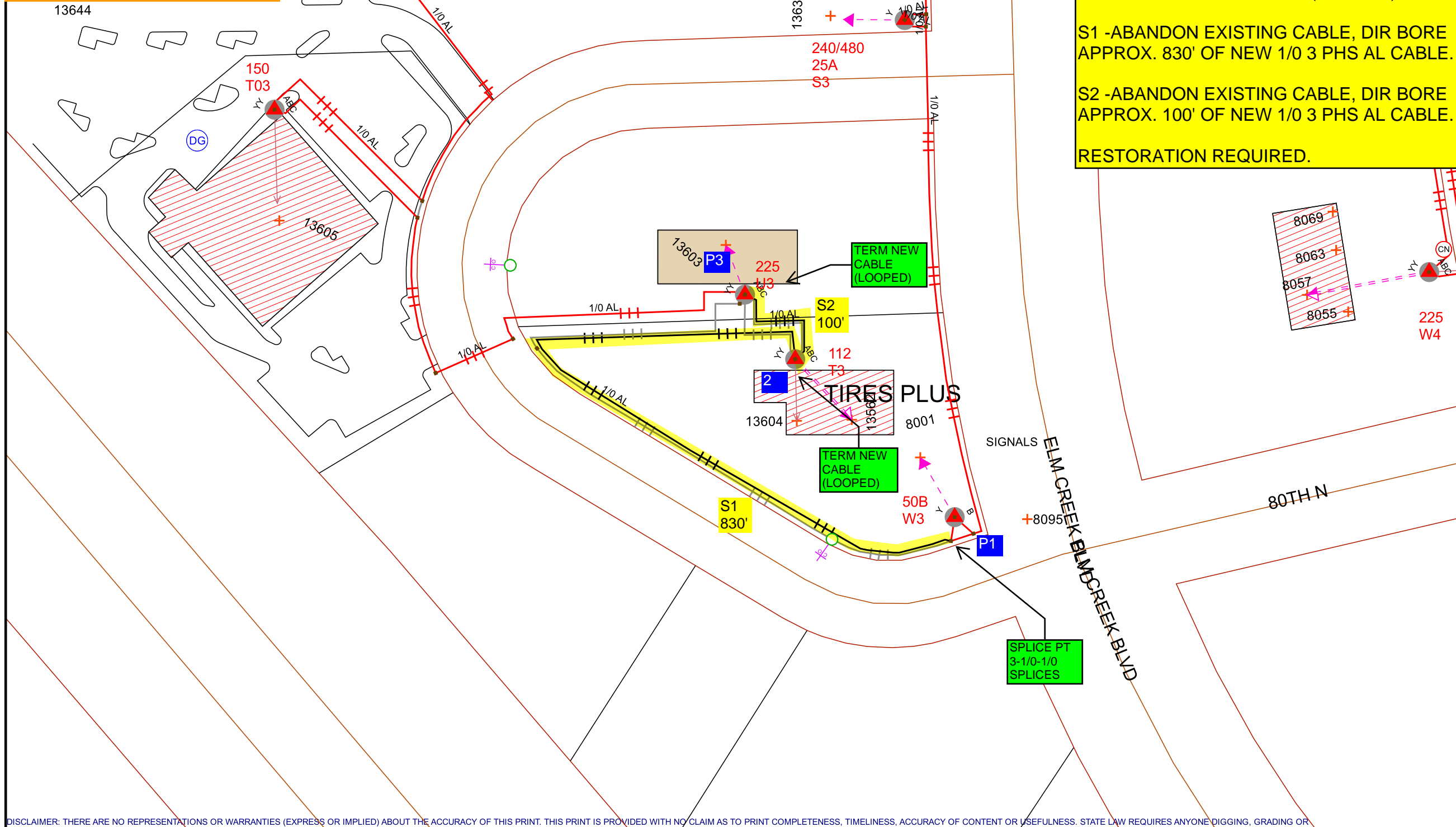

FEEDER ECK063

PHASE ABC

VOLTAGE 15 KV

P1 -SPLICE PT-3-1/0 -1/0 SPLICES

P2 -T3- TERM NEW CABLE (LOOPED)

P3 -U3- TERM NEW CABLE (LOOPED)

S1 -ABANDON EXISTING CABLE, DIR BORE APPROX. 830' OF NEW 1/0 3 PHS AL CABLE.

S2 -ABANDON EXISTING CABLE, DIR BORE APPROX. 100' OF NEW 1/0 3 PHS AL CABLE.

RESTORATION REQUIRED.

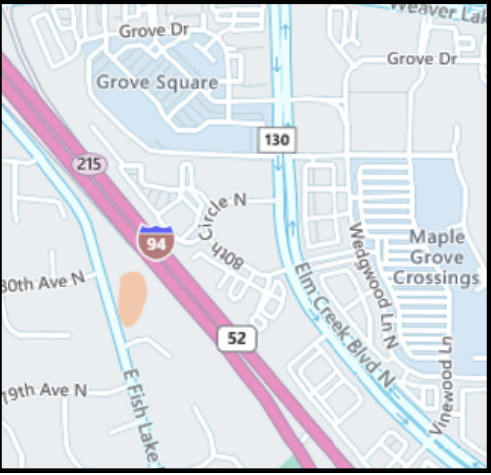

DESIGNER:
 JAYMIE HOLTE
 EMAIL: JAYMIE.L.HOLTE@XCELENERGY.
 PHONE: 608-799-3001

Work Order Information	
Service Request #	: 000013847337
Design Number	: 000001129914
Designer/Planner ID	: W37797
Designer/Planner Name	: J. HOLTE
Designer/Planner Ph #	: 608-799-3001
Manager Approval	:

Joint Utility	
E:	G:
T:	C:

Design Location	
Division	: Maple Grove
County	: Hennepin
City	: Maple Grove
Address	:
T: 119N	R: 22W S: 22
Map #	: K52076 Permit :

Electric	
Feeder: ECK063	Voltage: 15 KV
Phase: ABC	Bkup Dev ID:

Gas	
System	: Pressure :
Size	: Material :
Dead End	:

Work Order # :

Date: 06/14/2023

Sketch: 1 OF 1

Scale: 1" equals 100'

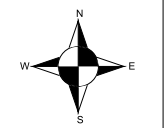

CONSTRUCTION USE ONLY

NO CHANGES (BUILT AS DESIGNED)

CHANGES MADE AS INDICATED (ALL URD MUST HAVE ACTUAL MEASUREMENTS FROM THE FIELD SITE)

RFO _____
 FOREMAN _____ DATE _____
 TEAM LEADER _____

DISCLAIMER: THERE ARE NO REPRESENTATIONS OR WARRANTIES (EXPRESS OR IMPLIED) ABOUT THE ACCURACY OF THIS PRINT. THIS PRINT IS PROVIDED WITH NO CLAIM AS TO PRINT COMPLETENESS, TIMELINESS, ACCURACY OF CONTENT OR USEFULNESS. STATE LAW REQUIRES ANYONE DIGGING, GRADING OR EXCAVATING TO OBTAIN A PRIOR FIELD LOCATE OF ALL UTILITIES. THIS PRINT DOES NOT DISCHARGE THIS REQUIREMENT OR ANY OTHER REQUIREMENT. THE COMPANY AND ITS AFFILIATES ASSUME NO LEGAL RESPONSIBILITY OR LIABILITY FOR THE RECIPIENT'S USE (OR ANY OTHER PARTIES' USE) OF THE PRINT, INCLUDING THE RECIPIENT'S INTENDED PURPOSE IN USING THE PRINT. NO COMPANY EMPLOYEE OR OTHER PARTY HAS BEEN AUTHORIZED TO PROVIDE THIS PRINT FOR PLANNING OR ESTIMATING PURPOSES; RELY ON THIS PRINT AT YOUR OWN RISK. BY ACCEPTING THIS PRINT, THE RECIPIENT & ANY OTHER PARTY RECEIVING A COPY OF THE PRINT ACKNOWLEDGES AND AGREES TO THIS DISCLAIMER. For All Field Locates Call 811

THIS DOCUMENT IS XCEL ENERGY CONFIDENTIALS AND PROPRIETARY INFORMATION AND MAY NOT BE REPRODUCED IN WHOLE, OR IN PART, NOR MAY ANY OF THE INFORMATION CONTAINED HEREIN BE DISCLOSED WITHOUT THE CONSENT OF XCEL ENERGY. CONFIDENTIALS AND PROPRIETARY INFORMATION © 2019 XCEL ENERGY INC. | XCEL ENERGY IS REGISTERED TRADEMARK OF XCEL ENERGY INC