

15835 73RD CIRCLE N  
 ID: 38471595  
 POI: K304 B02  
 ECK062/B/7.97kV

TASK 1: DIRECTIONAL BORE  
 BORE IN 140' OF 350 TRIPLEX CABLE P1 TO P2

TASK 2: TERMINATION  
 TERMINATE AT P1 AND P2

TASK 3: RESTORATION

NOTE: ABANDON EXISTING SVC CABLE IN PLACE  
 REMOVE LANDSCAPE AT SECONDARY PEDESTAL  
 REPLACE PADLOCKS ON TRANSFORMER AND PEDESTAL

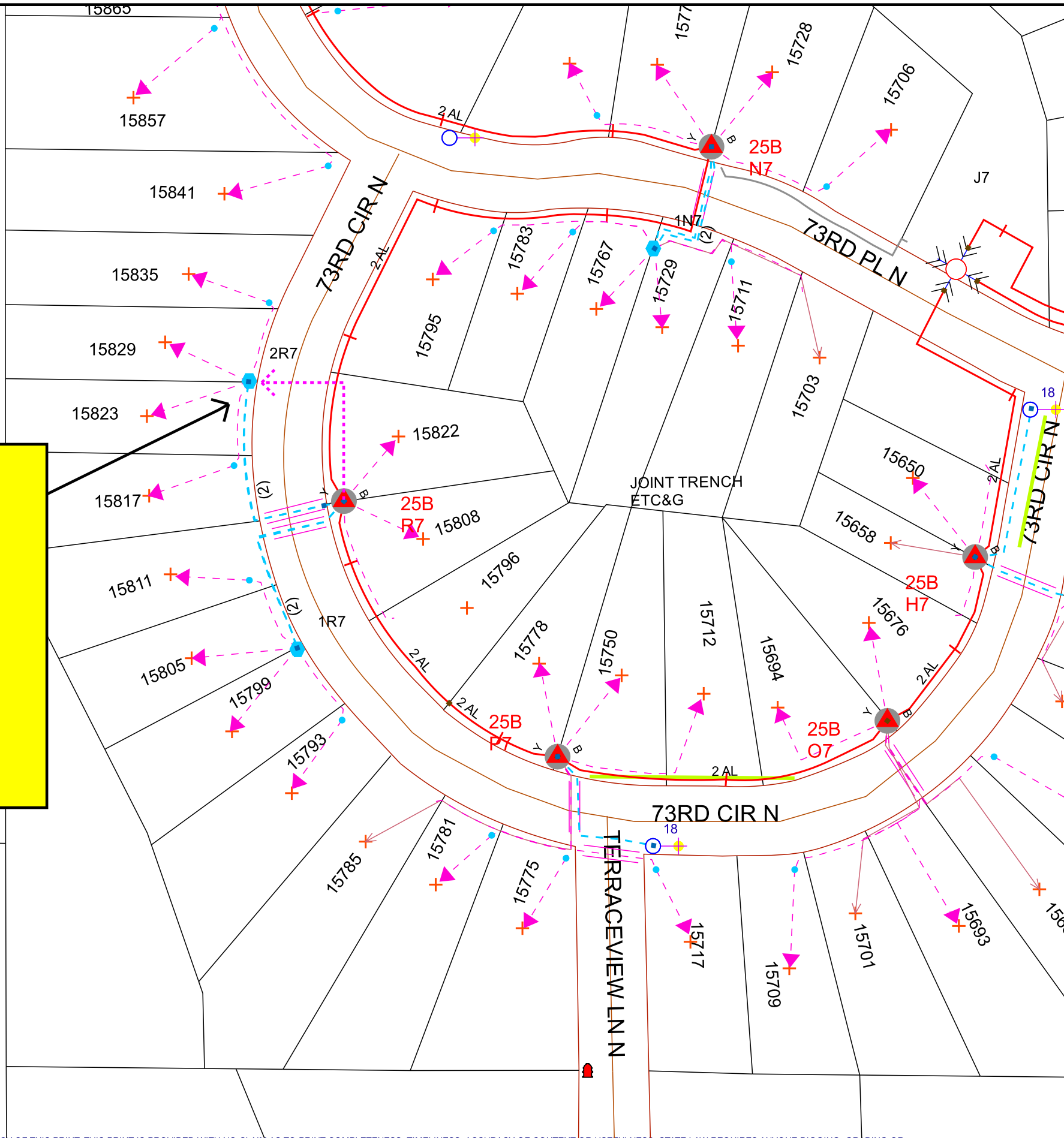

**Work Order Information**

Service Request #	:	
Design Number	:	000001123565
Designer/Planner ID	:	304559
Designer/Planner Name	:	Hannah Sayre
Designer/Planner Ph #	:	(816) 394-2303
Manager Approval	:	

**Joint Utility**

E:	G:
T:	C:

**Design Location**

Division	:	Maple Grove
County	:	Hennepin
City	:	Maple Grove
Address	:	15835 73rd Circle N
T: 119N	R: 22W	S: 28
Map #	:	K53004
Permit	:	Maple Grove

**Electric**

Feeder: ECK062	Voltage: 7.9kV
Phase: B	Bkup Dev ID:

**Gas**

System	:	Pressure	:
Size	:	Material	:
Dead End	:		

Work Order # : 00000109527136

Date: 05/02/2023  
 Sketch: 1 Of 1 Sketch Data  
 Scale: 1" equals 83'

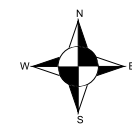

**CONSTRUCTION USE ONLY**

- NO CHANGES (BUILT AS DESIGNED)
- CHANGES MADE AS INDICATED (ALL URD MUST HAVE ACTUAL MEASUREMENTS FROM THE FIELD SITE)

RFO \_\_\_\_\_  
 FOREMAN \_\_\_\_\_ DATE \_\_\_\_\_  
 TEAM LEADER \_\_\_\_\_

DISCLAIMER: THERE ARE NO REPRESENTATIONS OR WARRANTIES (EXPRESS OR IMPLIED) ABOUT THE ACCURACY OF THIS PRINT. THIS PRINT IS PROVIDED WITH NO CLAIM AS TO PRINT COMPLETENESS, TIMELINESS, ACCURACY OF CONTENT OR USEFULNESS. STATE LAW REQUIRES ANYONE DIGGING, GRADING OR EXCAVATING TO OBTAIN A PRIOR FIELD LOCATE OF ALL UTILITIES; THIS PRINT DOES NOT DISCHARGE THIS REQUIREMENT OR ANY OTHER REQUIREMENT. THE COMPANY AND ITS AFFILIATES ASSUME NO LEGAL RESPONSIBILITY OR LIABILITY FOR THE RECIPIENT'S USE (OR ANY OTHER PARTIES' USE) OF THE PRINT, INCLUDING THE RECIPIENT'S INTENDED PURPOSE IN USING THE PRINT. NO COMPANY EMPLOYEE OR OTHER PARTY HAS BEEN AUTHORIZED TO PROVIDE THIS PRINT FOR PLANNING OR ESTIMATING PURPOSES; RELY ON THIS PRINT AT YOUR OWN RISK. BY ACCEPTING THIS PRINT, THE RECIPIENT & ANY OTHER PARTY RECEIVING A COPY OF THE PRINT ACKNOWLEDGES AND AGREES TO THIS DISCLAIMER. For All Field Locates Call 811