

Work Location

9839 89th Ave N
MAPLE GROVE, MN
55369

Job Description

PLACE ONE PRO14
PEDESTAL AND APPROX. 6
FEET OF CABLE OUT OF
THE EXISING MANHOLE.
PLACEMENT SHOULD BE
DIRECTLY TO THE SOUTH
OF THE MANHOLE IN THE
CITY ROW.

PROJECT: **N.219436** REVISION

CENTURYLINK
ENGINEER:
Todd Paulson
PHONE:
651 312 5527
EMAIL:
Todd.Paulson@CenturyLink.com

POWER ENGINEERS
DRAWN BY:
Warren Opheim
EMAIL:
warren.opheim@powereng.com
FIELD ENGINEER:

SHEET: 01 REV: 01
OF: 03 DATE: 2/23/2017



SCALE: N.A.

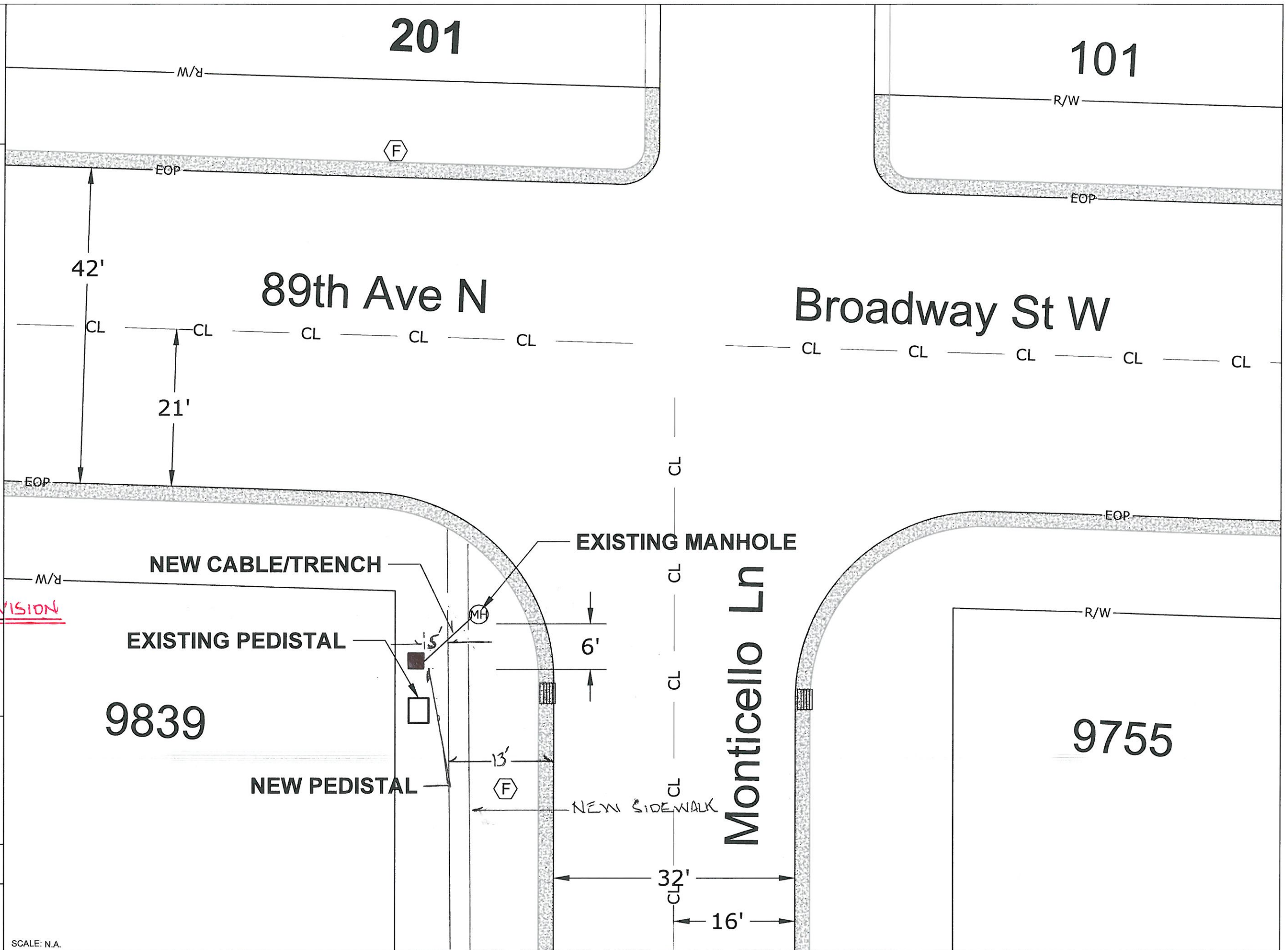

201

101

89th Ave N

Broadway St W

Monticello Ln

9839

9755

NEW CABLE/TRENCH

EXISTING PEDISTAL

NEW PEDISTAL

EXISTING MANHOLE

NEW SIDEWALK