

Revised 05-27-2021	State	MN	Contractor	MN Metro	CMS#	23032402
<b>CenturyLink BSW Order/Maintenance Work Authorization</b>						
Company	Exchange Name	MPGVMNXA			Service Order#	1500108658
Work Activity	Fiber-Buried	Capital	Y	Maintenance	N	
Customer Name	BILLY ROISUM			Phone#		
Address	10787 SUNDANCE BLVD N			One Call Ticket#		
City & Zip	MAPLE GROVE, MN					
Location/Directions						
Description of Work or Special Instructions						

Held Order	N	Permit:	Y	Bore:	Y	CBR#	
Tech Name and Tech #	Mamadee Keita - AD22553			Employee Contact#	404-317-5848		
Sketch (Include Cntr Line & Pedestal)	Material/Labor Units			Footage/Quantity	Comments		
	Description	Notes					
Cntr Line foot	SEB3-22	BSW-3 & plow plcmt					
	SEB3-22T	BSW-3 & hand dig plcmt					
Ped#	SEPCUTOVER	CUTOVER BSW		1			
Parish/County	BM83	BSW guard at house		1			
	XXSEB-GL	Remove temp drop		300	Footage when temp can't be re-used		
Township:	BM61(1.25)SEB	BSW Bore footage		121			
Section	SEBO PER FT LBR	Fiber & plow plcmt		43			
Range	SEBO PER FT LBR T	Fiber & hand dig plcmt					
	SEB6-22	BSW-6 & plow plcmt					
	BM2(5/8)(8)	Ground Rod					
	SEBO-COIL	Fiber Coil		1	Coil excess on Fiber drop add 1 unit		
	Permit	Permit		1	Any placement within the ROW requires a permit		
Nearest cross st.				Plat Page		Map#	

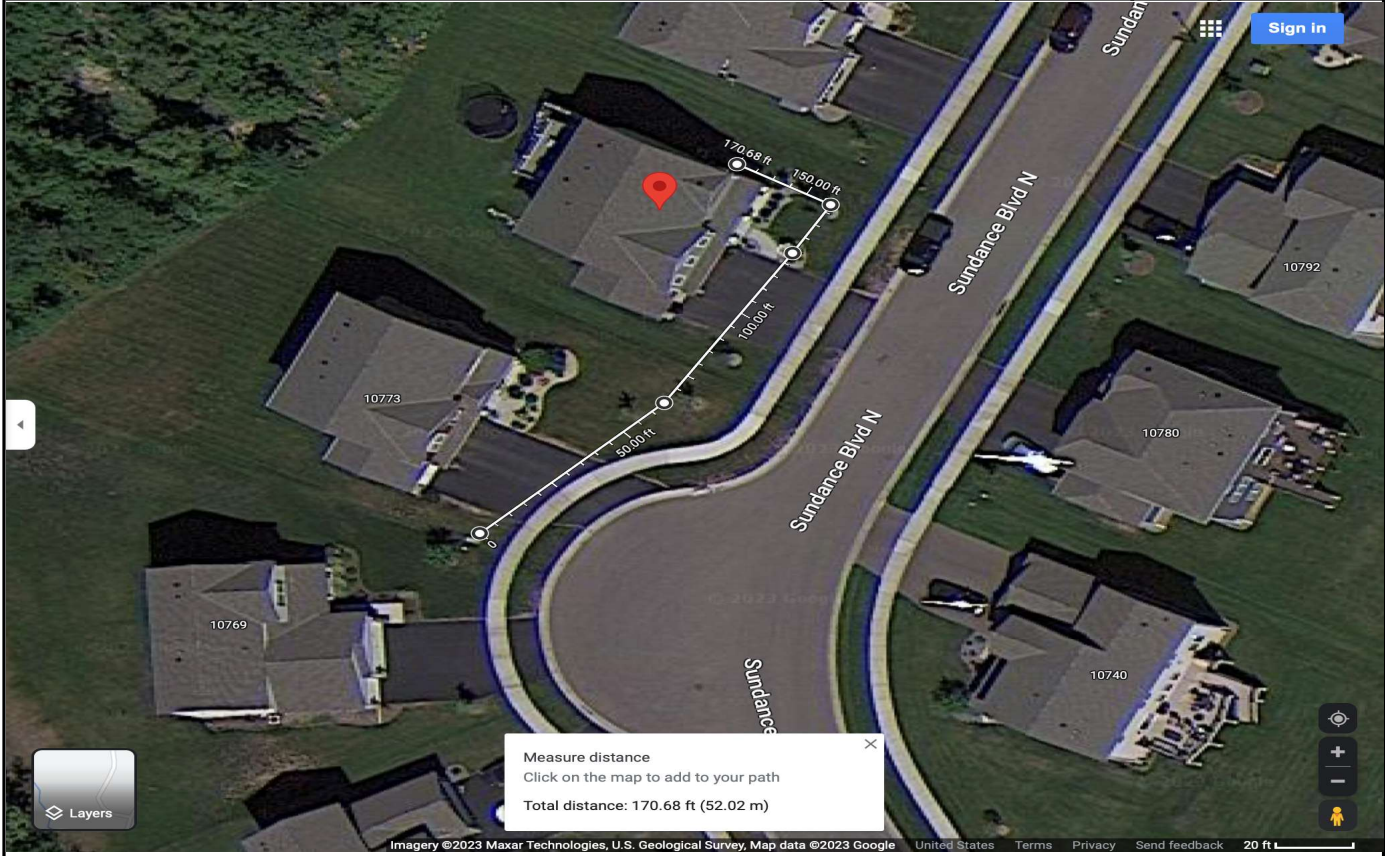

Originated By:	MAMADEE KEITA	Date:	3/14/23	Completed By:		Date:	
Authorized By: (SRO)		Date:		Inspected By:		Date:	
Authorized By: (MRO)		Date:					
Email sketch to:							

1. Distance of the bury in Right-of-Way		3. Distance to the nearest intersection	
2. Distance from the terminal to the centerline		4. Nearest State Hwy mile marker	