

Revised 05-27-2021	State	MN	Contractor	MN Metro	CMS#	23034803-HELD
<b>CenturyLink BSW Order/Maintenance Work Authorization</b>						
Company	Exchange Name	OSSEMNXO			Service Order#	SA-4381827
Work Activity	Fiber-Buried	Capital	Y	Maintenance	N	
Customer Name	PETRU TUREA			Phone#	(150) 010-9583	
Address	11908 85th pl n			One Call Ticket#		
City & Zip	MAPLE GROVE, MN					
Location/Directions	SEE SKETCH FOR DETAILS					
Description of Work or Special Instructions	SEE SKETCH FOR DETAILS					

Held Order	Y	Permit:	Y	Bore:	Y	CBR#	7635686539
Tech Name and Tech #	AA10109			Employee Contact#	7632288645		
Sketch (Include Cntr Line & Pedestal)	Material/Labor Units			Footage/Quantity	Comments		
	Description	Notes					
Cntr Line foot	SEB3-22	BSW-3 & plow plcmt					
	SEB3-22T	BSW-3 & hand dig plcmt					
Ped#	SEE SKETCH	SEPCUTOVER					
Parish/County	BM83	BSW guard at house		1			
	XXSEB-GL	Remove temp drop			Footage when temp can't be re-used		
Township:	NA	BM61(1.25)SEB	BSW Bore footage	18			
Section	NA	SEBO PER FT LBR	Fiber & plow plcmt	100			
Range	NA	SEBO PER FT LBR T	Fiber & hand dig plcmt				
		SEB6-22	BSW-6 & plow plcmt				
		BM2(5/8)(8)	Ground Rod				
		SEBO-COIL	Fiber Coil	1	Coil excess on Fiber drop add 1 unit		
		Permit	Permit	1	Any placement within the ROW requires a permit		
Nearest cross st.	SEE SKETCH			Plat Page	Map#		

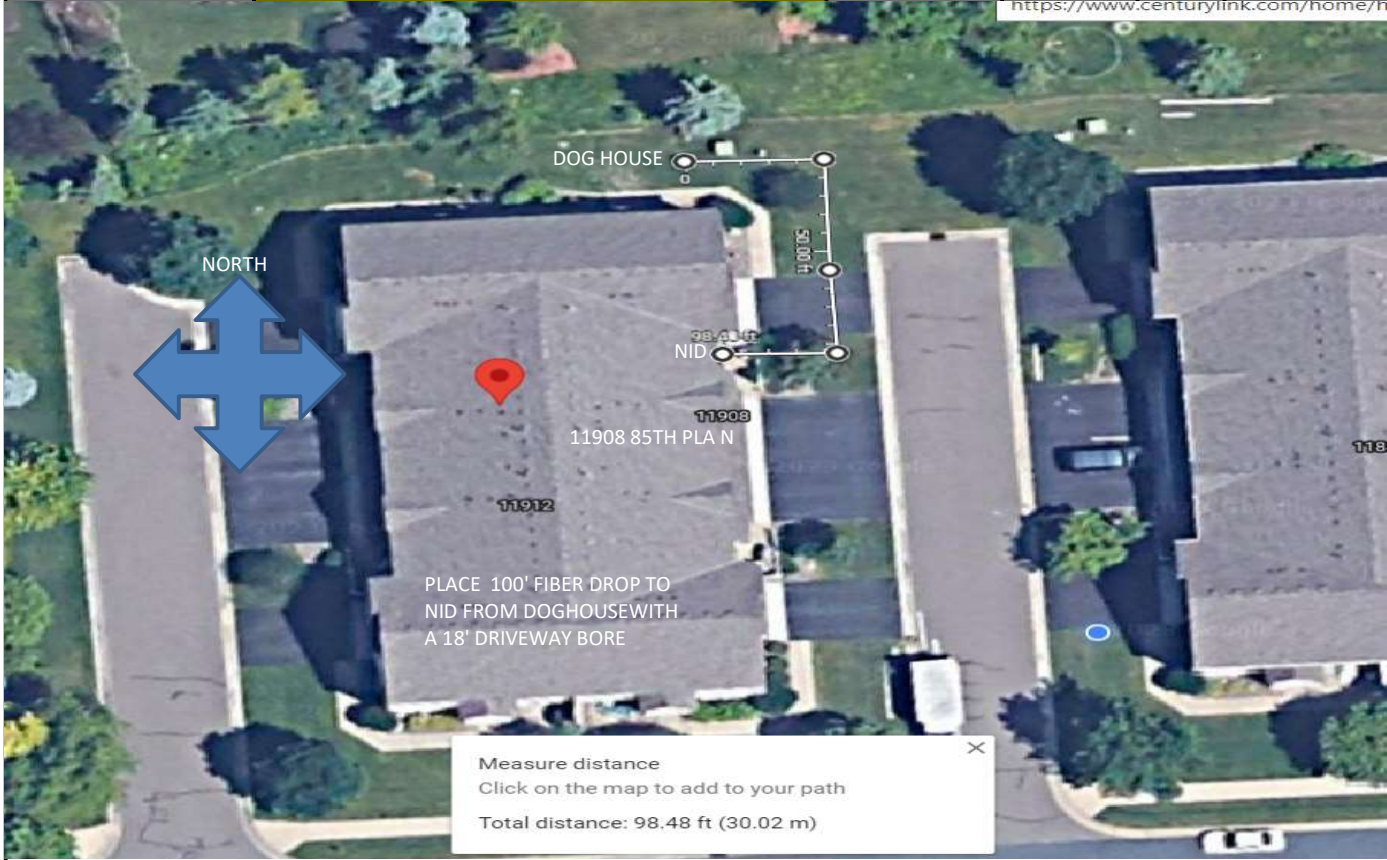

Originated By:	AA10109	Date:	3/20/23	Completed By:		Date:	
Authorized By: (SRO)		Date:		Inspected By:		Date:	
Authorized By: (MRO)		Date:					

Email sketch to:

1. Distance of the bury in Right-of-Way		3. Distance to the nearest intersection	
2. Distance from the terminal to the centerline		4. Nearest State Hwy mile marker	