

CITY OF MAPLE GROVE-WEAVER LK RD, MG UG
 Relocate for retaining wall.
 Directional Bore 750AL feeder cables &
 1/0 3PH cables- splice.

ECK082- 13.8KV (2/2)



Ryan Sunram w/ Sunram
 Const-612-282-3952
 Designer-
 John Pfothenauer 612-963-3804

Work Order Information	
Service Request #	000013357148
Design Number	000001092017
Designer/Planner ID	PFTJ01
Designer/Planner Name	
Designer/Planner Ph #	(612) 630-4322
Manager Approval	

Joint Utility	
E:	G:
T:	C:

Design Location	
Division	Maple Grove
County	HENNEPIN
City	MAPLE GROVE
Address	WEAVER LAKE RD
T: 119N	R: 22W S: 17
Map #	K52053 Permit :

Electric	
Feeder: ECK082	Voltage: 13.8 KV
Phase: ABC	Bkup Dev ID:

Gas	
System :	Pressure :
Size :	Material :
Dead End :	

Work Order # :
 Date: 09/19/2022
 Sketch: 1 Of 1 Sketch Data
 Scale: 1" equals 100'



CONSTRUCTION USE ONLY

NO CHANGES (BUILT AS DESIGNED)
 CHANGES MADE AS INDICATED
 (ALL URD MUST HAVE ACTUAL MEASUREMENTS FROM THE FIELD SITE)

RFO _____
 FOREMAN _____ DATE _____
 TEAM LEADER _____

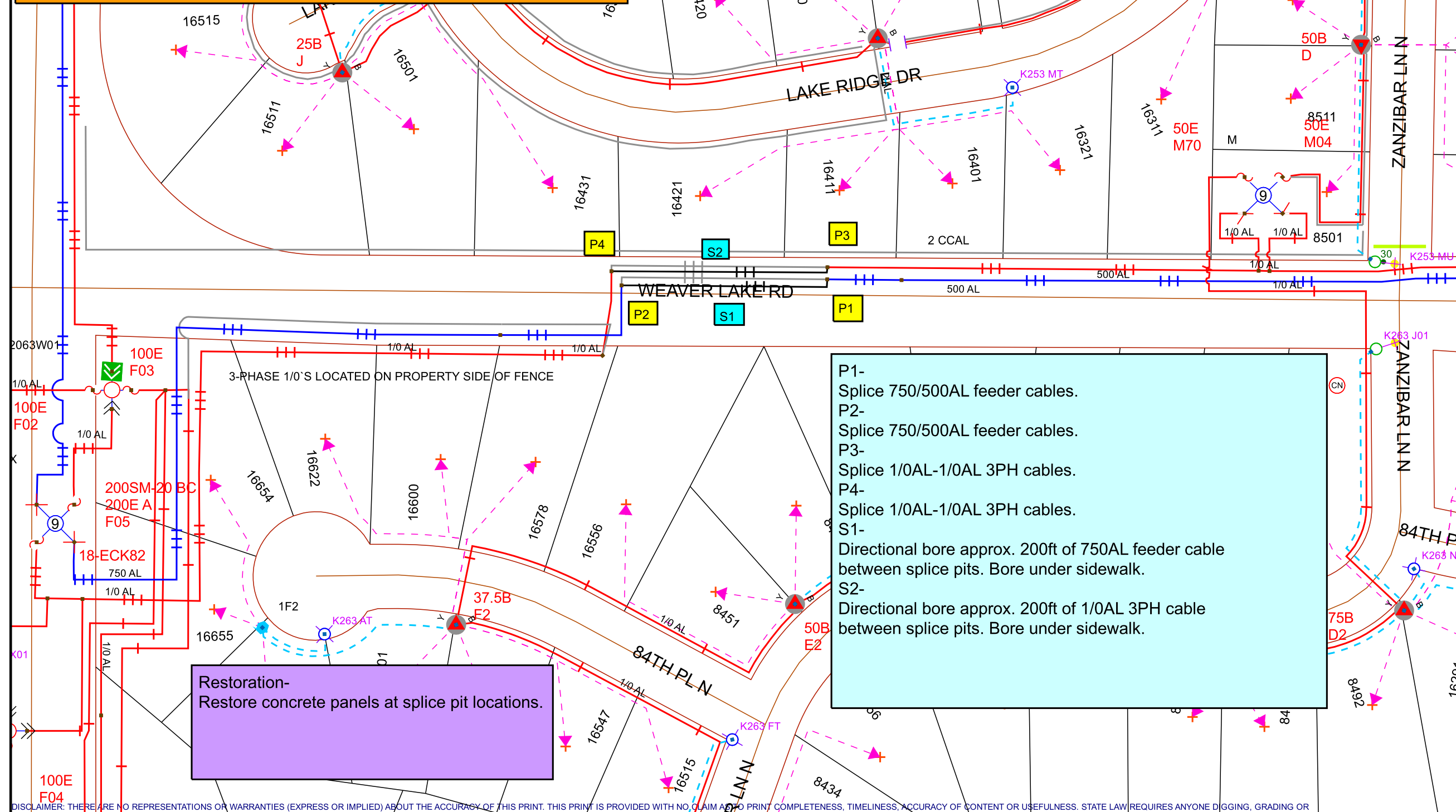

P1-
 Splice 750/500AL feeder cables.
P2-
 Splice 750/500AL feeder cables.
P3-
 Splice 1/0AL-1/0AL 3PH cables.
P4-
 Splice 1/0AL-1/0AL 3PH cables.
S1-
 Directional bore approx. 200ft of 750AL feeder cable between splice pits. Bore under sidewalk.
S2-
 Directional bore approx. 200ft of 1/0AL 3PH cable between splice pits. Bore under sidewalk.

Restoration-
 Restore concrete panels at splice pit locations.

DISCLAIMER: THERE ARE NO REPRESENTATIONS OR WARRANTIES (EXPRESS OR IMPLIED) ABOUT THE ACCURACY OF THIS PRINT. THIS PRINT IS PROVIDED WITH NO CLAIM AS TO PRINT COMPLETENESS, TIMELINESS, ACCURACY OF CONTENT OR USEFULNESS. STATE LAW REQUIRES ANYONE DIGGING, GRADING OR EXCAVATING TO OBTAIN A PRIOR FIELD LOCATE OF ALL UTILITIES. THIS PRINT DOES NOT DISCHARGE THIS REQUIREMENT OR ANY OTHER REQUIREMENT. THE COMPANY AND ITS AFFILIATES ASSUME NO LEGAL RESPONSIBILITY OR LIABILITY FOR THE RECIPIENT'S USE (OR ANY OTHER PARTIES' USE) OF THE PRINT, INCLUDING THE RECIPIENT'S INTENDED PURPOSE IN USING THE PRINT. NO COMPANY EMPLOYEE OR OTHER PARTY HAS BEEN AUTHORIZED TO PROVIDE THIS PRINT FOR PLANNING OR ESTIMATING PURPOSES; RELY ON THIS PRINT AT YOUR OWN RISK. BY ACCEPTING THIS PRINT, THE RECIPIENT & ANY OTHER PARTY RECEIVING A COPY OF THE PRINT ACKNOWLEDGES AND AGREES TO THIS DISCLAIMER. For All Field Locates Call 811

THIS DOCUMENT IS XCEL ENERGY CONFIDENTIALS AND PROPRIETARY INFORMATION AND MAY NOT BE REPRODUCED IN WHOLE, OR IN PART, NOR MAY ANY OF THE INFORMATION CONTAINED HEREIN BE DISCLOSED WITHOUT THE CONSENT OF XCEL ENERGY. CONFIDENTIALS AND PROPRIETARY INFORMATION © 2019 XCEL ENERGY INC. | XCEL ENERGY IS REGISTERED TRADEMARK OF XCEL ENERGY INC