

REPLACE PMH-9 'R' WITH 3 PHASE FUSED LBC CABINET STENCIL - L51071W01
 TWO FUSED POSITIONS
 50E FUSES
 POI - L51071F03 TO TR-D7, TR-J7, TR-D9
 POI - L51071F04 TO TR-O6, TR-T5, TR-T4
 INSTALL FAULT INDICATOR TO TP-J70

INSTALL FAULT INDICATOR

INSTALL FAULT INDICATOR

INSTALL FAULT INDICATOR

INSTALL FAULT INDICATOR

INSTALL FAULT INDICATOR

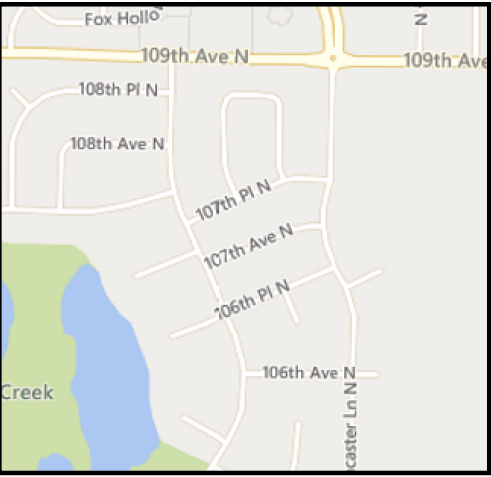

DESIGNER:
 JOSH WUBBENA
 C: 763.350.6346

Work Order Information	
Service Request #	:
Design Number	: 000001073087
Designer/Planner ID	: wbbj96
Designer/Planner Name	: Wubbena, Joshua
Designer/Planner Ph #	: 763.493.1649
Manager Approval	:

Joint Utility	
E:	G:
T:	C:

Design Location	
Division	: MAPLE GROVE
County	: HENNEPIN
City	: MAPLE GROVE
Address	: 10703 NATHAN LN N
T: 119N	R: 22W S: 1
Map #	: L51071 Permit :

Electric	
Feeder: WCR321	Voltage: 13800
Phase: ABC	Bkup Dev ID:

Gas	
System :	Pressure :
Size :	Material :
Dead End :	

Work Order # :
 Date: 05/19/2022
 Sketch: 1 Of 1 Sketch Data
 Scale: 1" equals 100'

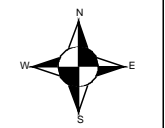

- CONSTRUCTION USE ONLY**
- NO CHANGES (BUILT AS DESIGNED)
 - CHANGES MADE AS INDICATED (ALL URD MUST HAVE ACTUAL MEASUREMENTS FROM THE FIELD SITE)

RFO _____
 FOREMAN _____ DATE _____
 TEAM LEADER _____

DISCLAIMER: THERE ARE NO REPRESENTATIONS OR WARRANTIES (EXPRESS OR IMPLIED) ABOUT THE ACCURACY OF THIS PRINT. THIS PRINT IS PROVIDED WITH NO CLAIM AS TO PRINT COMPLETENESS, TIMELINESS, ACCURACY OF CONTENT OR USEFULNESS. STATE LAW REQUIRES ANYONE DIGGING, GRADING OR EXCAVATING TO OBTAIN A PRIOR FIELD LOCATE OF ALL UTILITIES. THIS PRINT DOES NOT DISCHARGE THIS REQUIREMENT OR ANY OTHER REQUIREMENT. THE COMPANY AND ITS AFFILIATES ASSUME NO LEGAL RESPONSIBILITY OR LIABILITY FOR THE RECIPIENT'S USE (OR ANY OTHER PARTIES' USE) OF THE PRINT, INCLUDING THE RECIPIENT'S INTENDED PURPOSE IN USING THE PRINT. NO COMPANY EMPLOYEE OR OTHER PARTY HAS BEEN AUTHORIZED TO PROVIDE THIS PRINT FOR PLANNING OR ESTIMATING PURPOSES; RELY ON THIS PRINT AT YOUR OWN RISK. BY ACCEPTING THIS PRINT, THE RECIPIENT & ANY OTHER PARTY RECEIVING A COPY OF THE PRINT ACKNOWLEDGES AND AGREES TO THIS DISCLAIMER. For All Field Locates Call 811

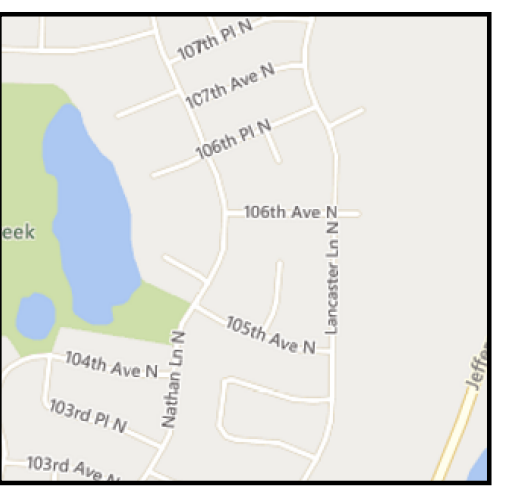
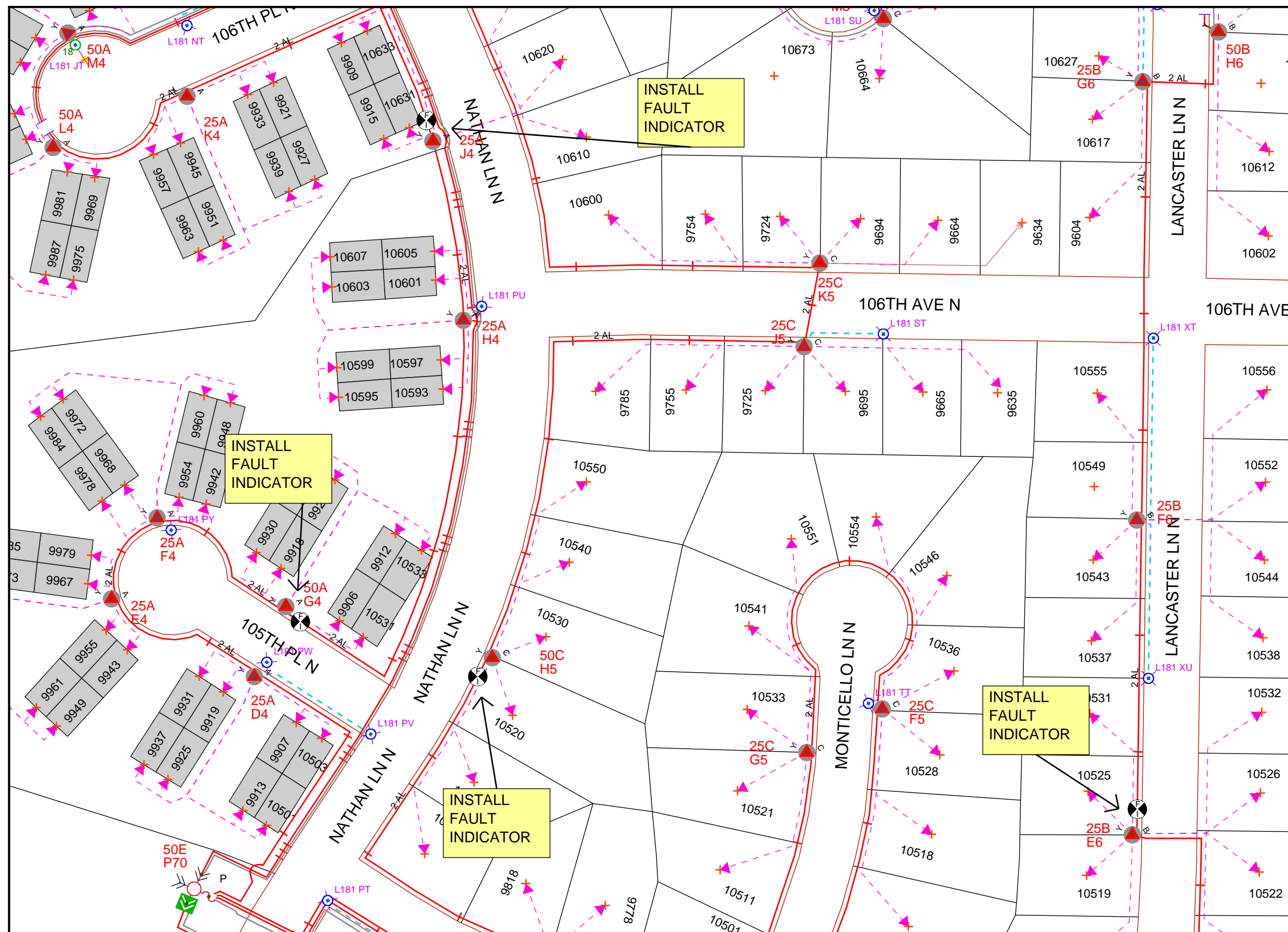

Work Order Information	
Service Request #	:
Design Number	: 000001073087
Designer/Planner ID	: wbbj96
Designer/Planner Name	: Wubben, Joshua
Designer/Planner Ph #	: (000) 000-0000
Manager Approval	:

Joint Utility	
E:	G:
T:	C:

Design Location	
Division	: Maple Grove
County	: Hennepin
City	: Maple Grove
Address	:
T: 119N	R: 22W S: 1
Map #	: L51081
Permit	:

Electric	
Feeder:	Voltage:
Phase:	Bkup Dev ID:

Gas	
System	: Pressure
Size	: Material
Dead End	:

Work Order # :
 Date: 05/19/2022
 Sketch: # Of # Sketch Data
 Scale: 1" equals 101'

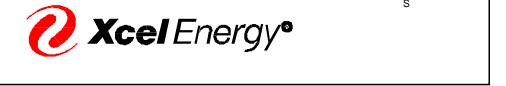

- CONSTRUCTION USE ONLY**
- NO CHANGES (BUILT AS DESIGNED)
 - CHANGES MADE AS INDICATED (ALL URD MUST HAVE ACTUAL MEASUREMENTS FROM THE FIELD SITE)

RFO _____
 FOREMAN _____ DATE _____
 TEAM LEADER _____

DISCLAIMER: THERE ARE NO REPRESENTATIONS OR WARRANTIES (EXPRESS OR IMPLIED) ABOUT THE ACCURACY OF THIS PRINT. THIS PRINT IS PROVIDED WITH NO CLAIM AS TO PRINT COMPLETENESS, TIMELINESS, ACCURACY OF CONTENT OR USEFULNESS. STATE LAW REQUIRES ANYONE DIGGING, GRADING OR EXCAVATING TO OBTAIN A PRIOR FIELD LOCATE OF ALL UTILITIES. THIS PRINT DOES NOT DISCHARGE THIS REQUIREMENT OR ANY OTHER REQUIREMENT. THE COMPANY AND ITS AFFILIATES ASSUME NO LEGAL RESPONSIBILITY OR LIABILITY FOR THE RECIPIENT'S USE (OR ANY OTHER PARTIES' USE) OF THE PRINT, INCLUDING THE RECIPIENT'S INTENDED PURPOSE IN USING THE PRINT. NO COMPANY EMPLOYEE OR OTHER PARTY HAS BEEN AUTHORIZED TO PROVIDE THIS PRINT FOR PLANNING OR ESTIMATING PURPOSES; RELY ON THIS PRINT AT YOUR OWN RISK. BY ACCEPTING THIS PRINT, THE RECIPIENT & ANY OTHER PARTY RECEIVING A COPY OF THE PRINT ACKNOWLEDGES AND AGREES TO THIS DISCLAIMER. For All Field Locates Call 811

THIS DOCUMENT IS XCEL ENERGY CONFIDENTIALS AND PROPRIETARY INFORMATION AND MAY NOT BE REPRODUCED IN WHOLE, OR IN PART, NOR MAY ANY OF THE INFORMATION CONTAINED HEREIN BE DISCLOSED WITHOUT THE CONSENT OF XCEL ENERGY. CONFIDENTIALS AND PROPRIETARY INFORMATION © 2019 XCEL ENERGY INC. | XCEL ENERGY IS REGISTERED TRADEMARK OF XCEL ENERGY INC

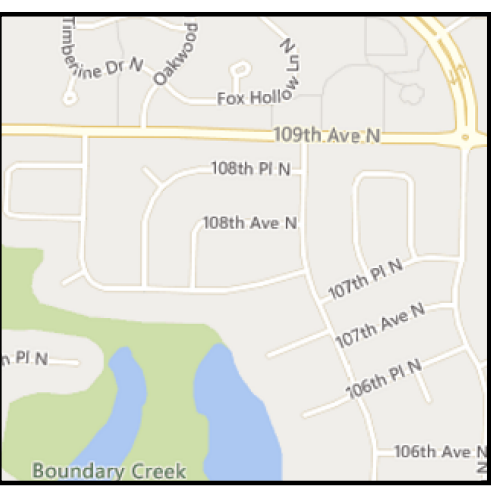
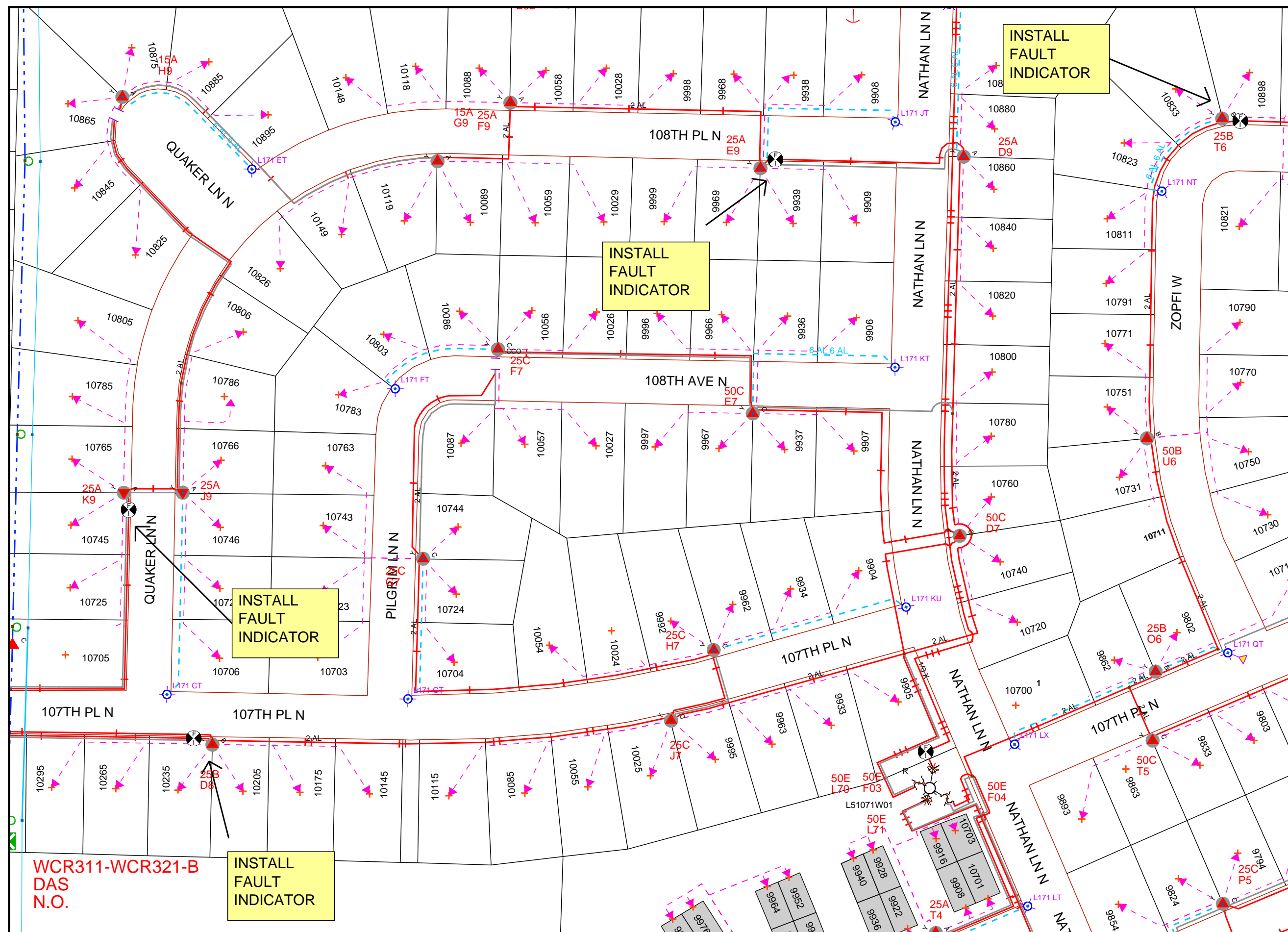

Work Order Information	
Service Request #	:
Design Number	: 000001073087
Designer/Planner ID	: wbbj96
Designer/Planner Name	: Wubben, Joshua
Designer/Planner Ph #	: (000) 000-0000
Manager Approval	:

Joint Utility	
E:	G:
T:	C:

Design Location	
Division	: Maple Grove
County	: Hennepin
City	: Maple Grove
Address	:
T: 119N	R: 22W S: 1
Map #	: L51071
Permit	:

Electric	
Feeder:	Voltage:
Phase:	Bkup Dev ID:

Gas	
System	: Pressure
Size	: Material
Dead End	:

Work Order # :
 Date: 05/19/2022
 Sketch: # Of # Sketch Data
 Scale: 1" equals 125'



**WCR311-WCR321-B
 DAS
 N.O.**

**INSTALL
 FAULT
 INDICATOR**

CONSTRUCTION USE ONLY

NO CHANGES (BUILT AS DESIGNED)
 CHANGES MADE AS INDICATED
 (ALL URD MUST HAVE ACTUAL MEASUREMENTS FROM THE FIELD SITE)

RFO _____
 FOREMAN _____ DATE _____
 TEAM LEADER _____

DISCLAIMER: THERE ARE NO REPRESENTATIONS OR WARRANTIES (EXPRESS OR IMPLIED) ABOUT THE ACCURACY OF THIS PRINT. THIS PRINT IS PROVIDED WITH NO CLAIM AS TO PRINT COMPLETENESS, TIMELINESS, ACCURACY OF CONTENT OR USEFULNESS. STATE LAW REQUIRES ANYONE DIGGING, GRADING OR EXCAVATING TO OBTAIN A PRIOR FIELD LOCATE OF ALL UTILITIES. THIS PRINT DOES NOT DISCHARGE THIS REQUIREMENT OR ANY OTHER REQUIREMENT. THE COMPANY AND ITS AFFILIATES ASSUME NO LEGAL RESPONSIBILITY OR LIABILITY FOR THE RECIPIENT'S USE (OR ANY OTHER PARTIES' USE) OF THE PRINT, INCLUDING THE RECIPIENT'S INTENDED PURPOSE IN USING THE PRINT. NO COMPANY EMPLOYEE OR OTHER PARTY HAS BEEN AUTHORIZED TO PROVIDE THIS PRINT FOR PLANNING OR ESTIMATING PURPOSES; RELY ON THIS PRINT AT YOUR OWN RISK. BY ACCEPTING THIS PRINT, THE RECIPIENT & ANY OTHER PARTY RECEIVING A COPY OF THE PRINT ACKNOWLEDGES AND AGREES TO THIS DISCLAIMER. For All Field Locates Call 811

THIS DOCUMENT IS XCEL ENERGY CONFIDENTIALS AND PROPRIETARY INFORMATION AND MAY NOT BE REPRODUCED IN WHOLE, OR IN PART, NOR MAY ANY OF THE INFORMATION CONTAINED HEREIN BE DISCLOSED WITHOUT THE CONSENT OF XCEL ENERGY. CONFIDENTIALS AND PROPRIETARY INFORMATION © 2019 XCEL ENERGY INC. | XCEL ENERGY IS REGISTERED TRADEMARK OF XCEL ENERGY INC