

Revised 05-27-2021	State MN	Contractor MN Metro	CMS#	22085757
CenturyLink BSW Order/Maintenance Work Authorization				
Company	Exchange Name OSSEMNXO	Service Order#		
Work Activity Fiber-Buried	Capital	Y	Maintenance	N
Customer Name	Address 6387 YUMA LN		Phone#	
City & Zip	MAPLE GROVE, MN			
Location/Directions	GPS			
Description of Work or Special Instructions	SEE SKETCH			

Held Order	N	Permit:	Y	Bore:	Y	CBR#	
Tech Name and Tech #	AA10109		Employee Contact#	763-228-8645			
Sketch (Include Cntr Line & Pedestal)	Material/Labor Units		Footage/Quantity	Comments			
	Description	Notes					
Cntr Line foot	SEB3-22	BSW-3 & plow plcmt					
	SEB3-22T	BSW-3 & hand dig plcmt					
Ped#	SEE SKETCH	SEPCUTOVER	1				
Parish/County	BM83	BSW guard at house	1				
	XXSEB-GL	Remove temp drop	200	Footage when temp can't be re-used			
Township:	BM61(1.25)SEB	BSW Bore footage	110				
Section	SEBO PER FT LBR	Fiber & plow plcmt	170				
Range	SEBO PER FT LBR T	Fiber & hand dig plcmt					
	SEB6-22	BSW-6 & plow plcmt					
	BM2(5/8)(8)	Ground Rod					
	SEBO-COIL	Fiber Coil	1	Coil excess on Fiber drop add 1 unit			
	Permit	Permit	1	Any placement within the ROW requires a permit			
Nearest cross st.	SEE SKETCH		Plat Page		Map#		

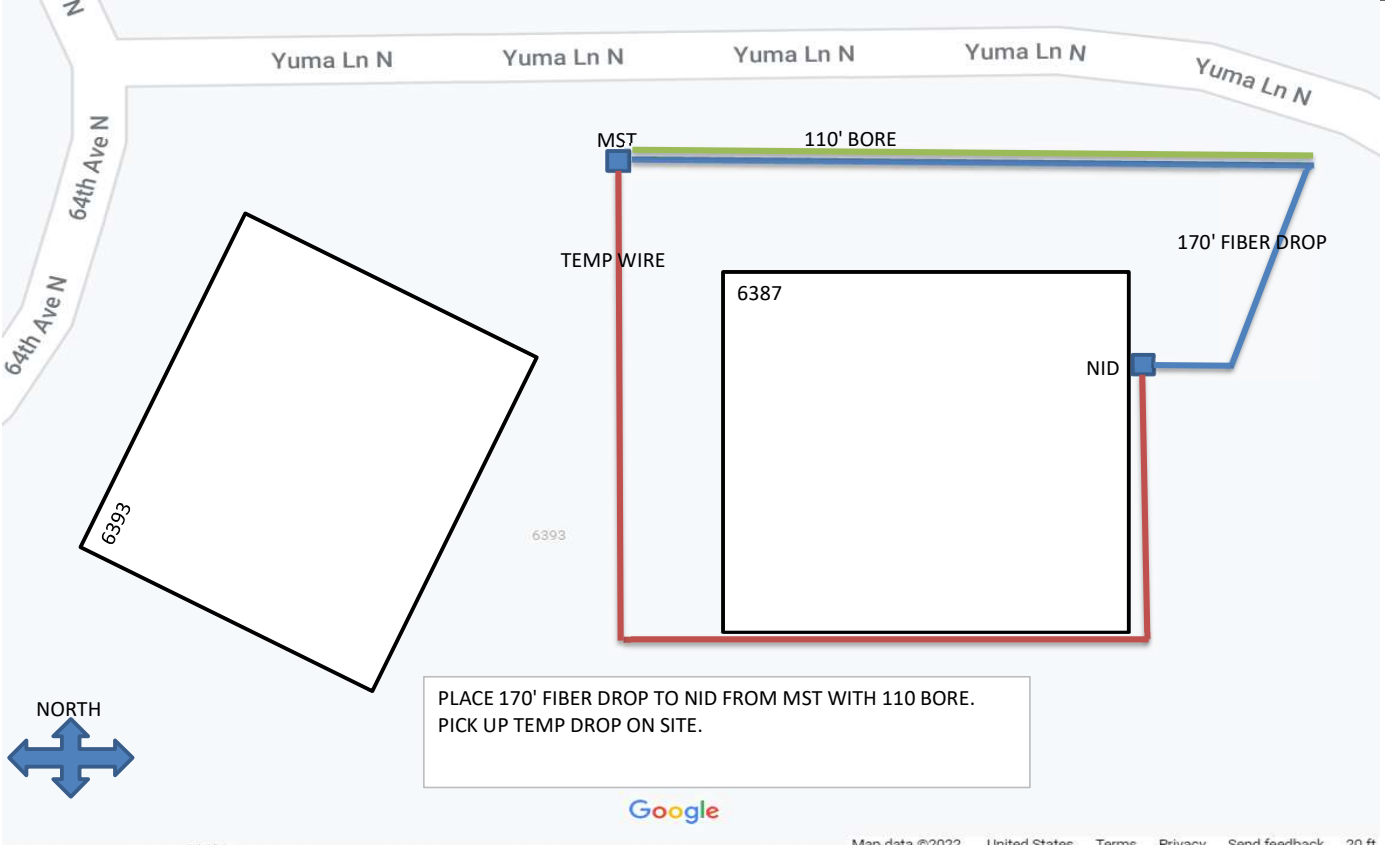

Originated By:	AA10109	Date:	8/3/22	Completed By:		Date:	
Authorized By: (SRO)		Date:		Inspected By:		Date:	
Authorized By: (MRO)		Date:					
Email sketch to:							
1. Distance of the bury in Right-of-Way		3. Distance to the nearest intersection					
2. Distance from the terminal to the centerline		4. Nearest State Hwy mile marker					