

**CenturyLink BSW Order/Maintenance Work Authorization**

Company	Exchange Name OSSEMNXO	Service Order# 1101505311
Work Activity	Fiber-Buried	Capital <input checked="" type="checkbox"/> Maintenance <input type="checkbox"/>
Customer Name	tyler johnston	Phone# (763) 420-2178
Address	7652 garland ln n	One Call Ticket#
City & Zip	maple grove	
Location/Directions	GPS	
Description of Work or Special Instructions	SEE SKETCH	

Held Order	<input checked="" type="checkbox"/>	Permit:	<input checked="" type="checkbox"/>	Bore:	<input checked="" type="checkbox"/>	CBR#	9525944583
Tech Name and Tech #	AA10109			Employee Contact#	763-228-8645		

Sketch (Include Cntr Line & Pedestal)	Material/Labor Units		Footage/Quantity	Comments
	Description	Notes		
Cntr Line foot	SEB3-22	BSW-3 & plow plcmt		
	SEB3-22T	BSW-3 & hand dig plcmt		
Ped#	SEE SKETCH	SEPCUTOVER	1	
Parish/County	BM83	BSW guard at house	1	
	XXSEB-GL	Remove temp drop		Footage when temp can't be re-used
Township:	BM61(1.25)SEB	BSW Bore footage	208	
Section	SEBO PER FT LBR	Fiber & plow plcmt	240	
Range	SEBO PER FT LBR T	Fiber & hand dig plcmt		
	SEB6-22	BSW-6 & plow plcmt		
	BM2(5/8)(8)	Ground Rod		
	SEBO-COIL	Fiber Coil	1	Coil excess on Fiber drop add 1 unit
	Permit	Permit	1	Any placement within the ROW requires a permit
Nearest cross st.	SEE SKETCH		Plat Page	Map#

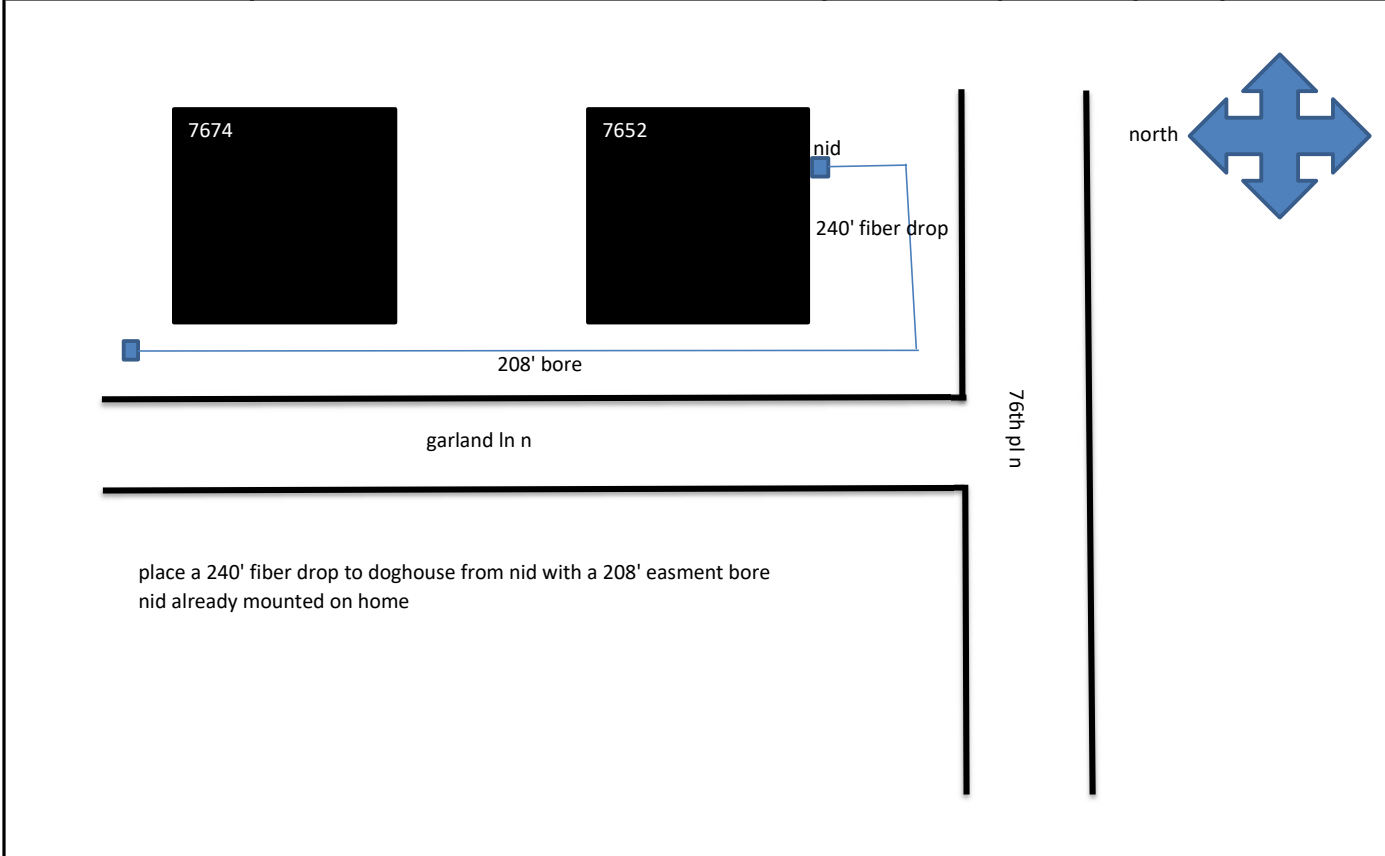

Originated By:	AA10109	Date:	6/20/22	Completed By:	_____	Date:	_____
Authorized By: (SRO)	_____	Date:	_____	Inspected By:	_____	Date:	_____
Authorized By: (MRO)	_____	Date:	_____		_____		_____

1. Distance of the bury in Right-of-Way	3. Distance to the nearest intersection
2. Distance from the terminal to the centerline	4. Nearest State Hwy mile marker