

CenturyLink BSW Order/Maintenance Work Authorization

Company	Exchange Name	OSSEMNXO	Service Order#
Work Activity	Fiber-Buried	Capital	Y
Customer Name	barb Ollila	Phone#	(150) 001-5094
Address	10543 108th Ave N	One Call Ticket#	
City & Zip	Osseec, MN		
Location/Directions	GPS		
Description of Work or Special Instructions	Plow 120 ft of fiber from ped to nid. 60 ft right of way bore required		

Held Order	Y	Permit:	Y	Bore:	Y	CBR#	7634860644
Tech Name and Tech #	Don Evans		Employee Contact#	6124303133			

Sketch (Include Cntr Line & Pedestal)	Material/Labor Units		Footage/Quantity	Comments
	Description	Notes		
Cntr Line foot	SEB3-22	BSW-3 & plow plcmt		
	SEB3-22T	BSW-3 & hand dig plcmt		
Ped#	125246	SEPCUTOVER		
Parish/County	BM83	BSW guard at house	1	
	XXSEB-GL	Remove temp drop		Footage when temp can't be re-used
Township:	BM61(1.25)SEB	BSW Bore footage	60	
Section	SEBO PER FT LBR	Fiber & plow plcmt	60	
Range	SEBO PER FT LBR T	Fiber & hand dig plcmt		
	SEB6-22	BSW-6 & plow plcmt		
	BM2(5/8)(8)	Ground Rod		
	SEBO-COIL	Fiber Coil	1	Coil excess on Fiber drop add 1 unit
	Permit	Permit	1	Any placement within the ROW requires a permit
Nearest cross st.	Trenton Ln N		Plat Page	Map#

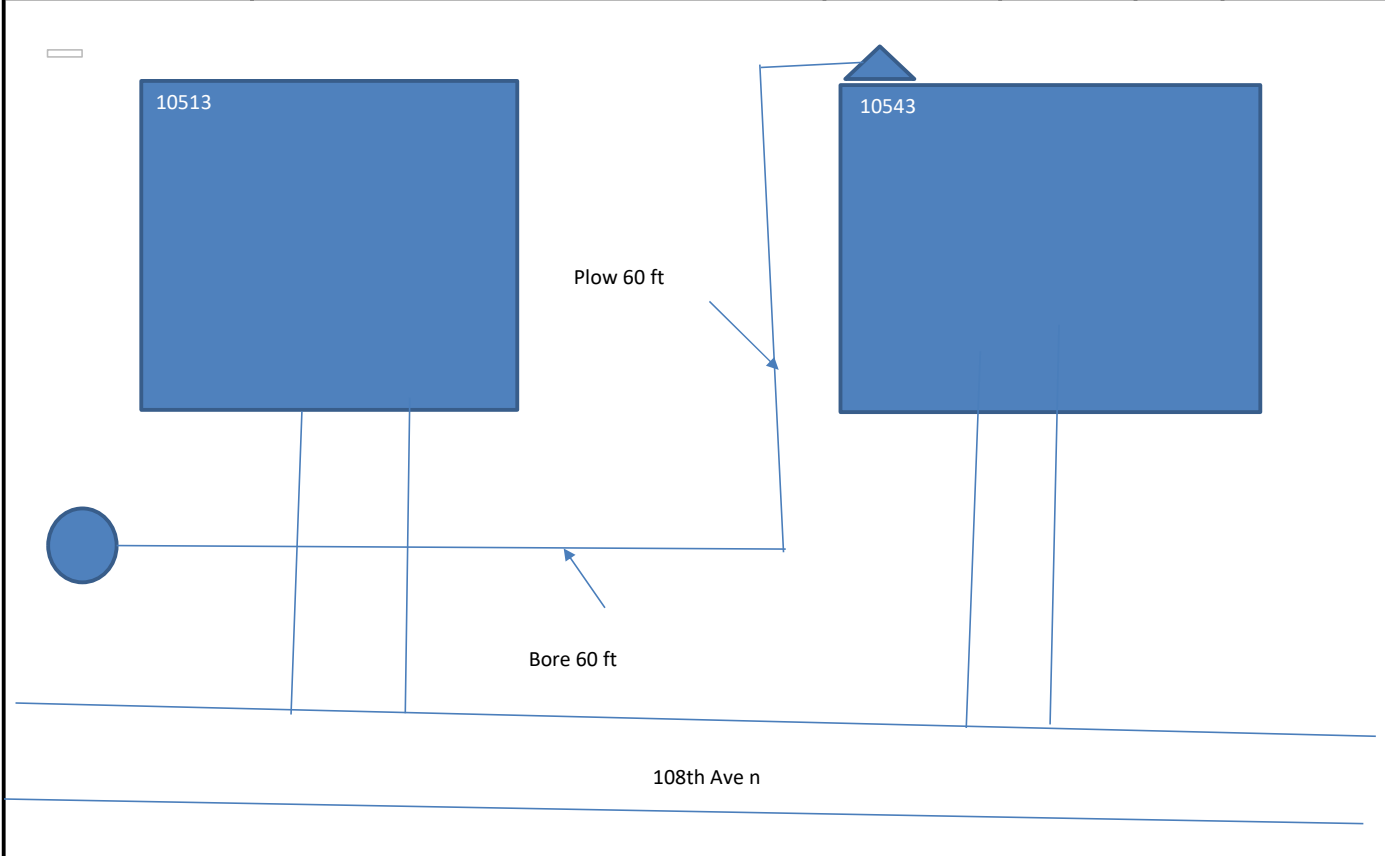

Originated By:	Don Evans	Date:	6/20/22	Completed By:		Date:	
Authorized By: (SRO)		Date:		Inspected By:		Date:	
Authorized By: (MRO)		Date:					

1. Distance of the bury in Right-of-Way		3. Distance to the nearest intersection	
2. Distance from the terminal to the centerline		4. Nearest State Hwy mile marker	