

CITY OF MAPLE GROVE, MN - HENNEPIN COUNTY
CSAH 101 RECONSTRUCTION
LOCATED ON CSAH 101 (TROY LN N) FROM 73RD AVE N TO 83RD AVE N

LUMEN WORK PLAN
PROJECT N.973254 / TERR-1007203

PLANS PREPARED FOR



LUMEN ENGINEER: **BILL BYERS**
 EMAIL: BILL.BYERS@LUMEN.COM
 PHONE: 651.829.5383
 LUMEN CONSTRUCTION CONTACT: **MARCIE DEMAIO**
 EMAIL: MARCIE.DEMAIO@LUMEN.COM
 PHONE: 651.302.9778
 WIRECENTER: MPGVMNXA

PLANS PREPARED BY



TT ENGINEER: **RJ ALLISON**
 PHONE: 612.388.7375
 EMAIL: RALLISON@TERRATECHLLC.NET

PROJECT CONTACT

OWNER: **KELLY MATZKE - CITY OF MAPLE GROVE**
 PHONE: 763.494.6365
 EMAIL: KMATZKE@MAPLEGROVEMN.GOV
 PROJECT ENGINEER: **MARCUS VANDERBRUG - WSB**
 PHONE: 612.741.6178
 EMAIL: MVANDERBRUG@WSBENG.COM
 SURVEY/STAKING: **MARCUS VANDERBRUG - WSB**
 PHONE: 612.741.6178
 EMAIL: MVANDERBRUG@WSBENG.COM
 ROAD CONTRACTOR: **(TBD) MARCUS VANDERBRUG - WSB**
 PHONE: 612.741.6178
 EMAIL: MVANDERBRUG@WSBENG.COM

WRIGHT-HENNEPIN
 BOB FENNER
 PHONE: 612.751.6989
 EMAIL: BFENNER@WHE.ORG



GOPHER STATE ONE CALL
 1-800-252-1100 OR
 1-651-454-0002
WWW.GOPHERSTATEONCALL.ORG

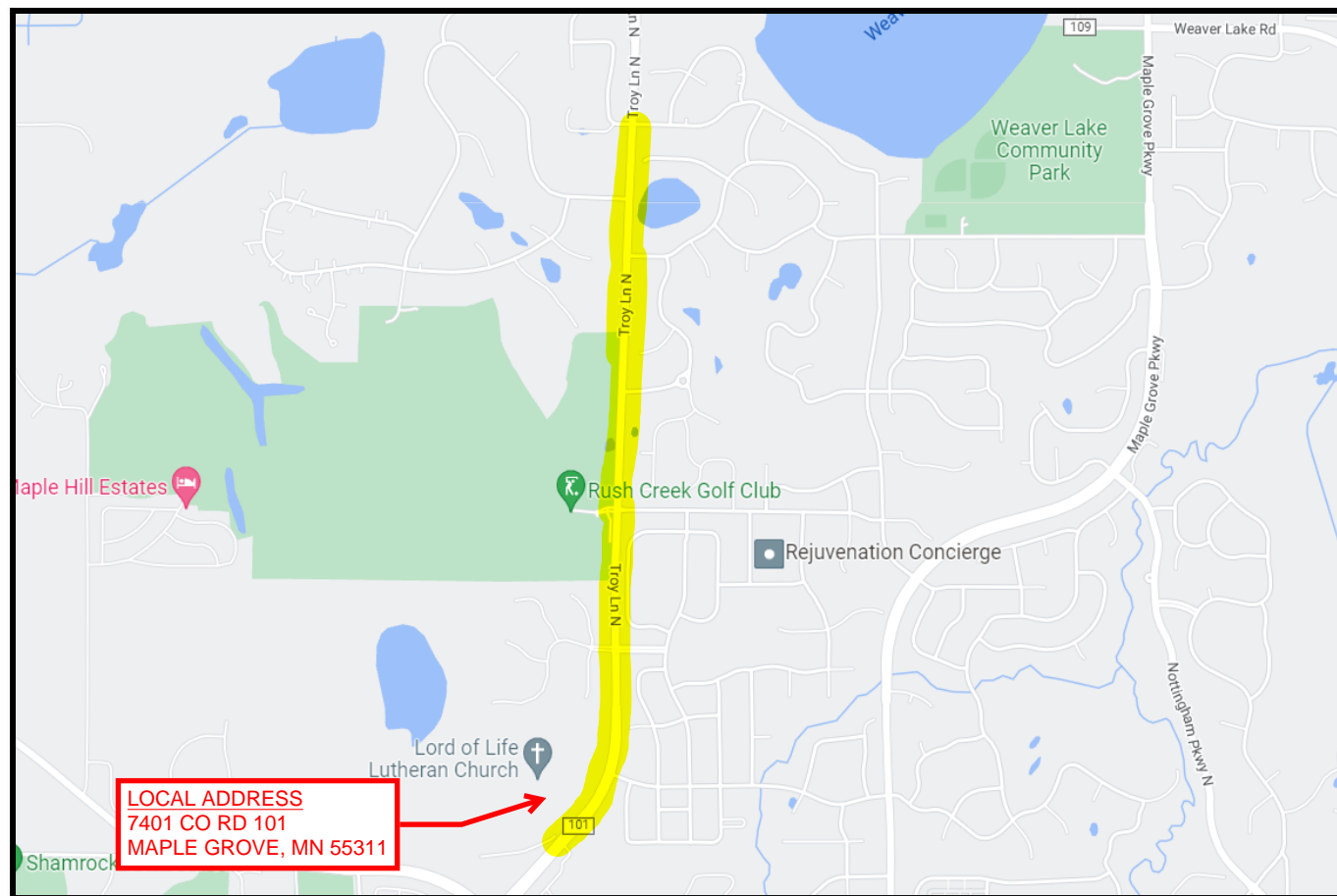

LOCATION MAP
 NOT TO SCALE

FOR REFERENCE ONLY

PERMITS REQUIRED: YES NO

CITY: MAPLE GROVE

COUNTY: HENNEPIN

STATE:

RAILROAD:

PIPELINE:

DNR:

MISCELLANEOUS:

CUTS REQUIRED: YES NO

FIBER OPTIC

COPPER

MIGRATIONS REQUIRED: YES NO

PRECONSTRUCTION MEETING DATE: TBD

EXPECTED ROADWAY CONSTRUCTION START DATE: 4/1/23

NOTES:

ALL EXISTING AND PROPOSED CONDITIONS ARE BASED ON INFORMATION PROVIDED BY OTHERS. LUMEN CANNOT BE RESPONSIBLE FOR THE ACCURACY OF INFORMATION AND/OR PLANS PROVIDED BY OUTSIDE PARTIES. FACILITY LOCATIONS, DEPTHS AND ELEVATIONS SHOULD BE FIELD VERIFIED PRIOR TO CONSTRUCTION.

PROPOSED DESIGN MODIFICATIONS ARE RECOMMENDATIONS ONLY AND SHOULD BE VERIFIED PRIOR TO CONSTRUCTION.

REVISION	DATE

HENNEPIN COUNTY CITY OF MAPLE GROVE

CONSTRUCTION PLAN FOR GRADING, BITUMINOUS SURFACING, FULL DEPTH RECLAMATION AND ADA IMPROVEMENTS
LOCATED ON CSAH 101 (TROY LANE) FROM 73RD AVENUE TO 500' NORTH OF 83RD AVENUE N

CSAH 101 (TROY LANE)

SAP 027-701-038
SAP 189-020-027

GROSS LENGTH 7,479.74 ft 1.417 miles
BRIDGES-LENGTH _____ ft _____ miles
EXCEPTIONS-LENGTH _____ ft _____ miles
NET LENGTH 7,479.74 ft 1.417 miles

NOTE: LENGTH AND DESCRIPTION BASED ON NB ALIGNMENT.

DESIGN DESIGNATION

CSAH 101 (TROY LANE)
SAP 027-701-038
SAP 189-020-027

R VALUE = 30
ADT (Current Year) 2022 = 11,550
ADT (Future Year) 2042 = 15,000
D (DIRECTIONAL DISTR.) = 50/50
HCADT (Future Year) 2042 = 1,065
ESALS 2,818,000
DESIGN SPEED 45 MPH
BASED ON STOPPING SIGHT DISTANCE
HEIGHT OF EYE 3.5 HEIGHT OF OBJECT 2.0
DESIGN SPEED NOT ACHIEVED AT: N/A
FUNCTIONAL CLASSIFICATION: MINOR ARTERIAL
NO. OF TRAFFIC LANES 2
NO. OF PARKING LANES 0
SHOULDER WIDTH 2'-10"
TON DESIGN 10

DESIGN DESIGNATION

TRAIL

DESIGN SPEED 20 MPH
BASED ON STOPPING SIGHT DISTANCE
HEIGHT OF EYE 4.5 HEIGHT OF OBJECT 0.0
DESIGN SPEED NOT ACHIEVED AT: N/A

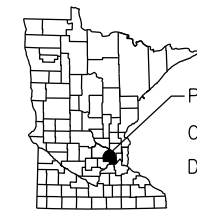
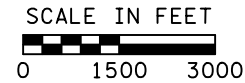
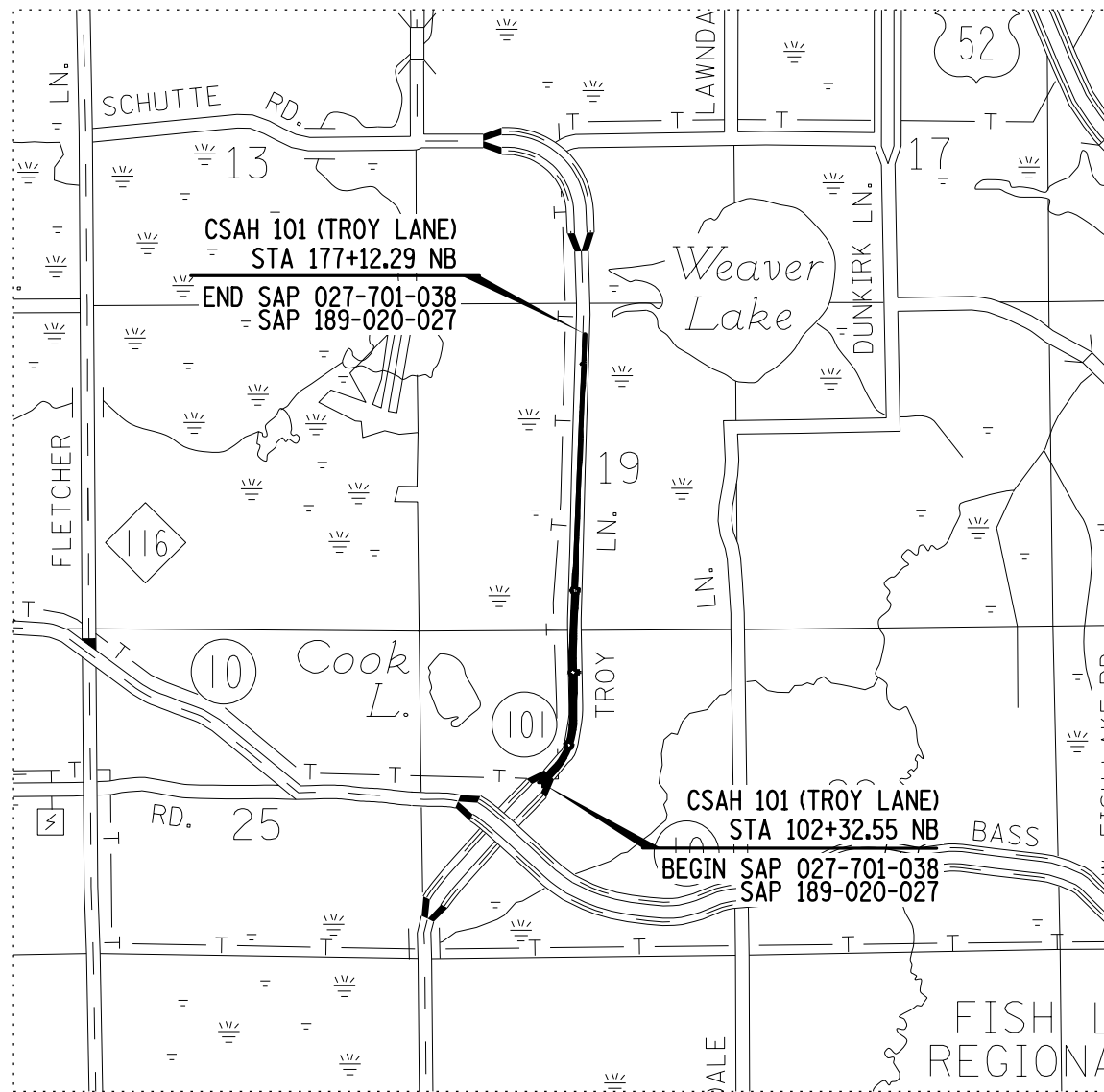

PROJECT LOCATION
COUNTY: HENNEPIN
DISTRICT: METRO

HENNEPIN COUNTY PROJECT

Legend

- Existing Copper Cable
- Existing Fiber Cable
- Existing Overhead Wire
- Existing Pedestal
- Existing Manhole
- Existing Handhole
- Existing Pole
- Cross Box

EXISTING	REMOVE/ABANDON	PROPOSED

GOVERNING SPECIFICATIONS
THE 2020 EDITION OF THE MINNESOTA DEPARTMENT OF TRANSPORTATION "STANDARD SPECIFICATIONS FOR CONSTRUCTION" SHALL GOVERN.
ALL TRAFFIC CONTROL DEVICES SHALL CONFORM TO THE LATEST EDITION OF THE MINNESOTA MANUAL OF UNIFORM TRAFFIC CONTROL DEVICES, INCLUDING THE LATEST EDITION OF THE FIELD MANUAL FOR TEMPORARY TRAFFIC CONTROL ZONE LAYOUTS.

INDEX

SHEET NO.	DESCRIPTION
1	TITLE SHEET
2	GENERAL LAYOUT
3 - 5	ESTIMATED QUANTITIES
6 - 7	QUANTITY TABULATIONS
8	SOILS AND CONSTRUCTION NOTES
9	EARTHWORK TABULATION
10 - 13	TYPICAL SECTIONS
14 - 16	MISCELLANEOUS DETAILS
17 - 33	STANDARD PLAN SHEETS
34 - 44	TRAFFIC CONTROL & STAGING PLAN
45 - 46	ALIGNMENT PLAN
47 - 50	EXISTING TOPOGRAPHY & UTILITIES PLAN
51 - 54	REMOVAL PLAN
55 - 57	SIGN REMOVAL PLAN
58 - 61	CONSTRUCTION PLAN
62 - 65	PROFILES
66 - 69	PAVING PLAN
70 - 73	QUADRANT DETAILS
74 - 78	PED RAMP DETAILS
79 - 82	DRAINAGE PLAN
83 - 91	DRAINAGE PROFILES AND TABULATIONS
92 - 107	SIGNING & STRIPING PLAN
108 - 110	SWPPP
111 - 115	EROSION CONTROL & TURF ESTABLISHMENT
X1 - X27	CROSS SECTIONS

THIS PLAN CONTAINS 142 SHEETS

ALL APPLICABLE FEDERAL, STATE, AND LOCAL LAWS AND ORDINANCES WILL BE COMPLIED WITHIN THE CONSTRUCTION OF THIS PROJECT.



SIGNATURE: _____ TYPED OR PRINTED NAME: MARCUS VANDERBRUG, PE
DESIGN ENGINEER: I HEREBY CERTIFY THAT THIS PLAN WAS PREPARED BY ME OR UNDER MY DIRECT SUPERVISION, AND THAT I AM A DULY LICENSED PROFESSIONAL ENGINEER UNDER THE LAWS OF THE STATE OF MINNESOTA.
DATE: 6/10/2022 LICENSE NUMBER 56164

APPROVED: CITY OF MAPLE GROVE ENGINEER _____ DATE: _____

DATE: _____

PLAN REVISIONS		
DATE	SHEET NO.	APPROVER

NOTE: THE SUBSURFACE UTILITY INFORMATION IN THIS PLAN IS QUALITY LEVEL D. THIS QUALITY LEVEL WAS DETERMINED ACCORDING TO THE GUIDELINES OF C/ASCE 38-02 ENTITLED STANDARD GUIDELINES FOR THE COLLECTION AND DEPICTION OF EXISTING SUBSURFACE UTILITY DATA.

SAP 027-701-038 / SAP 189-020-027
CP 2174900 / CITY PROJ. 22-10

SHEET NO. 1 OF 115 SHEETS

Date Printed: 6/10/2022
WSB Filename: Projects\Minnesota\017086-000\Cad\Plan\017086-000.tsh.dgn

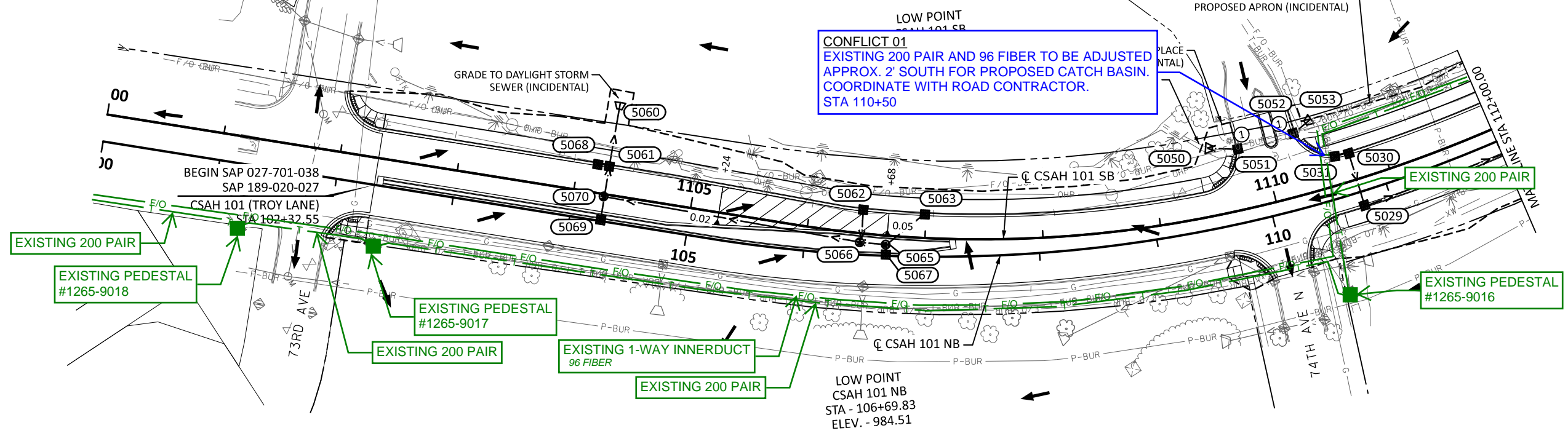
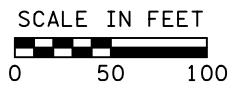

LEGEND

- ① CONNECT TO INPLACE CULVERT
- ② CONNECT TO EXISTING STORM SEWER
- CONSTRUCTION LIMITS
- - - EXISTING R/W
- PROPOSED R/W
- - - DRAINAGE & UTIL ESMT.
- - - TEMPORARY EASEMENT
- AREA OF ENVIRONMENTAL SENSITIVITY
- - - STORM SEWER
- - - CULVERT
- ▣ CATCH BASIN/DROP INLET
- ⊙ MANHOLE
- ⊙ APRON
- ⊙ STRUCTURE NUMBER
- ⊙ RANDOM RIPRAP
- SURFACE FLOW ARROW

NOTES:

- ALL DIMENSIONS ARE TO FACE OF CURB OR EDGE OF BITUMINOUS UNLESS OTHERWISE NOTED.
- REFER TO SHEETS 83 TO 91 FOR DRAINAGE TABULATIONS AND PROFILES.

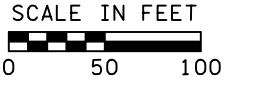
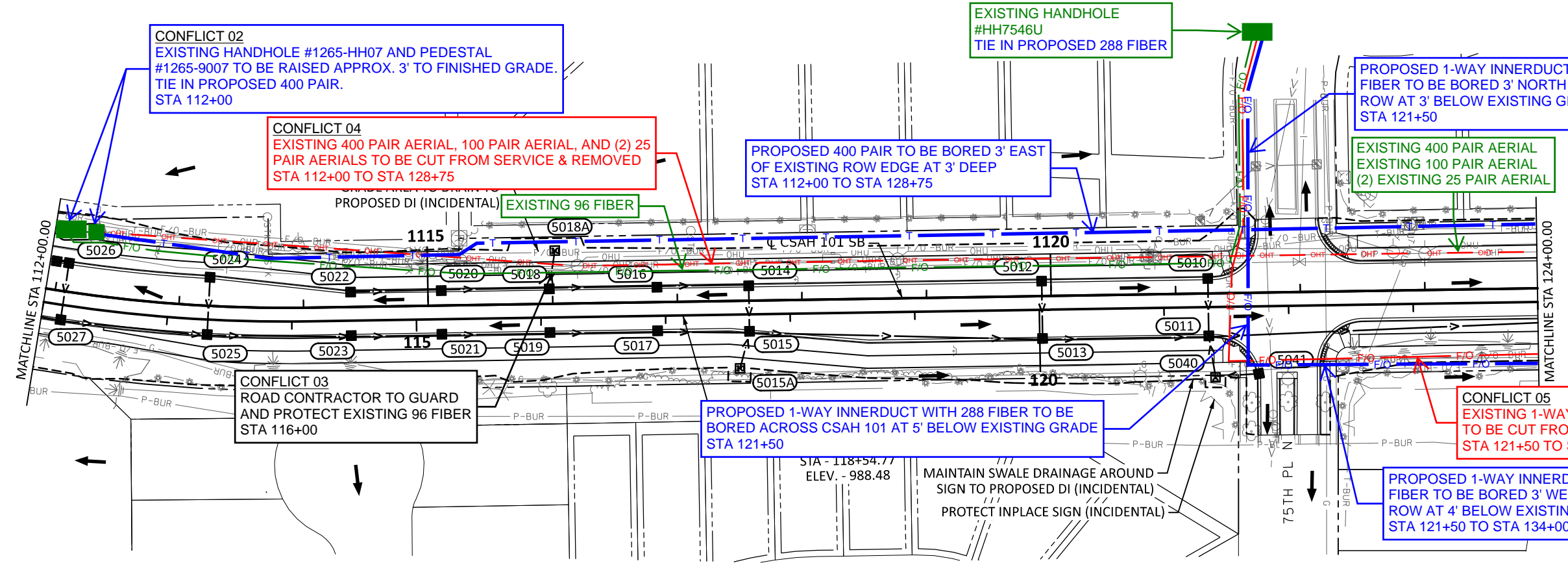

DATE: 6/10/2022 2:55:34 PM
PATH & FILENAME: Projects\Minnesota\017086-000\Cad\Plan\017086-000_dp.dgn

NO.	DATE	BY	CHK	REVISIONS

Design By: MKV
 Plan By: GAD
 Checked By: AJP
 Approved By: MKV

I HEREBY CERTIFY THAT THIS PLAN WAS PREPARED BY ME OR UNDER MY DIRECT SUPERVISION AND THAT I AM A DULY LICENSED PROFESSIONAL ENGINEER UNDER THE LAWS OF THE STATE OF MINNESOTA.

MARCUS VANDERBRUG, PE
 DATE: 6/10/2022 LICENSE NO. 56164



CSAH 101 Improvements

MAPLE GROVE, MINNESOTA

DRAINAGE PLAN

SAP 027-701-038 / SAP 189-020-027 / CP 2174900 / CITY PROJ 22-10

SHEET 79 OF 115 SHEETS

CONFLICT 04 (CONTD.)
 EXISTING 400 PAIR AERIAL, 100 PAIR AERIAL, AND (2) 25 PAIR AERIALS TO BE CUT FROM SERVICE & REMOVED STA 112+00 TO STA 128+75

CONFLICT 07
 EXISTING POLE #A3953173 AND POLE #A3953175 TO BE REMOVED STA 127+50 AND STA 128+75

PROPOSED SPLICE PEDESTAL TO BE PLACED 3' FROM EXISTING ROW EDGE AT EXISTING GRADE. TIE IN PROPOSED 400 PAIR AND EXISTING 900 PAIR. STA 128+75

CONFLICT 09
 EXISTING 900 PAIR TO BE ADJUSTED 2' TOWARDS CSAH 101. COORDINATE WITH ROAD CONTRACTOR. STA 131+15

PROPOSED 400 PAIR TO BE BORED 3' EAST OF EXISTING ROW EDGE AT 3' DEEP STA 112+00 TO STA 128+75

CONFLICT 05 (CONTD.)
 EXISTING 1-WAY INNERDUCT WITH 288 FIBER TO BE CUT FROM SERVICE & LEFT IN PLACE STA 121+50 TO STA 145+50

PROPOSED 1-WAY INNERDUCT WITH 288 FIBER TO BE BORED 3' WEST OF EXISTING ROW AT 4' BELOW EXISTING GRADE STA 121+50 TO STA 134+00

CONFLICT 10
 ROAD CONTRACTOR TO GUARD AND PROTECT PROPOSED 1-WAY INNERDUCT WITH 288 FIBER STA 132+40

PROPOSED 1-WAY INNERDUCT WITH 288 FIBER TO BE BORED 3' WEST OF EXISTING ROW AT 5' BELOW EXISTING GRADE STA 134+00 TO STA 141+50

CONFLICT 11
 EXISTING 1800 PAIR AND 50 PAIR TO BE ADJUSTED APPROX. 1' TOWARDS EXISTING ROW CORNER. COORDINATE WITH ROAD CONTRACTOR. STA 135+75

CONFLICT 06
 ROAD CONTRACTOR TO GUARD AND PROTECT PROPOSED 1-WAY INNERDUCT WITH 288 FIBER STA 125+10

CONFLICT 15
 PROPOSED 400 PAIR TO BE RAISED APPROX. 1' IN PLACE DURING STORM SEWER CONSTRUCTION IN 2023. COORDINATE WITH ROAD CONTRACTOR. STA 126+50

CONFLICT 08
 ROAD CONTRACTOR TO GUARD AND PROTECT PROPOSED 1-WAY INNERDUCT WITH 288 FIBER STA 130+00

CONFLICT 12
 ROAD CONTRACTOR TO GUARD AND PROTECT EXISTING 50 PAIR STA 137+70

CONFLICT 14
 ROAD CONTRACTOR TO GUARD AND PROTECT EXISTING 900 PAIR STA 138+15

- CONSTRUCTION LIMITS
- EXISTING R/W
- PROPOSED R/W
- DRAINAGE & UTIL ESMT.
- TEMPORARY EASEMENT
- AREA OF ENVIRONMENTAL SENSITIVITY
- STORM SEWER
- CULVERT
- CATCH BASIN/DROP INLET
- MANHOLE
- APRON
- STRUCTURE NUMBER
- RANDOM RIPRAP
- SURFACE FLOW ARROW

NOTES:
 1. ALL DIMENSIONS ARE TO FACE OF CURB OR EDGE OF BITUMINOUS UNLESS OTHERWISE NOTED.
 2. REFER TO SHEETS 83 TO 91 FOR DRAINAGE TABULATIONS AND PROFILES.

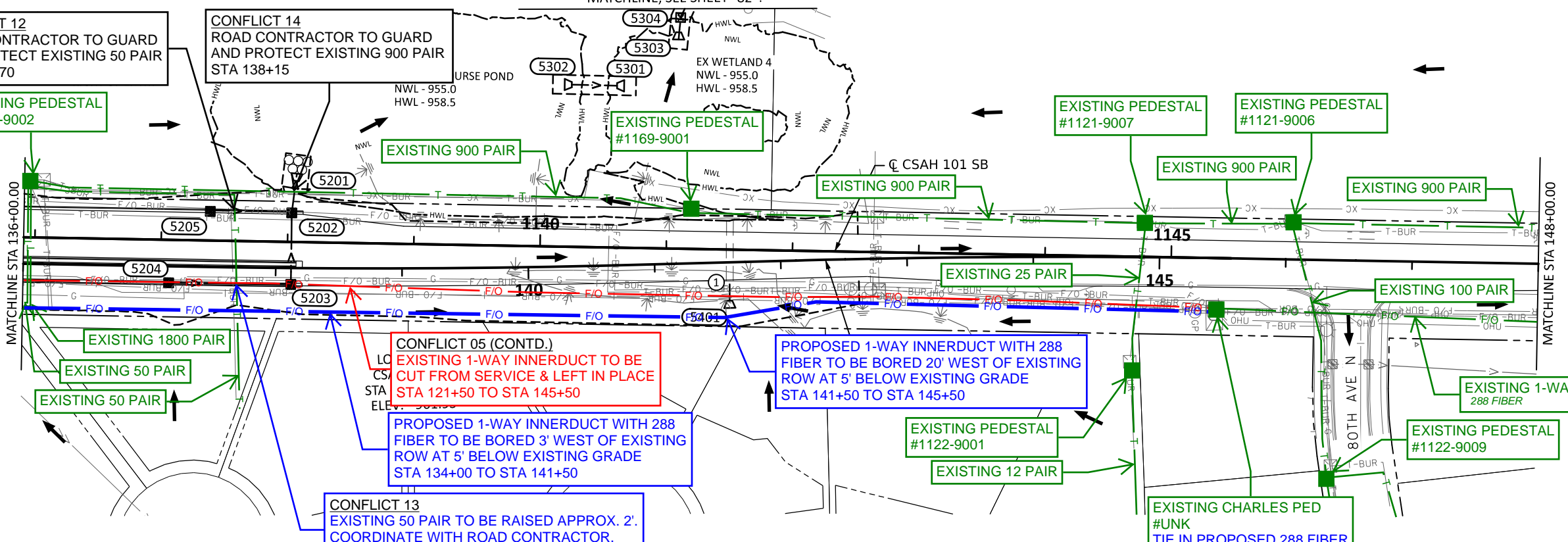
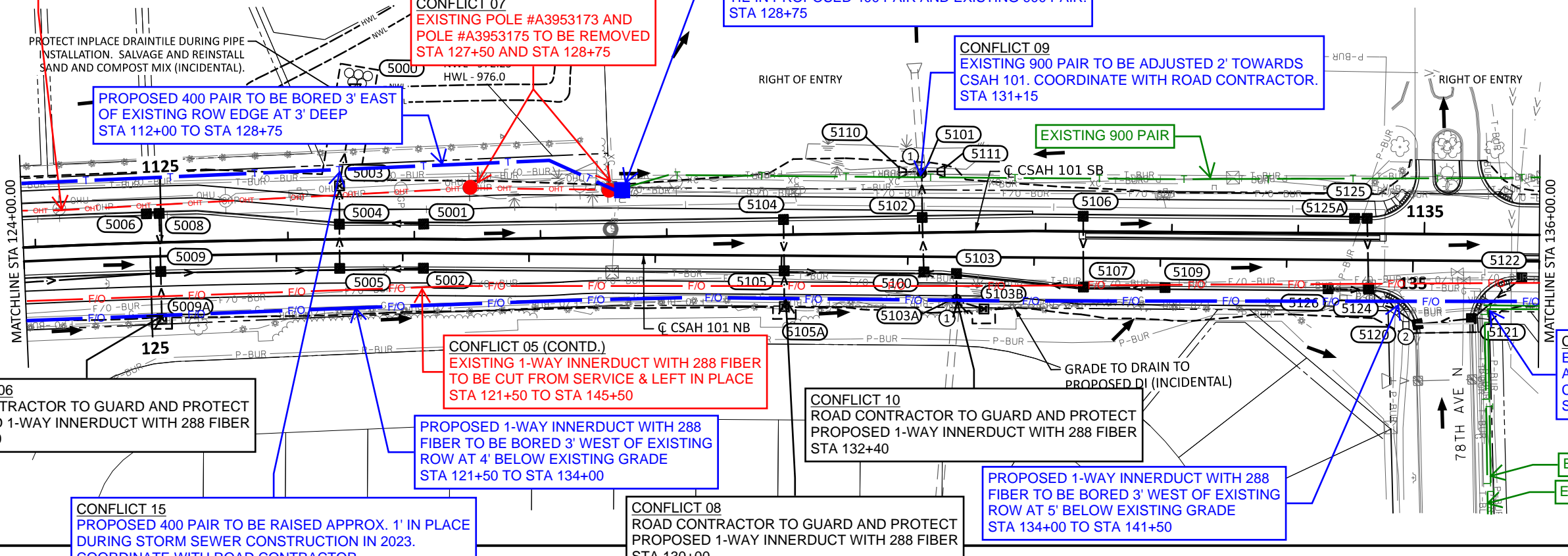
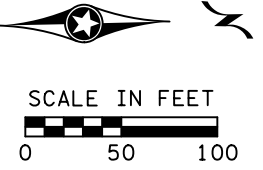
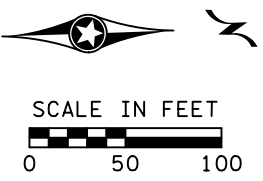

DATE: 6/10/2022 2:55:37 PM
 PATH & FILENAME: Projects\Minnesota\017086-000\Cad\Plan\017086-000_dp.dgn

NO.	DATE	BY	CHK	REVISIONS

Design By: GAD
 Checked By: AJP
 Approved By: MKV
 DATE: 6/10/2022
 LICENSE NO. 56164



CSAH 101 Improvements

MAPLE GROVE, MINNESOTA

DRAINAGE PLAN

SAP 027-701-038 / SAP 189-020-027 / CP 2174900 / CITY PROJ 22-10

SHEET 80 OF 115 SHEETS

NO LUMEN CONFLICTS

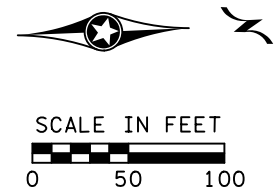
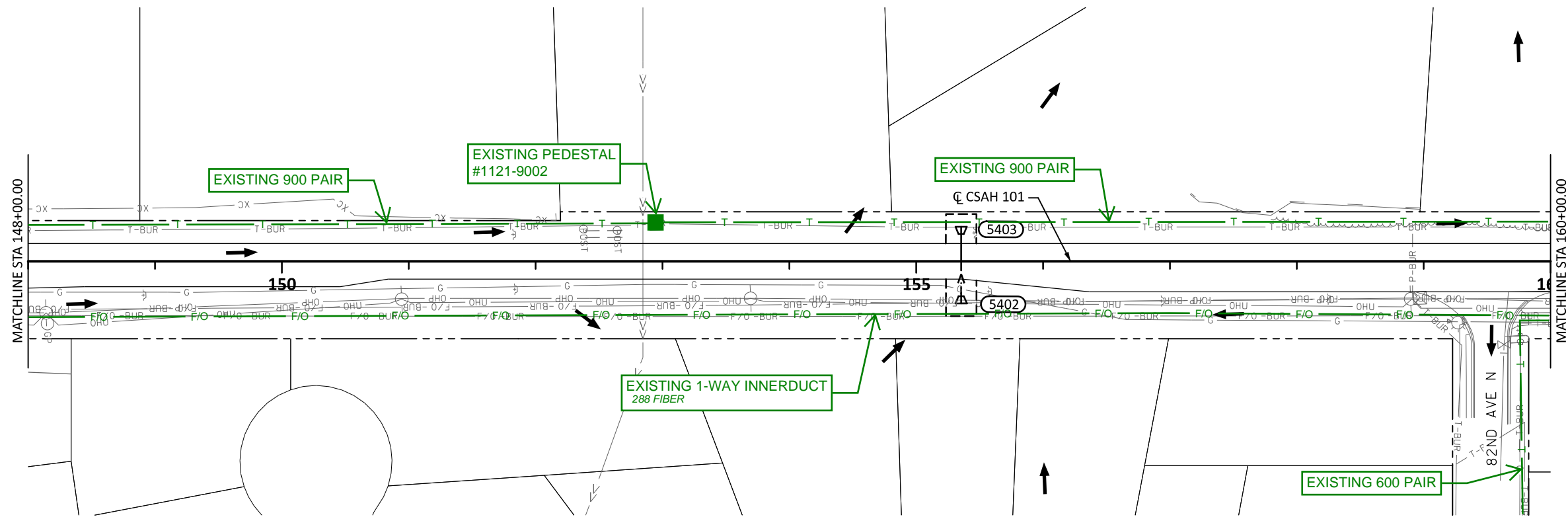

LEGEND

- ① CONNECT TO INPLACE CULVERT
- ② CONNECT TO EXISTING STORM SEWER
- CONSTRUCTION LIMITS
- - - EXISTING R/W
- PROPOSED R/W
- - - DRAINAGE & UTIL ESMT.
- - - TEMPORARY EASEMENT
- AREA OF ENVIRONMENTAL SENSITIVITY
- STORM SEWER
- CULVERT
- ▭ CATCH BASIN/DROP INLET
- ⊙ MANHOLE
- △ APRON
- ⊙ STRUCTURE NUMBER
- ⊙ RANDOM RIPRAP
- SURFACE FLOW ARROW

NOTES:
 1. ALL DIMENSIONS ARE TO FACE OF CURB OR EDGE OF BITUMINOUS UNLESS OTHERWISE NOTED.
 2. REFER TO SHEETS 83 TO 91 FOR DRAINAGE TABULATIONS AND PROFILES.

NO LUMEN CONFLICTS

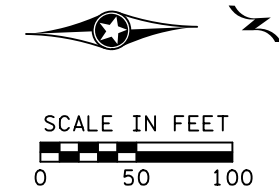
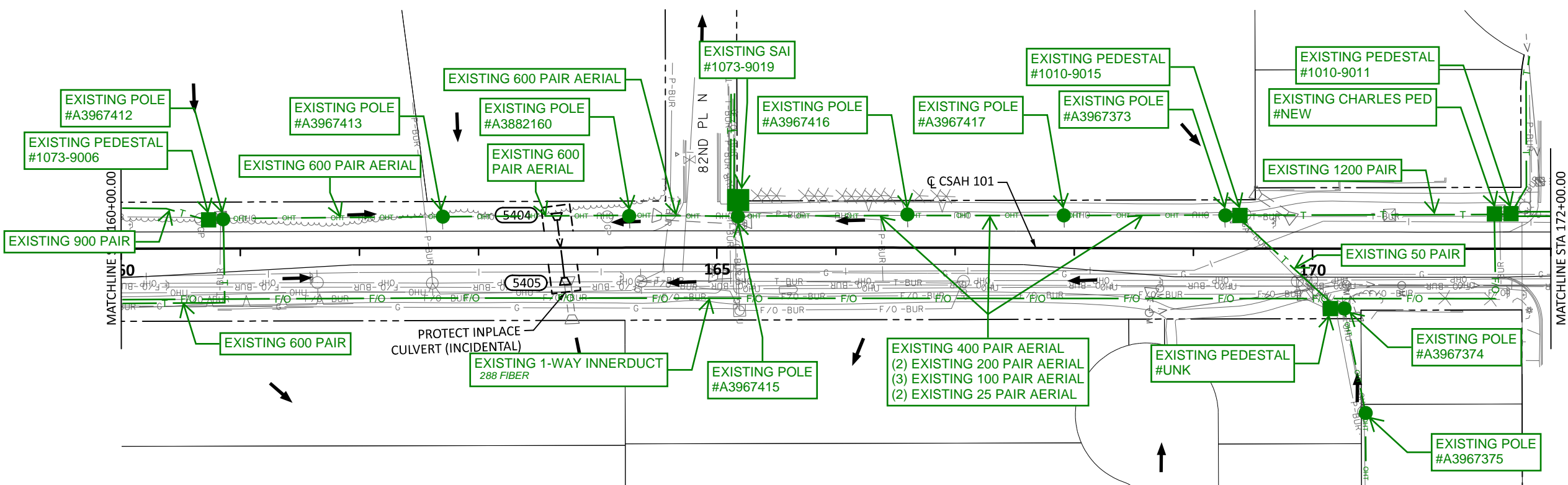

DATE: 6/10/2022 2:55:39 PM
 PATH & FILENAME: Projects\Minnesota\017086-000\Cad\Plan\017086-000_dp.dgn

NO.	DATE	BY	CHK	REVISIONS

Design By: MKV
 Plan By: GAD
 Checked By: AJP
 Approved By: MKV

I HEREBY CERTIFY THAT THIS PLAN WAS PREPARED BY ME OR UNDER MY DIRECT SUPERVISION AND THAT I AM A DULY LICENSED PROFESSIONAL ENGINEER UNDER THE LAWS OF THE STATE OF MINNESOTA.

MARCUS VANDERBRUG, PE
 DATE: 6/10/2022 LICENSE NO. 56164



CSAH 101 Improvements

MAPLE GROVE, MINNESOTA

DRAINAGE PLAN

SAP 027-701-038 / SAP 189-020-027 / CP 2174900 / CITY PROJ 22-10

SHEET 81 OF 115 SHEETS

NO LUMEN CONFLICTS

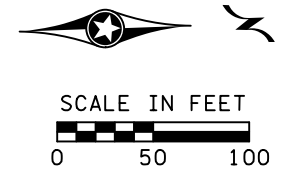
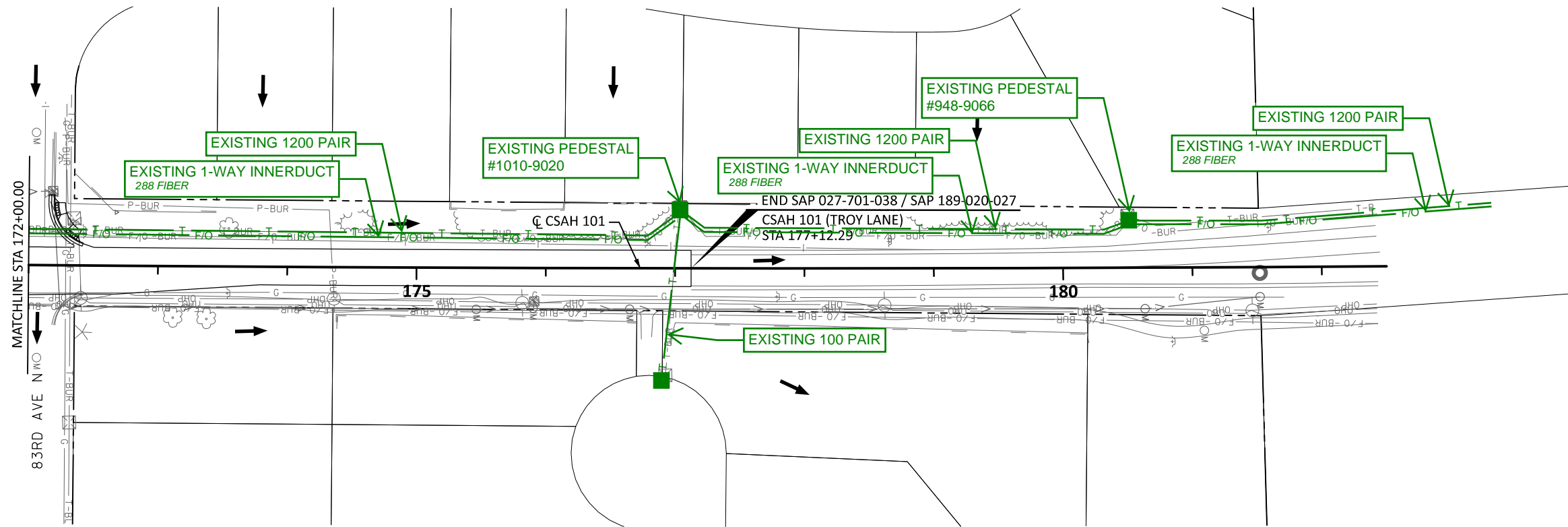

LEGEND

- ① CONNECT TO INPLACE CULVERT
- ② CONNECT TO EXISTING STORM SEWER
- CONSTRUCTION LIMITS
- - - EXISTING R/W
- PROPOSED R/W
- - - DRAINAGE & UTIL ESMT.
- - - TEMPORARY EASEMENT
- AREA OF ENVIRONMENTAL SENSITIVITY
- STORM SEWER
- CULVERT
- ▣ CATCH BASIN/DROP INLET
- ⊙ MANHOLE
- △ APRON
- 0000 STRUCTURE NUMBER
- RANDOM RIPRAP
- SURFACE FLOW ARROW

NOTES:
 1. ALL DIMENSIONS ARE TO FACE OF CURB OR EDGE OF BITUMINOUS UNLESS OTHERWISE NOTED.
 2. REFER TO SHEETS 83 TO 91 FOR DRAINAGE TABULATIONS AND PROFILES.

NO LUMEN CONFLICTS

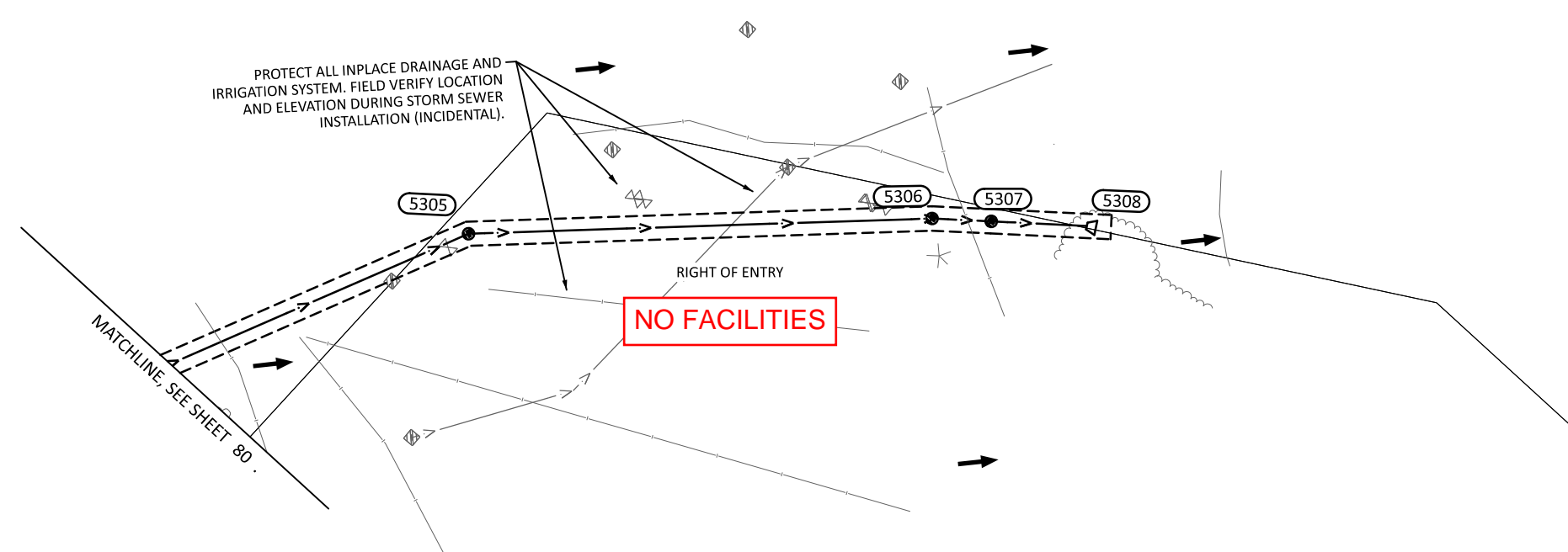

DATE: 6/10/2022 2:55:40 PM
PATH & FILENAME: Projects\Minnesota\017086-000\Cad\Plan\017086-000_dp.dgn

NO.	DATE	BY	CHK	REVISIONS

Design By: MKV
 Plan By: GAD
 Checked By: AJP
 Approved By: MKV

I HEREBY CERTIFY THAT THIS PLAN WAS PREPARED BY ME OR UNDER MY DIRECT SUPERVISION AND THAT I AM A DULY LICENSED PROFESSIONAL ENGINEER UNDER THE LAWS OF THE STATE OF MINNESOTA.

MARCUS VANDERBRUG, PE
 DATE: 6/10/2022 LICENSE NO. 56164



CSAH 101 Improvements
 Maple Grove, Minnesota

MAPLE GROVE, MINNESOTA

DRAINAGE PLAN

SAP 027-701-038 / SAP 189-020-027 / CP 2174900 / CITY PROJ 22-10

SHEET
 82
 OF
 115
 SHEETS