

CONSTRUCTION NOTES

Obtain Construction Plans from Designer prior to starting job.

Coordinate with Contractor / Engineering Firm for exact locations of proposed structures and facilities prior to installation of gas facilities.

Install new main as shown or as directed in field at time of installation. Contact Engineering for approval of field generated changes.

Long side mains and services to be installed below proposed sub-cuts (See Construction Plans).

All test points should be installed in the boulevard or other acceptable locations and avoid placement in driving lanes.

Verify Coating test results if required prior to abandoning main.

CONSTRUCTION PROCEDURES

Install, Clean and Test, and Put in Service; Proposed new main per CenterPoint Energy Construction and Services Manual.

Procedure for tapping or making tie-ins to existing gas mains: Verify existing gas main size, type, and location prior to tapping or making tie-in. Monitor and verify, using a pressure gauge, existing gas main Pressure Class within the bell hole of tap location or tie-in location prior to tapping or making tie-in.

Purge new main until essentially 100% reading is obtained on Combustible Gas Indicator. See CenterPoint Energy Construction and Service Manual Section CS-B-1.230 for purging mains into service.

Complete all Service / Meter Work as directed. (See Service Survey)

See Abandonment Procedures for abandonment and purging procedures.

Install a marker ball at a new end of main, at a valve, at each ell of a horizontal offset, at road crossings and at any fitting or pressure control identified as needing to be located in the future. Refer to CenterPoint Energy Construction and Service Manual section CS-B-1.310 for installation procedures.

ABANDONMENT PROCEDURES

See Construction Procedures for installation of mains and services prior to abandonments.

This project includes work on one-way feed mains. Ensure all proposed main is in service, all taps are completed and all services have been transferred to new main prior to abandonments.

Cut and Abandon existing main as shown. Purge abandoned mains until essentially 0% gas reading is obtained on Combustible Gas Indicator. See CenterPoint Energy Construction and Service Manual Section CS-B-1.110 and Section CS-B-1.230 for purging mains out of service using air movers.

Contact Engineering with questions.

NOTE: BORE ALL PAVED STREETS AND DRIVEWAYS

Minimum depth requirements for crossings of state highways and county roads is 60". Minimum depth requirements for crossings of city streets and township roads is 48".

Minimum depth for parallel installations on state highways and county roads is 30". Minimum depth for parallel installations on city streets and township roads is 30". All steel pipe welds to be coated with 2 part epoxy.

When butt fusing to existing in-service polyethylene, visually inspect for the presence of hydrocarbon permeation immediately after removing fusion iron. If any bubbling is identified on the heated surface, do not join to new PE pipe. Allow to cool and cut this end off (12" length) and send to the Golden Valley Lab with street location and W.O.#. Complete tie-in/extension using an electrofusion coupling(s).

Document in field notes.

Pipe < 4-inches Diameter (Unregulated PCB area):

Project area cleared for internal impacts. Pipe being removed is unregulated for disposal if coating does not exist or is non-asbestos. Refer to CNP Construction and Service Manual CS-B-1.110, CS-B-1.330, and CS-B-1.100, for pipe to be abandoned.

AAPE Pipe Sample

For AAPE pipe installed from 1968 to 1973 collect a two foot long pipe sample, document Main Auth and sample location then deliver to Golden Valley Lab.

EXISTING: 4" PE TEE (A61302001)
18" NCL GENTILLY
24" WCL SBL COR RD 61

EXISTING: 4X2 PE REDUCER (A61302001)
18" NCL GENTILLY LA
24" WCL CO RD 16

INSTALL: 4X2 HVPT
@ MIN. 3' SNL GENTILLY RD
EXTEND: 2" PE CL-6 EAST

CUT & ABANDON: 2" TR CL-6 EAST
USE 2" PE CAP

INSTALL: 2" PE CAP
@ MIN. 3' SNL GENTILLY RD
@ TO COVER END SERVICE #11542 GENTILLY RD
EXTEND: 2" PE CL-6 WEST

5/26/2022 12:23:25 PM DESIGNER EXPRESS DESIGN

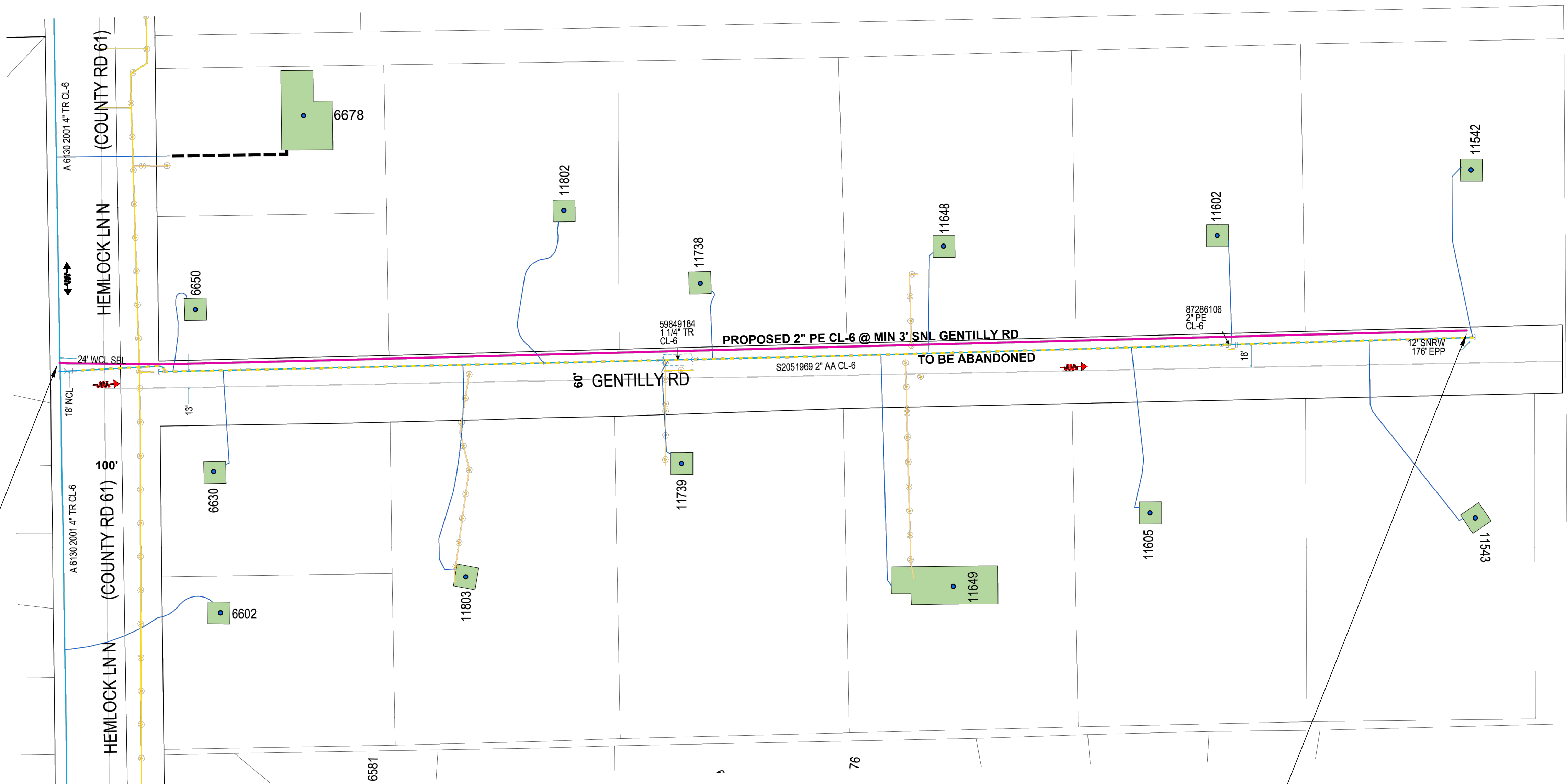

MINNESOTA REGION

PROPRIETARY AND CONFIDENTIAL

PROJECT #: 103078636

M52800 MAPLE GROVE

ONE CALL:
Hennepin
*NW35 T119/R22
*NE35 T119/R22
* = this Page

- LEGEND:
- ACTIVE MAIN
 - DESIGNED MAIN
 - - - PROPOSED ABANDONED/
 - - - OUT OF SERVICE MAIN
 - - - ABANDONED/
 - - - OUT OF SERVICE MAIN

PIPE REQUIRED:
1280' 2" PE CL-6
1280' PIPE

PROPOSED ABANDONED PIPE:
83' 2" TR CL-6
26' 1 1/4" TR CL-6
1157' 2" AA CL-6
5' 2" PE CL-6
1271' PIPE

COPIES:
PIPELINE INTEGRITY PACKET: N
STATION MANAGER: N
DD NUMBER: N/A
CORROSION: PATRICK CARLSON
EMP: N

SITE CONTACT: JOSEPH BZDOK
763-494-6362

SURVEYOR REQUIRED? N

RETURN PACKET TO ENG? N

JOB BRIEFING REQUIRED? Y

GFIP #: N/A

PERMITS: CITY OF MAPLE GROVE
HENNEPIN COUNTY

PROJECT DESCRIPTION: SREL
GENTILLY RD

DESIGNER: Kevin Scott
PHONE #: 612-321-5508
DRAWN BY: Kevin Scott
DESIGN DATE: 5/18/2022

REVISION INFO:

Main
SSS SCALE 1"=60'
SHEET 1 OF 1

I hereby certify that this plan, specification, or report was prepared by me or under my direct supervision and that I am a duly Licensed Professional Engineer under the laws of the state of Minnesota.

Signature: *Daniel G. Christensen*

Typed or Printed Name: DANIEL G. CHRISTENSEN

Date: 05/26/2022 License Number: 46588