

17ft DWB

103ft in ROW
2 feet from curb

N
↑

17784 88th
Ave N, M.G.

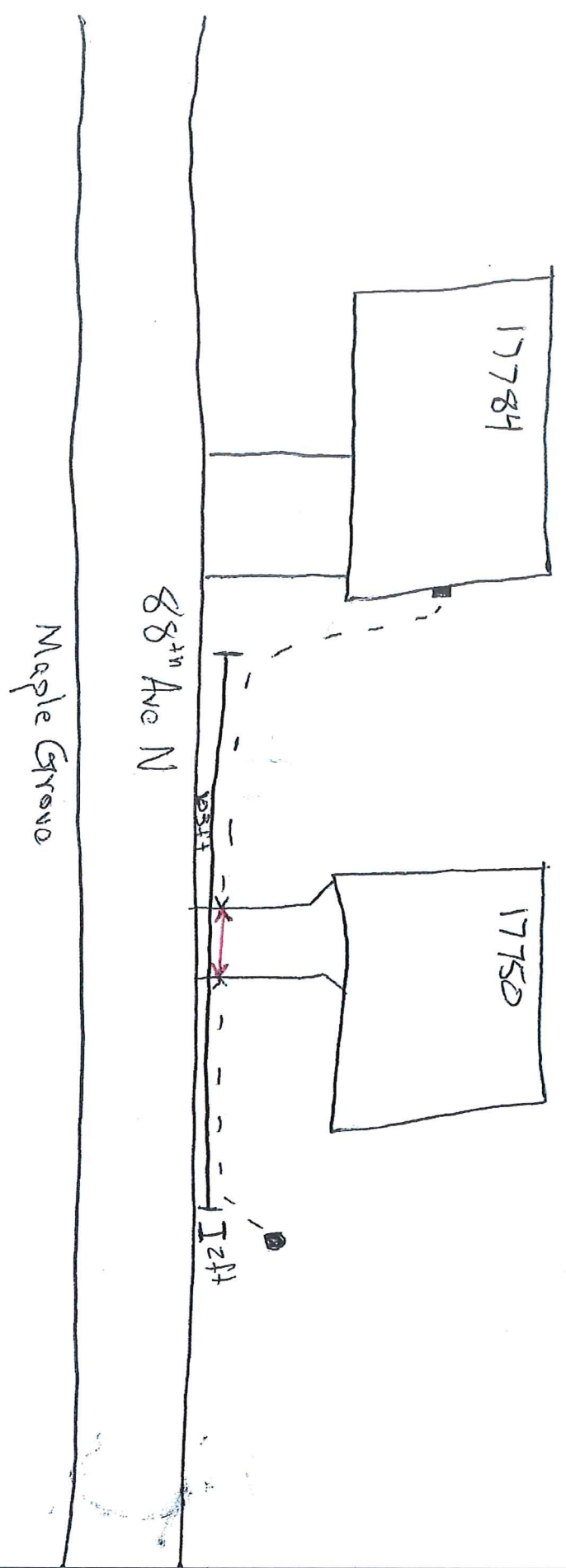



Hennepin County Property Map

Date: 5/20/2022



PARCEL ID: 1811922410046

OWNER NAME: K E Holmberg & S Holmberg

PARCEL ADDRESS: 17784 88th Ave N, Maple Grove MN 55311

PARCEL AREA: 0.35 acres, 15,392 sq ft

A-T-B: Abstract

SALE PRICE: \$46,900

SALE DATA: 09/1996

SALE CODE: Excluded From Ratio Studies

ASSESSED 2021, PAYABLE 2022

PROPERTY TYPE: Residential

HOMESTEAD: Homestead

MARKET VALUE: \$430,000

TAX TOTAL: \$5,648.00

ASSESSED 2022, PAYABLE 2023

PROPERTY TYPE: Residential

HOMESTEAD: Homestead

MARKET VALUE: \$527,300

Comments:

This data (i) is furnished 'AS IS' with no representation as to completeness or accuracy; (ii) is furnished with no warranty of any kind; and (iii) is not suitable for legal, engineering or surveying purposes. Hennepin County shall not be liable for any damage, injury or loss resulting from this data.

COPYRIGHT © HENNEPIN COUNTY 2022