

17536 96TH PLACE N  
 ID: 473316047  
 PO: K520011 T29  
 ECK322/C/19.92kV

TASK 1: DIRECTIONAL BORE  
 BORE IN 255' OF 350 TRIPLEX CABLE P1 TO P2

TASK 2: TERMINATION  
 TERMINATE AT P1 AND P2

TASK 3: RESTORATION

TASK 4: REMOVE ADD-A-PHASE

NOTE: ABANDON EXISTING SVC CABLE IN PLACE  
 REPLACE PADLOCK ON TRANSFORMER AND SECONDARY PEDESTAL  
 REMOVE LANDSCAPE AT SECONDARY PEDESTAL

Work Order Information

Service Request #	:	
Design Number	:	000001074498
Designer/Planner ID	:	243322
Designer/Planner Name	:	Grosko, Deborah
Designer/Planner Ph #	:	(816) 414-1113
Manager Approval	:	

Joint Utility

E:	G:
T:	C:

Design Location

Division	:	Maple Grove
County	:	Hennepin
City	:	Maple Grove
Address	:	17536 96th Place N
T: 119N	R: 22W	S: 7
Map #	:	K52011
Permit	:	Maple Grove

Electric

Feeder	:	ECK322	Voltage	:	19.92kV
Phase	:	C	Bkup Dev ID:	:	

Gas

System	:	Pressure	:	
Size	:	Material	:	
Dead End	:		:	

Work Order # : 0000000107794737

Date: 05/09/2022

Sketch: 1 Of 1 Sketch Data

Scale: 1" equals 100'

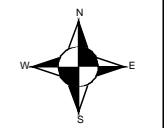

CONSTRUCTION USE ONLY

- NO CHANGES (BUILT AS DESIGNED)
- CHANGES MADE AS INDICATED  
(ALL URD MUST HAVE ACTUAL MEASUREMENTS FROM THE FIELD SITE)

RFO \_\_\_\_\_  
 FOREMAN \_\_\_\_\_ DATE \_\_\_\_\_  
 TEAM LEADER \_\_\_\_\_

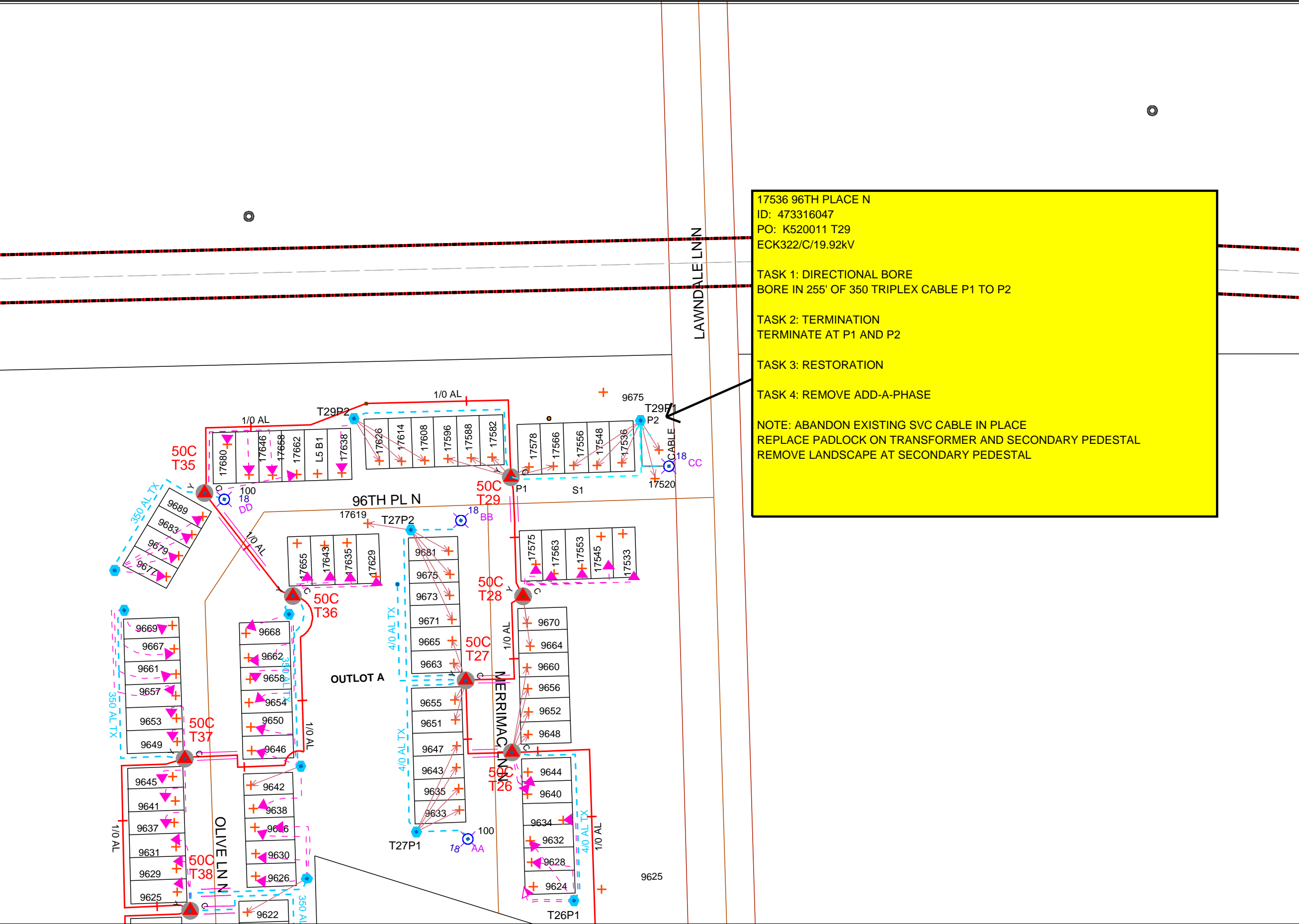

DISCLAIMER: THERE ARE NO REPRESENTATIONS OR WARRANTIES (EXPRESS OR IMPLIED) ABOUT THE ACCURACY OF THIS PRINT. THIS PRINT IS PROVIDED WITH NO CLAIM AS TO PRINT COMPLETENESS, TIMELINESS, ACCURACY OF CONTENT OR USEFULNESS. STATE LAW REQUIRES ANYONE DIGGING, GRADING OR EXCAVATING TO OBTAIN A PRIOR FIELD LOCATE OF ALL UTILITIES. THIS PRINT DOES NOT DISCHARGE THIS REQUIREMENT OR ANY OTHER REQUIREMENT. THE COMPANY AND ITS AFFILIATES ASSUME NO LEGAL RESPONSIBILITY OR LIABILITY FOR THE RECIPIENT'S USE (OR ANY OTHER PARTIES' USE) OF THE PRINT, INCLUDING THE RECIPIENT'S INTENDED PURPOSE IN USING THE PRINT. NO COMPANY EMPLOYEE OR OTHER PARTY HAS BEEN AUTHORIZED TO PROVIDE THIS PRINT FOR PLANNING OR ESTIMATING PURPOSES; RELY ON THIS PRINT AT YOUR OWN RISK. BY ACCEPTING THIS PRINT, THE RECIPIENT & ANY OTHER PARTY RECEIVING A COPY OF THE PRINT ACKNOWLEDGES AND AGREES TO THIS DISCLAIMER. For All Field Locates Call 811

THIS DOCUMENT IS XCEL ENERGY CONFIDENTIALS AND PROPRIETARY INFORMATION AND MAY NOT BE REPRODUCED IN WHOLE, OR IN PART, NOR MAY ANY OF THE INFORMATION CONTAINED HEREIN BE DISCLOSED WITHOUT THE CONSENT OF XCEL ENERGY. CONFIDENTIALS AND PROPRIETARY INFORMATION © 2019 XCEL ENERGY INC. |