

CenturyLink BSW Order/Maintenance Work Authorization

Company	Exchange Name MPGVMNXA	Service Order#	
Work Activity	Fiber-Buried	Capital	Y
Customer Name	Richard Lewis	Phone#	(763) 425-2799
Address	10690 Lancaster Ln N	One Call Ticket#	
City & Zip	Minneapolis, MN		
Location/Directions			

Description of Work or Special Instructions: Plow 295 ft of fiber from ped to nid. 265 ft right of way bore required

Converting customer from copper to fiber

Held Order	N	Permit:	Y	Bore:	Y	CBR#	
------------	---	---------	---	-------	---	------	--

Tech Name and Tech #	Don Evans	Employee Contact#	6124303133
----------------------	-----------	-------------------	------------

Sketch <small>(Include Cntr Line & Pedestal)</small>	Material/Labor Units		Footage/Quantity	Comments
	Description	Notes		
Cntr Line foot	SEB3-22	BSW-3 & plow plcmt		
	SEB3-22T	BSW-3 & hand dig plcmt		
Ped#	322941	SEPCUTOVER		
		CUTOVER BSW		
Parish/County	BM83	BSW guard at house	1	
	XXSEB-GL	Remove temp drop		Footage when temp can't be re-used
Township:	BM61(1.25)SEB	BSW Bore footage	265	
Section	SEBO PER FT LBR	Fiber & plow plcmt	30	
Range	SEBO PER FT LBR T	Fiber & hand dig plcmt		
	SEB6-22	BSW-6 & plow plcmt		
	BM2(5/8)(8)	Ground Rod		
	SEBO-COIL	Fiber Coil		Coil excess on Fiber drop add 1 unit
	Permit	Permit	1	Any placement within the ROW requires a permit

Nearest cross st.	107th Ave N	Plat Page		Map#	
-------------------	-------------	-----------	--	------	--

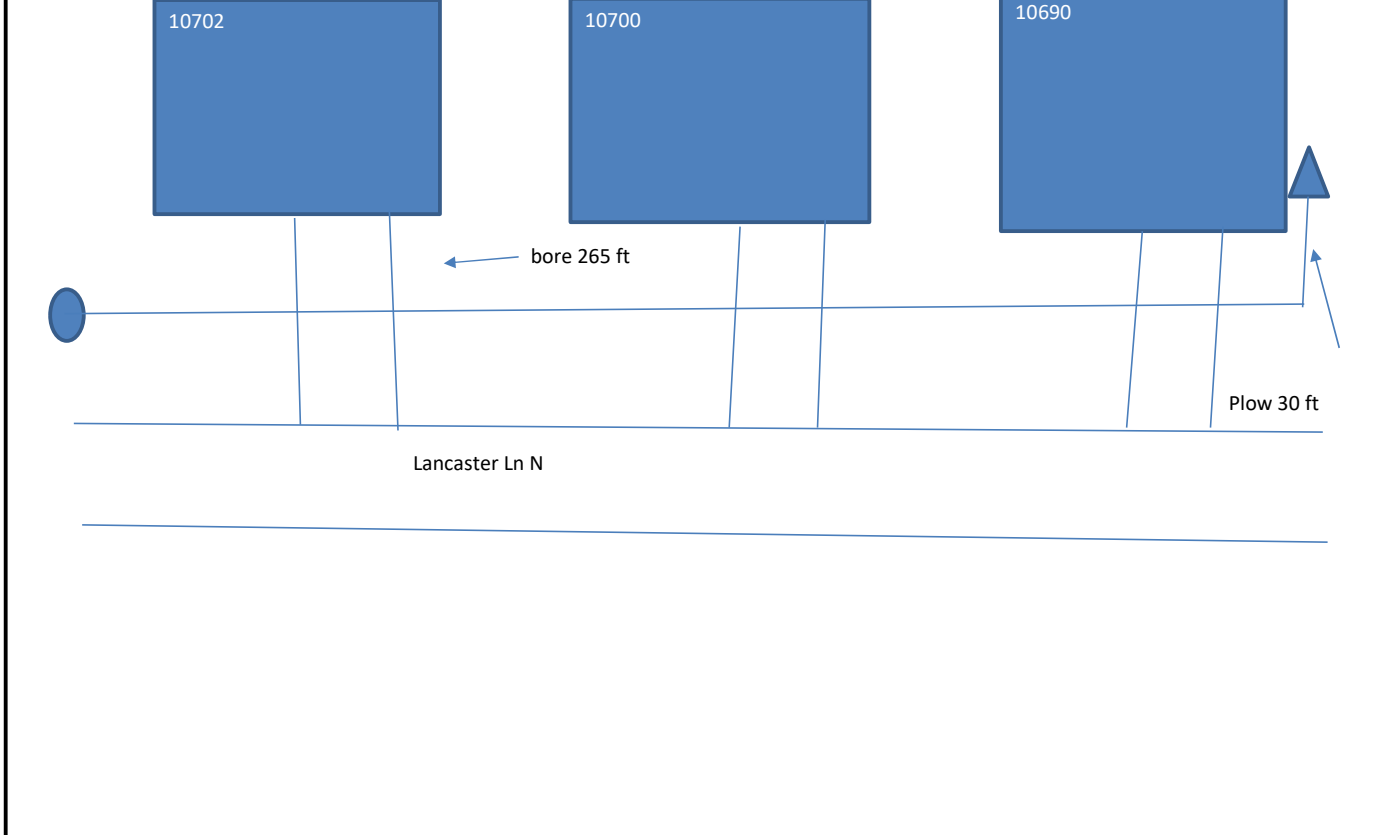

Originated By:	Don Evans	Date:	2/7/22	Completed By:	_____	Date:	_____
Authorized By: (SRO)	_____	Date:	_____	Inspected By:	_____	Date:	_____
Authorized By: (MRO)	_____	Date:	_____		_____		_____

1. Distance of the bury in Right-of-Way	3. Distance to the nearest intersection
2. Distance from the terminal to the centerline	4. Nearest State Hwy mile marker