



North

Scale: 1" : 194'

CenterPoint Energy
MGC 22-501

GENERAL LOCATION ONLY.
DO NOT USE TO LOCATE FOR EXCAVATION.
CALL 1-800-252-1166 FOR ONSITE LOCATIONS AND STAKING.

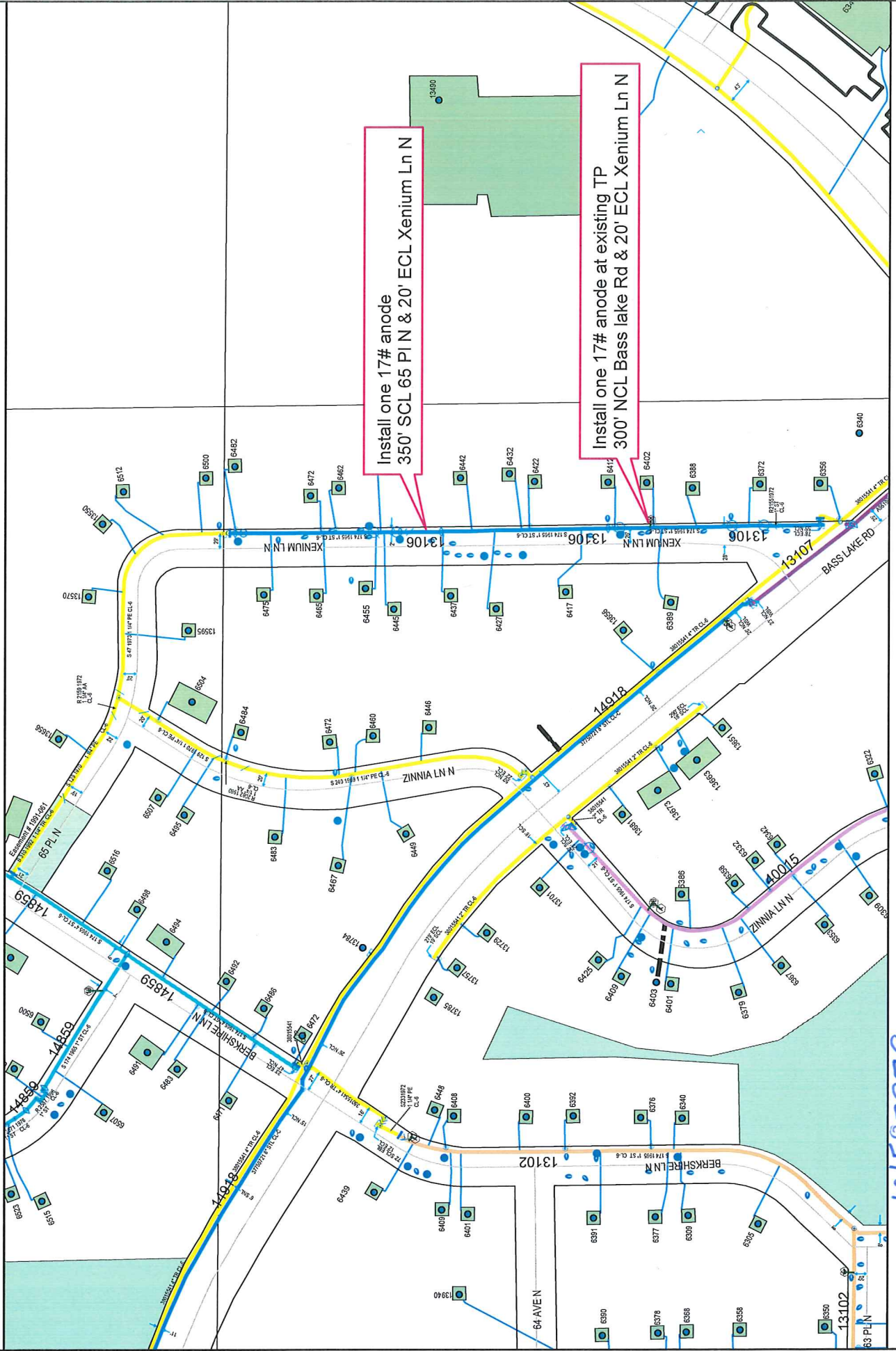

Designed By: Patrick Carlson
Designer Phone #: 612-434-1220

CP Section #: 13106
CP Area: 316

City: Maple Grove
Quad/Sec/Twp/Rng: SW34/119/22

Work Order #: 101587979
Design Date: 1/27/2022