

Bottineau 3 MDU - FTTP







11700 80th Ave. North
Maple Grove, MN 55369

JB0000814833

Node: MNMPGR103

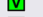
Legacy: DB183A

Google Image

Green Lin = New Underground Placement	
Yellow Line = Existing Conduit	
Blue Line = Aerial Placement	
New Fiber Vault	
Existing Fiber Vault	
New Pedestal	
Existing Pedestal	



Legend

Directional Drilling for Placement of (1) 2" Conduit 16'-31' BOC

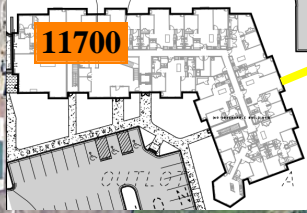

15'

187'

Directional Drilling for Placement of (1) 2" Conduit 8'-16' BOC

Existing Vault 8' BOC

654'

11875 80th Ave N

Pull through Existing Conduit

Pull through Existing Conduit



500 ft

**Bottineau 3
MDU - FTTP**
11700 80th Ave. North
Maple Grove, MN 55369
JB0000814833
Node: MNMPGR103
Legacy: DB183A

Green Lin = New Underground Placement
Yellow Line = Existing Conduit
Blue Line = Aerial Placement
New Fiber Vault
Existing Fiber Vault
New Pedestal
Existing Pedestal

MILESTAGE	PAID/LO
18.0	18.027.6/20.5
89.1V	A

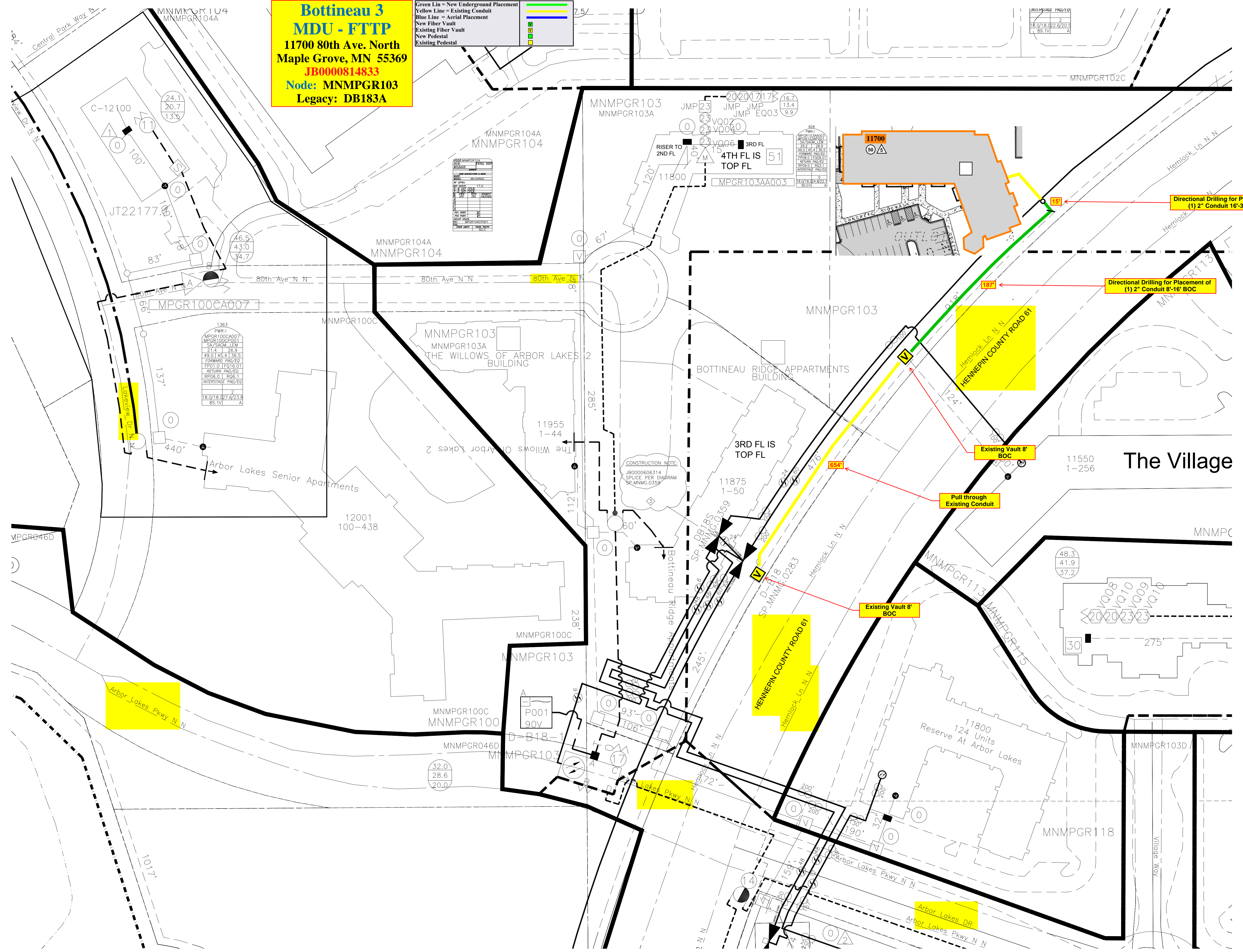

Directional Drilling for Placement of (1) 2" Conduit 16'-31' BOC

Directional Drilling for Placement of (1) 2" Conduit 8'-16' BOC

Existing Vault 8' BOC

Pull through Existing Conduit

Existing Vault 8' BOC