

FORESTVIEW LN N. MAPLE GROVE, MN

WO: 107405076

UG CONSTRUCTION

INSTALL FIBERGLASS POLES AND TRADITIONAL LIGHTS. BORE IN SECONDARY CABLE AND CONDUIT.

INSTALL:
 (3) A RATED TRADITIONAL LIGHTS
 (3) 18' FIBERGLASS POLES
 412' #6 DUPLEX SECONDARY CABLE
 412' 1 1/2" CONDUIT

NO RESTORATION

KELLY MATZKE: 763-494-6365

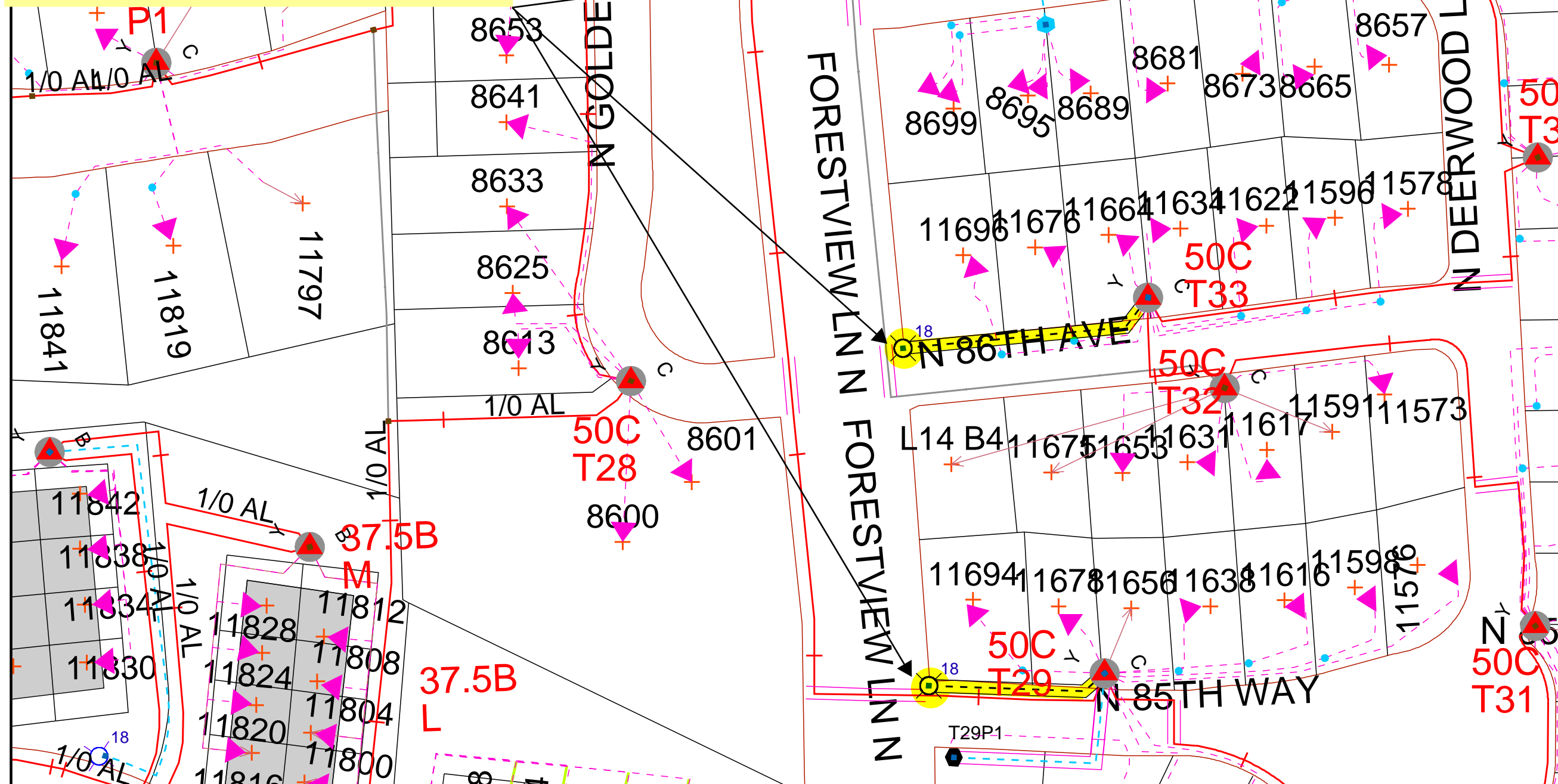

Work Order Information

Service Request #	:	
Design Number	:	000001060868
Designer/Planner ID	:	243934
Designer/Planner Name	:	Krampert, Alicia
Designer/Planner Ph #	:	612-346-2952
Manager Approval	:	

Joint Utility

E:	G:
T:	C:

Design Location

Division	:	Maple Grove
County	:	Hennepin
City	:	Maple Grove
Address	:	FORESTVIEW LN N
T: 119N	R: 22W	S: 14
Map #	:	K52059
Permit	:	

Electric

Feeder:	Voltage:
Phase:	Bkup Dev ID:

Gas

System	:	Pressure	:
Size	:	Material	:
Dead End	:		

Work Order #

Date: 01/19/2022
 Sketch: #1 Of #1 Sketch Data
 Scale: 1" equals 71'



CONSTRUCTION USE ONLY

- NO CHANGES (BUILT AS DESIGNED)
- CHANGES MADE AS INDICATED (ALL URD MUST HAVE ACTUAL MEASUREMENTS FROM THE FIELD SITE)

RFO _____
 FOREMAN _____ DATE _____
 TEAM LEADER _____

DISCLAIMER: THERE ARE NO REPRESENTATIONS OR WARRANTIES (EXPRESS OR IMPLIED) ABOUT THE ACCURACY OF THIS PRINT. THIS PRINT IS PROVIDED WITH NO CLAIM AS TO PRINT COMPLETENESS, TIMELINESS, ACCURACY OF CONTENT OR USEFULNESS. STATE LAW REQUIRES ANYONE DIGGING, GRADING OR EXCAVATING TO OBTAIN A PRIOR FIELD LOCATE OF ALL UTILITIES. THIS PRINT DOES NOT DISCHARGE THIS REQUIREMENT OR ANY OTHER REQUIREMENT. THE COMPANY AND ITS AFFILIATES ASSUME NO LEGAL RESPONSIBILITY OR LIABILITY FOR THE RECIPIENT'S USE (OR ANY OTHER PARTIES' USE) OF THE PRINT, INCLUDING THE RECIPIENT'S INTENDED PURPOSE IN USING THE PRINT. NO COMPANY EMPLOYEE OR OTHER PARTY HAS BEEN AUTHORIZED TO PROVIDE THIS PRINT FOR PLANNING OR ESTIMATING PURPOSES; RELY ON THIS PRINT AT YOUR OWN RISK. BY ACCEPTING THIS PRINT, THE RECIPIENT & ANY OTHER PARTY RECEIVING A COPY OF THE PRINT ACKNOWLEDGES AND AGREES TO THIS DISCLAIMER. For All Field Locates Call 811

THIS DOCUMENT IS XCEL ENERGY CONFIDENTIALS AND PROPRIETARY INFORMATION AND MAY NOT BE REPRODUCED IN WHOLE, OR IN PART, NOR MAY ANY OF THE INFORMATION CONTAINED HEREIN BE DISCLOSED WITHOUT THE CONSENT OF XCEL ENERGY. CONFIDENTIALS AND PROPRIETARY INFORMATION © 2019 XCEL ENERGY INC. | XCEL ENERGY IS REGISTERED TRADEMARK OF XCEL ENERGY INC