

10000 96TH AVE N
 ID: 35557050
 POI: L211 M06
 OSS073/A/7.9kV

TASK 1: DIRECTIONAL BORE
 BORE IN 165' OF 1/0 AL UG TRIPLEX CABLE P1 TO P2

TASK 2: TERMINATION
 TERMINATE AT P1 AND P2

TASK 3: RESTORATION

TASK 4: REMOVE ADD-A-PHASE

NOTE: ABANDON EXISTING SVC CABLE IN PLACE
 REPLACE PADLOCK ON TRANSFORMER
 REMOVE LANDSCAPE AT METER AND TRANSFORMER

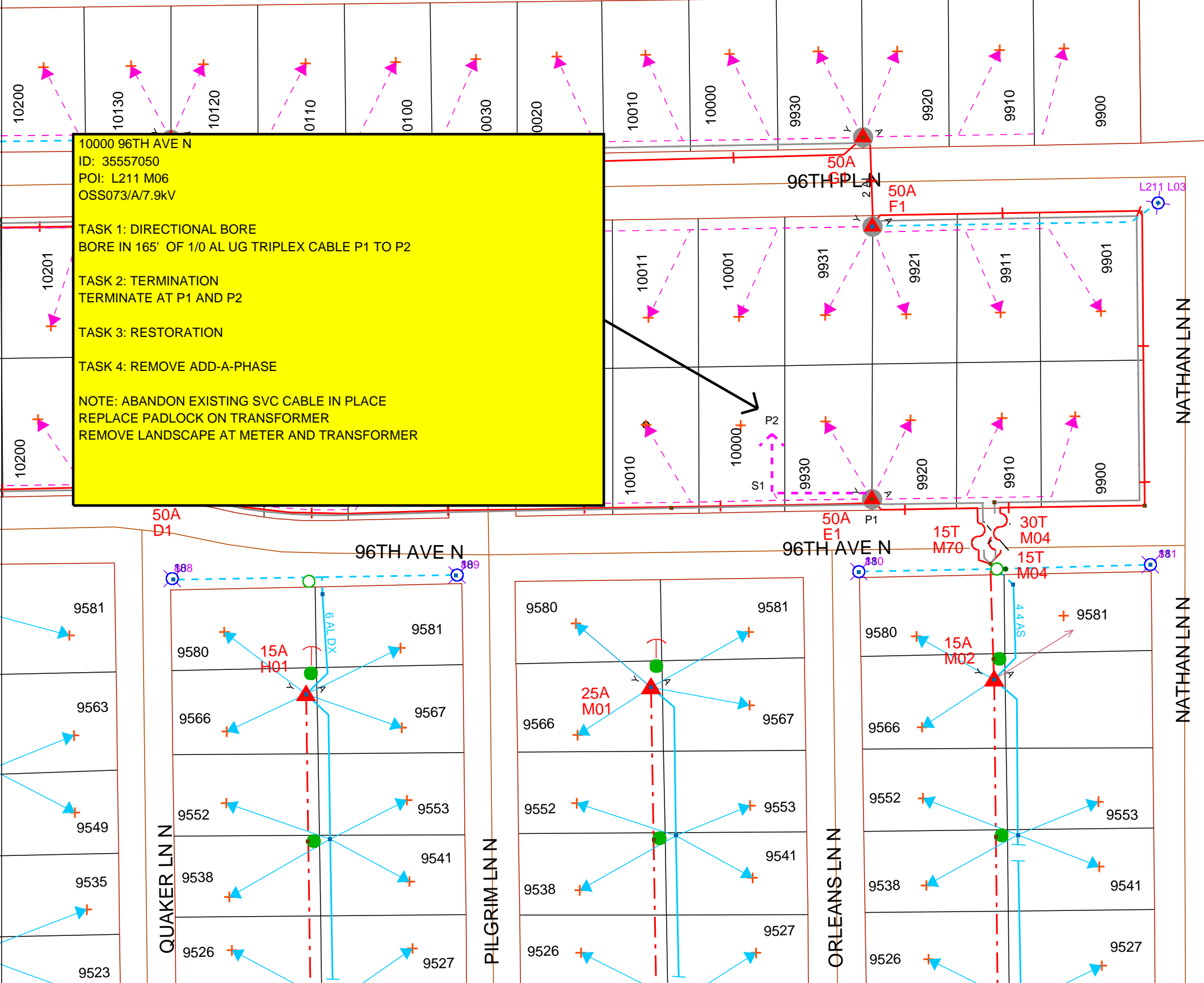

Work Order Information	
Service Request #	:
Design Number	: 000001061298
Designer/Planner ID	: 243322
Designer/Planner Name	: Grosko, Deborah
Designer/Planner Ph #	: (816) 414-1113
Manager Approval	:

Joint Utility	
E:	G:
T:	C:

Design Location	
Division	: Maple Grove
County	: Hennepin
City	: Maple Grove
Address	: 10000 96th Ave N
T: 119N	R: 22W S: 12
Map #	: L52011 Permit : Maple Grove

Electric	
Feeder: OSS073	Voltage: 7.9kV
Phase: A	Bkup Dev ID:

Gas	
System	: Pressure
Size	: Material
Dead End	:

Work Order # : 000000107346328

Date: 01/27/2022
 Sketch: 1 Of 1 Sketch Data
 Scale: 1" equals 100'



CONSTRUCTION USE ONLY

NO CHANGES (BUILT AS DESIGNED)
 CHANGES MADE AS INDICATED (ALL URD MUST HAVE ACTUAL MEASUREMENTS FROM THE FIELD SITE)

RFO _____
 FOREMAN _____ DATE _____
 TEAM LEADER _____

DISCLAIMER: THERE ARE NO REPRESENTATIONS OR WARRANTIES (EXPRESS OR IMPLIED) ABOUT THE ACCURACY OF THIS PRINT. THIS PRINT IS PROVIDED WITH NO CLAIM AS TO PRINT COMPLETENESS, TIMELINESS, ACCURACY OF CONTENT OR USEFULNESS. STATE LAW REQUIRES ANYONE DIGGING, GRADING OR EXCAVATING TO OBTAIN A PRIOR FIELD LOCATE OF ALL UTILITIES. THIS PRINT DOES NOT DISCHARGE THIS REQUIREMENT OR ANY OTHER REQUIREMENT. THE COMPANY AND ITS AFFILIATES ASSUME NO LEGAL RESPONSIBILITY OR LIABILITY FOR THE RECIPIENT'S USE (OR ANY OTHER PARTIES' USE) OF THE PRINT, INCLUDING THE RECIPIENT'S INTENDED PURPOSE IN USING THE PRINT. NO COMPANY EMPLOYEE OR OTHER PARTY HAS BEEN AUTHORIZED TO PROVIDE THIS PRINT FOR PLANNING OR ESTIMATING PURPOSES; RELY ON THIS PRINT AT YOUR OWN RISK. BY ACCEPTING THIS PRINT, THE RECIPIENT & ANY OTHER PARTY RECEIVING A COPY OF THE PRINT ACKNOWLEDGES AND AGREES TO THIS DISCLAIMER. For All Field Locates Call 811

THIS DOCUMENT IS XCEL ENERGY CONFIDENTIALS AND PROPRIETARY INFORMATION AND MAY NOT BE REPRODUCED IN WHOLE, OR IN PART, NOR MAY ANY OF THE INFORMATION CONTAINED HEREIN BE DISCLOSED WITHOUT THE CONSENT OF XCEL ENERGY. CONFIDENTIALS AND PROPRIETARY INFORMATION © 2019 XCEL ENERGY INC. |