



SOUTH ELEVATION

CUSTOMER APPROVAL OF DESIGN I/C:

SIGNATURE: _____

PRINTED NAME: _____ DATE: _____

Please review CenterPoint Energy design for installing Natural Gas to your facility. Verify the route of the Service Line and Meter Location on the building. If there is a conflict please contact the Designer or Sales Rep as shown in the Title Block. Before a natural gas service line can be installed, you must clearly mark all privately-owned underground facilities including: septic tanks, drain fields, sewer lines, water wells, sprinkler systems, invisible fences, electric lines and pipelines. CenterPoint Energy and its representatives are not responsible for damage to these items if they are not clearly marked at time of installation.



PROPRIETARY AND CONFIDENTIAL

100394373
M52900 MAPLE GROVE

ONE CALL:
Hennepin
*SW25 T119/R22
* = this Page

- LEGEND:**
- ACTIVE
 - DESIGNED
 - PROPOSED
 - ABANDONED
 - A ABANDONED
 - Interruptible
 - Existing
 - Normal
 - Future
 - Proposed

Address: 10402 73rd Ave N
Customer: Keller Williams
Contact Person: Cliff Reithel
Contact Phone: 612-280-8171
Sales Rep: Grant Dhein
Sales Rep Phone: 612-861-8455
Construction Hotline: 612-321-5310
Copies To Pipeline Integrity: No
Curb Valve: No
Copies to Corrosion: No
Corrosion Approval: N/A
Follow Internal Pipe Sampling Requirements? No
GFIP#: N/A
Permits: Yes - City Of Maple Grove
Requested Install Date: 11/21/2021

Approval: *TJ Dehne* 11/3/2021

PROJECT DESCRIPTION:
KELLER WILLIAMS

DESIGNER: Wendy Seidl
PHONE #: 612-321-5476
DRAWN BY: Wendy Seidl
DESIGN DATE: 10/29/2021

Revised Print
Destroy All Others
Revision History
Date:
Description:
Design Approval:

IC Services
SCAN DATE: 1" : 81'
SHEET 1 OF 1

DESIGNER EXPRESS DESIGN
10/29/2021 7:28:13 PM

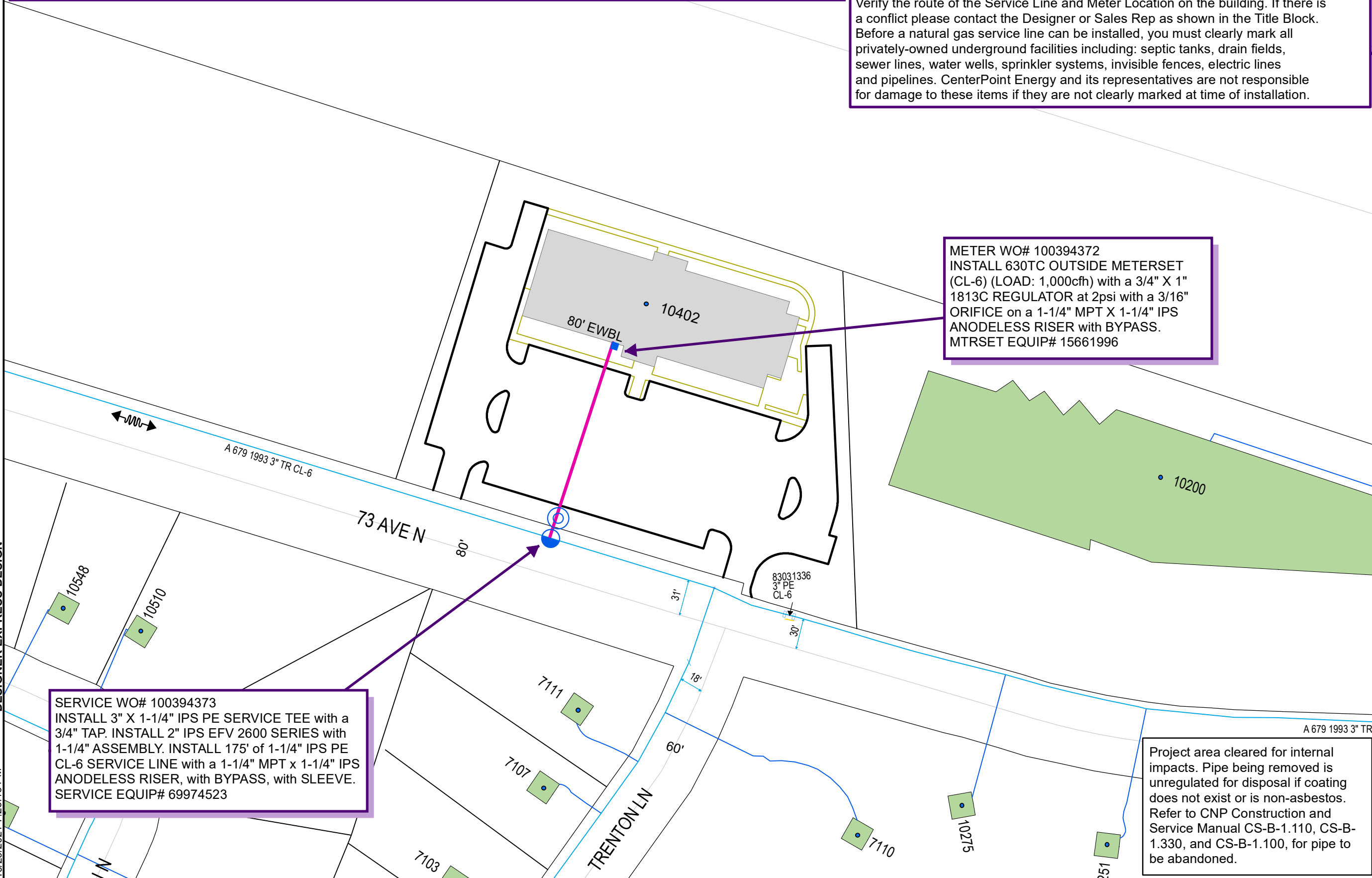

METER WO# 100394372
INSTALL 630TC OUTSIDE METERSET (CL-6) (LOAD: 1,000cfh) with a 3/4" X 1" 1813C REGULATOR at 2psi with a 3/16" ORIFICE on a 1-1/4" MPT X 1-1/4" IPS ANODELESS RISER with BYPASS. MTRSET EQUIP# 15661996

SERVICE WO# 100394373
INSTALL 3" X 1-1/4" IPS PE SERVICE TEE with a 3/4" TAP. INSTALL 2" IPS EFV 2600 SERIES with 1-1/4" ASSEMBLY. INSTALL 175' of 1-1/4" IPS PE CL-6 SERVICE LINE with a 1-1/4" MPT x 1-1/4" IPS ANODELESS RISER, with BYPASS, with SLEEVE. SERVICE EQUIP# 69974523

Project area cleared for internal impacts. Pipe being removed is unregulated for disposal if coating does not exist or is non-asbestos. Refer to CNP Construction and Service Manual CS-B-1.110, CS-B-1.330, and CS-B-1.100, for pipe to be abandoned.