

17320 78<sup>th</sup> ave n  
maj. x-street laundable ln

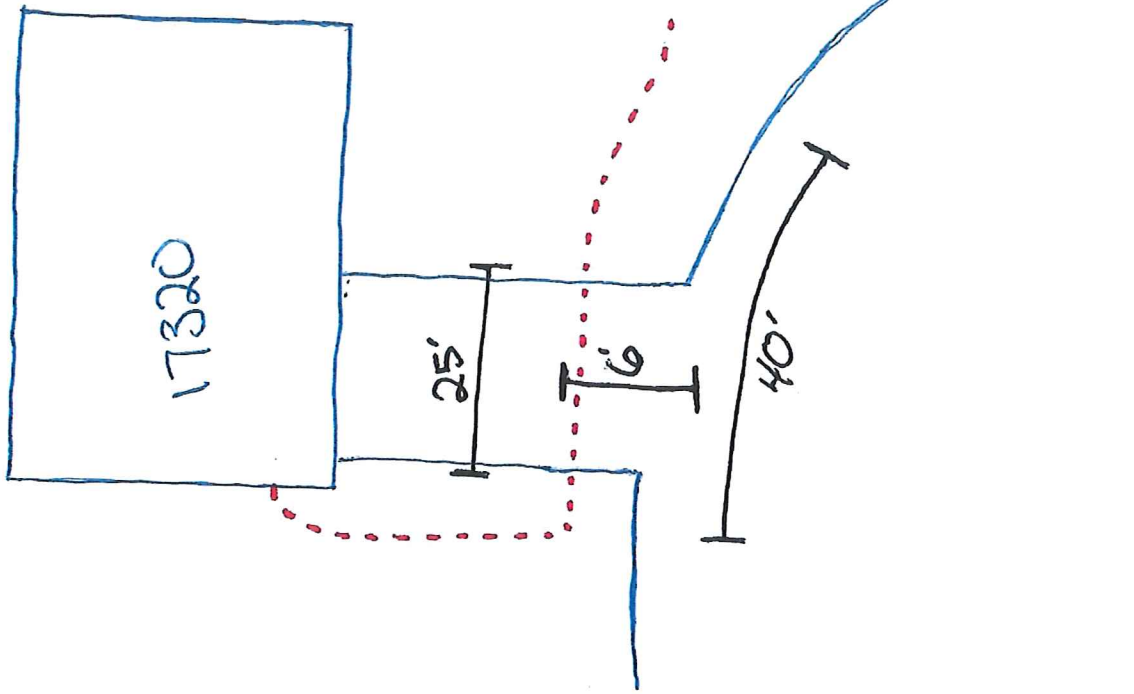



# Hennepin County Property Map

Date: 9/24/2021



PARCEL ID: 2011922330057

OWNER NAME: Y Karrar/M Karrar Et Al

PARCEL ADDRESS: 17320 78th Ave N, Maple Grove MN 55311

PARCEL AREA: 0.72 acres, 31,344 sq ft

A-T-B: Abstract

SALE PRICE: \$573,146

SALE DATA: 06/2015

SALE CODE: Excluded From Ratio Studies

ASSESSED 2020, PAYABLE 2021  
PROPERTY TYPE: Residential  
HOMESTEAD: Homestead  
MARKET VALUE: \$599,800  
TAX TOTAL: \$7,653.60

ASSESSED 2021, PAYABLE 2022  
PROPERTY TYPE: Residential  
HOMESTEAD: Homestead  
MARKET VALUE: \$618,500

## Comments:

This data (i) is furnished 'AS IS' with no representation as to completeness or accuracy; (ii) is furnished with no warranty of any kind; and (iii) is not suitable for legal, engineering or surveying purposes. Hennepin County shall not be liable for any damage, injury or loss resulting from this data.

COPYRIGHT © HENNEPIN COUNTY 2021