

MN Metro

21158572 - HELD

Revised 2-10-2020 State MN Contractor [Redacted] CMS# [Redacted]

CenturyLink BSW Order/Maintenance Work Authorization

Company: [Redacted] Exchange Name: [Redacted] Service Order#: 00132260
 Work Activity: SA-146910 Capital Y Maintenance N
 Customer Name: Heather Mansfield Phone#: 1000 282 131
 Address: 10800 108th Pl N One Call Ticket#: [Redacted]
 City & Zip: Maple Grove 55369
 Location/Directions: [Redacted]
 Description of Work or Special Instructions: From N.D 15 ft to Property line 180 ft bore to ped crossing 3 drive ways

Held Order: Y N Permit: Y N Bore: (Y) N CBR#: 612 237 7657
 Tech Name and Tech #: Abby / Alhadi / AC95391 Employee Contact#: 312 718 4063

Sketch (Include Cntr Line & Pedestal)	Material/Labor Units		Footage/Quantity	Comments
	Description	Notes		
Cntr Line Foot	SEB3-22	BSW-3 & plow plcmt		
	SEB3-22T	BSW-3 & hand dig plcmt		
Ped# 10810	SEPCUTOVER	CUTOVER BSW		
Parish/County	BM83	BSW guard at house		Footage when temp can't be re-used
	XXSEB-GL	Remove temp drop		
Township	BM61(1.25)SEB	BSW Bore footage	180	
Section	SEBO PER FT LBR	Fiber & plow plcmt	15	
Range	SEBO PER FT LBR T	Fiber & hand dig plcmt		
	SEB6-22	BSW-6 & plow plcmt		
	BM2(5/8)(8)	Ground Rod		
	Trip Charge	Trip Charge		
	Permit	Permit		Any placement within the ROW requires a permit

Nearest cross st. [Redacted] Plat Page [Redacted] Map# [Redacted]

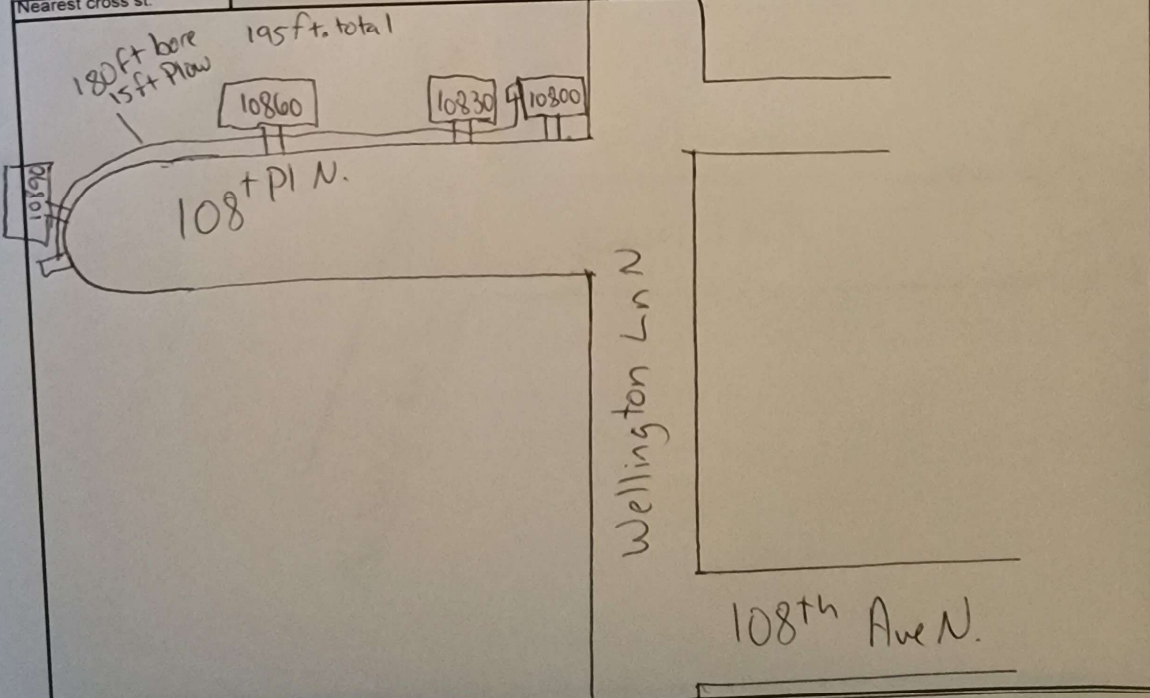

Originated By: _____ Date: _____ Completed By: _____ Date: _____
 Authorized By: (SRO) _____ Date: _____ Inspected By: _____ Date: _____
 Authorized By: (MRO) _____ Date: _____
 Email sketch to: _____

1. Distance of the bury in Right-of-Way	3. Distance to the nearest intersection
2. Distance from the terminal to the centerline	4. Nearest State Hwy mile marker

12. TRIGG
13. DISCO