

NOTE: BORE ALL PAVED STREETS AND DRIVEWAYS  
 Minimum depth requirements for crossings of state highways and county roads is 60". Minimum depth requirements for crossings of city streets and township roads is 48".  
 Minimum depth for parallel installations on state highways and county roads is 36". Minimum depth for parallel installations on city streets and township roads is 30". All steel pipe welds to be coated with 2 part epoxy.

INSTALL LOCATING POINTS AT A MAXIMUM SPACING OF 1,000 FT.

INSTALL 2" PE CL-6 MAIN 10' WEST OF EAST ROW LINE - DIRECTIONAL BORE

Install; Clean and Test; and Put in Service; Proposed new main per CenterPoint Energy Construction and Service Manual.

Purge new main until essentially 100% gas reading is obtained on Combustible Gas Indicator. See CenterPoint Energy Construction and Service Manual Section CS-B-1.230 for purging mains into service.

Install a marker ball at a new end of main, at a valve, at each ell of a horizontal offset, at road crossings and at any fitting or pressure control identified as needing to be located in the future. Refer to CenterPoint Energy Construction and Service Manual section CS-B-1.310 for installation procedures.

Procedure for tapping or making tie-ins to existing gas mains: Verify existing gas main size, type, and location prior to tapping or making tie-in. Monitor and verify, using a pressure gauge, existing gas main Pressure Class within the bell hole of tap location or tie-in location prior to tapping or making tie-in.

I hereby certify that this plan, specification, or report was prepared by me or under my direct supervision and that I am a duly Licensed Professional Engineer under the laws of the state of Minnesota.

Signature: *Eric Yang*

Typed or Printed Name: **Eric Yang**

Date: **10/11/2021** License Number: **56613**

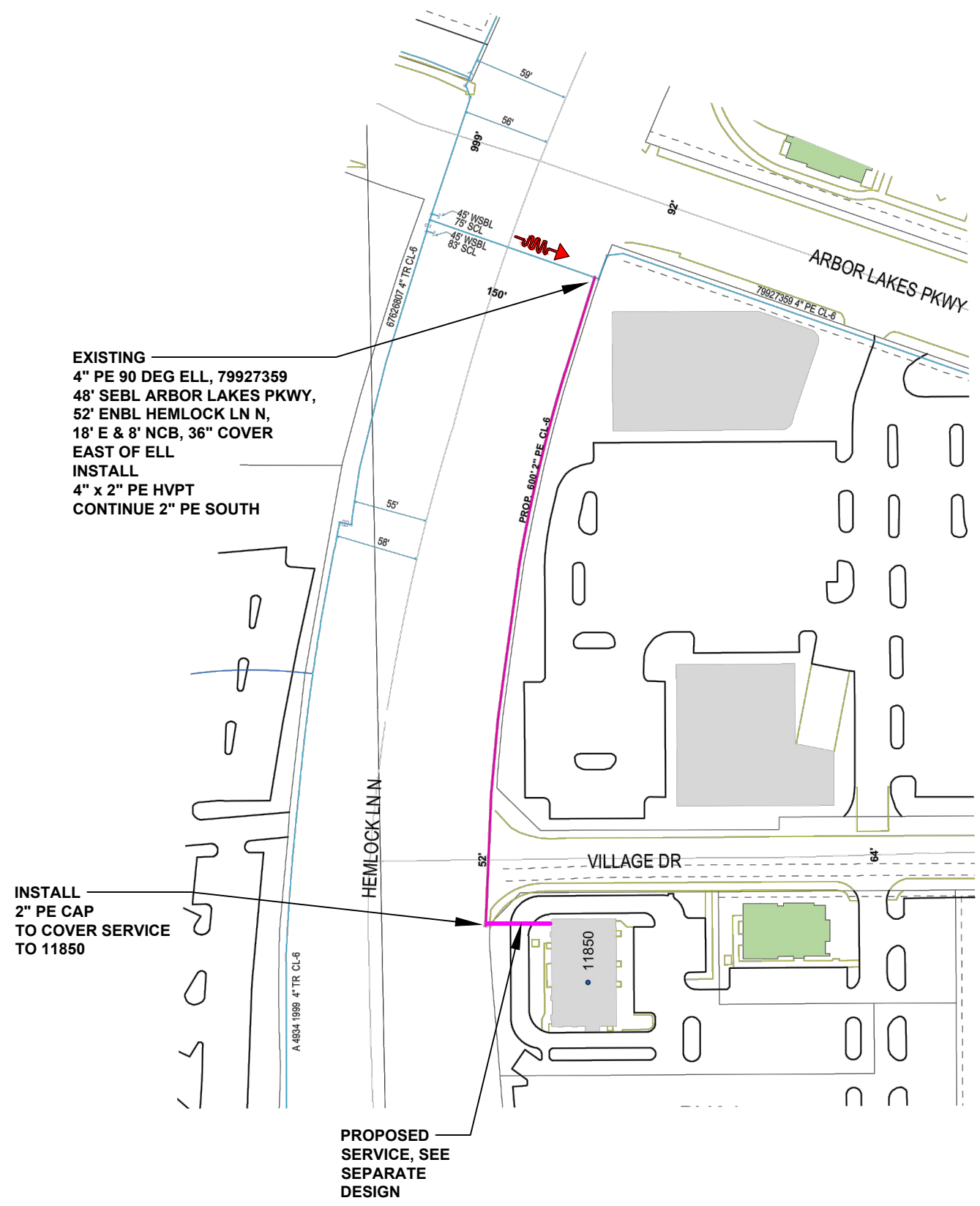

**EXISTING**  
 4" PE 90 DEG ELL, 79927359  
 48' SEBL ARBOR LAKES PKWY,  
 52' ENBL HEMLOCK LN N,  
 18' E & 8' NCB, 36" COVER  
**EAST OF ELL**  
**INSTALL**  
 4" x 2" PE HVPT  
 CONTINUE 2" PE SOUTH

**INSTALL**  
 2" PE CAP  
 TO COVER SERVICE  
 TO 11850

**PROPOSED**  
 SERVICE, SEE  
 SEPARATE  
 DESIGN



MINNESOTA REGION  
 PROPRIETARY AND CONFIDENTIAL

PROJECT #: **100127351**

M52900 MAPLE GROVE

ONE CALL:  
 Hennepin  
 \*SE23 T119/R22  
 \*SW23 T119/R22  
 \*= this Page

- LEGEND:
- 4" PVC CONDUIT
  - ACTIVE MAIN
  - DESIGNED MAIN
  - PROPOSED ABANDONED/  
OUT OF SERVICE MAIN
  - ABANDONED/  
OUT OF SERVICE MAIN

PIPE REQUIRED:  
 600' 2" PE CL-6  
 -----  
 600' PIPE

PROPOSED ABANDONED PIPE:

COPIES:  
 PIPELINE INTEGRITY PACKET: N  
 STATION MANAGER: N  
 DD NUMBER: N  
 CORROSION: N  
 EMP: N  
 SITE CONTACT: DAN MEHOK  
 651-270-7124  
 FOLLOW INTERNAL PIPE  
 SAMPLING REQUIREMENTS? N  
 SURVEYOR REQUIRED? N  
 RETURN PACKET TO ENG? N  
 GFIP#: N/A  
 PERMITS: MAPLE GROVE  
 SalesRep **CHERIE MONSON**

PROJECT DESCRIPTION: NBCCO  
 ARBOR LAKES BLDG D

DESIGNER: Marcia Kolstad  
 PHONE #: 612-321-5482  
 DRAWN BY: Marcia Kolstad  
 DESIGN DATE: 10/11/2021

REVISION INFO:

Main SS#	SCALE 1" = 120' SHEET 1 OF 1
----------	---------------------------------