

10995 97th Pl n
m.g.
X-Street Zachary Ln

N ↑

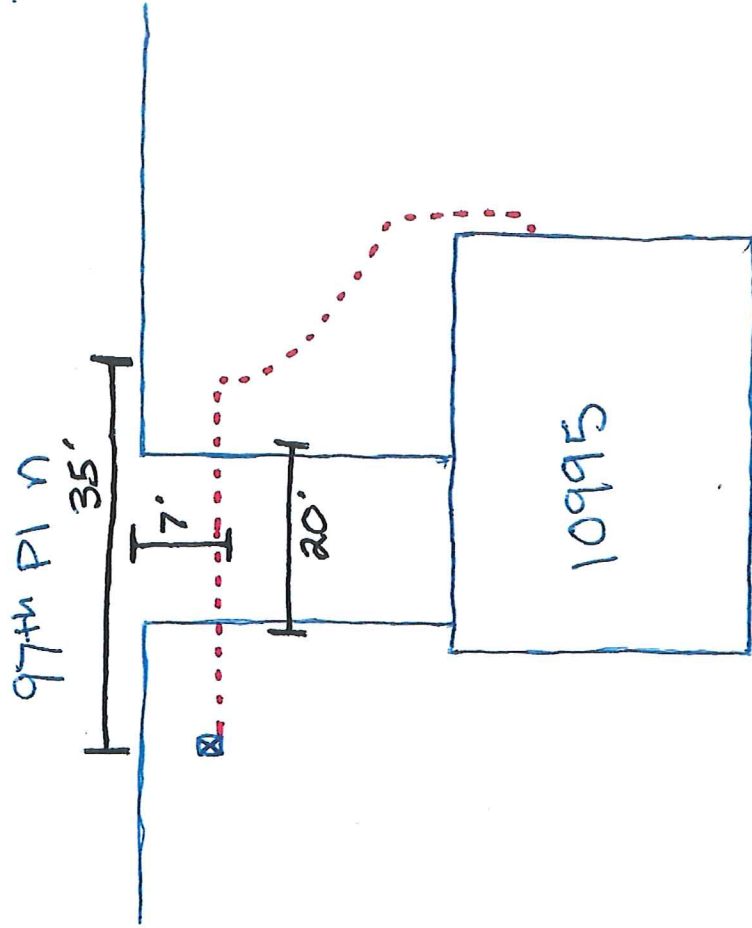



Hennepin County Property Map

Date: 8/18/2021



PARCEL ID: 1211922230087

OWNER NAME: L Manelli & M Otoole-Manelli

PARCEL ADDRESS: 10995 97th PI N, Maple Grove MN 55369

PARCEL AREA: 0.23 acres, 10,000 sq ft

A-T-B: Abstract

SALE PRICE: \$82,235

SALE DATA: 10/1985

SALE CODE: Contract For Deed

ASSESSED 2020, PAYABLE 2021
PROPERTY TYPE: Residential
HOMESTEAD: Homestead
MARKET VALUE: \$268,900
TAX TOTAL: \$3,195.56

ASSESSED 2021, PAYABLE 2022
PROPERTY TYPE: Residential
HOMESTEAD: Homestead
MARKET VALUE: \$289,000

Comments:

This data (i) is furnished 'AS IS' with no representation as to completeness or accuracy; (ii) is furnished with no warranty of any kind; and (iii) is not suitable for legal, engineering or surveying purposes. Hennepin County shall not be liable for any damage, injury or loss resulting from this data.

COPYRIGHT © HENNEPIN
COUNTY 2021